

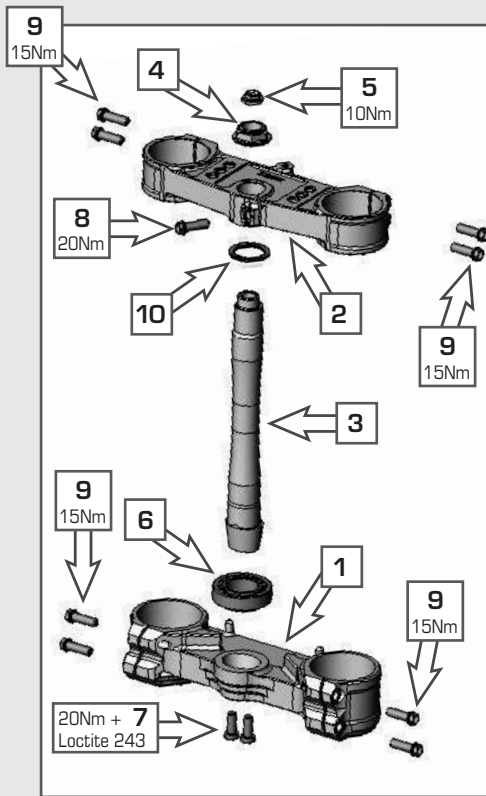

**MOUNTING INSTRUCTIONS
FOR THE XTRIG TRIPLE CLAMP**

racing technology



Thank you for choosing XTRIG racing technology.

All our products were designed and manufactured according to the highest standards using the best materials available. XTRIG racing technology is race-proven to offer the ultimate in performance.

XTRIG shall not be held liable for improper installation or use of this product. Please follow all instructions provided. If you are unsure of any installation procedure, please contact an authorized dealer. Thank you.

Scope of supply:

1. 1x XTRIG triple clamp milled on bottom
2. 1x XTRIG triple clamp milled on top
3. 1x XTRIG steering stem with adjustable eccentric
4. 1x adjusting nut for XTRIG triple clamp
5. 1x counter screw for XTRIG triple clamp
6. 1x tapered roller bearing
7. 2x HH screw M8x20 A/F 6 with pin
8. 1x collar screw M8x25 A/F 10
9. 8x collar screws M8x30 A/F 10
10. 1x O-ring or 1x gasket, depending on model

XTRIG triple clamp mounting instructions

Certain details in these instructions may vary depending on the model.

These instructions will provide instructions for the general installation of the triple clamp and show how to adjust the offset.

Preparation:

Jack up the clean motorcycle under the frame, lifting the front wheel off the ground.

Removing the factory triple clamp:



Remove the brake pump.



Remove the brake line guide.



Attach the brake pump to the brake line.



Remove the starting number plate (depending on model).



Remove the handlebar and any fastening material such as cable ties.



Remove the fender.

factory triple clamp



7. Loosen the mounting nut on the upper triple clamp.



8. Loosen the triple clamp clampings.



9. Pull the fork down and remove together with the front wheel and brake system.



10. Remove the upper triple clamp.



11. Holding on to the lower triple clamp, remove the adjusting nut on the steering head bearing.



12. Remove the lower triple clamp. Clean the motorcycle's steering head and bearing seat.

Mounting the XTRIG triple clamp:



1. Grease the steering head bearing on the pre-assembled XTRIG triple clamp with suitable bearing grease.



2. Slide the lower triple clamp into the steering head, holding the upper steering head bearing and the sealing washer in place.

NOTE: do not let go of the lower triple clamp and continue pressing in the mounting direction.



3. Depending on the model, mount the seal for the steering head bearing (sealing washer or O-ring)



4. Mount the upper triple clamp and screw the adjusting nut (4) on by hand.

NOTE: now you can let go of the lower triple clamp.



5. Position the fork, front wheel and brake system in the triple clamp.

WARNING: only tighten the clamp screws (9) on the upper triple clamp to a torque of 15 Nm.



6. Use the adjusting nut (4) to adjust the desired bearing clearance.

Mounting the XTRIG triple clamp:



Screw the counter screw (5) in the adjusting nut (4) and tighten to 10 Nm.



Tighten the collar screw (8) to clamp the shaft tube to 20 Nm.



Tighten the clamp screws (9) on the lower triple clamp to 15 Nm. Mount the front fender and brake line guide.



Warning!

The handling performance will be unsteady if there is play in the steering head support. This could cause you to lose control of your motorcycle.

Caution!

If you continue to drive with play in the steering head support, the bearings and the bearing seats in the frame will eventually be destroyed.

Regrease the steering head bearings at least once a year.

Offset:

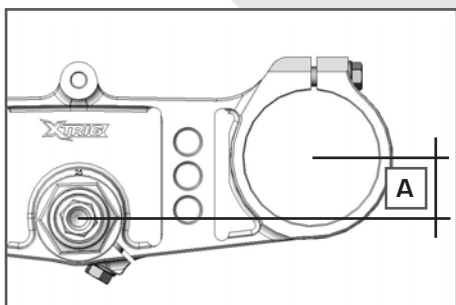

The Xtrig triple clamp can be used to adjust the fork offset [A] (center of the fork legs – center of the steering head bearing) to adapt the handling to the racecourse.

The preset offset is shown on the engraved number visible in front of or behind the adjusting nut.

The lower offset setting will give you better driving stability on fast racecourses. The larger offset will improve the handling in tight curves.

Changing the fork offset:

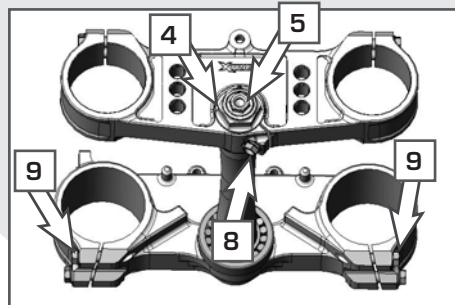

To change the offset, jack up the motorcycle under the frame, lifting the front wheel off the ground. Remove the front fender. Loosen the 5 clamp screws (8) and (9) and remove the two screws (7). Push the lower triple clamp down approx. 22 mm, making sure the fork is not compressed in this state.

NOTE: if the lower triple clamp is jammed, the lower triple clamp can be separated from the conical shaft tube by screwing the M8x20 collar screw into the hole (B).

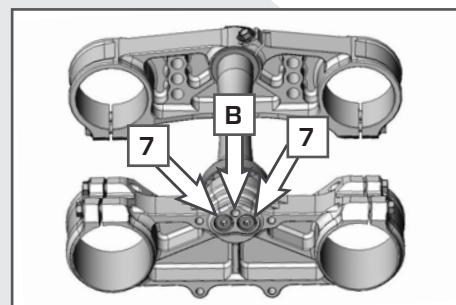

Turn the adjusting nut (4) on the steering stem 180° in a clockwise direction using a suitable wrench (A/F 27). Make sure you do not loosen the counter screw (5). Remove the collar screw from the hole (B) (if used) and push the lower triple clamp all the way up again. Screw in and tighten the two screws (7). Tighten the 5 clamp screws (8) and (9) and mount the fender. Check the steering head bearing clearance and readjust if necessary.

factory triple clamp