

## V3 FRAME SLIDERS KIT 2.0

# KAWASAKI Z800

year of production: ALL

product code: SR134

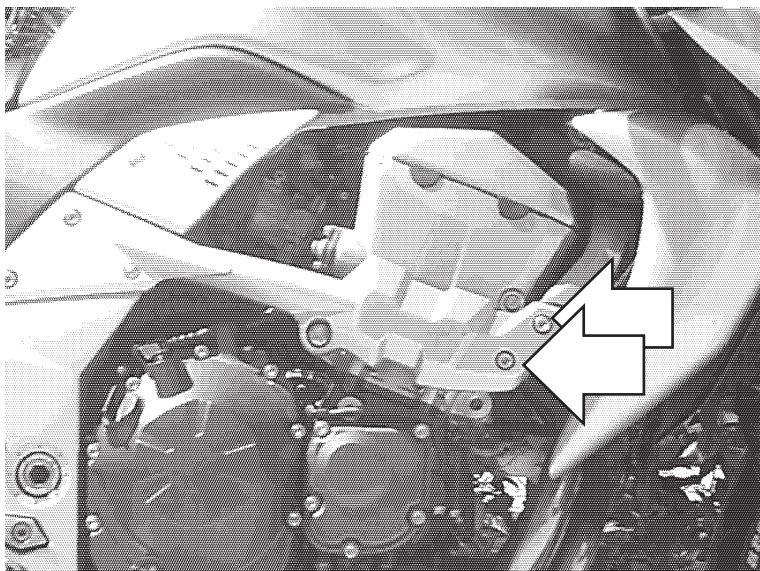

### Assembly instructions

1. Remove the original bolts indicated with the arrows on the assembly position scheme above.
2. Replace the original bolt by the new mounting bolt (parts #7, #8), the spacers 1 and 2 (parts #9, #10) and adapter (part #6) according to the scheme on the right page. Put the adapter (part #6) in the right position according to the drawing on the right page.
3. Assemble the slider, round cylindrical body, the bolt and the steel sleeve (parts #1, #2, #3 and #4) according to the drawing on the right page. Put them into the threaded hole in adapter (part #6).
4. Same operation is required in another side of the motorbike.

We suggest to use the threadlocker (eg. Loctite®) to make sure that the vibrations of the engine do not loosen the bolts.

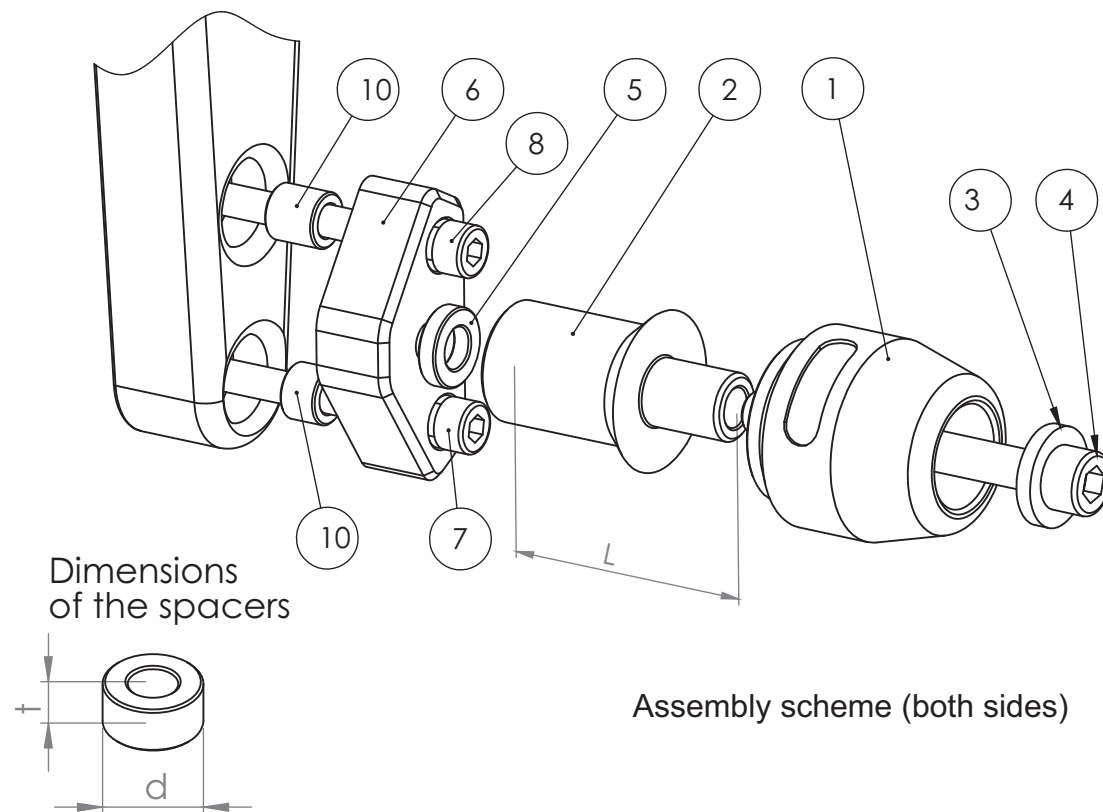

Dimensions of the spacers

Assembly scheme (both sides)

Part #	Part name	Left side (as You sit on the motorbike)	Right side
1	Slider	1 pcs.	1 pcs.
2	Round cylindrical body	L = 50 mm	L = 40 mm
3	Steel sleeve	1 pcs.	1 pcs.
4	Allen bolt (8,8 class)	M10x70 mm	M10x60 mm
5	Spacer	t=20mm, d=5 mm to be put between part#2 and part #6	t=20mm, d=5 mm to be put between part#2 and part #6
6	Adapter	Steel	Steel
7	Mounting bolt 1	M8x60	M8x60
8	Mounting bolt 2	M8x60	M8x60
9	Spacer 1	t=14mm, d=14 mm	t=14 mm, d=14 mm
10	Spacer 2	t=14mm, d=14 mm	t=14mm, d=14 mm
11	Nut	-	-
12	Washer	M8, 2 pcs. to be put under the heads' of M8x60 bolts	M8, 2 pcs. to be put under the heads' of M8x60 bolts

Legal note. This product is a professional accessory to be used on the race track. Neither manufacturer, nor Seller take responsibility for any damages occurred despite of using protective accessories.

Our website offers you a wide variety of motorcycle frame & body at affordable prices.