

RS591K INSTRUCTIONS

TO BE INSTALLED BY A CERTIFIED MECHANIC ONLY | FOR RACE USE ONLY

BRAKE SIDE EXPLODED VIEW



INDEX

-  Lubricate
-  Thread Lock
-  Use Factory Piece

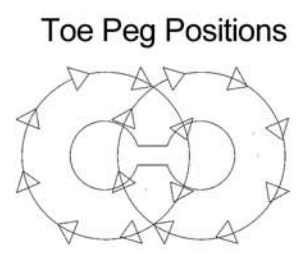
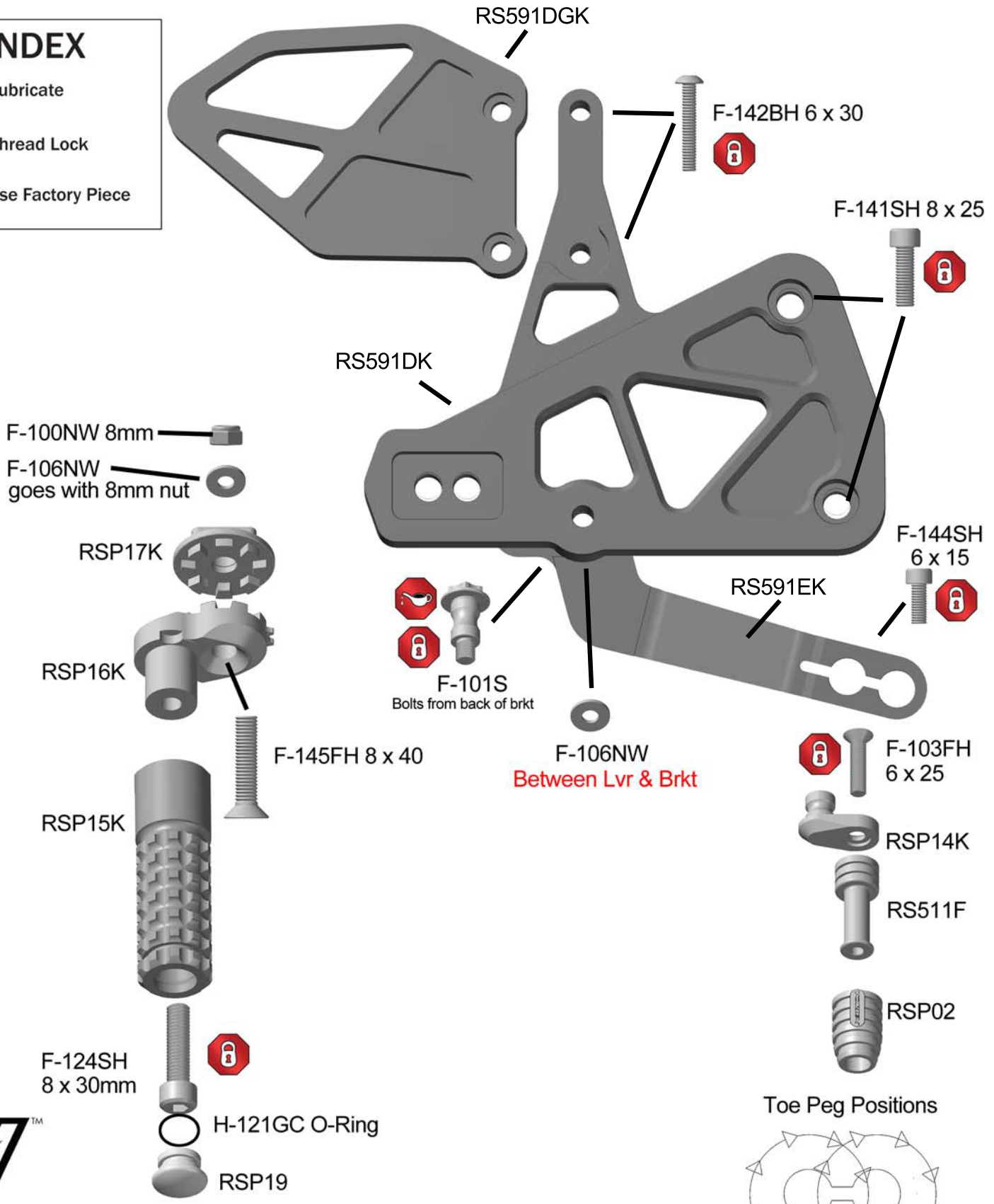

RS591K INSTRUCTIONS

TO BE INSTALLED BY A CERTIFIED MECHANIC ONLY | FOR RACE USE ONLY

SHIFT SIDE EXPLODED VIEW



INDEX

-  Lubricate
-  Thread Lock
-  Use Factory Piece

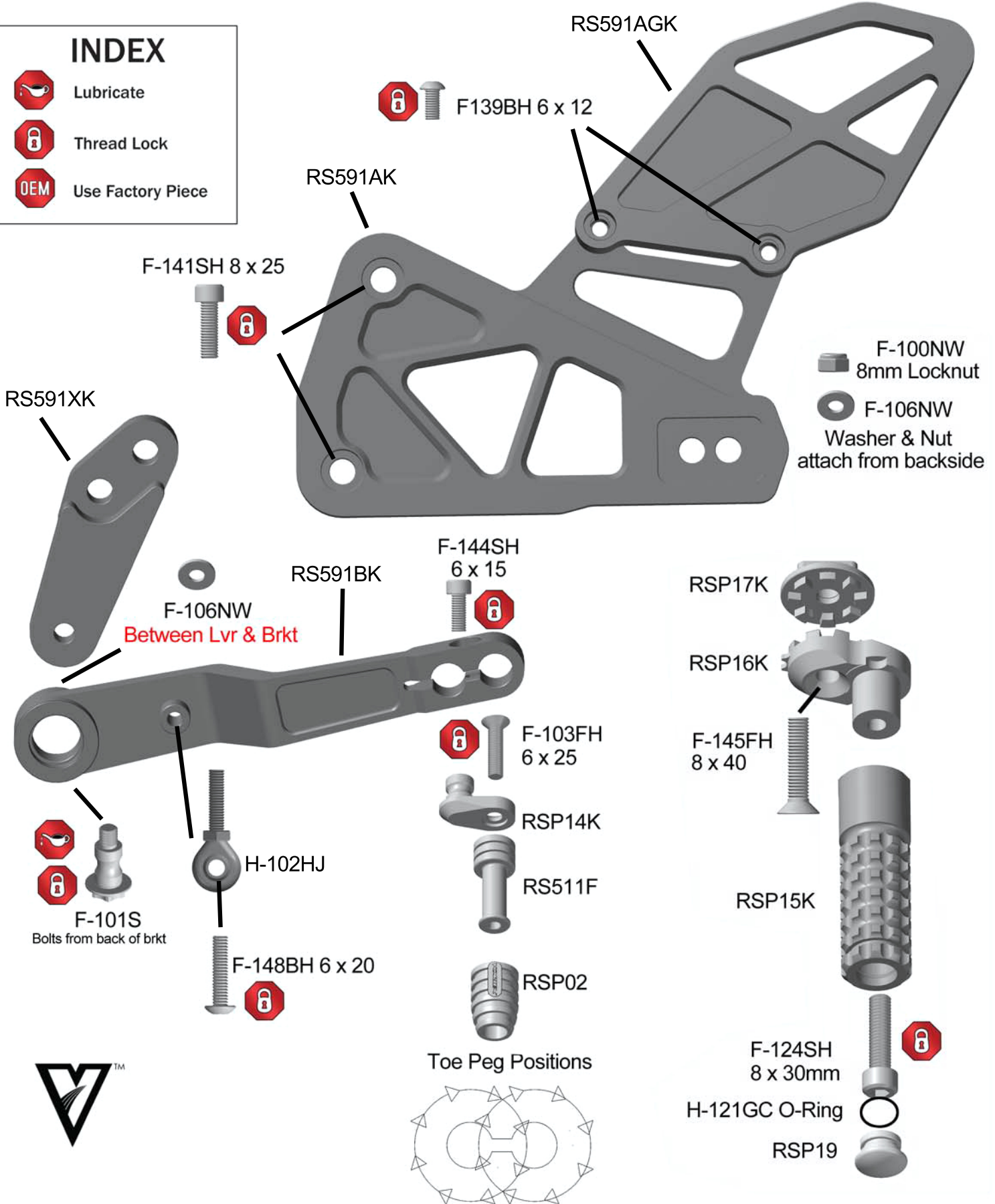

RS591K INSTRUCTIONS

TO BE INSTALLED BY A CERTIFIED MECHANIC ONLY | FOR RACE USE ONLY

How to adjust Footpeg positions

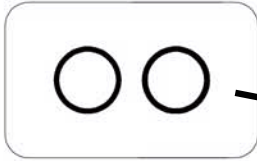

1) Decide which mounting hole in pocket to use.

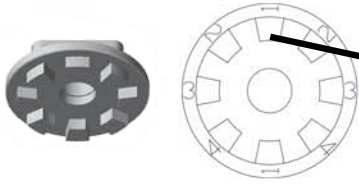

2) Position #1 at 12 o'clock position for shift and brake.
Be sure other numbers are not upside down.



3) Tab reader will indicate which position you are on.

CAUTION - Each number has two positions. Be sure to use the same position for shift and brake side.

Example

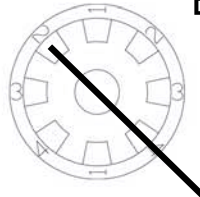

#2 position

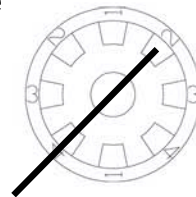

#2 position

Footpeg positions

