

RS503 INSTRUCTIONS

TO BE INSTALLED BY A CERTIFIED MECHANIC ONLY | FOR RACE USE ONLY

BRAKE SIDE EXPLODED VIEW

FOR: Suzuki GSXR750 00-05 / GSXR600 01-05 / GSXR1000 01-04



INDEX



Lubricate



Red Thread Lock



DO NOT Overtighten



Use Factory Piece

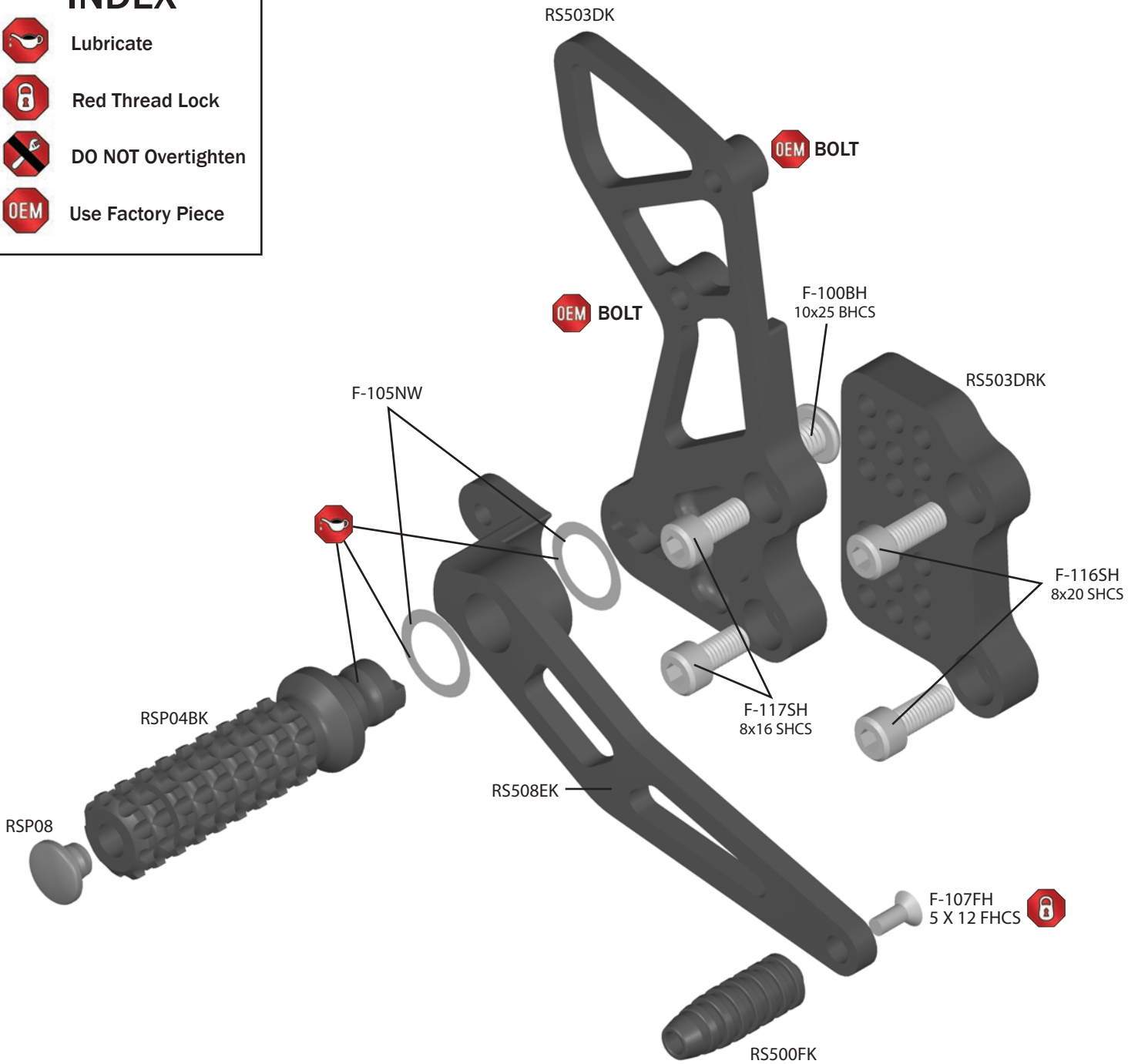

RS503 INSTRUCTIONS

TO BE INSTALLED BY A CERTIFIED MECHANIC ONLY | FOR RACE USE ONLY

SHIFT SIDE EXPLODED VIEW

FOR: Suzuki GSXR750 00-05 / GSXR600 01-05 / GSXR1000 01-04



INDEX



Lubricate



Red Thread Lock



DO NOT Overtighten



Use Factory Piece

