

RS211 INSTRUCTIONS

TO BE INSTALLED BY A CERTIFIED MECHANIC ONLY | FOR RACE USE ONLY

SHIFT SIDE EXPLODED VIEW

FOR: HONDA CBR500 13-14



INDEX



Lubricate



Red Thread Lock



DO NOT Overtighten



Use Factory Piece

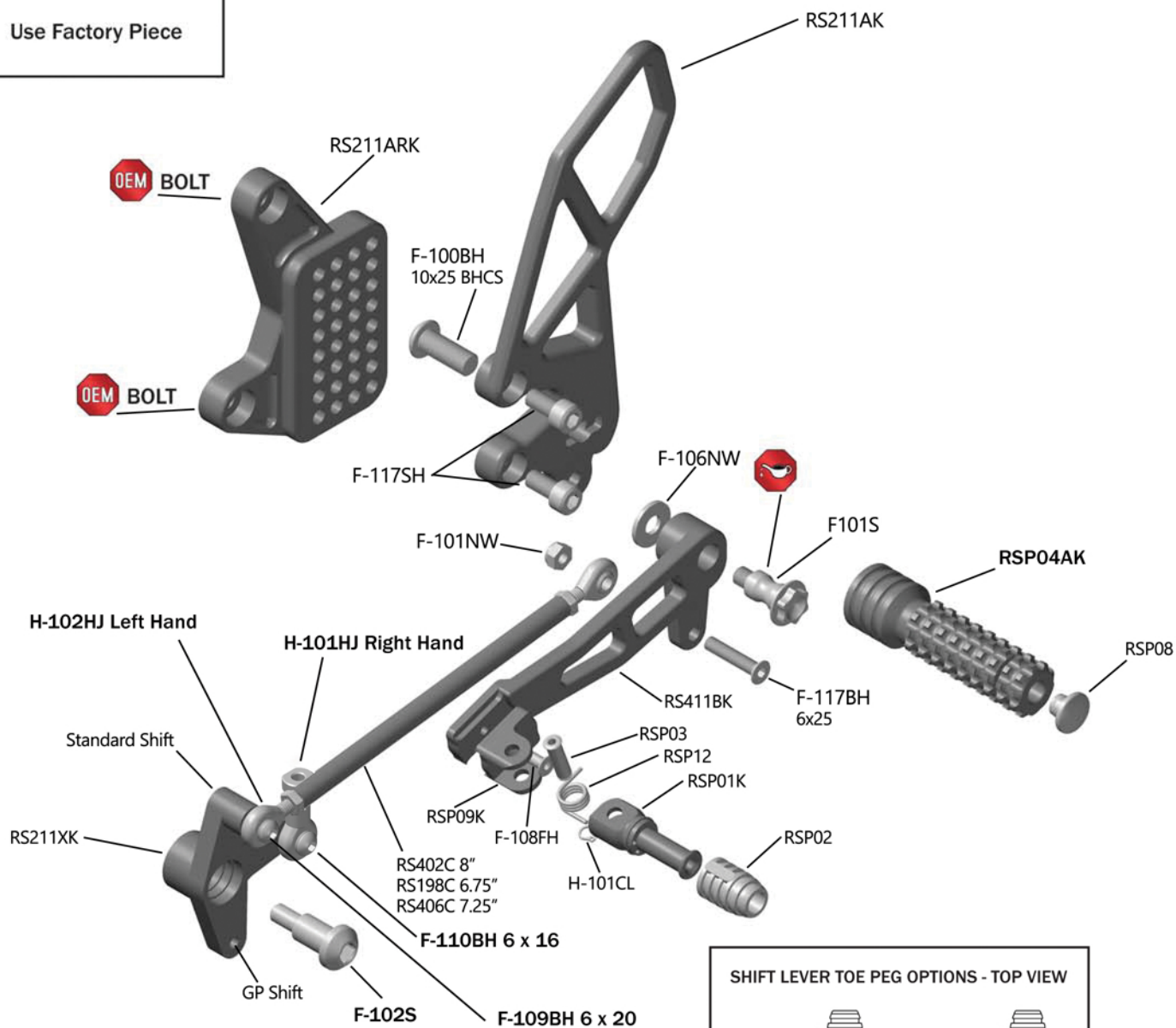

SHIFT LEVER TOE PEG OPTIONS - TOP VIEW

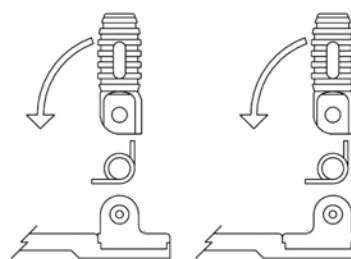

TOE PEG MUST FOLD TOWARDS FOOT PEG



RS211 INSTRUCTIONS

TO BE INSTALLED BY A CERTIFIED MECHANIC ONLY | FOR RACE USE ONLY

BRAKE SIDE EXPLODED VIEW

FOR: HONDA CBR500 13-14



INDEX



Lubricate



Red Thread Lock



DO NOT Overtighten



Use Factory Piece

CAUTION: You may have to loosen and reposition the brake line location depending upon the rearset position you choose. Be sure to properly tighten after adjusting.

Use pliers to remove top of clevis pin as shown below



Modified Clevis Pin

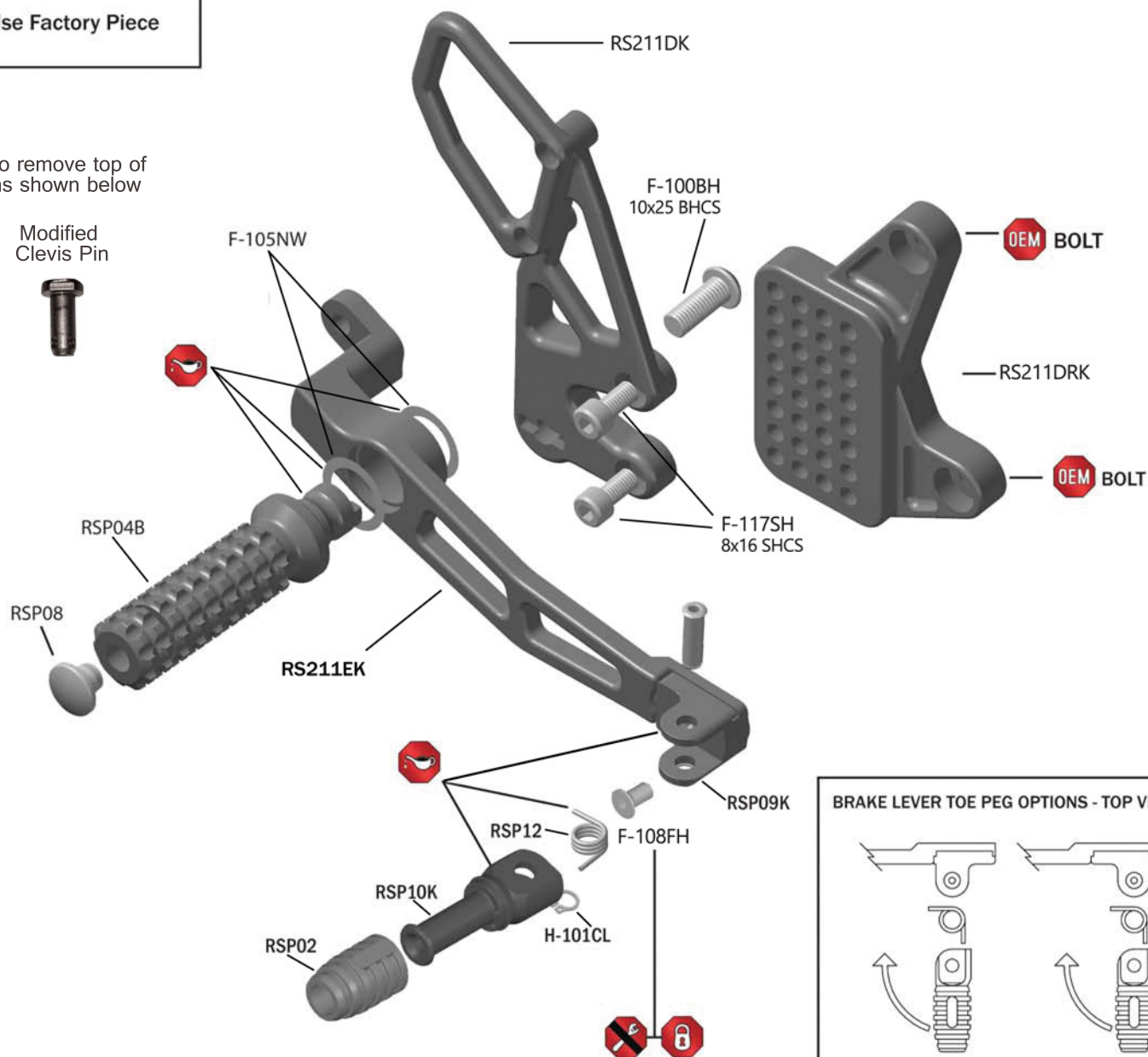

BRAKE LEVER TOE PEG OPTIONS - TOP VIEW

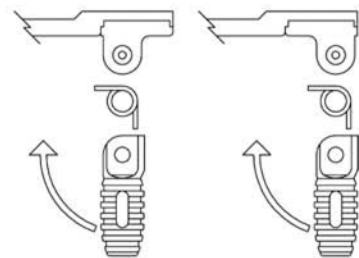

TOE PEG MUST FOLD TOWARDS FOOT PEG

BRAKE LIGHT INFO:

These rearsets do not use: OEM rear brake light switch, spring & lever return spring. In race form these rear sets no longer activate rear brake light from rear brake lever. Street use requires rear brake light to be activated by rear & front brake levers. To achieve rear brake light activation from rear brake lever use Vortex in-line pressure switch RS100.



Check out a selection of motorcycle foot controls & pegs offered in our online store.