

Congratulations, you have purchased the finest exhaust system available for your motorcycle. Your Vance & Hines exhaust is designed and crafted for performance, quality, and style.

FOR CLOSED COURSE COMPETITION USE ONLY. NOT INTENDED FOR STREET USE.

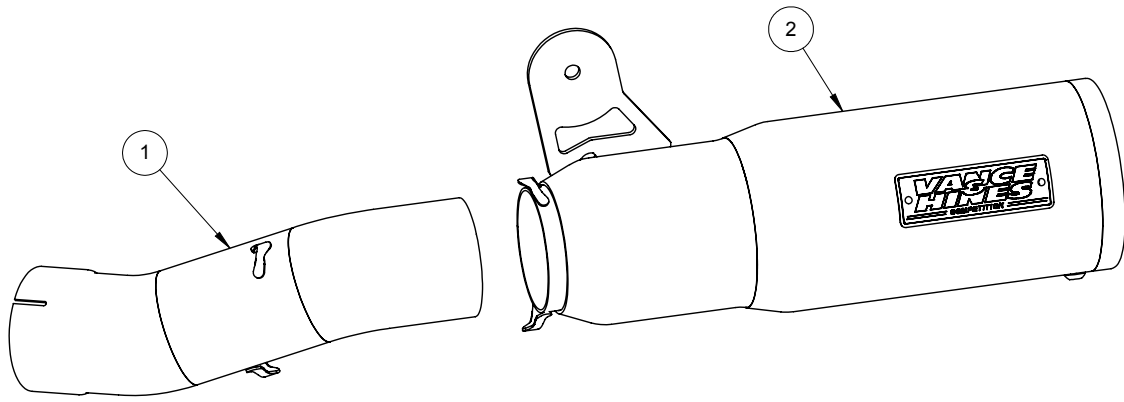

## HARDWARE

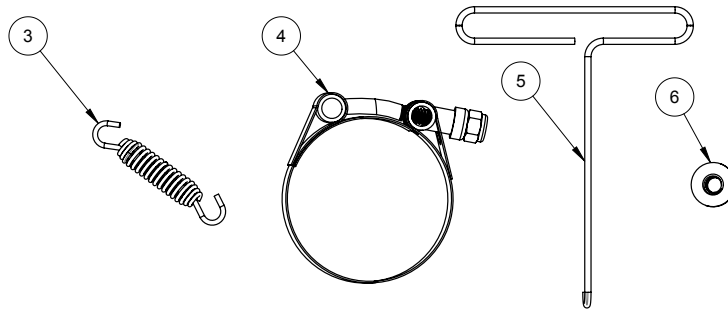

## PARTS LIST

ITEM NO.	PART NO.	DESCRIPTION	QTY.	ITEM NO.	PART NO.	DESCRIPTION	QTY.
1	B600RB	MID-PIPE	1	4	A925HW	2-5/16 - 2-5/8 T BOLT CLAMP	1
2	B610RB-S	MUFFLER CAN ASSEMBLY	1	5	A260SP	SPRING PULLER	1
3	A115SP	DIRT SPORT SPRING	2	6	A852HW	M8 X 1.25MM FLANGE NUT	1

## TOOLS REQUIRED

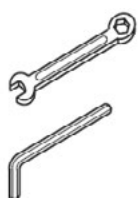

Wrenches: 10mm

Allen Wrench: T-45

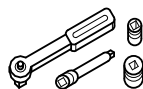

Sockets: 10mm

## STOCK SYSTEM REMOVAL

1. Loosen clamp securing muffler to head pipe.
2. Remove bolt securing muffler can to mount bracket.
3. Carefully slip muffler off of mid-pipe and set aside.

## VANCE & HINES SYSTEM INSTALLATION

1. Insert clamp (A925HW) onto the mid-pipe (B600RB) and position as shown in **Figure 1**.
2. Slip muffler (B610RB-S) onto mid-pipe (B600RB) and align spring clip tabs.
3. Slip mid-pipe onto stock header. **Note:** Mid-pipe must bottom out on head pipe collar. Adjust the fit of the muffler and secure muffler can using the stock mounting bolt and supplied flange nut (A852HW). Do not tighten at this time.
4. Align clamp with edge of midpipe, ensure mid-pipe slots are covered completely. Tighten clamp (A925HW) to secure mid-pipe in location.
5. Attach both exhaust springs (A115SP) to muffler and mid-pipe using supplied spring puller. **Figure 2**.

## EXHAUST CARE (STAINLESS)

1. When installing new stainless steel make sure your hands are clean and free of oil. After installation, thoroughly clean pipes and mufflers with a soft cloth and cleaning solvent that will leave no residue (acetone, glass cleaner, alcohol, etc...) before starting the motorcycle.
2. It is considered normal for stainless steel exhaust systems to discolor due to heat.
3. High performance engine tuning utilizing a dyno will likely result in severe discoloration.
4. Avoid long periods of idling as this can cause discoloration. Intake leaks can cause the engine to run lean and overheat; this could lead to discoloration.

**FIGURE 1**

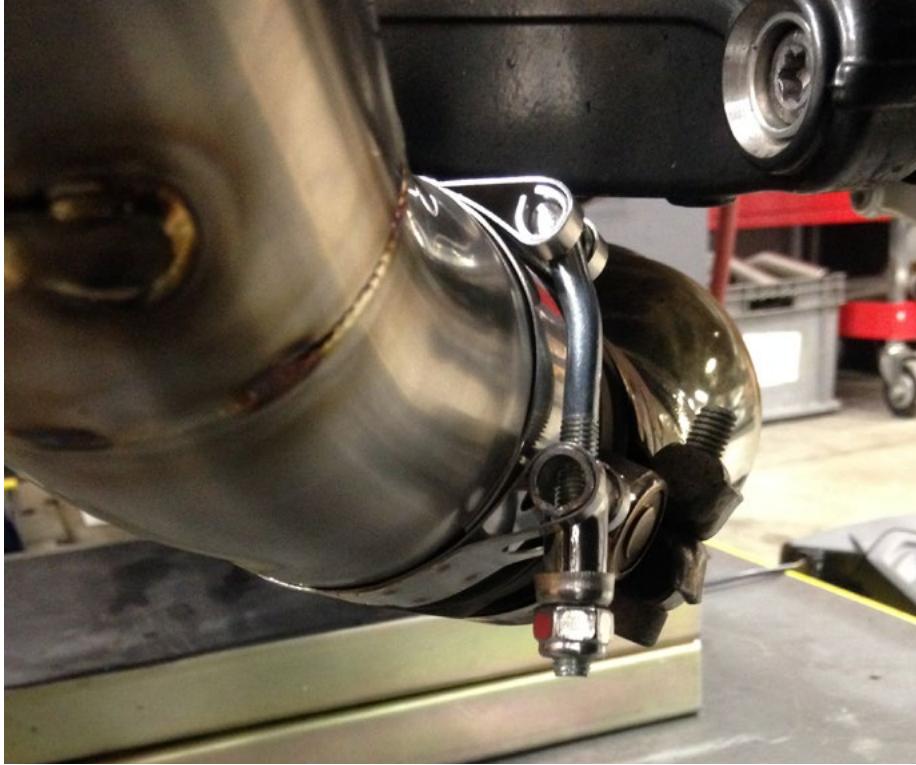

**FIGURE 2**



Discover other motorcycle exhaust on our website.