



SHOWN WITH ACCESSORY SKULLCAP

**TOOLS  
REQUIRED**

- 4mm Allen wrench
- 5mm Allen wrench
- 5/32" Allen wrench
- Loctite 243 (blue)

Congratulations, you have purchased the finest air intake system for your motorcycle on the market. Your Vance & Hines Air Intake system is designed and crafted for maximum performance and a perfect fit.

Attention installer (if other than owner), please forward this instruction sheet to the owner of this product. These instructions contain valuable information to end user.

**READ ALL INSTRUCTIONS BEFORE BEGINNING INSTALLATION**

**OEM SYSTEM  
REMOVAL**

1. Using a 4mm Allen wrench, remove the filter cover by first removing the 4 outer socket head capscrews securing the filter cover then remove the cover assembly.
2. This will expose the filter element, which is then removed by pulling it out of the housing.
3. Using a 5mm Allen wrench, remove the socket head capscrew located at the front of the housing, Using a 4mm Allen wrench remove the 3 socket head capscrews attaching the housing to the throttle body.
4. Pull the air cleaner housing away slightly from the engine. Located on the backside of the housing is a breather hose attached with a wire clamp. Carefully squeeze the clamp's tabs and remove the hose from the air cleaner housing while removing the housing from the vehicle.
5. None of the OEM parts will be reused for this installation.

**INSTALLATION OF VO2  
AIR FILTER KIT**

1. For a clear understanding of this installation it is best to refer to the exploded view diagram (Page 3) while reading these instructions.
2. When installing or servicing the air cleaner, apply Loctite 243 (blue) to threads of all fasteners.
3. Squeeze the tabs on the wire clamp to expand the clamp and install the breather hose on the nipple located on the backside of the Vance and Hines dual venturi making sure the hose is firmly seated against the backside of the venturi plate.
4. Using the three supplied M5 x 12mm socket head capscrews, attach the aluminum dual venturi (2) to the stock throttle body.
5. Attach the mounting bracket (4) to the filter mounting plate (5) using the supplied 1/4-20 x 1/2 button head (3). NOTE Roughly align the curve in the mounting bracket with the circular hole in the filter mounting plate. Do not fully tighten the 1/4" Button Head at this time.
6. Place the filter mounting plate (5) on the aluminum dual venturi (1) roughly aligning the plate and venturi. Next put the filter element in place (logo should be near the bottom) and using the supplied three M6 x 60mm socket head capscrews (7) secure both the filter and mounting plate to the venturi. Note Do not fully tighten at this time.
7. Install the supplied M6 x 1.0 x 12mm capscrew (8) though the mounting plate (4) and into the OEM bracket on the front cylinder head.

- 8. Align all elements and tighten all bolts securely.
- 9. This kit does not include the Skullcap type cover. This will have to be ordered seperately, please choose one of the available types from the Optional Accessories below.
- 10. If you plan to run the Motorcycle without the optional Skullcap you will need to plug the hole in the middle of the Filter Element using a 5/16"-18 Bolt (Not Supplied)
- 10. Periodically check all fasteners for tightness.

**CLEANING AND MAINTENANCE**

- 1. Please review cleaning and maintenance instructions supplied with Skullcap kit.

**VANCE & HINES OPTIONAL ACCESSORIES**

**FUELPAK**



**FUEL MANAGEMENT:**

Take the guess work out of fuel injection with Fuelpak Fuel Management. Contact your local dealer or call (562) 921-0071 to order. Visit [fuelpakfi.com](http://fuelpakfi.com) for more information.

Fuelpak is intended for racing or off-highway use only, and is not legal for sale or use in California on pollution-controlled vehicles.

**SKULLCAPS**

71013 - Chrome Skullcap

71017 - Chrome Crown Skullcap

71015 - Black Skullcap

71019 - Black Crown Skullcap

71025 - Matte Chrome Crown Skullcap

**MORE POWER : LESS NOISE**

**EXPLODED VIEW DIAGRAM**

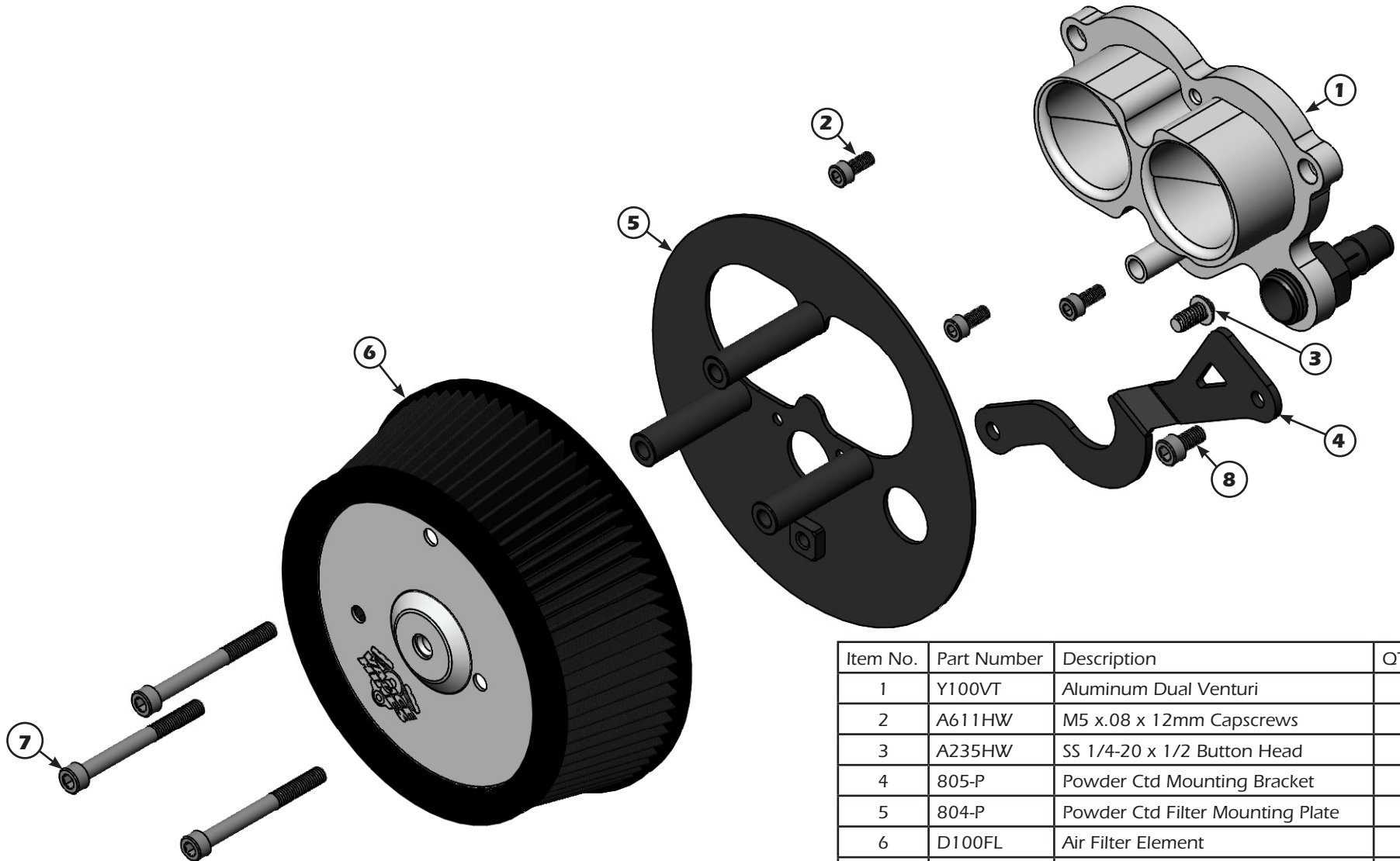

Item No.	Part Number	Description	QTY
1	Y100VT	Aluminum Dual Venturi	1
2	A611HW	M5 x.08 x 12mm Capscrews	3
3	A235HW	SS 1/4-20 x 1/2 Button Head	1
4	805-P	Powder Ctd Mounting Bracket	1
5	804-P	Powder Ctd Filter Mounting Plate	1
6	D100FL	Air Filter Element	1
7	A610HW	M6 x1.0 x 60mm Capscrews	3
8	A612HW	M6 x 1.0 x 12mm Capscrew	1

**WARRANTY**

Vance & Hines products are warranted against defects in material and workmanship for a period of 90 days from the date of purchase from an authorized dealer. This warranty does not cover discoloration of chrome finishes. This warranty is limited to the repair or replacement of a product proven to be defective from normal use. Vance & Hines products are designed to fit and operate on OEM motor and chassis. This warranty does not cover any product subject to abuse, misuse, improper installation or modification.

## FUEL MANAGEMENT

### GET THE MOST OUT OF YOUR RIDING EXPERIENCE...

AN AFTERMARKET EXHAUST SYSTEM IS ONLY YOUR FIRST STEP, NOW YOU NEED FUEL MANAGEMENT.

### NOW YOU NEED FUELPAK.

Your fuel injected Motorcycle is equipped with an ECU (electronic control unit) that's programmed to deliver fuel to the motor based on an air/fuel ratio for a stock air filter and stock exhaust system. When you install a performance exhaust system, your airflow changes, so you need a fuel management system that adjusts your air/fuel ratio to match the changes. That fuel management system is Fuelpak. Fuelpak adds and takes away fuel, allowing for a more precise range of refinement in your air/fuel ratio. Get the perfect fuel management combination with your Vance & Hines exhaust system, get Fuelpak.

NOTICE: Fuelpak is intended for racing or off-highway use only, and is not legal for sale or use in California on pollution-controlled vehicles.



MORE POWER : LESS NOISE