



UNIBEAR

CARE FOR ENVIRONMENT



Motorcycle Chains&Sprockets



Company Introduction



Hangzhou Unibear Industrial Co. Ltd. was founded in 1995, occupying an overall floorage of 220,000 square meters, hiring more than 1200 employees. It has several registered trademarks like UNIBEAR®, SLCC®, Oditer® and Odiking®.

Unibear boasts itself of advanced production equipments and processing technology that are paralleled with international level. It has been all along dedicated to conducting research and development on all kinds of chains and sprockets. Its products excellently pass major international quality standards of ISO, ANSI, BS, DIN and JIS, due to their superior performance and stable quality. Furthermore, it was crowned several reputations such as "National Torch Program Project", "The Entrepreneurial Technology Center of Zhejiang Province" and "Innovation-oriented Pilot Enterprise of Zhejiang Province", etc. For 20 years along Unibear's products were prevailingly spread all over Europe, America, Japan, Southeast Asia, Middle East and Africa, etc, attaining broad compliments from various customers of the world.

Unibear's product line consists of thousands of chains with 8 categories over 50 series, like transmission chain, conveyor chain, agriculture chain, hoist chain, specialized chain, steel-stainless chain, motorcycle chain, motorcycle sprocket, etc. They are broadly applied to machinery operation in mass industries of manufacturing, agriculture, forestry, mining, metallurgy, road-paving, oil-exploring, architecture, light industry, papermaking, household appliance, commodity, Foods, ceramics, environmental protection, garage, and so on.

Unibear will persist in the principle of "Quality assurance-oriented, in the spirit of continuous innovation", and guarantee for "Products to satisfy customers" to meet the various demand from both domestic and overseas customers with improved R&D and production capability, as well as upgraded after-sales service.



董事长:
President's Address: Clive Cao

1995

Establish YongLi Electric Appliance, specialized in producing chain components;



1999

- Renamed as Hangzhou Unibear Industrial Co. Ltd, Unibear Chinese and English logo registered globally
- Begin the production of motorcycle chain, industry chain, agriculture chain and non-standardized chain, etc.
- Construct domestic 1st stage factory building; set up Inspection Center and Technology R&D Center



2004

Construct domestic 2nd stage factory building; Found company's CPC party branch; Set up staff entertainment centre



2010

- Establish Oditer Trading Company, and Baihehui wine cellar
- Set up sprocket and cold-heading plant



2014

- Crowned as "Famous Brand in Hangzhou Exports"
- Establish Unibear Holding Group
- Chairman Clive Cao titled as "The 10th Outstanding Entrepreneur in Hangzhou"



2015

Construct domestic 3rd stage factory building, approved as the S&T innovation park



2016

- Set up new plants for sprocket, leaf chains, escalator chains
- Chairman Clive Cao crowned as "The Philanthropist"



National & Provincial Authoritative Qualification



Brand & Trademark Class



Industry Association Class



Social Responsibility & Honor



Quality Management System



Environment Management System



Occupational Health and Safety Management System





For two decades, our products were imported to over 60 countries worldwide, prevailingly spread all over Europe, America, Japan, Southeast Asia, Middle East and Africa, etc. attaining broad compliments from various customers of the world.

Global OEM Partners



- ✓ Fine-quality alloy-steel material;
- ✓ Super wear-resistant and prolonged service life;
- ✓ Higher tensile strength and fatigue resistance;
- ✓ Advanced heat treatment and surface polishing technique;
- ✓ 100% pre-stretch, decreasing chain's elongation;
- ✓ Innovative sprocket fine blanking of "Once-Punch-Forming" technology;



Transmission Chain



Conveyor Chain



Agricultural Chain



Hoist Chain



Specialized Chain



Stainless Steel Chain



Motorcycle Chain



Motorcycle Sprocket
UNIBEAR 5-6

ADVANCED PRODUCTION EQUIPMENT

先进的生产设备



Steel strip
Semi-finished products warehouse



200T high speed press



Japan-imported slow-feeding wire-cutting machine



Digital controlled lathe



Automatic pin cutting machine



Bush-curling Workshop



Automatic chamfering machine



Laser marking machine



Automatic mesh belt conveyor furnace
(Factory one)



Automatic mesh belt conveyor furnace
(Factory two)



Sprocket - Automatic digital-controlled
large tonnage precise lathe(1)



Sprocket - Automatic digital-controlled
large tonnage precise lathe(2)

ADVANCED PRODUCTION EQUIPMENT

EXCELLENT TESTING DEVICES



High speed assembling machine



Inspection of missing parts



Automatic assembling line



Well-finished pin quad rivet machine



Testing Center



Chemical analysis platform



Material chemical analysis machine
Material chemical tester



Metalloscope

AUTOMATIC ASSEMBLY LINE FLOW CHART

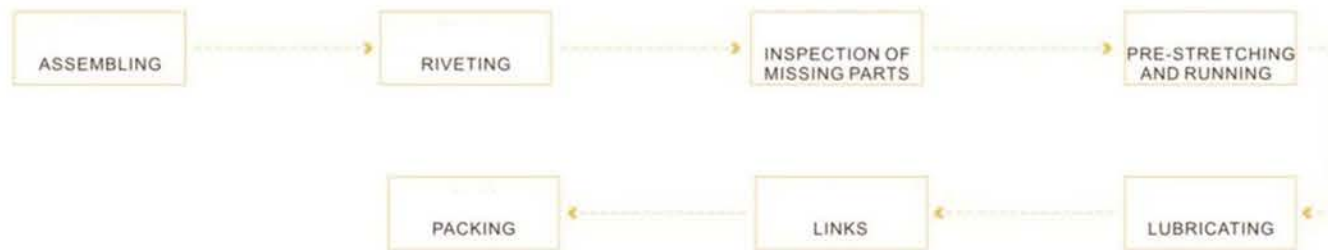

Note: 1. Pre-stretching and running at 60% of the tensile strength, it solves the problem of elongation of the chain in the initial stage of use.

2. We use the grease JS003 from Taiwan which guarantees the wear-resistance of the chain.



HV-5 hardness tester



Microh

EXCELLENT TESTING DEVICES

完善的检测设备



Shore (Rubber) hardness tester



HV-1 Micro-Vickers hardness tester



Shot peening strength tester



Chain twist testing machine



200KN high frequency fatigue testing machine



50KN Press-outforce tester



Surface roughness tester



Carbon sulfur automatic analyzer
Metallographic pre-grinding machine



Metallographic polishing machine



Instrument for measuring chain length



Hydraulic universal material testing machine



200KN material tensile strength testing machine



Profile projector



Image measuring instrument



Large scale photographic metalloscope



Spectromax



Mid-speed chain abrasion testing machine



Mid-speed chain abrasion testing machine

PRODUCT CHAPTER



Standard link plate

Wide-waist link plate contours

Design of link plate waist
Increase in width of waist for combating fatigue.



Ball drift
The plate holes are finally ball-burnished to assure maximum resistance to fatigue failure.

Shot Peened Parts
Link plates and rollers are shot peened for greater fatigue strength.

<h1 style="font-size: 48px;">A</h1> <p>015-016</p> <p>MOTORCYCLE TRANSMISSION CHAIN</p>		<h1 style="font-size: 48px;">B</h1> <p>017-018</p> <p>X-RING CHAIN O-RING CHAIN</p>		<h1 style="font-size: 48px;">C</h1> <p>019-020</p> <p>MOTORCYCLE ENGINE MECHANISM CHAIN TIMING CHAIN</p>		<h1 style="font-size: 48px;">D</h1> <p>021-022</p> <p>SILENT MOTORCYCLE CHAIN</p>		<h1 style="font-size: 48px;">E</h1> <p>023-034</p> <p>MOTORCYCLE SPROCKET KITS</p>		<h1 style="font-size: 48px;">F</h1> <p>035-040</p> <p>MOTORCYCLE SPROCKET AND GEAR</p>	
---	--	---	--	--	--	---	--	--	--	--	--

China's No.1 Innovation & High Quality Motorcycle Chains and Sprockets

- Innovatively researching and developing the "Once-Punch-Forming" technology for teeth shape;
- Fit clearance between chain roller and sprocket teeth arcs $\leq 0.05\text{mm}$, superior to domestic competitors (0.3-0.5mm) by 80%, without noise during meshing operation;
- Japan-imported slow-feeding wire-cutting machine for teeth punching mould, with advanced punching technique, teeth arc roughness $\leq 1.6\mu\text{m}$, 50% lower than domestic competitors' roughness ($\leq 3.2\mu\text{m}$) produced with traditional gear hobbing technique, even much superior to national standard ($\leq 6.4\mu\text{m}$), greatly improving wear-resistance and prolonging service life;
- Heat treatment by automatic mesh belt conveyor furnace, teeth surface hardness reaching 56-62HRC, using imported high-tech grease, increasing wear-resistance by 50%, 30,000km guaranteed
- Advanced "Once-Punch-Forming" technology, ensuring concentricity between teeth panel and central hole $\leq 0.05\text{mm}$, rolling teeth $\leq 0.2\text{mm}$, increasing meshing stability between chain and sprocket, preventing chain bouncing and noise occurred;
- Surface stoving varnish technique, such as red, yellow, orange, green, blue, black, etc. meeting various appearance demands;
- Motorcycle chain plate surface electroplated with copper, zinc, nickel, chrome, etc. ensuring chain more corrosion-resistant and modifying visual effect
- High quality alloy steel selected, through heat treatment by automatic mesh belt conveyor furnace, surface centerless grind and shot-peening technique, greatly improving tensile strength and fatigue resistance



Unibear

VS



Competitors

Innovative "Once-Punch-Forming" fine blanking technology (teeth arc roughness $\leq 1.6\mu\text{m}$), with smooth and good burnishing band, without noise during meshing operation; improving wear-resistance and prolonging service life.

Traditional gear hobbing technique (teeth arc roughness $\leq 6.4\mu\text{m}$), with rough and bad burnishing band, noise occurred during operation, easily worn off and reducing service life.



UNIBEAR 13-14

Standard

UNIBEAR Chain No.	Pitch	Roller diameter	Width between inner plates	Pin diameter	Pin length		Inner plate depth	Plate thickness	Ultimate tensile strength	Average tensile strength	Fatigue
	P	d, max	b, min	Ld, max	max	L, max	h, max	T, mm	Q min, kn	Q, kn	max, kgf
	mm	mm	mm	mm	mm	mm	mm	mm	kn	kn	kgf
415	12.7	7.75	4.88	3.98	12.5	13.8	10.4	1.5	11.8	12.5	380
420	12.7	7.77	5.35	3.98	14.5	16.1	12	1.5	18	16.5	380
426	12.7	8.51	7.75	4.45	16.5	18.06	12	1.6	17.8	16.5	380
620	16.875	10.16	5.35	6.05	17.7	19	15	2	25.8	29.3	650
626	16.875	10.16	7.84	6.05	18.8	20.6	15	2.03	20.8	29	650
630	16.875	10.16	9.4	6.05	20.9	22.2	15	2	20.6	29.7	650
630	16.875	11.91	9.4	6.94	22.2	24	15	2.4	35	37	800

Standard & Reinforced are UNIBEAR economic motorcycle chain lines. With curled bushing, Standard & Reinforced Chains are designed for low performance motorcycles with medium and low capacity up to 250CC and mopeds.

* Outer Plate Color Available: Steel Natural Color; Black Finished; Blue Finished; Yellow Finished



Reinforced

UNIBEAR Chain No.	Pitch	Roller diameter	Width between inner plates	Pin diameter	Pin length		Inner plate depth	Plate thickness	Ultimate tensile strength	Average tensile strength	Fatigue
	P	d, max	b, min	Ld, max	max	L, max	h, max	T, mm	Q min, kn	Q, kn	max, kgf
	mm	mm	mm	mm	mm	mm	mm	mm	kn	kn	kgf
418H	12.7	7.75	4.88	3.98	13.1	14.8	11.8	1.5	15.6	15.1	380
420H	12.7	7.77	5.35	3.98	15.7	17.4	12	1.5	17	17.5	380
426H	12.7	8.51	7.75	4.45	18.3	19.8	12	2.03	20.8	21.4	450
620H	16.875	10.16	5.35	6.24	18.9	20.6	15	2.42	30	31	700
626H	16.875	10.16	7.84	6.24	20.4	22.2	15	2.42	30	31	700
630H	16.875	10.16	9.4	6.05	21.8	24.2	15	2.42	30	31.5	700

Dipped-plated, zinc-plated, nickel-plated and chrome-plated steels available

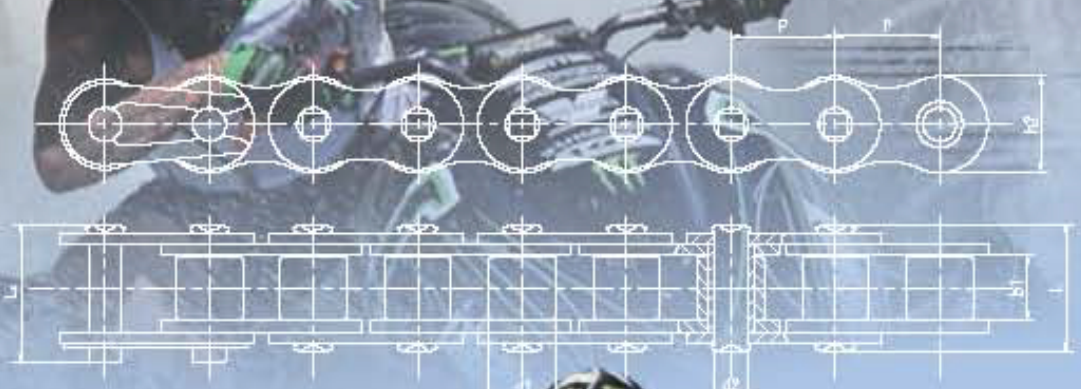

Super Professional

UNIBEAR CHAIN NO.	JAPAN CHAIN NO.	Pitch		Roller Dia.	Width between inner plates	Pin Dia.	Pin Length	Plate Thickness		Weight		Tensile Strength		Seal Type	Connecting Link		
		mm	in					inner	outer	100L	100L	KN	Lbs		O/X	Rivet	Clip
		mm	in					mm	mm	kg	lbs	KN	Lbs		O/X	Rivet	Clip
415MX	415MZ	12.70	1/2	7.75	4.78	3.98	13.30	0.924	1.30	1.50	0.70	1.34	19.00	4289.87	/	/	*
420MX	420MZ	12.70	1/2	7.77	5.25	3.98	16.70	0.619	1.80	1.80	0.81	1.79	21.00	4719.35	/	/	*
426MX	426MZ (426H)	12.70	1/2	8.51	7.75	4.45	17.80	0.701	1.80	1.80	0.89	2.15	22.00	5168.79	/	/	*
620MX	620MZ	16.875	5/8	10.16	6.35	5.34	18.90	0.798	2.20	2.20	1.78	3.88	39.00	8698.74	/	*	*
626MX	626MZ	16.875	5/8	10.16	7.86	5.34	20.80	0.798	2.20	2.20	1.87	4.12	39.00	8698.74	/	*	*
630MX	630MZ (630H)	16.875	5/8	10.16	9.40	5.34	21.80	0.851	2.20	2.20	1.98	4.37	39.00	8698.74	/	*	*
630MX	630MZ	16.875	5/8	11.91	9.40	5.34	22.80	0.850	2.42	2.42	2.74	6.04	36.00	8090.77	/	*	*

UNIBEAR Super are extra reinforced chains. With Solid Bushing & Through-hardened Roller, Super Chains perform with excellent response to wear and elongation. UNIBEAR Super Chains are suitable for standard as well as racing applications whenever O-Ring chain is not required.

* Outer Plate Color Available: Golden Finished; Silver Finished

O-Ring

UNIBEAR CHAIN NO.	JAPAN CHAIN NO.	Pitch		Roller Dia. mm	Width between inner plates mm	Pin Dia mm	Pin Length		Plate Thickness		Weight		Tensile Strength		Seal Type	Connecting Link		
		mm	in				mm	mm	mm	mm	mm	mm	100L	100L		KN	Lbs	O/X
		O-RING																
420UO	420V	12.70	1/2	7.77	6.35	3.96	19.00	0.749	1.80	1.80	0.93	2.05	19.80	4045.14	O	*	*	
428UO	428V	12.70	1/2	8.51	7.94	4.45	21.20	0.835	2.03	2.03	1.23	2.71	24.20	4944.06	O	*	*	
520UO	520V	15.875	5/8	10.16	6.40	5.24	20.80	0.820	2.20	2.20	1.86	4.10	39.60	8090.28	O	*	*	
525UO	525V	15.875	5/8	10.16	7.95	5.24	22.30	0.879	2.20	2.20	1.96	4.32	39.60	8090.28	O	*	*	
530UO	530(50)V	15.875	5/8	10.16	9.40	5.24	24.90	0.981	2.42	2.42	2.27	5.00	46.20	9438.66	O	*	*	
630UO	630V	19.05	3/4	11.91	9.40	5.94	25.40	1.001	2.42	2.42	2.91	6.42	53.90	11011.77	O	*	*	

MR/MRS

AR/ARS

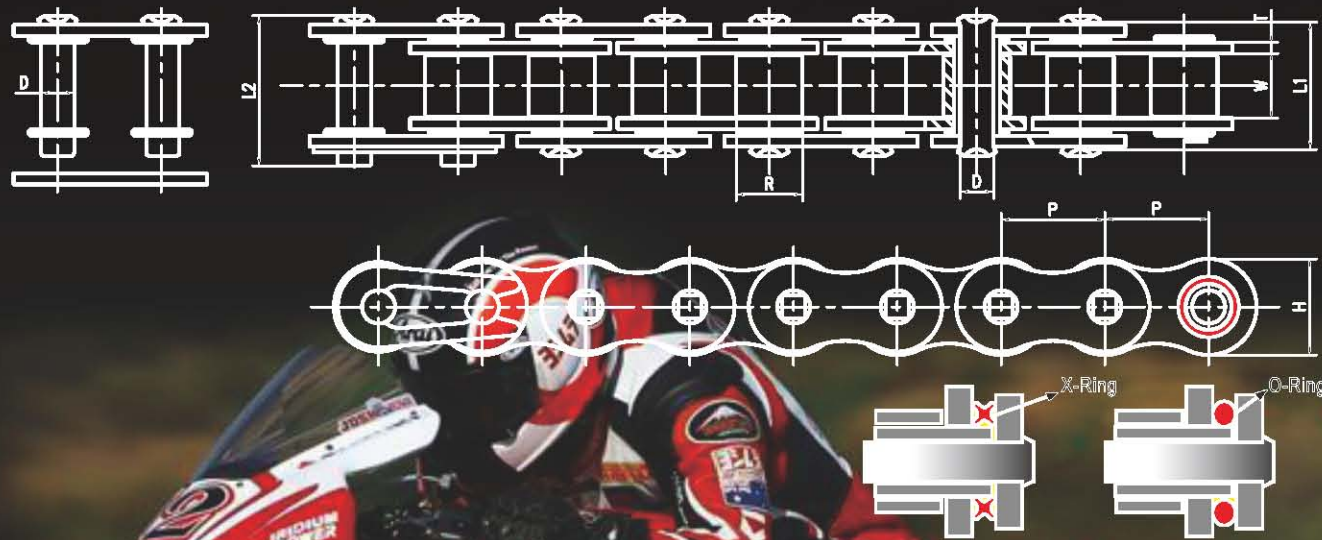

UNIBEAR O-Ring chain achieve permanent Lubrication Sealing between pin & bush which ensure with longer lifetime and minimum maintainance. With Solid Bushing, High Quality of Pin Material and 4-side riveting, UNIBEAR provide with both standard & reinforced O-Ring Chains. But UNIBEAR recommend reinforced O-Ring chains since it has even better performance which covers almost all the range of motorcycles.

* Outer Plate Color Available: Golden Finished; Silver Finished

* Painted Color Plate Available: Red, Yellow, Orange, Green, Blue

ATV X-Ring

UNIBEAR CHAIN NO.	JAPAN CHAIN NO.	Pitch		Roller Dia. mm	Width between inner plates mm	Pin Dia mm	Pin Length		Plate Thickness		Weight		Tensile Strength		Seal Type	Connecting Link		
		mm	in				mm	mm	mm	mm	100L	100L	KN	Lbs		O/X	Rivet	Clip
		X-RING																
420UX	420VM	12.70	1/2	7.77	6.35	3.96	19.00	0.749	1.80	1.80	0.93	2.05	19.80	4045.14	X	*	*	
428UX	428VM	12.70	1/2	8.51	7.94	4.45	21.20	0.835	2.03	2.03	1.23	2.71	24.20	4944.06	X	*	*	
520UX	520VM	15.875	5/8	10.16	6.40	5.24	20.80	0.820	2.20	2.20	1.86	4.10	39.60	8090.28	X	*	*	
525UX	525VM	15.875	5/8	10.16	7.95	5.24	22.30	0.879	2.20	2.20	1.96	4.32	39.60	8090.28	X	*	*	
530UX	530VM	15.875	5/8	10.16	9.40	5.24	24.90	0.981	2.42	2.42	2.27	5.00	46.20	9438.66	X	*	*	
630UX	630VM	19.05	3/4	11.91	9.40	5.94	28.60	1.127	3.25	3.25	2.91	6.42	53.90	11011.77	X	*	*	

UNIBEAR Connecting Links Option

Clip Type:
Clip type connecting link with loose fit. Can be installed easily with pliers.

Rivet Type:
Rivet type connecting link is the most dependable connecting link. Special riveting tool is required for installation.

Pin Link:
Pin link could obtain the same riveting as other links of your chain. Special tooling is required for installation.

UNIBEAR Chain Cutting Tool

UNIBEAR Chain Cutting Tool is machined from best hardened steel and, is designed to cut our chain pins when removing old chains. It's simple to use and easy to follow the instructions.

UNIBEAR X-Ring Chains are specially designed to be used on high powered as well as touring bikes. With a special 4-lips seal ring - X-Ring safely sealed lubrication inside the chain during its lifetime. With low frictional resistance, UNIBEAR X-Ring Chains operate much softer & cooler and, engaged better than traditional O-Ring chains. Also X-Ring increased the lifetime of the chain considerably as well.

UNIBEAR ATV Chains use low friction & long lifetime X-Ring and, its performance are good for all quad types.

- * Outer Plate Color Available: Golden Finished; Silver Finished
- * Painted Color Plate Available: Red, Yellow, Orange, Green, Blue

DOES YOUR CHAIN HAVE ALL THESE FEATURES?

UNIBear Quadra-X Ring seals reduce friction by 50% compared to conventional O-rings. They keep dirt out and the high-tech grease in.

Solid bushings and rollers are precision centerless ground and shot-peened, to minimize friction and maximize strength.

Sideplates made of high-strength, heat-treated alloy steel to resist chain stretch.

Protruding bushings help extend O-ring life and inhibit kinking.

Sideplate holes reduce weight, lower friction, dissipate heat, extend O-ring life, and facilitate self-cleaning

Pins are quad-staked to the sideplates for reliability.



UNIBear Chains new Zero Stretch Technology virtually eliminates measurable chain stretch in the first 1000 km of use. ZST puts an end to the hassle of retensioning the chain after the initial break-in period, when most chain stretch occurs. For racers, this can mean going several race weekends without a single chain adjustment. You also get the confidence of knowing that a chain with ZST will stay within wear tolerances throughout its entire service life. ZST is standard on the 530 ZZZ chain, and available as an option on the 520 RXO chain and all MVXZ series chains.

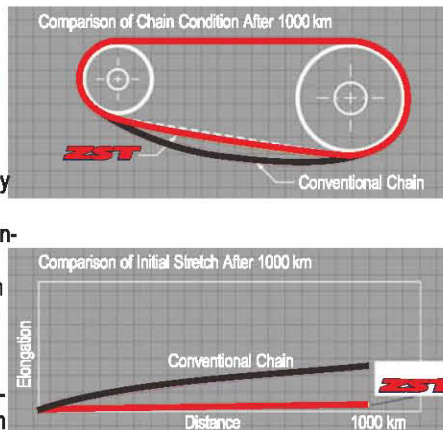

UNIBEAR QUADRA-X RINGS VS. O-RINGS

No one knows more about sealed chains than UNIBear. After all, we invented the O-ring chain for motorcycles way back in 1995. Since then, we've improved on our invention with the revolutionary Quadra-X Ring seal. The Quadra-X Ring reduces friction by as much as 50 percent, thanks to its smaller contact area. Yet it offers even better sealing than a conventional O-ring, because it has twice as many contact points between the ring and sideplates. It's the optimal combination of maximum sealing protection with minimum friction.

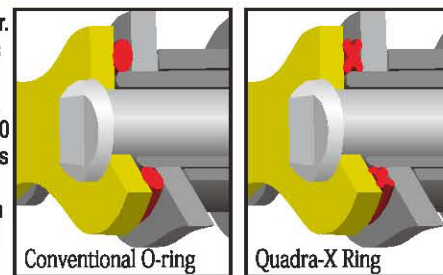

Many sealed chains are a trade-off. In the quest for low friction, the quality of the seal between the rings and sideplates is compromised. While such chains may offer lower friction initially, their loose tolerances ultimately lead to lubricant loss, premature wear, and increased friction in the long run. UNIBear Quadra-X Ring chains combine reduced friction and long wear-lab tests show that they last 50 percent longer than standard O-ring chains.

UNIBEAR CHAIN LIMITED WARRANTY

UNIBear O-ring and Quadra-X Ring Chains are warranted against defects in materials and workmanship for 24 months/unlimited mileage (street use) or 12 months/unlimited mileage (off-road use). The warranty period begins on the date shown on the sales invoice or receipt. This warranty is void for any use other than those applications recommended by UNIBear Chain. This warranty does not cover the use of UNIBear Chains in competitive events, or on motorcycles that have been modified.

TIMING CHAIN

	Pitch	Roller diameter	Width between inner plates	Pin diameter	Pin length	Inner plate depth	Ultimate tensile strength	Average tensile strength	Fatigue
UNIBear Chain No.	P mm	d, max mm	b, min mm	d, max mm	L max mm	h, max mm	Q min kn	Q _a kn	amx kgf
25	6.35	3.3	3.1	2.31	7.8	5.9	3.5	5.2	90
25H	6.35	3.3	3.18	2.31	9	5.9	4.8	5.2	100
25HX	6.35	3.3	3.18	2.31	9	5.9	6	6.5	100
25HD	6.35	3.3	3.18	2.31	9	5.9	6.2	6.8	100
219H	7.774	4.59	5	3.01	12	7.6	6.6	7.9	20
219SH	7.774	4.59	4.6	3.01	12.15	7.6	8.8	9.5	150
270H	8.5	5	4.75	3.58	13.3	8.45	9.8	12.5	180
06B	9.525	6.35	5.72	3.28	13.2	8.2	9	10.4	

Copper-plated, zinc-plated, nickel-plated and chrome-plated chain available

MOTORCYCLE CHAIN

UNIBEAR® **SLCC®**

SILENT CHAIN

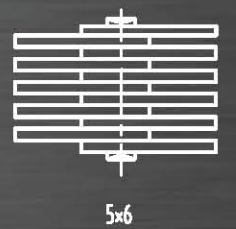
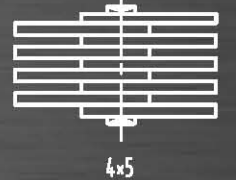
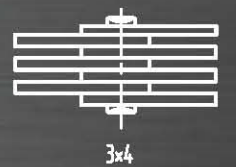
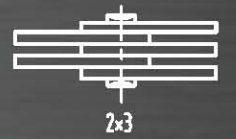
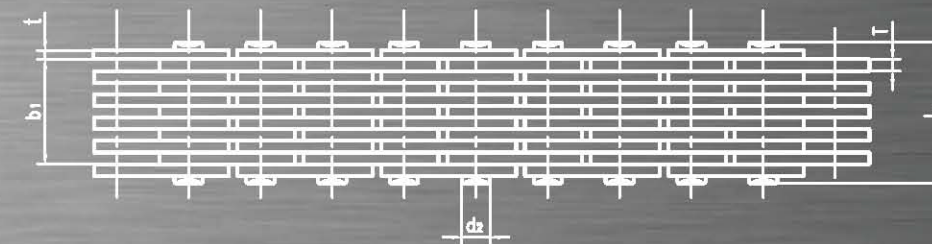
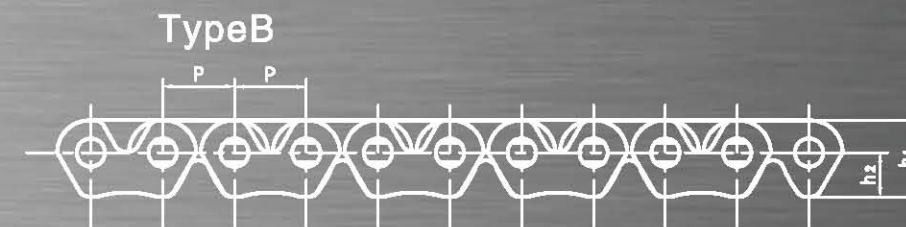
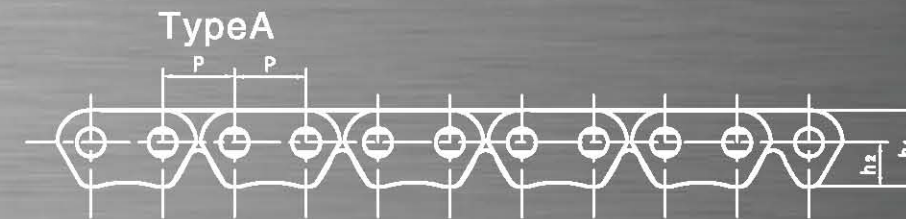

UNIBear Chain No.		Pitch	Chain Width	Pin diameter	Pin length	Distance from hole centre to tooth	Plates thickness	Ultimate tensile strength	Average tensile strength	Fatigue
		P	b ₁	d ₂ max	L	h ₁	T/t	Q _{min}	Q _a	amx
		mm	mm	mm	mm	mm	mm	kn	kn	kgf
2023LW	404LW	6.35	3.15	2.5	6.3	3.9	0.8	5	5.5	100
2034LW	409LW	6.35	5.2	2.5	8.4	3.9	0.8	7.6	8.2	150
2045LW	412LW	6.35	7.2	2.5	10.6	3.9	0.8	9	10.5	210
2023LN	404LN	6.35	3.15	2.5	6.3	3.9	0.8	5.2	5.5	115
2034LN	409LN	6.35	5.2	2.5	8.4	3.9	0.8	7.6	8.2	170
2045LN	412LN	6.35	7.2	2.5	10.6	3.9	0.8	9	9.5	240

Copper-plated, zinc-plated, nickle-plated and chrome-plated chain available

UNIBEAR MOTORCYCLE SPROCKET KITS

UNIBEAR® SLCC®

TRANSMISSION KITS



(item code)	型号(Model)		(Chain NO.)			(Sprockets)	
			(Reinforced)	(Normal)	(Links)	(Rear)	(Front)
UN 001	本田125	CG125	428H	428	100L	38T	15T
UN 002	五羊A	WY125A	428H	428	108L	38T	15T
UN 003	五羊B	WY125C	428H	428	108L	39T	15T
UN 004	富先达125-38T(大孔)	FXD125-38T	428H	428	108L	38T	15T
UN 005	富先达125-39T(大孔)	FXD125-39T	428H	428	108L	39T	15T
UN 006	富先达125-41T(大孔)	FXD125-41T	428H	428	116L	41T	15T
UN 007	富先达125-43T(大孔)	FXD125-43T	428H	428	116L	43T	15T
UN 008	富先达125-46T(大孔)	FXD125-46T	428H	428	116L	46T	15T
UN 009	本田飞鹰	WIN100	428H	428	108L	41T	14T
UN 010	铃木	GS100	428H	428	112L	42T	14T
UN 011	铃木王125	GN125	428H	428	116L	43T	14T
UN 012	豪爵125	QJ125	428H	428	116L	42T	14T
UN 013	钱江125-38T(小孔)	QJ125	428H	428	116L	38T	15T
UN 014	钱江125-39T(小孔)	QJ125	428H	428	116L	39T	15T
UN 015	钱江125-42T(小孔)	QJ125	428H	428	116L	42T	15T
UN 016	钱江125-43T(小孔)	QJ125	428H	428	116L	43T	15T
UN 017	钱江125-38T(大孔)	QJ125	428H	428		38T	15T
UN 018	钱江125-41T(大孔)	QJ125	428H	428	116L	41T	15T
UN 019	钱江125-43T(大孔)	QJ125	428H	428	116L	43T	15T
UN 020	本田王	CB125	428H	428	122L	42T	15T
UN 021	嘉陵125-42T	JHI125-42T	428H	428	112L	42T	15T
UN 022	嘉陵125-43T	JHI125-43T	428H	428	112L	43T	15T
UN 023	嘉陵125-46T	JHI125-46T	428H	428	112L	46T	15T
UN 024	Fb风暴150带罩	FBI150	428H	428	132L	42T	15T
UN 025	劲豹150	SRZ150	428H	428	132L	47T	15T
UN 026	嘉陵70	JH70		420	98L	41T	14T
UN 027	嘉陵90	JH90		420	100L	37T	14T
UN 028	太阳90	DY90		420	100L/102L	37T	14T
UN 029	太阳100	DY100	428H	428	100L	36TB	14T
UN 030	珠江125	ZJ125	428H	428	116L	139TA	15Ta
UN 031	珠江100	ZJ100	428H	428	100L	38T	14T
UN 032	捷达100	JD100	428H	428	108L	39T	14T
UN 033	捷达125-39T	JD125-39T	428H	428	116L	39T	15T
UN 034	捷达125-41T	JD125-41T	428H	428	112L	41T	15T
UN 035	捷达125-43T	JD125-43T	428H	428	116L	43T	15T
UN 036	捷达125-46T	JD125-46T	428H	428	116L	46T	15T
UN 037	珠江刀	ZJD	428H	428	116L	43T	15T
UN 038	风暴太子	FB150	428H	428	128L	42T含罩	15T
UN 039	钱江王	QJW	428H	428	116L	42T	15T
UN 040	豪爵-8(豪爵太子)	HJ125-8	428H	428	116L	42T	15T
UN 041	金城125	JC125	428H	428	122L	42T	15T
UN 042		QS110	428H	428	104L	35T	14T
UN 043		JY110	428H	428	108L	38T	14T
UN 044		JS110	428H	428	108L	35T	14T
UN 045	太阳100	DY110	428H	428	108L	38T	
UN 046	太阳100	DY100	428H	428	112L	41T	14T
UN 047		QJ125	428H	428	118L	45T	15T
UN 048	新大洲		428H	428	122L	46T	15T
UN 049	新大洲		428H	428	118L	43T	15T
UN 050	新大洲		428H	428	118L	41T	15T
UN 051		GT125	428H	428	116L	41T	14DY
UN 052		GT125	428H	428	116L	41T	14CG
UN 053		SY125	428H	428	116L	41T	15T
UN 054		JD125	428H	428	122L	45T	15T
UN 055		JYM	428H	428	122L	45T	14T

TRANSMISSION KITS FOR SOUTH AMERICA

(Item code)	(Model)	(Chain NO.)			(Sprockets)	
		(Reinforced)	(Normal)	(Links)	(Rear)	(Front)
UN 056	C 100DREAM	428H	428	96L	36T	14T
UN 057	C-100 BIZ	428H	428	108L	35T	15T
UN 058	C-125 BIZ	428H	428	108L	34T	14T
UN 059	POP 100	428H	428	106L	35T	14T
UN 060	WEB 100	428H	428	108L	36T	14T
UN 061	CBX 200	520H	520	104L	41T	13T
UN 062	CBX 250	520H	520	108L	38T	13T
UN 063	CBX 250 TWISTER	520H	520	108L	37T	13T
UN 064	HUNTER/MAX 100	428H	428	118L	39T	15T
UN 065	NX 150	428H	428	126L	48T	15T
UN 066	XR 200	520H	520	108L	43T	13T
UN 067	XR 250 TORNADO	520H	520	104L	38T	13T
UN 068	KATANA/YES 125	428H	428	116L	43T	14T
UN 069	TITAN/CG-125 99	428H	428	116L	43T	14T
UN 070	TITAN/CG-125 00	428H	428	116L	44T	14T
UN 071	TITAN/CG-150 04	428H	428	118L	43T	16T
UN 072	YBR-125 2000	428H	428	118L	43T	14T
UN 073	YBR-125	428H	428	118L	45T	14T
UN 074	FAZER 250	428H	428	132L	45T	15T
UN 075	NXR125 BROS	428H	428	132L	54T	17T
UN 076	NXR150 BROS	428H	428	130L	50T	17T
UN 077	MOBILETE	415H	415	104L	54T	11T
UN 078	XTZ 125	428H	428	126L	48T	14T
UN 079	XLS125	428H	428	124L	58T	14T
UN 080	XLR125	428H	428	126L	50T	15T
UN 081	CRYPTON 100	428H	428	98L	37T	15T
UN 082	AX100	428H	428	120L	42T	14T
UN 083	AX100	428H	428	108L	37T	14T
UN 084	FALCON 400	520H	520	106L	40T	15T
UN 085	RX100	428H	428	120L	39T	15T
UN 086	DR125	520H	520	104L	39T	12T
UN 087	XI125	428H	428	132L	45T	15T
UN 088	XI125	428H	428	132L	42T	15T
UN 089	XI125	428H	428	132L	37T	15T
UN 090	GN125	428H	428	120L	42T	15T
UN 091	CD110	428H	428	116L	38T	14T
UN 092	TVS	428H	428	112L	42T	14T
UN 093	BAJAJ	428H	428	114L	42T	14T

O/X-RING CHAIN FOR SOUTH AMERICA



(Item code)	(Model)	(Chain NO.)		(Links)
UN 094	Honda C-100 Dream	428UX	428UO	96L
UN 095	Yamaha Crypton 100	428UX	428UO	98L
UN 096	Honda C-100 Biz/Sundown Hunter-125	428UX	428UO	108L
UN 097	Honda CG/ML/Turuna-125'83	428UX	428UO	110L
UN 098	Honda CG/Today/Titan-125 Suzuki EN/Katana-125	428UX	428UO	116L
UN 099	Yamaha RD-135/RDZ-125/YBR-125 Honda CG-150	428UX	428UO	118L
UN 100	Yamaha RD-180/XT-225/TDM-225/RD/RDZ-135	428UX	428UO	120L
UN 101	Honda CBX Aero	428UX	428UO	122L
UN 102	Honda XL-125	428UX	428UO	124L
UN 103	Honda NX/CBX-150/XL/XLR-125 Agrale SXT-Yamaha-125	428UX	428UO	126L
UN 104	Yamaha XTZ-250-Lander	428UX	428UO	128L
UN 105	Honda NXR-150 Bros	428UX	428UO	130L
UN 106	Honda NXR-125 Bros/Yamaha YS250 Fazer	428UX	428UO	132L
UN 107	Honda NX-350 Sahara	520UX	520UO	98L
UN 108	Honda NX-400/NX/XLX-350 Suzuki GM-250 Yamaha DT-200	520UX	520UO	100L
UN 109	Honda XL/XLX-250/XR-200/NX-250/CB-400/Yamaha DT-200R Agrale Daker	520UX	520UO	102L
UN 110	Honda CBX 200 Strada/NX 200/XR250 Tornado/Yamaha Tenere-600-84-88	520UX	520UO	104L
UN 111	Honda XR-200	520UX	520UO	108L
UN 112	Honda CR-125/CR-250	520UX	520UO	110L
UN 113	Suzuki GS-500	520UX	520UO	112L
UN 114	Honda Virag0-250/Suzuki Intruder-250	520UX	520UO	114L
UN 115	Honda VT-600 Shadow	525UX	525UO	100L
UN 116	Honda CB-500'03	525UX	525UO	108L
UN 117		525UX	525UO	110L
UN 118	Honda CB-400/CB-600 HORNET	525UX	525UO	120L
UN 119	Honda CB-500/CBR-450 Shadow	530UX	530UO	102L
UN 120	Honda CB-400/450	530UX	530UO	110L
UN 121	Suzuki GS-500			

Copper-plated, zinc-plated, nickel-plated and chrome-plated chain available

TIMING CHAIN FOR SOUTH AMERICA

(item code)	(Model)	(Chain NO.)		(Links)
UN 122	Honda Biz/C-100 Dream	25H		84L
UN 123	Yamaha YBR-125 XTZ	25H		88L
UN 124	Honda ML/XL-250 Suzuki-125 Katana/Intruder/Yamaha Cryton/XLS/Turuna	25H		98L
UN 125	Yamaha TDM-225/XT-225	25H		104L
UN 126	YBR125/XTZ125	2023LW	404LW	90L
UN 127	Biz125	2023LW	404LW	92L
UN 128	Honda CG-150(TITAN150)	2023LN	404LN	94L
UN 129	DaelING Altino-100	2023LW	404LW	96L
UN 130	Honda NX/CBX150 Aero/NXR-150 Bros/ En150 YES	2023LW	404LW	100L
UN 131	Honda NX/CBX 200 Strada/Strada/ XR-200	2023LW	409LW	102L
UN 132	Fazer 250/Lander 250	2023LW	409LW	104L
UN 133	Kasinski Midas FX	2023LW	409LW	92L
UN 134	Kasinski RX/GF/Cruise-125	2034LN	409LN	98L
UN 135	Kasinski Cruise 125i	2024LN	409LN	100L
UN 136	Honda Nx4 Falcon,kasinski Midas-110/NX400 Falcon	2024LN	409LN	112L
UN 137	Shadow 600	2024LN	409LN	118L
UN 138	Kasinski Midas 250	2024LN	409LN	124L
UN 139	Honda XR/Tornado/CBX/Twister-250 kasinski Midas-250	2034LN	409LN	128L
UN 140	Honda CBX-150	2045LW	412LW	100L
UN 141	Honda CBX-200/NX200	2045LW	412LW	102L
UN 142	Honda XLR-250	2045LW	412LW	104L
UN 143	Honda XLR-250/XLX/NX/Sahara-350	2045LW	412LW	108L
UN 144	Honda CB-400/450	2045LW	412LW	110L
UN 145	Intruder 250	2045LW	412LW	112L
UN 146	CBR 900	2045LW	412LW	116L
UN 147	Tenere	2045LW	412LW	126L
UN 148	Honda CB-500	2045LW	412LW	130L
UN 149	XTZ 750	2045LW	412LW	138L
UN 150				

MOTORCYCLE CHAIN FOR SOUTH AMERICA

(item code)	(Model)	(Chain NO.)		(Links)
UN 151	CALOI MOBILETTE/Ciclomotor	415	415H	104L
UN 152	HONDA C-100 DREAM	428	428H	96L
UN 153	YAMAHA CRYPTON 100	428	428H	98L
UN 154	HONDA C-125 DREAM	428	428H	100L
UN 155	HONDA CG, ML-125 & YAMAHA TT125,RX125	428	428H	102L
UN 156	HONDA C 125 BIZ	428	428H	106L
UN 157	HONDA C 100 BIZ	428	428H	108L
UN 158	HONDA CG, ML-125, TURUNA 1983	428	428H	110L
UN 159	HONDA CARGO, TODAY, TITAN 125 - SUZUKI KATANA 125	428	428H	116L
UN 160	HONDA CG 150, YAMAHA RD, RDZ 125, YBR 125	428	428H	118L
UN 161	YAMAHA RD, RDZ 125, DT, DTN-180, XT-225	428	428H	120L
UN 162	HONDA CBX 150 Aero	428	428H	122L
UN 163	HONDA XL 125S	428	428H	124L
UN 164	HONDA NX 150, CBX 150, XLR 125, XL 125	428	428H	126L
UN 165	HONDA NX 125 BROSS	428	428H	130L
UN 166	HONDA NX-150 BROSS	428	428H	132L
UN 167	CBX 250 STRADA	428	428H	134L
UN 168	HONDA NX 350/400 FALCON & YAMAHA Di200	520	520H	100L
UN 169	HONDA XL, XLX 250, XR 200 - YAMAHA DT 200R	520	520H	102L
UN 170	HONDA CBX, NX 200 - YAMAHA TENERE 600	520	520H	104L
UN 171	HONDA CBX250 TWISTER, XR 250 TORNADO, YAMAHA RD 350, XT 600	520	520H	106L
UN 172	HONDA XR, NX 200	520	520H	108L
UN 173	CR 125/250/GS 500	520	520H	110L
UN 174	RM 250	520	520H	112L
UN 175	YAMAHA VIRAGO 250	520	520H	114L
UN 176	MOTOCICLETA COMPETIO	520	520H	116L
UN 177	HONDA SHADOW 600	525	525H	100L
UN 178	HONDA CB 500	525	525H	120L
UN 179	HONDA CB 400, CBX 450	530	530H	102L
UN 180	HONDA CB 750 FOUR	530	530H	106L
UN 181	HONDA CBR 600F	530	530H	108L
UN 182	SUZUKI GS 500	530	530H	110L
UN 183	HONDA CBX 750, CBR 1000	530	530H	114L

CHAIN KITS FOR MALAYSIA

Chain kits for Malaysia						
(item code)	(Model)	(Chain NO.)			(Sprockets)	
		(Reinforced)	(Normal)	(Links)	(rear)	(front)
UN 184	EX-5	428H	428	96L	36T	14T
UN 185	WAVE	428H	428	104L	35T	14T
UN 186	WAVE R	428H	428	106L	36T	14T
UN 187	WAVE 100	428H	428	100L	36T	14T
UN 188	WAVE 125	428H	428	108L	36T	14T
UN 189	Y100	428H	428	100L	38T	14T
UN 190	RXZ(1)	428H	428	120L	38T	15T
UN 191	RXZ(2)	428H	428	120L	39T	15T
UN 192	LC135	428H	428	112L	39T	15T
UN 193	SMASH	428H	428	102L	36T	14T
UN 194	RC	428H	428	102L	36T	14T
UN 195	RG	428H	428	128L	38T	14T
UN 196	LEGENDA	428H	428	104L	36T	15T
UN 197	TZM	428H	428	132L	47T	16T
UN 198	KLISS 1	428H	428	108L	38T	14T
UN 199	MODENAS KLISS 1	428H	428	108L	40T	14T
UN 200	CD70	420H	420	100L	36T	14T
UN 201	DREAM	428H	428	100L	36T	14T
UN 202	TUKTUK	428H	428	112L	43T	13T

CHAIN KITS FOR AFRICA

Chain kits for Africa					
(item code)	(Model)	(Chain NO.)			(Sprockets)
		(Reinforced)	(Normal)	(Links)	
UN 203	KB100	428H	428	112	13T*42T
UN 204	KB4S	428H	428	112	13T*44T
UN 205	TVS SAMURAI	428H	428	112	13T*41T
UN 206	HERO GONDA GN5	428H	428	106	14T*44T
UN 207	HERO GONDA GN5	428H	428	112	14T*44T
UN 208	AX100	428H	428	112	14T*42T
UN 209	CD80	420H	420	100	14T*39T
UN 210	CG125	428H	428	100	15T*38T
UN 211	RX115	428H	428	108	15T*38T
UN 212	CD70CDI	420H	420	104	14T*41T
UN 213	YB100	420H	420	100	15T*37T
UN 214	CD70F	420H	420	100	14T*41T
UN 215	CBZ	428H	428	112	14T*46T
UN 216	KB4S	428H	428	112	13T*44T
UN 217	KB100	428H	428	112	13T*42T
UN 218	RX115	428H	428	108	15T*38T
UN 219	AX100	428H	428	112	14T*42T
UN 220	H100S	428H	428	106	14T*35T
UN 221	CG125	428H	428	108	15T*38T
UN 222	CD80	420H	420	100	14T*39T
UN 223	HERO HONDA	428H	428	112	14T*44T
UN 224	YB100	420H	420	100	15T*37T
UN 225	RS125	428H	428	110	15T*35T
UN 226	KMW4冲程	428H	428	100	14T*35T
UN 227	KMW2冲程	428H	428	100	14T*35T
UN 228	CD70F	420H	420	104	14T*41T
UN 229	YB100	420H	420	100	15T*37T
UN 230	A80	420H	420	106	14T*35T

CHAIN KITS FOR INDONESIA

Chain kits for Indonesia						
(item code)	(Model)	(Chain NO.)			(Sprockets)	
		(Reinforced)	(Normal)	(Links)	(rear)	(front)
UN 231	TIGER	520H	520	106	43T	13T
UN 232	KARISMA	428H	428	104	35T	14T
UN 233	GRAND	428H	428	100	36T	14T
UN 234	SUPRA FIT NEW	428H	428	106	36T	14T
UN 235	SUPRA X	428H	428	104	35T	14T
UN 236	SUPRA X125	428H	428	104	40T	15T
UN 237	SHOGUN 125	428H	428	102	35T	14T
UN 238	SHOGUN SP	428H	428	100	35T	14T
UN 239	SMASH NEW	428H	428	100	35T	14T
UN 240	SMASH NEW	428H	428	104	36T	14T
UN 241	SATRIA	428H	428	128	43T	14T
UN 242	SATRIA FU150	428H	428	120	43T	14T
UN 243	THUNDER 125	428H	428	120	45T	14T
UN 244	RXK NEW	428H	428	110	37T	14T
UN 245	RXS	428H	428	110	37T	15T
UN 246	WIN	428H	428	110	40T	14T
UN 247	FORCE 1	428H	428	100	39T	14T
UN 248	VEGA ZR	420H	420	108	40T	15T
UN 249	VEGA-R NEW	428H	428	104	35T	15T
UN 250	JUPITER Z	428H	428	104	36T	15T
UN 251	JUPITER MX	428H	428	112	39T	15T
UN 252	SCORPIO Z	428H	428	120	44T	15T
UN 253	BLADE	428H	428	104	36T	14T
UN 254	BLITE	428H	428	104	36T	14T
UN 255	MEGA PRO	428H	428	112	46T	14T
UN 256	GLPRO	428H	428	110	45T	15T
UN 257	NINJA	428H	428	122	42T	14T
UN 258	V-LXION	428H	428	120	42T	14T
UN 259	NINJA RR	520H	520	104	39T	14T
UN 260	ZX 130	428H	428	108	42T	14T
UN 261	GL 100	428H	428	100	38T	15T
UN 262	KAZE NEW	428H	428	110	42T	14T
UN 263	PRO NEOTECH	428H	428	112	46T	14T
UN 264	CRYPTON/VEGA	428H	428	100	37T	15T
UN 265	GLPRO NEOTECH	428H	428	112	46T	14T
UN 266	BLADE	428H	428	102	37T	14T
UN 267	REVO ABSOLUTE CS1	428H	428	116	42T	14T

CHAIN KITS FOR BURMA

Chain kits for Burma						
(item code)	(Model)	(Chain NO.)			(Sprockets)	
		(Reinforced)	(Normal)	(Links)	(rear)	(front)
UN 268	C90	420H	420	100L	39T	15T
UN 269	W110 (DY100)	428H	428	104L	36T	14T
UN 270	W110 (DY100)	428H	428	106L	36T	14T
UN 271	W125A (DY100) 大孔、小孔	428H	428	108L	38T	14T
UN 272	W125A (DY100)	428H	428	108L	41T	13T
UN 273	W125A (DY100)	428H	428	108L	44T	13T
UN 274	W125A (DY100)	428H	428	108L	46T	13T

CHAIN KITS FOR PAKISTAN

Chain kits for Pakistan						
(item code)	(Model)	(Chain NO.)			(Sprockets)	
		(Reinforced)	(Normal)	(Links)	(rear)	小齿(front)
UN 275	C50Z	420H	420	100L	36T	14T
UN 276	CD70/CDI	420H	420	104L	41T	14T
UN 277	CD70F	420H	420	100L	41T	14T
UN 278	CG125	428H	428	100L	38T	15T
UN 279	CG125DX	428H	428	108L	38T	14T
UN 280	CG125 NEW	428H	428	108L	38T	15T
UN 281	CD185	428H	428	112L	34T	15T
UN 282	YB100	420H	420	100L	37T	15T
UN 283	YD100	420H	420	102L	37T	14T(15T)
UN 284	SOHRAB-1/W	420H	420	100L	37T	14T
UN 285	SOHRAB-1/S	420H	420	100L	37T	14T
UN 286	SOHRAB	420H	420	104L	37T	14T
UN 287	SD110	428H	428	104L	37T	15T
UN 288	CD100	428H	428	108L	43T	14T
UN 289	CG125 伊朗	428H	428	102L	38T	15T

CHAIN KITS FOR CAMBODIA

Chain kits for Cambodia						
(item code)	(Model)	(Chain NO.)			(Sprockets)	
		(Reinforced)	(Normal)	(Links)	(rear)	(front)
UN 290	C700	420H	420	100L	36T	14T
UN 291	DREAM	428H	428	100L	36T	14T
UN 292	SMASH	428	428	100L	36T	14T
UN 293	VIVA	428H	428	100L	36T	14T
UN 294	WAVE 2004	428	428	104L	35T	14T
Chain kits for Cambodia						
UN 295		25H		82L		
UN 296		25H		84L		
UN 297		25H		88L		
UN 298		25H		90L		
UN 299		2023LW	404LW	88L		
UN 300		2023LW	404LW	90L		
UN 301		2023LW	404LW	92L		
UN 302		2034LW	409LW	94L		
UN 303		2034LW	409LW	98L		
UN 304		2045LW	412LW	104L		
UN 305		420H	420	88L		
UN 306		420H	420	100L		
UN 307		420H	420	104L		
UN 308		428H	428	100L		
UN 309		428H	428	104L		
UN 310		428H	428	106L		
UN 311		428H	428	108L		
UN 312		428H	428	112L		
UN 313		428H	428	120L		
UN 314		520H	520	110		

CHAIN KITS FOR INDIA

Unibear Chain Kit for India						
(item code)	(Model)	(Chain NO.)			(Sprockets)	
		(Reinforced)	(Normal)	(Links)	(rear)	(front)
UN317		100CC				
UN318	BAJAJ KB100	428H	428	112L	42T	13T
UN319	BAJAJ KB 4S/BOXER	428H	428	112L	44T	13T
UN320	BAJAJ BYK	428H	428	102L	44T	13T
UN321	BAJAJ CALIBER	428H	428	116L	44T	13T
UN322	BAJAJ CALIBER CROMA	428H	428	116L	44T	13T
UN323	BAJAJ BOXER AR CT/CT-100	428H	428	114L	47T	13T
UN324	BAJAJ NEW CT-100	428H	428	112L	42T	14T
UN325	BAJAJ PLATINA	428H	428	118L	42T	14T
UN326	HERO HONDA CD100	428H	428	106L	44T	14T
UN327	HERO HONDA PASSION	428H	428	108L	44T	14T
UN328	HERO HONDA PASSION PLUS NEW	428H	428	108L	44T	14T
UN329	HERO HONDA STREET	428H	428	100L	36T	14T
UN330	HERO HONDA JOY	428H	428	106L	42T	14T
UN331	HERO HONDA SPLENDOR(108)	428H	428	108L	45T	14T
UN332	HERO HONDA SPLENDOR Y2k	428H	428	106L	43T	14T
UN333	HERO HONDA SPLENDOR PLUS	428H	428	106L	43T	14T
UN334	TVS SUZUKI AX 100	428H	428	112L	41T	13T
UN335	TVS SAMURAL	428H	428	112L	41T	13T
UN336	TVS CENTRA	428H	428	102L	41T	14T
UN337	TVS STAR	428H	428	112L	44T	14T
UN338	TVS STAR CITY / DELUXE	428H	428	110L	41T	13T
UN339	YAMAHA RX100	428H	428	110L	39T	15T
UN340	YAMAHA RXG	428H	428	110L	37T	15T
UN341	BAJAJ CALIBER 115	428H	428	116L	43T	13T
UN342	BAJAJ DISCOVER	428H	428	122L	45T	14T
UN343	BAJAJ DISCOVER(110CC)	428H	428	120L	42T	14T
UN344	BAJAJ DISCOVER(125CC)	428H	428	120L	42T	14T
UN345	BAJAJ DISCOVER UG (Alloy wheel)	428H	428	122L	45T	14T
UN346	BAJAJ WIND 125	428H	428	118L	44T	14T
UN347	HERO HONDA SUPER SPLENDOR	428H	428	108L	42T	14T
UN348	HERO HONDA GLAMOUR	428H	428	108L	43T	14T
UN349	HONDA SHINE	428H	420	116L	41T	14T
UN350	KINETIC CHALLENGER / BOSS	428H	428	108L	45T	14T
UN351	LML FREEDOM	428H	428	114L	40T	14T
UN352	SUZUKI HEAT / ZEUS	428H	428	114L	40T	14T
UN353	TVS SHOGUN	428H	428	112L	44T	13T
UN354	TVS VICTOR / VICTOR GL	428H	428	106L	43T	13T
UN355	TVS VICTOR GLX	428H	428	112L	41T	13T
UN356	TVS VICTOR GX	428H	428	110L	43T	13T

CHAIN KITS FOR VIETNAM

Unibear Chain Kit for Vietnam						
(item code)	(Model)	(Chain NO.)			(Sprockets)	
		(Reinforced)	(Normal)	(Links)	(rear)	(front)
UN315	DY100	428H	428	100L	36T	14T
UN316		428H	428	102L	36T	14T

CHAIN KITS FOR INDIA

(Item code)	(Model)	(Chain NO.)			(Sprockets)	
		(Reinforced)	(Normal)	(Links)	(rear)	(front)
UN 357	YAMAHA CRUX	428H	428	112L	42T	14T
UN 358	YAMAHA LIBERO	428H	428	118L	45T	14T
UN 359	YAMAHA ENTICER	428H	428	130L	47T	15T
UN 360	YAMAHA YBX / YD 125	428H	428	112L	44T	14T
UN 361	BAJAJ PULSAR 150	428H	428	114L	42T	15T
UN 362	BAJAJ PULSAR180	428H	428	112L	42T	15T
UN 363	BAJAJ PULSAR DTSI (150/180)	428H	428	122L	42T	15T
UN 364	BAJAJ PULSAR UG (Alloy wheel)	428H	428	124L	44T	15T
UN 365	BAJAJ PULSAR NEW (180cc)	428H	428	124L	43T	15T
UN 366	BAJAJ PULSAR (180cc)	428H	428	124L	44T	15T
UN 367	BAJAJ AVENGER	428H	428	124L	42T	14T
UN 368	ESCORTS RAJDOOT NEW 175CC	428H	428	122L	47T	14T
UN 369	ESCORTS RAJDOOT OLD 175CC	428H	428	122L	47T	14T
UN 370	HERO HONDA ACHIEVER	428H	428	120L	42T	15T
UN 371	HERO HONDA CBZ	428H	428	128L	46T	14T
UN 372	HERO HONDA AMBITION	428H	428	116L	38T	14T
UN 373	HERO HONDA KARIZMA	428H	428	108L	40T	13T
UN 374	HONDA UNICORN	428H	428	126L	42T	15T
UN 375	LML ADRENO / ENERGY	428H	428	116L	40T	14T
UN 376	TVS FIERO	428H	428	110L	39T	13T
UN 377	TVS FIERO F2	428H	428	116L	40T	13T
UN 378	TVS FIERO FX	428H	428	118L	40T	13T
UN 379	TVS APACHE	428H	428	118L	43T	13T
UN 380	YAMAHA RX 135	428H	428	108L	34T	16T
UN 381	BAJAJ M80-4S	428H	428	100L	44T	13T
UN 382	BAJAJ M80 (NEW)	428H	428	104L	36T	17T
UN 383	BAJAJ M80 (FLAT)	428H	428	104L	36T	17T
UN 384	BAJAJ M80 (OLD)	428H	428	104L	36T	17T
UN 385	HERO PUCH - ECONOMY	415H	415	94L	33T	13T
UN 386	HERO PANTHER (OLD)	415H	415	100L	48T	12T
UN 387	HERO PANTHER (NEW)	428H	428	100L	48T	12T
UN 388	HERO PANTHER 4S	428H	428	100L	40T	14T
UN 389	BULLET 350CC(NEW)	530H	530	94L	38T	16T
UN 390	TVS 50 XL	415H	415	112L	52T	13T
UN 391	TVS 50 XT	415H	415	106L	47T	13T
UN 392	TVS XL-SUPER	415H	415	112L	50T	13T
UN 393	TVS XL-SUPER (NEW)	415H	415	112L	50T	13T
UN 394	TVS XL HEAVY DUTY	420H	420	112L	50T	13T
UN 395	TVS XL HEAVY DUTY (E)	415H	415	112L	50T	13T
UN 396	TVS DURO XL SUPER (HD)	420H	420	112L	50T	13T
UN 397	TVS DURO XL SUPER HD Upgrade New	420H	420	110L	50T	13T

UNIBEAR®

MOTORCYCLE SPROCKETS

STREET / OFF-ROAD / MOTOCROSS / ATV / ROADRACING / DRAGRACING

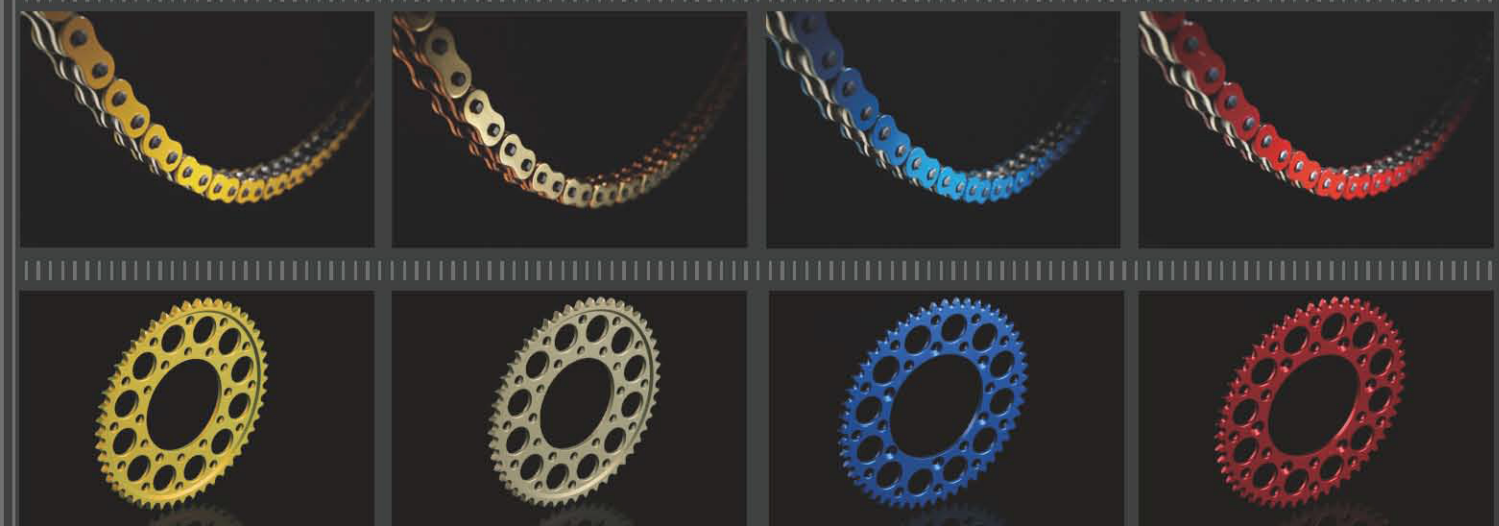

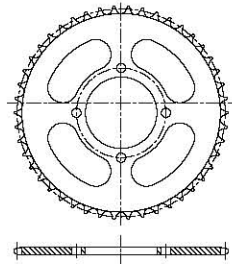

型号Model: FXD 125

齿数Teeth Number: Z 46
 齿顶圆直径Outside Diameter: D Ø192.5MM
 中心孔直径Center Hole: D Ø64MM
 齿根圆直径Root Diameter: D1 Ø177.6MM
 齿厚Tooth Thickness: 7MM
 定位孔中心距Center Distance: Ø80MM

定位孔直径Pilot Hole Diameter: Ø8.5MM
 材质Material: 1045#
 硬度Hardness: HRB70-80
 节距Pitch: P12.7MM
 滚子直径Roller Diameter: Dr8.51MM
 适配ISO链号Adaptive ISO Chain Number: 08B

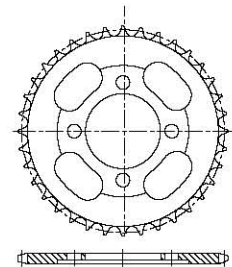

型号Model: DY 100

齿数Teeth Number: Z 36
 齿顶圆直径Outside Diameter: D Ø152.01MM
 中心孔直径Center Hole: D Ø54MM
 齿根圆直径Root Diameter: D1 Ø137.2MM
 齿厚Tooth Thickness: 7MM
 定位孔中心距Center Distance: Ø70MM

定位孔直径Pilot Hole Diameter: Ø8.5MM
 材质Material: 1045#
 硬度Hardness: HRB70-80
 节距Pitch: P12.7MM
 滚子直径Roller Diameter: Dr8.51MM
 适配ISO链号Adaptive ISO Chain Number: 08B

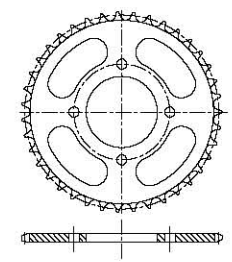

型号Model: JD 125

齿数Teeth Number: Z 39
 齿顶圆直径Outside Diameter: D Ø164.17MM
 中心孔直径Center Hole: D Ø58MM
 齿根圆直径Root Diameter: D1 Ø149.31MM
 齿厚Tooth Thickness: 7MM
 定位孔中心距Center Distance: Ø78MM

定位孔直径Pilot Hole Diameter: Ø8.5MM
 材质Material: 1045#
 硬度Hardness: HRB70-80
 节距Pitch: P12.7MM
 滚子直径Roller Diameter: Dr8.51MM
 适配ISO链号Adaptive ISO Chain Number: 08B

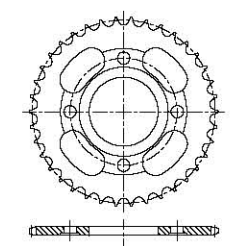

型号Model: WY 125

齿数Teeth Number: Z 38
 齿顶圆直径Outside Diameter: D Ø160.12MM
 中心孔直径Center Hole: D Ø58MM
 齿根圆直径Root Diameter: D1 Ø145.28MM
 齿厚Tooth Thickness: 7MM
 定位孔中心距Center Distance: Ø90MM

定位孔直径Pilot Hole Diameter: Ø10.5MM
 材质Material: 1045#
 硬度Hardness: HRB70-80
 节距Pitch: P12.7MM
 滚子直径Roller Diameter: Dr8.51MM
 适配ISO链号Adaptive ISO Chain Number: 08B

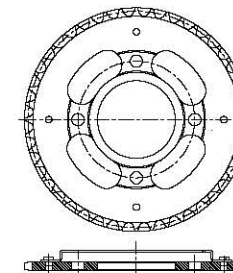

型号Model: TITAN 2000

齿数Teeth Number: Z 44
 齿顶圆直径Outside Diameter: D Ø184.37MM
 中心孔直径Center Hole: D Ø64MM
 齿根圆直径Root Diameter: D1 Ø169.47MM
 齿厚Tooth Thickness: 7MM
 平面凹槽Step Diameter: Ø80MM-Ø112MM
 定位孔中心距Center Distance: Ø96MM

定位孔直径Pilot Hole Diameter: Ø10.5MM
 材质Material: 1045#
 硬度Hardness: HRB70-80
 节距Pitch: P12.7MM
 滚子直径Roller Diameter: Dr8.51MM
 适配ISO链号Adaptive ISO Chain Number: 08B
 带保护盘With protector

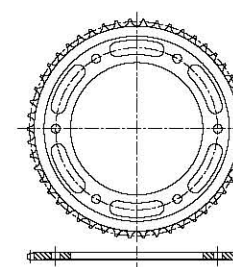

型号Model: NXR150 BROSS

齿数Teeth Number: Z 50
 齿顶圆直径Outside Diameter: D Ø208.71MM
 中心孔直径Center Hole: D Ø125MM
 齿根圆直径Root Diameter: D1 Ø193.75MM
 齿厚Tooth Thickness: 7MM
 平面凹槽Step Diameter: Ø175MM
 定位孔中心距Center Distance: Ø153MM

定位孔直径Pilot Hole Diameter: Ø8.5MM
 材质Material: 1045#
 硬度Hardness: HRB70-80
 节距Pitch: P12.7MM
 滚子直径Roller Diameter: Dr8.51MM
 适配ISO链号Adaptive ISO Chain Number: 08B
 扩孔Broaching

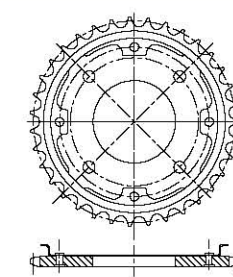

型号Model: C100-BIZ

齿数Teeth Number: Z 35
 齿顶圆直径Outside Diameter: D Ø148.01MM
 中心孔直径Center Hole: D Ø58MM
 齿根圆直径Root Diameter: D1 Ø133.2MM
 齿厚Tooth Thickness: 7MM
 定位孔中心距Center Distance: Ø90MM
 定位孔直径Pilot Hole Diameter: Ø8.5MM

材质Material: 1045#
 硬度Hardness: HRB70-80
 节距Pitch: P12.7MM
 滚子直径Roller Diameter: Dr8.51MM
 适配ISO链号Adaptive ISO Chain Number: 08B
 带保护盘With protector

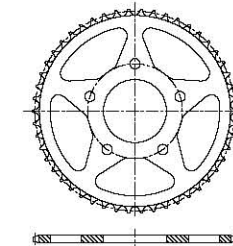

型号Model: XLR 125

齿数Teeth Number: Z 50
 齿顶圆直径Outside Diameter: D Ø208.71MM
 中心孔直径Center Hole: D Ø64MM
 齿根圆直径Root Diameter: D1 Ø193.75MM
 齿厚Tooth Thickness: 7MM
 油线圆直径Oil Groove Diameter: Ø180MM
 定位孔中心距Center Distance: Ø96MM

定位孔直径Pilot Hole Diameter: Ø10.5MM
 材质Material: 1045#
 硬度Hardness: HRB70-80
 节距Pitch: P12.7MM
 滚子直径Roller Diameter: Dr8.51MM
 适配ISO链号Adaptive ISO Chain Number: 08B
 带钉With Screw

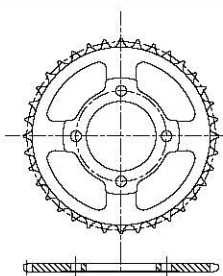

型号Model: C 70

齿数Teeth Number: Z 36
 齿顶圆直径Outside Diameter: D Ø152.01MM
 中心孔直径Center Hole: D Ø54MM
 齿根圆直径Root Diameter: D1 Ø137.86MM
 齿厚Tooth Thickness: 6MM
 平面凹槽Step Diameter: Ø90MM
 定位孔中心距Center Distance: Ø70MM

定位孔直径Pilot Hole Diameter: Ø54MM
 材质Material: 1045#
 硬度Hardness: HRB70-80
 节距Pitch: P12.7MM
 滚子直径Roller Diameter: Dr7.8MM
 适配ISO链号Adaptive ISO Chain Number: 08B

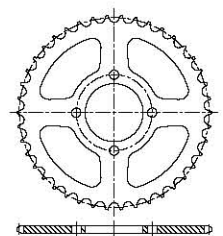

型号Model: AX 100

齿数Teeth Number: Z 42
 齿顶圆直径Outside Diameter: D Ø176.32MM
 中心孔直径Center Hole: D Ø52MM
 齿根圆直径Root Diameter: D1 Ø161.43MM
 齿厚Tooth Thickness: 7MM
 定位孔中心距Center Distance: Ø68MM

定位孔直径Pilot Hole Diameter: Ø8.5MM
 材质Material: 1045#
 硬度Hardness: HRB70-80
 节距Pitch: P12.7MM
 滚子直径Roller Diameter: Dr8.51MM
 适配ISO链号Adaptive ISO Chain Number: 08B

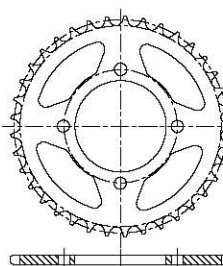

型号Model: RS 125

齿数Teeth Number: Z 37
 齿顶圆直径Outside Diameter: D Ø156.03MM
 中心孔直径Center Hole: D Ø64MM
 齿根圆直径Root Diameter: D1 Ø141.22MM
 齿厚Tooth Thickness: 7MM
 定位孔中心距Center Distance: Ø80MM

定位孔直径Pilot Hole Diameter: Ø8.5MM
 材质Material: 1045#
 硬度Hardness: HRB70-80
 节距Pitch: P12.7MM
 滚子直径Roller Diameter: Dr8.51MM
 适配ISO链号Adaptive ISO Chain Number: 08B

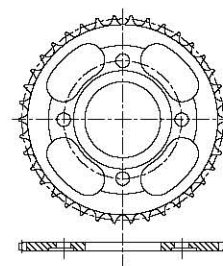

型号Model: CG 125

齿数Teeth Number: Z 38
 齿顶圆直径Outside Diameter: D Ø160.12MM
 中心孔直径Center Hole: D Ø58MM
 齿根圆直径Root Diameter: D1 Ø145.28MM
 齿厚Tooth Thickness: 7MM
 平面凹槽Step Diameter: Ø75MM-Ø105MM
 定位孔中心距Center Distance: Ø90MM

定位孔直径Pilot Hole Diameter: Ø10.5MM
 材质Material: 1045#
 硬度Hardness: HRB70-80
 节距Pitch: P12.7MM
 滚子直径Roller Diameter: Dr8.51MM
 适配ISO链号Adaptive ISO Chain Number: 08B

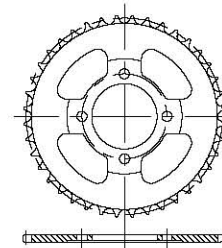

型号Model: SUPRA

齿数Teeth Number: Z 40
 齿顶圆直径Outside Diameter: D Ø168.22MM
 中心孔直径Center Hole: D Ø54MM
 齿根圆直径Root Diameter: D1 Ø153.35MM
 齿厚Tooth Thickness: 7MM
 平面凹槽Step Diameter: Ø90MM
 定位孔中心距Center Distance: Ø70MM

定位孔直径Pilot Hole Diameter: Ø8.5MM
 材质Material: 1045#
 硬度Hardness: HRB70-80
 节距Pitch: P12.7MM
 滚子直径Roller Diameter: Dr8.51MM
 适配ISO链号Adaptive ISO Chain Number: 08B

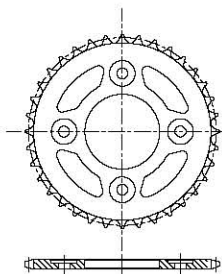

型号Model: SUPER FIT NEW

齿数Teeth Number: Z 36
 齿顶圆直径Outside Diameter: D Ø152.01MM
 中心孔直径Center Hole: D Ø58MM
 齿根圆直径Root Diameter: D1 Ø137.2MM
 齿厚Tooth Thickness: 7MM
 定位孔中心距Center Distance: Ø90MM
 定位孔直径Pilot Hole Diameter: Ø8.5MM

材质Material: 1045#
 硬度Hardness: HRB70-80
 节距Pitch: P12.7MM
 滚子直径Roller Diameter: Dr8.51MM
 适配ISO链号Adaptive ISO Chain Number: 08B
 扩孔Broaching

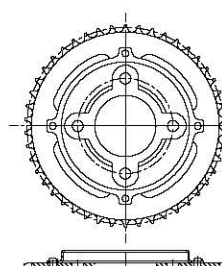

型号Model: GLPRO NEO

齿数Teeth Number: Z 46
 齿顶圆直径Outside Diameter: D Ø192.5MM
 中心孔直径Center Hole: D Ø58MM
 齿根圆直径Root Diameter: D1 Ø177.6MM
 齿厚Tooth Thickness: 7MM
 平面凹槽Step Diameter: Ø75MM-Ø105MM
 定位孔中心距Center Distance: Ø90MM

定位孔直径Pilot Hole Diameter: Ø10.5MM
 材质Material: 1045#
 硬度Hardness: HRB70-80
 节距Pitch: P12.7MM
 滚子直径Roller Diameter: Dr8.51MM
 适配ISO链号Adaptive ISO Chain Number: 08B
 带保护盘With protector

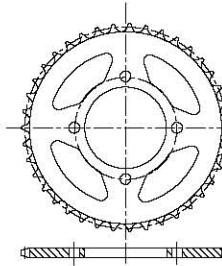

型号Model: FORCE-1

齿数Teeth Number: Z 39
 齿顶圆直径Outside Diameter: D Ø164.17MM
 中心孔直径Center Hole: D Ø64MM
 齿根圆直径Root Diameter: D1 Ø149.31MM
 齿厚Tooth Thickness: 7MM
 定位孔中心距Center Distance: Ø80MM

定位孔直径Pilot Hole Diameter: Ø8.5MM
 材质Material: 1045#
 硬度Hardness: HRB70-80
 节距Pitch: P12.7MM
 滚子直径Roller Diameter: Dr8.51MM
 适配ISO链号Adaptive ISO Chain Number: 08B

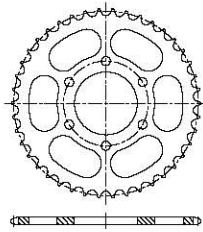

型号Model: PULSAR

齿数Teeth Number: Z 42
 齿顶圆直径Outside Diameter: D Ø176.32MM
 中心孔直径Center Hole: D Ø58MM
 齿根圆直径Root Diameter: D1 Ø161.43MM
 齿厚Tooth Thickness: 7MM
 定位孔中心距Center Distance: Ø78MM

定位孔直径Pilot Hole Diameter: Ø8.5MM
 材质Material: 1045#
 硬度Hardness: HRB70-80
 节距Pitch: P12.7MM
 滚子直径Roller Diameter: Dr7.8MM
 适配ISO链号Adaptive ISO Chain Number: 08B

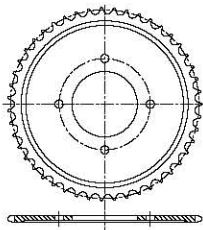

型号Model: RAJDOOT N/M

齿数Teeth Number: Z 47
 齿顶圆直径Outside Diameter: D Ø196.57MM
 中心孔直径Center Hole: D Ø66MM
 齿根圆直径Root Diameter: D1 Ø181.63MM
 齿厚Tooth Thickness: 7MM
 平面凹槽Step Diameter: Ø159MM
 定位孔中心距Center Distance: Ø92MM

定位孔直径Pilot Hole Diameter: Ø10.5MM
 材质Material: 1045#
 硬度Hardness: HRB70-80
 节距Pitch: P12.7MM
 滚子直径Roller Diameter: Dr8.51MM
 适配ISO链号Adaptive ISO Chain Number: 08B

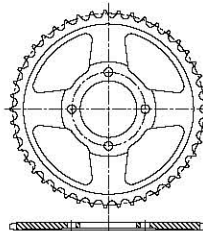

型号Model: SPLENDER

齿数Teeth Number: Z 45
 齿顶圆直径Outside Diameter: D Ø188.57MM
 中心孔直径Center Hole: D Ø54MM
 齿根圆直径Root Diameter: D1 Ø173.63MM
 齿厚Tooth Thickness: 7MM
 平面凹槽Step Diameter: Ø90MM
 定位孔中心距Center Distance: Ø70MM

定位孔直径Pilot Hole Diameter: Ø8.5MM
 油线圆直径Oil Groove Diameter: Ø162MM
 材质Material: 1045#
 硬度Hardness: HRB70-80
 节距Pitch: P12.7MM
 滚子直径Roller Diameter: Dr8.51MM
 适配ISO链号Adaptive ISO Chain Number: 08B

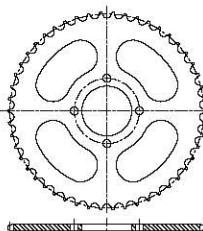

型号Model: TVS XL SUPPER

齿数Teeth Number: Z 50
 齿顶圆直径Outside Diameter: D Ø208.71MM
 中心孔直径Center Hole: D Ø52MM
 齿根圆直径Root Diameter: D1 Ø194.40MM
 齿厚Tooth Thickness: 6MM
 定位孔中心距Center Distance: Ø68MM

定位孔直径Pilot Hole Diameter: Ø8.5MM
 材质Material: 1045#
 硬度Hardness: HRB70-80
 节距Pitch: P12.7MM
 滚子直径Roller Diameter: Dr7.8MM
 适配ISO链号Adaptive ISO Chain Number: 085

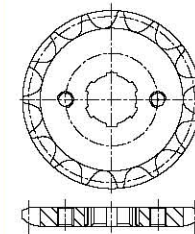

型号Model: WY 125

齿数Teeth Number: Z 15
 齿顶圆直径Outside Diameter: D Ø66.60MM
 中心孔直径Center Hole: D Ø17.8MM
 齿根圆直径Root Diameter: D1 Ø52.57MM
 齿厚Tooth Thickness: 7MM
 螺丝孔Screwhole: M6*2*Ø34MM
 花键Spline: Z6-4*20MM
 材质Material: 20CrMnTi
 硬度Hardness: HRC60-63
 节距Pitch: P12.7MM
 滚子直径Roller Diameter: Dr8.51MM
 适配ISO链号Adaptive ISO Chain Number: 08B

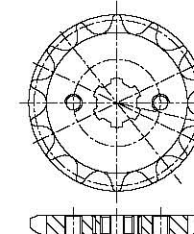

型号Model: DY 100

齿数Teeth Number: Z 14
 齿顶圆直径Outside Diameter: D Ø62.50MM
 中心孔直径Center Hole: D Ø14MM
 齿根圆直径Root Diameter: D1 Ø48.56MM
 齿厚Tooth Thickness: 7MM
 螺丝孔Screwhole: M6*2*Ø30MM
 花键Spline: Z6-4*17MM
 材质Material: 20CrMnTi
 硬度Hardness: HRC60-63
 节距Pitch: P12.7MM
 滚子直径Roller Diameter: Dr8.51MM
 适配ISO链号Adaptive ISO Chain Number: 08B

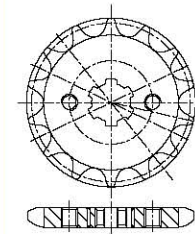

型号Model: GRAND

齿数Teeth Number: Z 14
 齿顶圆直径Outside Diameter: D Ø62.50MM
 中心孔直径Center Hole: D Ø14MM
 齿根圆直径Root Diameter: D1 Ø48.56MM
 齿厚Tooth Thickness: 7MM
 螺丝孔Screwhole: M6*2*Ø30MM
 花键Spline: Z6-4*17MM
 材质Material: 20CrMnTi
 硬度Hardness: HRC60-63
 节距Pitch: P12.7MM
 滚子直径Roller Diameter: Dr8.51MM
 适配ISO链号Adaptive ISO Chain Number: 08B

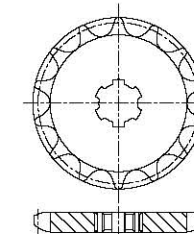

型号Model: RC 100

齿数Teeth Number: Z 14
 齿顶圆直径Outside Diameter: D Ø62.50MM
 中心孔直径Center Hole: D Ø13MM
 齿根圆直径Root Diameter: D1 Ø48.56MM
 齿厚Tooth Thickness: 7MM
 花键Spline: Z6-3.5*16MM
 材质Material: 20CrMnTi
 硬度Hardness: HRC60-63
 节距Pitch: P12.7MM
 滚子直径Roller Diameter: Dr8.51MM
 适配ISO链号Adaptive ISO Chain Number: 08B

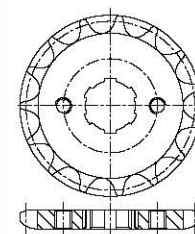

型号Model: CG 125

齿数Teeth Number: Z 15
 齿顶圆直径Outside Diameter: D Ø66.60MM
 中心孔直径Center Hole: D Ø17.8MM
 齿根圆直径Root Diameter: D1 Ø52.57MM
 齿厚Tooth Thickness: 7MM
 螺丝孔Screwhole: M6*2*Ø34MM
 花键Spline: Z6-4*20MM
 材质Material: 20CrMnTi
 硬度Hardness: HRC60-63
 节距Pitch: P12.7MM
 滚子直径Roller Diameter: Dr8.51MM
 适配ISO链号Adaptive ISO Chain Number: 08B

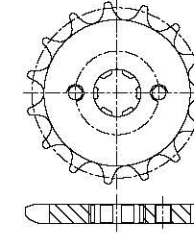

型号Model: SUPRA

齿数Teeth Number: Z 15
 齿顶圆直径Outside Diameter: D Ø66.60MM
 中心孔直径Center Hole: D Ø14MM
 齿根圆直径Root Diameter: D1 Ø52.57MM
 齿厚Tooth Thickness: 7MM
 螺丝孔Screwhole: M6*2*Ø30MM
 花键Spline: Z6-4*17MM
 材质Material: 20CrMnTi
 硬度Hardness: HRC60-63
 节距Pitch: P12.7MM
 滚子直径Roller Diameter: Dr8.51MM
 适配ISO链号Adaptive ISO Chain Number: 08B

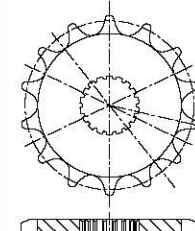

型号Model: GS 125

齿数Teeth Number: Z 14
 齿顶圆直径Outside Diameter: D Ø62.50MM
 中心孔直径Center Hole: D Ø18MM
 齿根圆直径Root Diameter: D1 Ø48.56MM
 齿厚Tooth Thickness: 7MM
 花键Spline: Z18-20MM
 材质Material: 20CrMnTi
 硬度Hardness: HRC60-63
 节距Pitch: P12.7MM
 滚子直径Roller Diameter: Dr8.51MM
 适配ISO链号Adaptive ISO Chain Number: 08B

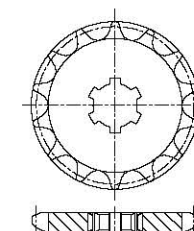

型号Model: AX 100

齿数Teeth Number: Z 14
 齿顶圆直径Outside Diameter: D Ø62.50MM
 中心孔直径Center Hole: D Ø16MM
 齿根圆直径Root Diameter: D1 Ø48.56MM
 齿厚Tooth Thickness: 7MM
 花键Spline: Z6-4*20MM
 材质Material: 20CrMnTi
 硬度Hardness: HRC60-63
 节距Pitch: P12.7MM
 滚子直径Roller Diameter: Dr8.51MM
 适配ISO链号Adaptive ISO Chain Number: 08B



We supply the best for your transmission



UNIBEAR[®]

**RUSHED OUT OF THE COUNTRY
CROSS THE WORLD**

Seventeen years of spring flowers and autumn fruit,
wind and rain has washed out the white lead
on the road

But can not take off the enthusiasm and devotion
of Yongli people.....

Have great ambition and high aspiration

Only with foresight can you have future, only with
dream can you soar highly

New starting piont and new vista, limitless space
and time and never stop struggle.....