



**2006-15 Yamaha  
FZ-1**

V.A.L.E.™ Slip-On Exhaust System  
Part # 005-1500406V / 005-1500407V / 005-1500408V



**Parts List**

Qty.	Description	Part Number
1	Yamaha FZ1 Muffler Canister	Varies
1	Yamaha FZ1 Slip Tube	005-15004S
1	Muffler Canister Clamp	Varies
1	HARDWARE KIT	005-150-3
1	X-Ring Kit	005-7-2-3KIT
1	Barrel Clamp	005-27-71MSH
1	10mm Nylon Lock Nut	005-NN11
1	Permatex Ultra Black Gasket Maker	031-P22072

**IMPORTANT - PLEASE READ CAREFULLY**

*We recommend that this performance part be installed by a qualified motorcycle technician. If you have any doubts as to your ability to install this performance part, please consult with your local motorcycle dealer. Read all instructions first before starting installation. Make sure the motorcycle and exhaust system are completely cool before starting the installation. Also, make sure the bike is secure on a centerstand or ideally a service lift during installation. Be sure to save all stock components for possible use later.*

**Installation Instructions**

1. Make sure the bike is completely cool before starting the installation. Make sure the bike is secure on a centerstand or ideally a service lift.

2. Loosen the bottom muffler clamp.



3. Remove cover plate at exhaust valve.



4. Loosen the 10mm nuts and disconnect exhaust valve servo cables.



5. Remove the 14mm muffler mounting bolt and remove the stock muffler and slip-tube assembly from the bike.



6. Remove both seats to allow access to the other end of the exhaust valve servo cables.



7. Remove the cover and disconnect both servo cables.



8. Remove the plastic tie from the cables as shown. Guide the cables downward and remove them from the bike.

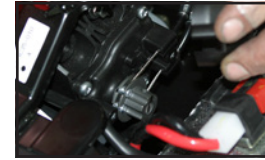

9. Slide the X-lite™ Ring over the slip-tube. Use the 4 (four) 6x14mm Socket Head Cap Screws and 6mm split lock washers to loosely attach to the muffler as shown. Do not tighten yet.

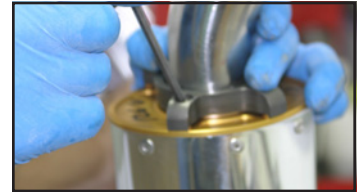

10. Slide the supplied muffler canister clamp over the muffler. Slide the supplied barrel clamp over the end of the slip-tube. Do not tighten yet.

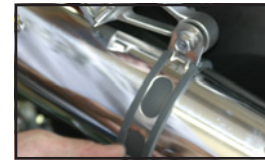

(Continued on page 2)



**2006-15 Yamaha  
FZ-1**

V.A.L.E.™ Slip-On Exhaust System  
Part # 005-1500406V / 005-1500407V / 005-1500408V

(Continued from page 1)

11. Remove the stock rubber from the centerstand and insert it into the place provided on the TBR slip-tube.



12. Carefully position the TBR muffler assembly on the bike, sliding the slip-tube onto the stock header tube. Using the stock muffler mounting bolt and the supplied nut, loosely secure the muffler canister to the bike as shown.

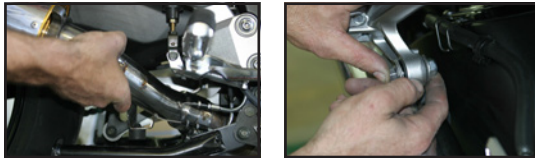

13. Be sure that the centerstand will come into contact with the rubber piece when lifted against the TBR slip-tube. Once you are satisfied with the fitment of the exhaust and everything is straight, tighten the muffler clamp, followed by the 4 (four) 6x14mm V.A.L.E. bolts, and then lastly tighten the barrel clamp.

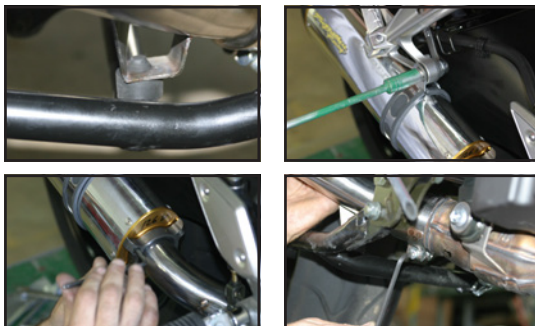

14. Double check your work to ensure everything is tight and properly installed.

15. Before you run the bike, clean off all fingerprints and dirt, as any oily residue will etch the metal and become somewhat permanent when the system gets hot. Run the bike and enjoy. It is normal for some white smoke to appear the first time you start the bike. This is packing/manufacturing oil from inside the pipe burning off. Check for gaps or leaks. If you find a leak, a little high temperature silicon sealant should fix it. After 50 to 100 miles, recheck all fasteners for tightness.



**Installation Instructions**



Qty.	Description	Part Number
1	Yamaha FZ1 Muffler Canister	Varies
1	Yamaha FZ1 Slip Tube	005-15004S
1	Muffler Canister Clamp	Varies
1	HARDWARE KIT	005-150-3
1	X-Ring Kit	005-7-2-3KIT
1	Barrel Clamp	005-27-71MSH
1	10mm Nylon Lock Nut	005-NN11
1	Permatex Ultra Black Gasket Maker	031-P22072

**Care & Cleaning / Warranty**

**Care & Cleaning**

Keep system free of dirt and moisture. Store in a cool, dry place. For cleaning use a mild spray cleaner. Always apply cleaner or polish with a soft, clean cloth.

**Stainless Header System:** Polished stainless steel pipes will turn a light golden hue after a few heat cycles, this is a normal characteristic of high quality stainless steel.

**Carbon Fiber Mufflers:** Always make sure the fiberglass packing inside is in good condition and not burned out, as exhaust heat inside an empty canister will deteriorate the Carbon Fiber sleeve. TBR sells repack kits (TBR part # 005-10038) that include new rivets and repack material as well as a drill bit (#30), making it easy to do yourself. Also, NEVER dyno test your bike with carbon fiber mufflers installed - the intense heat and lack of cooling air can quickly cause the CF material to burn. Two Brothers Racing does not provide a warranty for burned carbon fiber.

**Aluminum Mufflers:** Use an aluminum or mag wheel polish such as Mother's to restore the bright finish to factory spec.

Two Brothers Racing products are intended for closed course competition purposes only, and therefore are sold "as is" without warranty. Two Brothers Racing specifically disclaims any warranties of merchantability or fitness for a particular purpose and disclaims all responsibility for consequential and incidental damages or any other losses arising from the use of these products or parts.