



# MrJump

 100%  HAND MADE IN ITALY



# WARNING

**Thank you for choosing a SUOMY helmet.**

Designed and manufactured in compliance with the highest qualitative standards specifically for motorcycle use, MR. JUMP is certified by the most important Certification Bodies.

**Suomy cannot be held responsible for direct or indirect damages resulting from an incorrect use of the product and/or for using the helmet in situations that go beyond the normal conditions of use or the modalities indicated in this booklet.**

Before using the helmet, carefully read this manual. Keep it at hand for future reference.

For further information, contact your Distributor or SUOMY Motosport S.r.l.

Use this helmet in compliance with the instructions contained in this manual. Compliance with these instructions will make your helmet last longer and will assure maximum product performances.

**Modifications and/or alterations to the helmet and/or any of its components shall make the warranty void and may jeopardize the safety requirements or make the product non-compliant with the certification standards.**

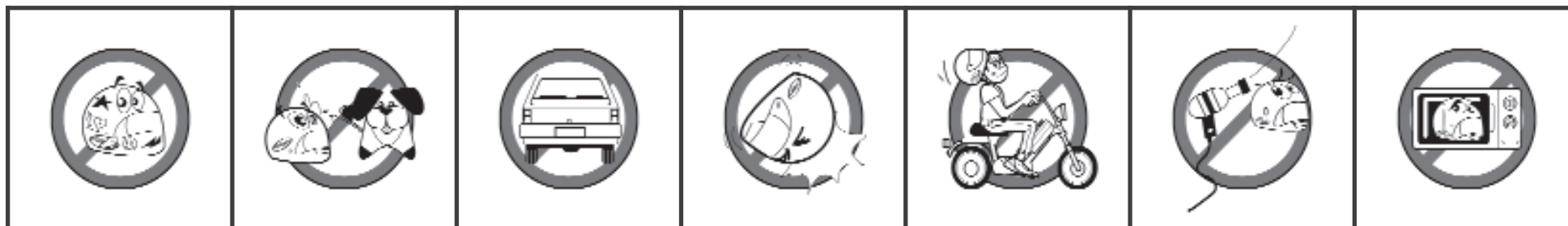

## WARNING

All the Suomy products are constantly subject to a continual improvement process, that's why Suomy reserves the right to make changes, without prior notice, to the products object of this manual. It is therefore not possible to exercise any rights on the basis of the information, illustrations and descriptions contained in this manual.

MR. JUMP was developed and tested to assure, together with the safety features, the best level of comfort and noise reduction during ordinary conditions of use. However, the particular configuration of the vehicle and/or the position of the rider or both factors can entail situations that could not be foreseen during the manufacturing of the product that may generate aerodynamic rustles or hissing sounds.

**Suomy therefore cannot be held responsible if this should occur.**

**MR. JUMP is not designed to be used with ear-phones and/or similar elements.**



# GENERAL RULES

For maximum safety MR. JUMP must fit tightly and be correctly and securely fastened, so it cannot be taken off neither by pulling it nor by rotating it around the head (see figure 1).

If it is too big it may slide down over the eyes or turn in a lateral direction due to movement during riding, thus blocking visibility.

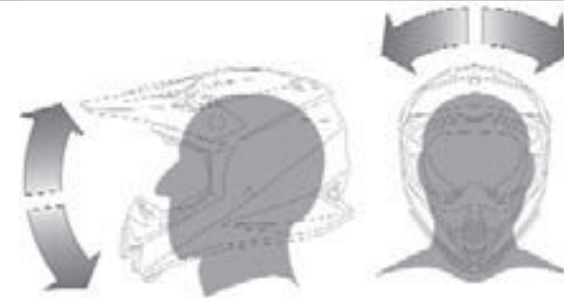

figure 1

Do not use scarves or neck guards which could make the strap slide and the helmet fly off in case of crash.

The function of the helmet is to reduce stress on the user's head in case of crash; this happens through a partial destruction and/or deformation of its components (mostly the external shell and the internal polystyrene shell). In this way, part of the energy generated by the impact is absorbed by the components of the helmet, thus reducing the vibrations on the user's head, eliminating or limiting the risk of traumas.

The protection capacity of the helmet is not endless and certain crashes may generate such high stress that even the energy absorbed by the helmet is not enough to protect the user from injuries: **no helmet, even top quality helmets, can protect the head against the forces generated by any type of crash.**

The integrity of the shell and of the inside is essential to assure maximum performances in terms of safety. MR. JUMP was designed to absorb crashes through a partial destruction of the shell or some of its parts that could be damaged after a crash even if it is not readily visibly. If the helmet suffers further stress it might not be able to offer the maximum level of protection.

**Do not use a helmet that suffered severe blows even though the damage is not readily visible; if the helmet is damaged it must be replaced.**

**It is extremely dangerous to modify the helmet by sticking or gluing anything on it.**

**Do not cut or punch the helmet's shell, do not insert screws or paint it.**

Do not change the internal lining of the helmet, particularly never cut or change the inside polystyrene padding: **changes to the shape of the internal polystyrene shell can affect the safety features of the helmet.**

Only use original Suomy accessories and spare parts or those specifically indicated by Suomy for the specific model: this is the only way to assure reliability, safety and compatibility with the helmet used.

**The use of non original components and/or accessories makes the warranty void (see warranty conditions on page 23) and can affect the safety requirements.**

## MAINTENANCE

To **clean the shell and front part** use water and mild soap; let the helmet dry at room temperature, never expose it to heat.

Cleaning the helmet with solvents, petrol by-products or chemical substances, the application of stickers or paint could affect the structure of the shell, thus affecting the safety features, even if the damage is not readily visible.

**Do not paint, or apply stickers, petrol or other chemical solvents to this helmet.**

To **clean the internal lining**, just hand wash at 30°C maximum, exclusively using mild soap.

To clean the removable internal lining use a damp cloth and mild soap.

**The fabric lining, even if it is part of removable elements, must not be soaked in water when it is applied to or paired with an internal padding, either rigid or soft.**

Dry the pieces at room temperature, **away from sunlight** and without exposing them to heat.

Periodically clean the «**D-Ring**» **retention system** with warm water and mild soap. **Do not use solvents or chemical detergents and do not lubricate.**

Some colourings of the shell are made with Fluo paints that could be subject to the natural migration phenomenon with a drop in intensity. The phenomenon could be enhanced when the helmet is exposed for long periods to a particularly intense light. However, this does not affect the performances and the quality of MR. JUMP.

**Suomy therefore, cannot be held responsible if this should occur.**

## RETENTION SYSTEM «D-RING»

see figure 2

Insert the free side of the strap in the rings. Pull the end until the strap presses firmly against the jaw.

After this operation, it should not be possible to remove the helmet. Verify that by grabbing it from the back and rotating it to the front it cannot be removed and it is fixed to the head.

If the helmet tends to come off or rotates freely, tighten the strap again until the right pressure is obtained and repeat test.

**If after repeating the test you are not able to efficiently tighten the retention system, do not use the helmet.**

Only after checking the correct tension of the strap, fix the free end locking it with the automatic stud to the release tab (see fig. 2).

**The automatic stud is necessary only to fix the free end of the strap to prevent it from flapping while riding. Fixing the release button does not assure that the helmet is correctly in position and properly fastened: the correct locking of the strap must be verified exclusively following the above paragraphs.**

To release the retention system, release the automatic stud button and pull the release tab to loosen the closure. Slide out the free end of the strap from the “D-Rings”.

**Use the release tab only to remove the helmet! Never release this tab while riding.**

**If the retention system does not work properly, do not use the helmet and contact Suomy authorized personnel only.**

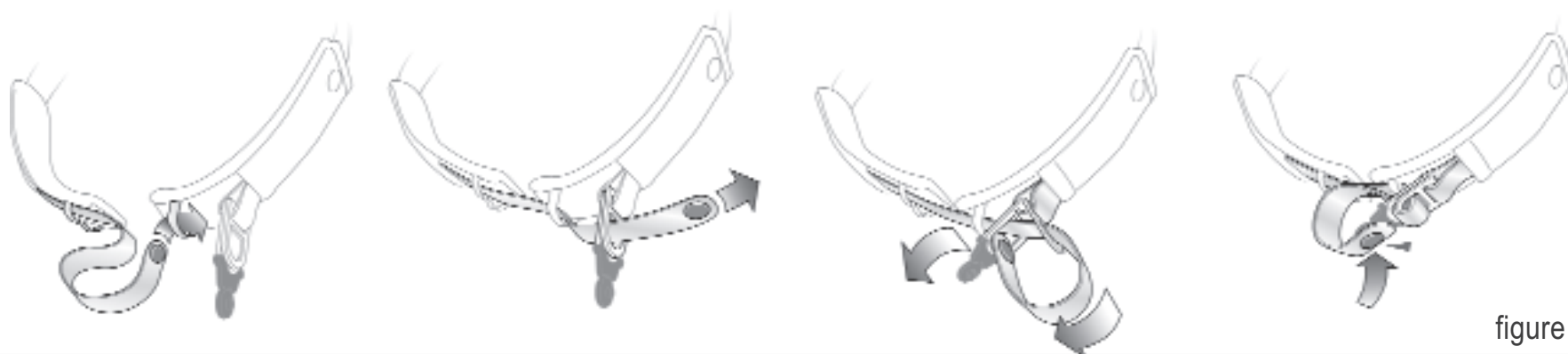

figure 2



The part in fabric can be washed and replaced (fig. 2A).

To remove it, release the stud button and slid it out from the free side. To fasten again, slide back in the fabric from the free side and fix the fabric to the stud button.

## FRONT PART : ADJUSTING

see figure 3A

Loosen without removing the three screws on the right, left and central part. Adjust the position of the front part rotating it upwards or downwards until the desired position is obtained. After finding the position, tighten the three screws and re-check the position of the front part.

**For all these operation, use the proper tool to tighten these screws.**

## FRONT PART : REPLACING

see figure 3B

Loosen and remove the three screws placed on the right, left and central part. Position the new front part by making the holes match with the three threaded fittings on the shell. Insert the screws in the specific housings without tightening completely. Adjust the position of the front part and lock it into position as indicated in above paragraph.

**For all these operation, use the proper tool to tighten these screws.**

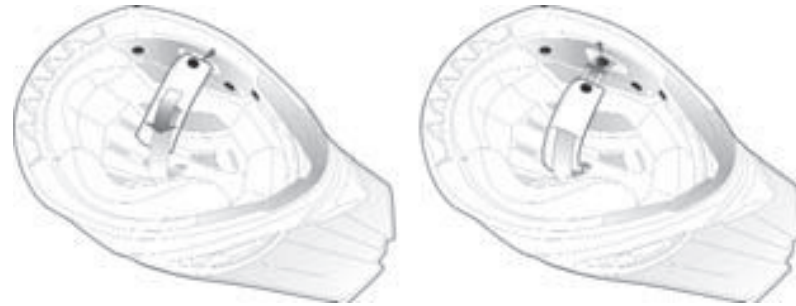

figure 2A



figure 3A

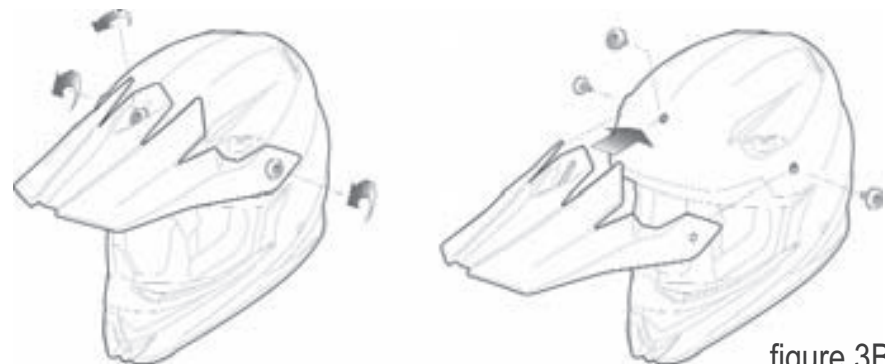

figure 3B

# USER'S INSTRUCTIONS

## INTERNAL PARTS

The internal parts of "MR: JUMP" (central pads, right and left cheek pad), can easily be removed to be washed and/or replaced.

### Inner side padding: CHEEK PADS – Assembly and disassembly

The cheek pads are fixed to the inner lining of the helmet through three press studs.

#### Removing the pads – see fig. 4A

The removable cheek pad is fixed to the shell through three press studs to remove, unfasten the three studs by slightly pulling outwards. After unfastening the buttons, slide out the pad by releasing the strap from the slot in the pad.

#### Assembly – see fig. 4B

Follow this procedure to fit in the cheek pads : insert the strap in the slot inside the cheek pad.

Verify the correct positioning of the removable cheek pads and slightly press and fasten the studs.

#### Verify that the part was assembled correctly by checking that:

- the cheek pad is firmly locked in position
- that the strap is completely free inside the hole and was not blocked under the cheek pad during assembly.

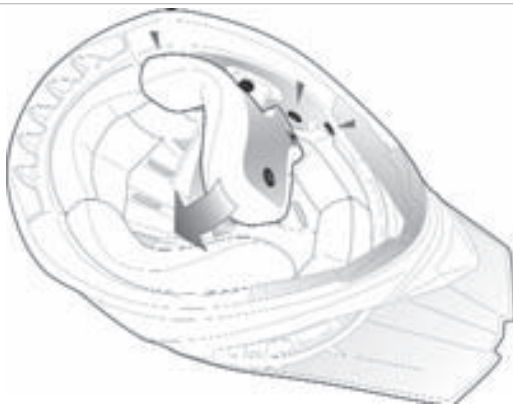

figure 4A

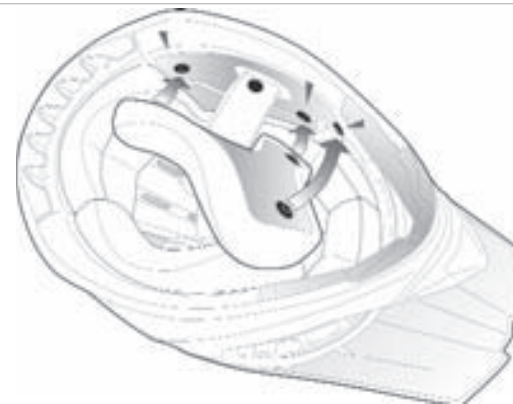

figure 4B



**Only the correct assembly of the cheek pad and the correct positioning of the strap will assure the proper operation of the retention system.**

If this doesn't happen and the removable cheek pads don't work correctly, do not use the helmet and contact Suomy authorized personnel only.

## **Internal central padding : fitting and removal**

**Removal** – see fig. 5A

The internal padding is fixed to the helmet through 2 back stud buttons and in the front part through a click-in tongue. There are also two side tongues that fix the internal padding to the polystyrene.

Remove the removable cheek pads (refer to paragraph CHEEK PADS). Release the back stud buttons and release in the front part of the polystyrene, the click-in tongue from its seats. Slide out the two side tongues that fix the internal padding to the polystyrene. Remove the internal padding.

**Caution:** to avoid damaging the internal lining, before removing the padding, make sure the tow back stud buttons were released.

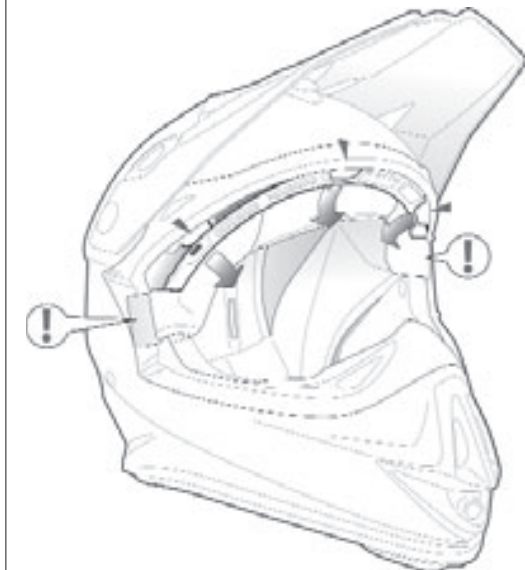
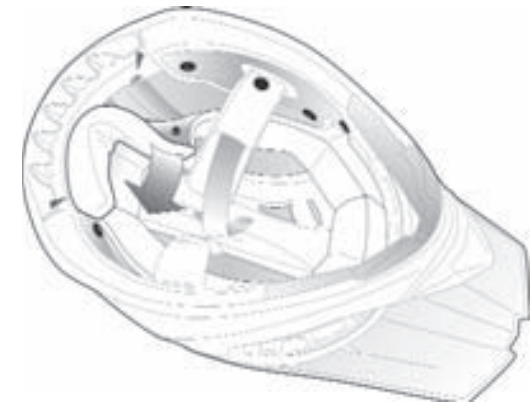

figure 5A

# USER'S INSTRUCTIONS

## **Fitting** – see fig. 5B

Position the internal padding of the helmet checking the direction of assembly. Fix the front tongue to its support on the polystyrene, fasten the back stud buttons and reinsert the side tongues between the shell and the polystyrene.

**After fitting the parts, make sure the internal padding was positioned correctly.**

**If these conditions are not verified and the internal padding was not fitted correctly, do not use the helmet and contact authorized Suomy personnel only.**

Put the cheek pads back into position (refer to paragraph CHEEK PADS).

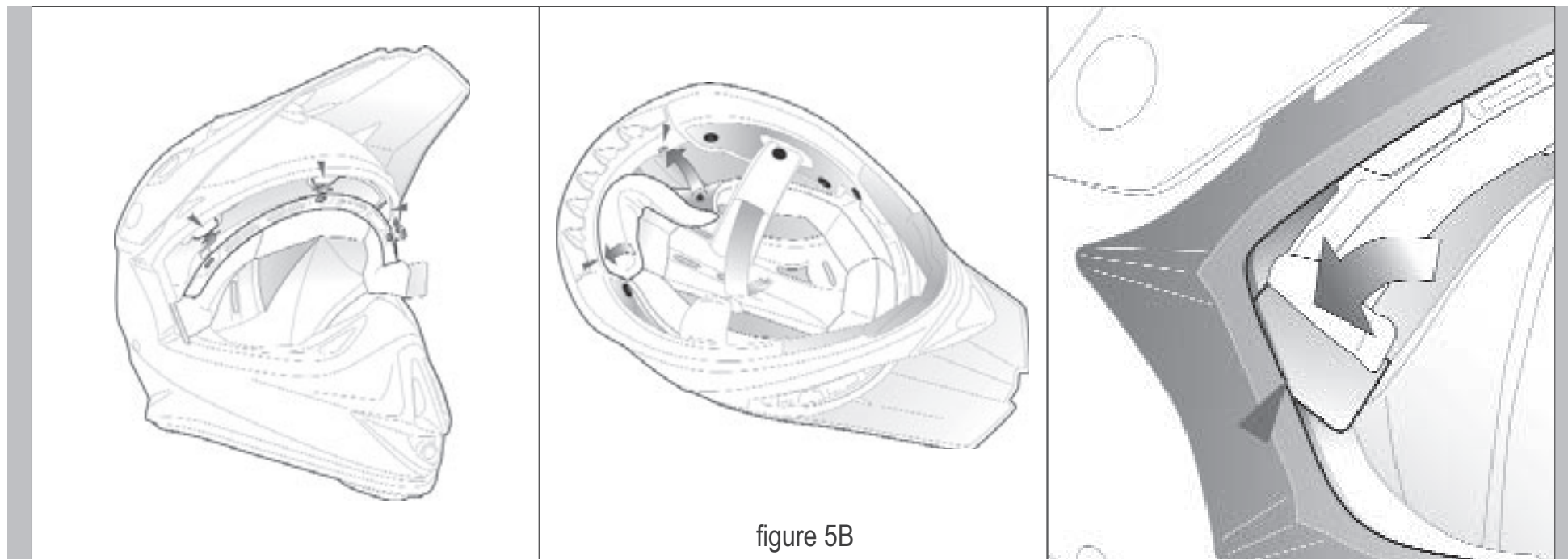



[View other motorcycle helmets made by Suomy on our website.](#)