

TOOLS NEEDED:	3MM ALLEN WRENCH	4MM ALLEN WRENCH	5MM ALLEN WRENCH	12MM WRENCH	THREAD LOCK COMPOUND
HARDWARE INCLUDED:	1 – MOUNT (A) 8 – ANGLED SPACERS (C)	4 – M8 X 25MM BOLTS (D) 2 – 10-32 X 5/8" BOLTS (E)	1 – BACKREST PAD (F) 4 – ¼-20 X 1/4 BOLTS (G)	2 – M8 X 45MM BOLT (H)	

PLEASE READ THROUGH AND UNDERSTAND THESE INSTRUCTIONS BEFORE BEGINNING.

NOTE: THIS BACKREST REQUIRES THE INSTALLATION OF BIG BIKE PARTS PART NUMBER 52-830M OR HONDA PART NUMBERS 77313-MJG-770 AND 77314-MJG-770 BEFORE INSTALLING THIS BACKREST. (EXCEPT DELUXE MODELS WHICH HAVE THE MOUNTS FROM THE FACTORY)

INSTALLATION (BACKREST ONLY):

1. IF YOU HAVE A HONDA OEM PASSENGER BACKREST REMOVE THE 4 ALLEN BOLTS AND THE BACKREST AND SET THEM ASIDE. YOU WILL NOT BE REUSING THE OEM BOLTS.
2. PLACE AN ANGLED SPACER (C) ON EACH OF THE MOUNTS AS SHOWN IN FIG. 1. THE FLAT SIDE OF THE SPACE FACES DOWN. TIP: USING A SMALL DROP OF THICK GREASE BETWEEN THE SPACER AND THE MOUNTING POINT WILL HELP HOLD THEM IN PLACE DURING ASSEMBLY.
3. PLACE A SMALL DROP OF THREAD LOCKING COMPOUND ON THE FOUR M8 X 25MM BOLTS (D) INCLUDED IN THE KIT.
4. HOLDING MOUNT (A) IN ONE HAND PLACE A M8 X 25MM (D) BOLT AND ANGLED SPACER (C) IN EACH SLOT WITH THE FLAT SIDE OF THE SPACERS FACING UP.
5. POSITION THE MOUNT OVER THE MOUNTING HOLES ON THE BIKE AND ONE AT A TIME START THE THREADS ON EACH OF THE 4 BOLTS.
6. LOWER THE MOUNT INTO PLACE AND TIGHTEN THE FOUR BOLTS USING A 5MM ALLEN WRENCH.
7. ATTACH THE PAD (F) TO THE MOUNT (A) USING THE TWO 10-32 X 5/8" BOLTS INCLUDED IN THE KIT. THE PAD CAN BE MOUNTED IN THREE DIFFERENT POSITIONS. FIG.1 SHOWS IT BEING MOUNTED IN THE MIDDLE POSITION.
8. USE THE FOUR ¼-20 X 1/4 BOLTS (G) SUPPLIED TO PLUG THE FOUR MOUNTING HOLES THAT ARE NOT BEING USED. (SEE FIG.1)

INSTALLATION (BACKREST WITH 52-830 RACK):

1. IF YOU HAVE A HONDA OEM PASSENGER BACKREST REMOVE THE 4 ALLEN BOLTS AND THE BACKREST AND SET THEM ASIDE. YOU WILL NOT BE REUSING THE OEM BOLTS.
2. PLACE AN ANGLED SPACER (C) ON EACH OF THE MOUNTS AS SHOWN IN FIG. 1. THE FLAT SIDE OF THE SPACE FACES DOWN. TIP: USING A SMALL DROP OF THICK GREASE BETWEEN THE SPACER AND THE MOUNTING POINT WILL HELP HOLD THEM IN PLACE DURING ASSEMBLY.
3. PLACE A SMALL DROP OF THREAD LOCKING COMPOUND ON THE TWO M8 X 45MM BOLTS (H) INCLUDED IN THIS KIT AND ON THE TWO M8 X 40MM BOLTS INCLUDED WITH THE 52-830 TOUR RACK.
4. ASSEMBLE TOGETHER AS SHOWN IN FIG. 2 WITH THE M8 X 45MM BOLTS IN THE FRONT MOUNTING HOLES AND THE M8 X 40MM BOLTS IN THE BACK HOLES.
5. LOOSELY MOUNT AND TIGHT BOLTS FINGER TIGHT. CENTER BACKREST AND RACK ON THE BIKE AND USING A 12MM WRENCH TIGHTEN ALL FOUR BOLTS.
6. ATTACH THE PAD (F) TO THE MOUNT (A) USING THE TWO 10-32 X 5/8" BOLTS INCLUDED IN THE KIT. THE PAD CAN BE MOUNTED IN THREE DIFFERENT POSITIONS. FIG.1 SHOWS IT BEING MOUNTED IN THE MIDDLE POSITION.
7. USE THE FOUR ¼-20 X 1/4 BOLTS (G) SUPPLIED TO PLUG THE FOUR MOUNTING HOLES THAT ARE NOT BEING USED. (SEE FIG.1)

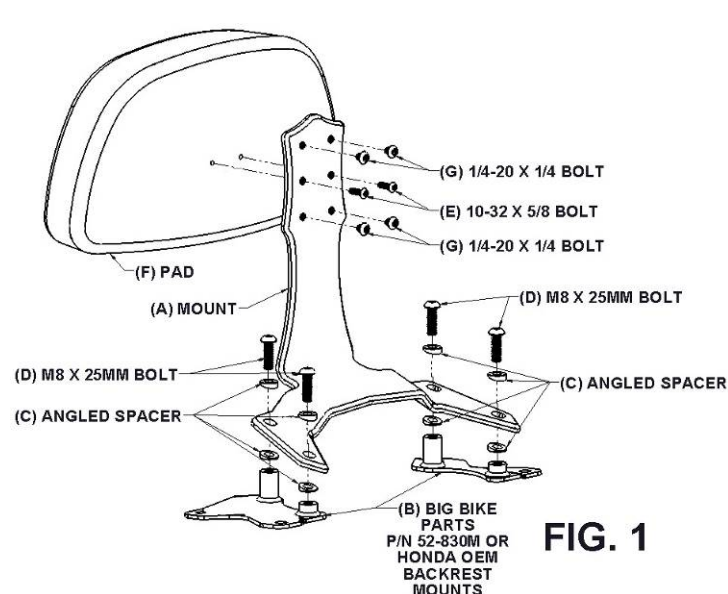

FIG. 1

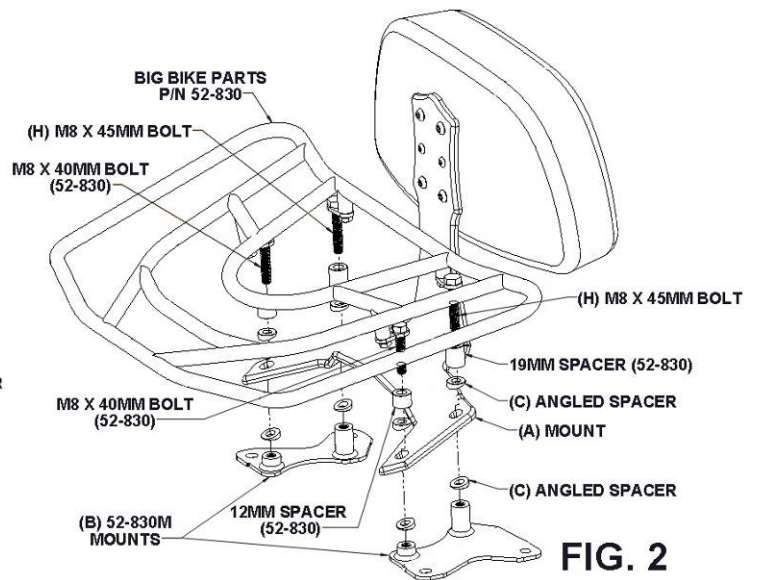

FIG. 2