



RJ Platinum-R

Instructions for use

Thank you for purchasing this SHOEI product. For your enjoyment and correct use of the product, we suggest that you read these instructions fully.

Ventilation System

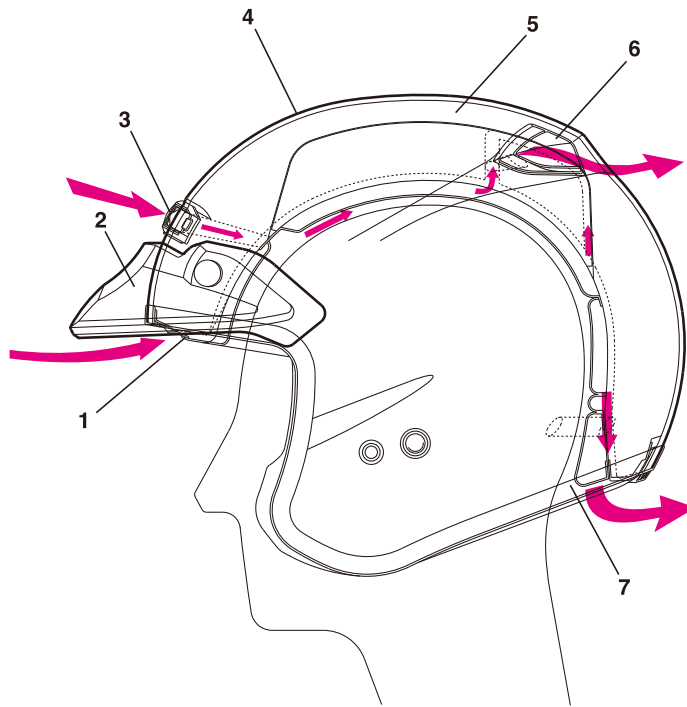

- 1 Front Air Intake
- 2 GT Visor (Peak)
- 3 Upper Air Intake
- 4 Shell
- 5 Impact Absorbing Liner
- 6 GT Top Ventilation (Top Air Outlet)
- 7 Rear Air Outlet

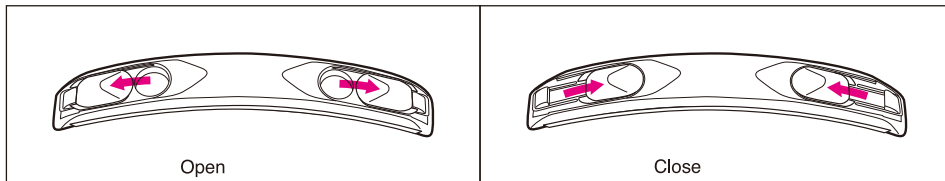

Upper Air Intake

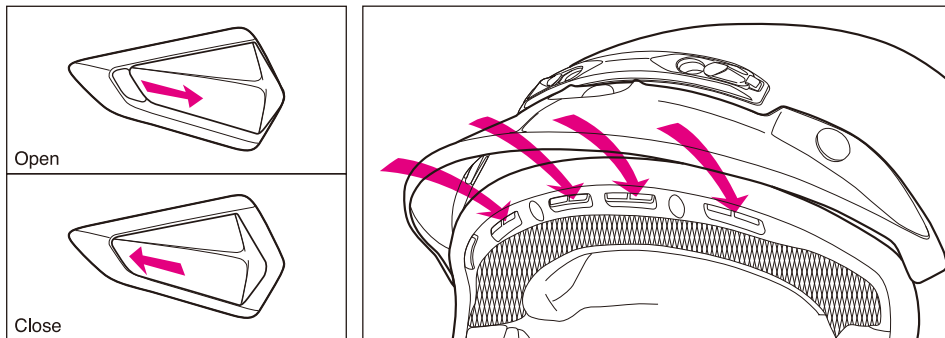

GT Top Ventilation (Top Air Outlet)

Front Air Intake
Absorption d'air frontal



Detachable Inner Parts

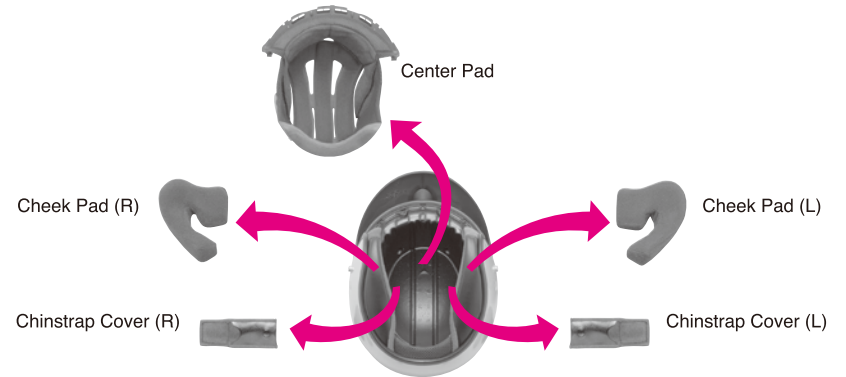

Make sure that all the inner parts are equipped before use.

All the inner parts of this helmet are fully detachable and washable. Detach or attach these parts referring the above drawing.

There are varieties of sizes of inner parts. When you replace them, be sure to select the proper size for the size of your helmet.

Standard Pad Sizes

For ECE R22 Products

Helmet size	XS	S	M	L	XL	XXL					
Center pad	XS9	M13	M9	L9	XL9	XL5					
Cheek pad	STANDARD (mm)		35	39	35	35	31				
	OPTION (mm)		37	33	41	37	33	37	33	37	33

For SNELL M2010 Products

Helmet size	XS	S	M	L	XL	XXL	XXXL					
Center pad	XS9	M13	L13	XL13	XL9	XXL9	XXL5					
Cheek pad	STANDARD (mm)		35	39	39	39	35	35	31			
	OPTION (mm)		37	33	41	37	41	37	41	37	37	33

For SNELL M2010/AS1698 Products to Australia

Helmet size	XS	S	M	L	XL	XXL						
Center pad	XS9	M13	L13	XL13	XL9	XXL9						
Cheek pad	STANDARD (mm)		35	39	39	39	35	35				
	OPTION (mm)		37	33	41	37	41	37	41	37	33	37

Removing the Inner Parts

■ Removing the Cheek Pads

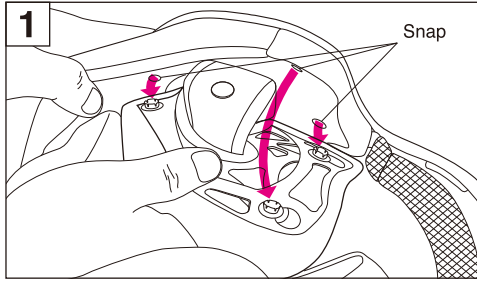

Unhook 3 snaps and pull out cheek pad of both sides.

■ Removing the Chinstrap Covers

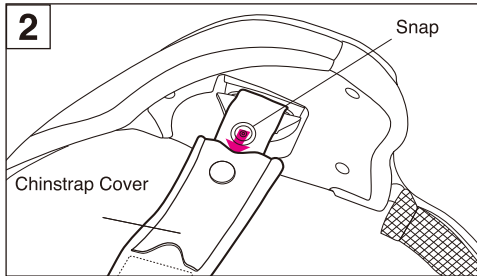

After removing a cheek pad, release a snap of a chinstrap cover and take out a cover from a strap.

■ Removing the Center Pad

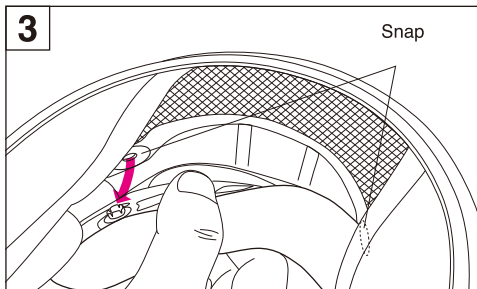

Remove the center pad by unsnapping the 2 snaps at the rear of the helmet first.

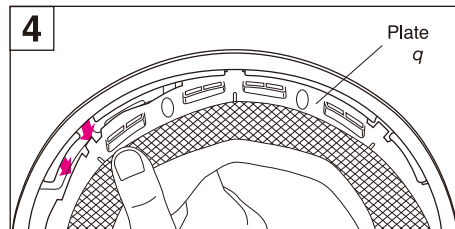

Pull the front portion of the center pad from the holding plate as per Drawing 4.

Installing the Inner Parts

● Installing the Center Pad

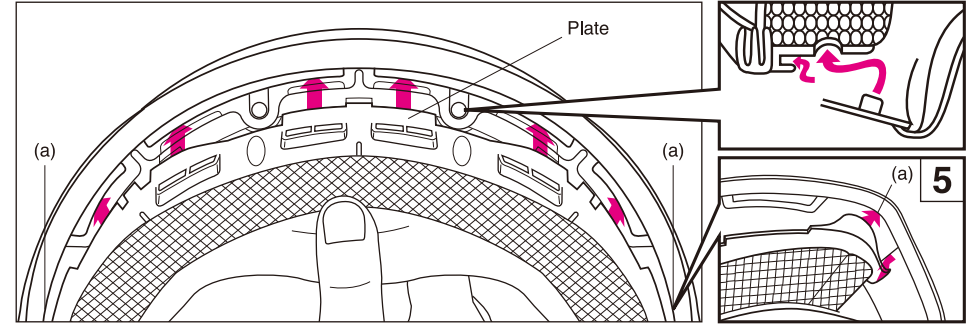

Slide a pad along a center pad bracket and snap a front portion of a plate on a front portion of a bracket at 2 points. Then, insert a right and a left ends of a plate into a gap (a) as shown in a Drawing 5.

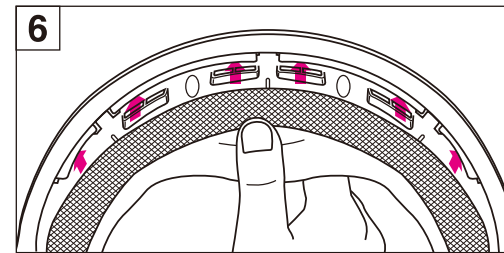

Be sure that the plate of the center pad is secured as shown in Drawing 6.

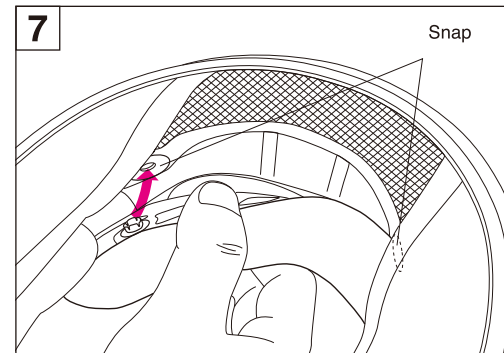

Snap the 2 snaps into place in the rear of the center pad.

●Installing the Chinstrap Covers

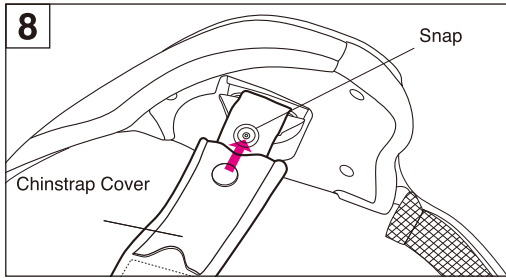

Install the chinstrap cover (same for right and left) before installing the cheek pad. Press a snap until you hear it clicks.

●Installing the Cheek Pads

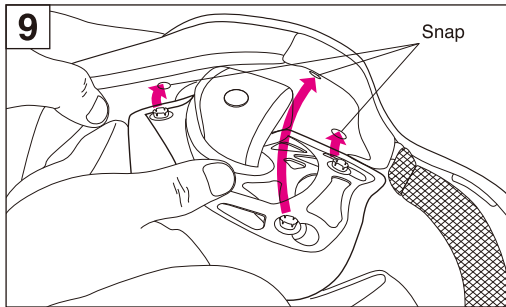

To install the cheek pad, pass the chinstrap through the hollow portion of the cheek pad and snap the pad at all 3 points. Press the head of the snap from the pad side until you hear it clicks.

Keys to Handling the Inner Parts

1. When installing or removing the inner parts, hold near a snap and handle with care. Press a head of the snap firmly until you hear it clicks.
2. When you wash the inner parts, wash by hand, or put them in mesh bag in case of machine wash. Use water only for washing, wipe with dry cloth and dry in the shade. An excessive wring may break a plate portion of the inner parts. Wipe the impact absorbing liner (polystyrene foam under the pads) with a cloth moistened by water or a solution of neutral detergent in water. **Never use benzene, thinner, petrol or any kind of harsh cleaner, as they may damage the parts.**

How to Remove and Fix Ventilation Parts

Removing and Fixing Top Air Outlet

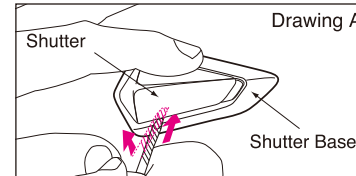

With the shutter in the middle position, insert a flat blade or screwdriver into the gap at the rear end of the shutter as per Drawing A and slide it forward to lift and remove the shutter from its base.

***Take care not to damage the helmet's paint-work during this removal process.**

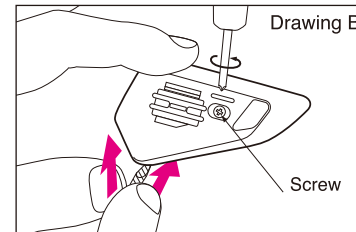

Remove the screw and insert a flat blade or screwdriver into the gap at the rear end of the shutter base, taking care not to damage the shell, then lift and remove it as per Drawing B.

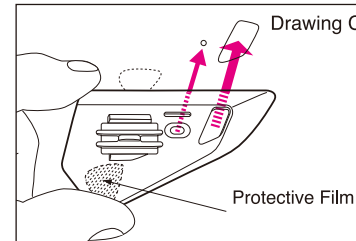

Remove any fragment of adhesive sheet or dirt and ensure that surfaces are totally clean before fixing the new shutter base. Peel off the protective film from the adhesive sheet, located on the reverse side of the shutter base. Align the oval hole and screw hole to the corresponding holes in the shell, and tighten the screw as per Drawing C.

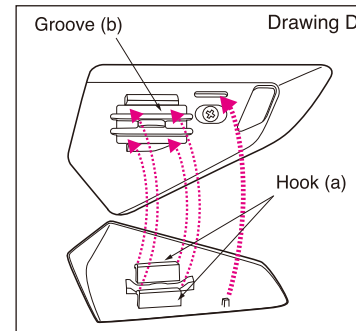

Slot hook (a), on the reverse side of the shutter, into the wide section of groove (b), located in the shutter base, and press the shutter until it clicks into position as per Drawings D and E. Make sure that the shutter works properly by sliding it back and forth.

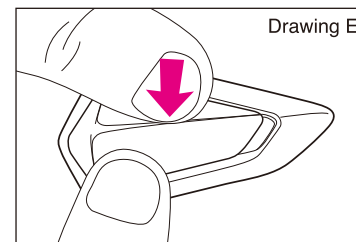

Removing and Fixing Upper Air Intake

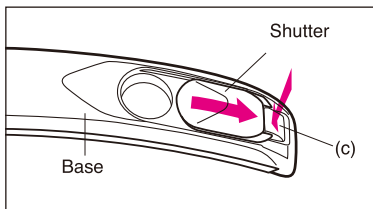

For removal press knob (c) downward, slide a shutter to a direction shown in drawing and remove from a base. Do in the same manner for the other side also. Loosen 2 screws of both sides and remove a base.

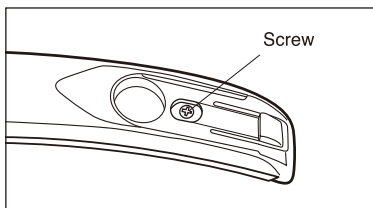

Do in a reverse manner to fix it. Tighten 2 screws of both sides and fix a base at first. Then, press a knob (c) downward and slide a shutter to fix. Do in the same manner for the other side also. Make sure that a shutter moves right and left smoothly at the end.

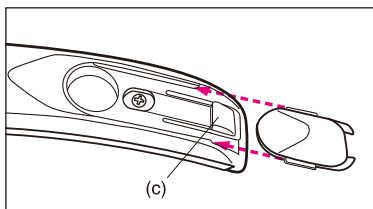

ATTENTION

1. Clean a visor or ventilation parts with a solution of neutral detergent and water, rinse well and dry with a soft cloth. **Never use benzine, thinner, petrol or any kind of harsh cleaner, as they may damage the parts.**
2. Make sure that all the inner parts are equipped before you use the helmet!