



Instructions for use

Thank you for purchasing your new SHOEI helmet. This manual contains valuable information to help you understand how to operate and maintain your helmet. Please read this manual carefully before use and keep it for future reference. Your SHOEI dealer can provide a replacement if this manual is lost.

**RYD
RF-SR**

English

Read This First	3
Confirm the Packed Items	4
Parts Description	5
Breath Guard	6
Applying Silicone Oil	6
Chin Curtain	7
CWR-1 Shield / Visor	8 - 9
Shield / Visor Adjustment Dial	9
Important Notice about Handling the CWR-1 Shield / Visor	10
PINLOCK® EVO lens	11
Replacing Interior Parts	12
Removing Interior Parts	13 - 14
Ear Pads	14
Installing Interior Parts	15 - 16
Important Notice about Handling Interior Parts	17
E.Q.R.S. (Emergency Quick Release System)	18
WARNING	19
Parts List	19

Read This First

This product is a motorcycle helmet.

Do not use it for any purposes other than riding a motorcycle. If you use the helmet for any other purpose, it may not provide sufficient protection in case of an accident.

No helmet can protect the wearer against all foreseeable high speed and low speed impacts.

For maximum head protection, the helmet must fit properly and the retention system must be securely fastened under the chin. The helmet should allow sufficient peripheral vision when secure on your head. If your helmet is too large, it may slip or move on your head while riding. This could cause your helmet to come off in an accident or obstruct your vision while riding resulting in personal injury or death. To learn to properly wear and secure your helmet, see the booklet "How to Use Your Helmet Properly" that is packed with your helmet.

The contents of this manual are subject to change without notice.

The illustrations in this manual may differ from the actual product.

The copyrights for this manual belong to SHOEI CO., LTD. Reproduction or copying of this manual without written permission is strictly prohibited.

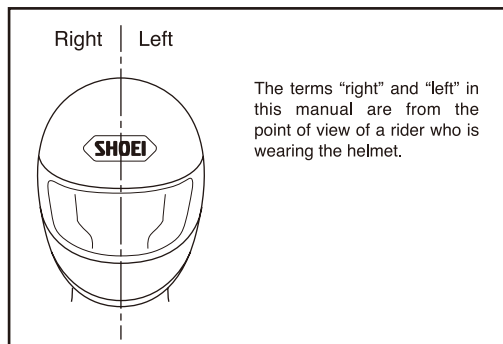

Confirm the Packed Items

After opening the product box, please confirm that all parts and accessories are included.

1. Helmet
2. PINLOCK® EVO lens for CWR-1(DKS301)
3. Breath Guard (for SNELL products)
4. Chin Curtain
5. Helmet Bag
6. Instruction Manual
7. "How to use your helmet properly"
8. Warning label (E-3 tag: for ECE R22 Products)
9. SHOEI logo stickers (2)
10. Silicone Oil



We recommend that you save the box and its cushioning material in case you need to ship the product or its parts for repair. If you dispose of these materials, please follow the proper laws and regulations.

Parts Description

1. Lower Air Intake
2. Defogger Ventilation System
3. CWR-1 Shield / Visor
4. Upper Air Intake
5. Shell
6. QR-E Shield / Visor Base
7. Impact Absorbing Liner
8. Top Air Outlet
9. Chinstrap

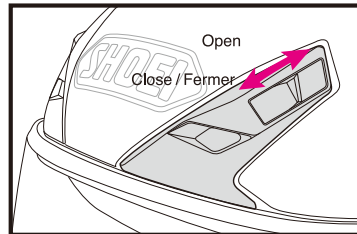
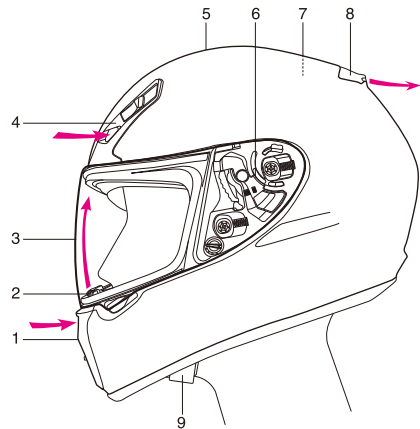

Upper Air Intake

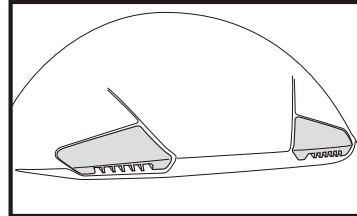

Top Air Outlet

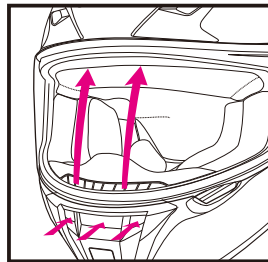

Defogger Ventilation System

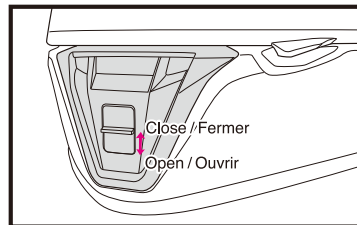

Lower Air Intake

! Opening the vents on the helmet can cause an increase in noise levels.

Breath Guard

The breath guard reduces fogging of the shield / visor caused by breathing. To install the breath guard, use the following procedure.

Installing the Breath Guard

As shown in the drawing, firmly insert the breath guard in the space between the defogger ventilation and the impact absorbing liner.

Removing the Breath Guard

Pull the breath guard from the space between the defogger ventilation and the impact absorbing liner.

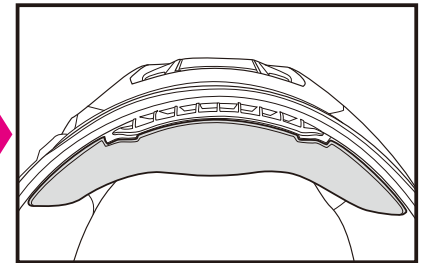
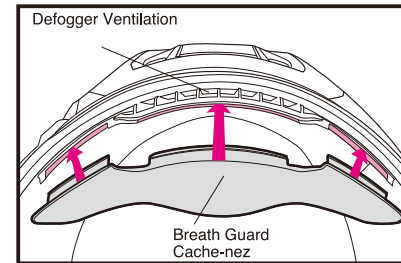

! Do not carry or hold the helmet by the breath guard. The breath guard may come off, causing the helmet to drop.

Applying Silicone Oil

For better sealing of the shield / visor, apply the enclosed silicone oil on the window beading. First, remove any dirt or dust, then apply a small amount of oil to the designated part as per drawing. Wipe away any excess oil. If silicone oil stains the shield / visor, it may obstruct your view. Check for adequate lubrication regularly.

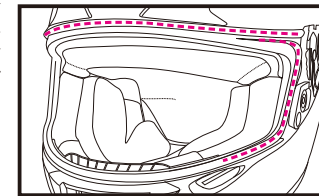

Chin Curtain

The chin curtain reduces the influx of air turbulence and wind noise into the helmet's chin area. The chin curtain can be removed by using the following procedure.

Installing the Chin Curtain

To fix the chin curtain, adjust a center of plate to a center of helmet's front end and insert it in a gap (A) between shell and liner, and then, insert plates of both sides.

Removing the Chin Curtain

To remove, pull out plate of a center portion of the chin curtain, and then, pull out plate of both sides.

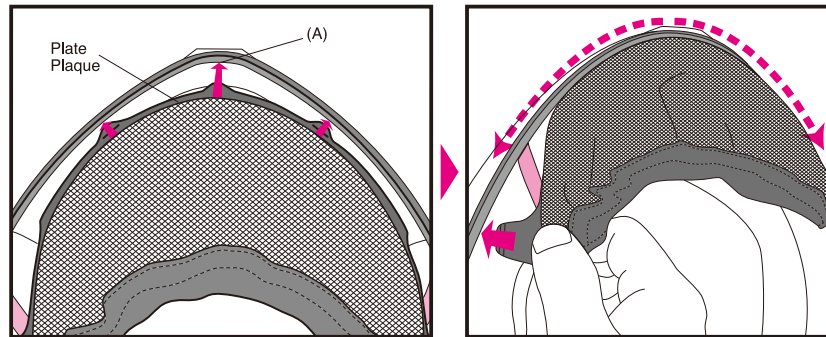

WARNING

1. With the chin curtain is installed, the sound from nearby vehicles will be reduced. Please be aware of this while riding.
2. Do not carry or hold the helmet by the chin curtain. The chin curtain may come off, and the helmet may drop.

CWR-1 Shield / Visor

! Before using the shield / visor for the first time after purchase, remove the protective film from the shield / visor.

If you pull the CWR-1 Shield / Visor completely down, the shield / visor tab will clasp the hook. We recommend that you use the shield / visor in this position while riding your motorcycle.

Removing the CWR-1 Shield / Visor

1. Open a shield/visor to fully opened position as per Drawing 1.
2. Lift a shield/visor pulling a trigger down and release hooks (A) and (B) as per Drawing 2. Then, remove a shield / visor moving hook (C) to an arrowed direction as per Drawing 3.
3. Do in the same manner for the other side.

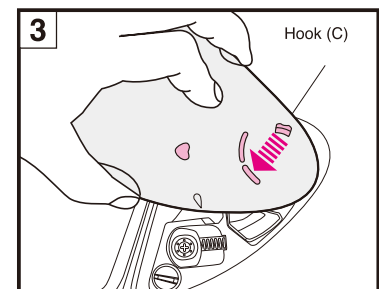
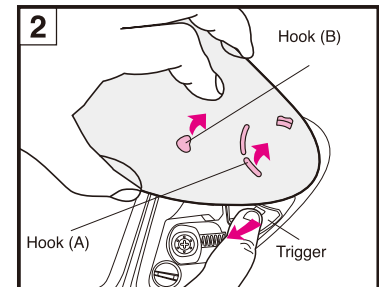
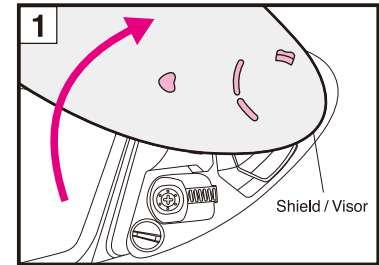
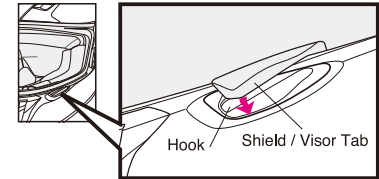

English

Installing the CWR-1 Shield / Visor

1. Adjust a shield / visor to fully opened position and insert shield/visor hook (C) as per Drawing 4.
2. Press an arrowed area of a shield/visor indicated in Drawing 5 until it clicks. Then, insert hooks (A) and (B) securely into positions indicated in Drawing 6.
3. Open and close a shield/visor a few times and make sure that all the hooks are fixed securely.
4. Do in the same manner for the other side.

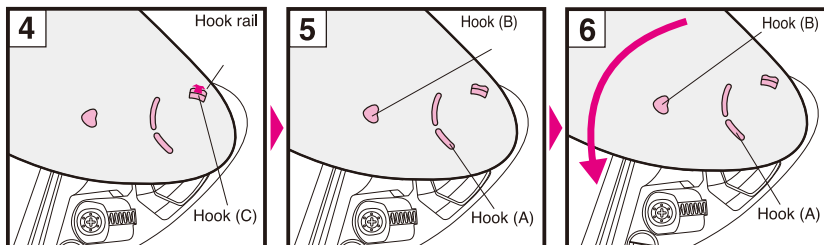

WARNING

If a hook or a gear is not fixed properly to QR-E shield / visor base, a shield / visor may come off while riding and it may cause an accident unexpectedly. After fixing CWR-1 Shield / Visor, open and close the shield / visor a few times and make sure that a hook and a gear are fixed securely as per Drawing 6. And also, close a shield / visor and make sure that a shield / visor knob is hooked.

English

Shield / Visor Adjustment Dial

When there happens a gap between a shield/visor and a window beading, rotate a dial of QR-E shield / visor as per drawing. QR-E shield / visor is fine tuned front and rear and a gap can be adjusted. Dials are located in both sides and can be adjusted in 4 steps using a flat head screwdriver

*Don't rotate a dial out of positions from 0 to 4.

*If a shield / visor is adjusted too tight, a window beading may be deteriorated. Make adjustment watching a condition of a gap carefully.

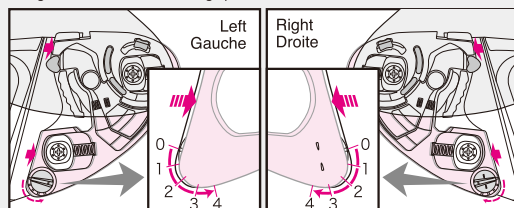

English

Important Notice about Handling the CWR-1 Shield / Visor

1. Dirt and scratches on the shield/visor may obstruct your view while riding and can be very dangerous! If the CWR-1 shield/visor gets dirty or scratched, stop using it immediately. Remove the shield/visor and clean or replace it.
2. The CWR-1 shield/visor should be cleaned with a solution of mild, neutral soap and water. Rinse well with pure water then wipe dry with a soft cloth. **Do not use any of the following cleaning materials: hot water over 40°C; salt water; any acidic or alkali detergent; benzine, thinner, gasoline, or other organic solvents; glass cleaner; or any cleaner containing organic solvents.** If any of these cleaners are used, the shield's/visor's chemical nature may be altered and safety may be hindered.
3. Do not ride with a shield/visor that is fogged. This may obstruct your view and can be very dangerous. If the CWR-1 shield/visor is fogged, open the lower air intake and/or open the shield/visor to circulate air within the helmet and remove the fog from the shield/visor. Use of the PINLOCK® EVO lens is also effective in stopping fog.
4. Always use SHOEI's genuine PINLOCK® EVO lens for CWR-1. For fitting PINLOCK® EVO lens, please read instructions enclosed in it.
5. Remove the protective film before using the shield/visor for the first time.
6. After cleaning or replacing the base plates, close the shield/visor and make sure that it touches the window beading in all around. If there is a gap between the shield/visor and the window beading, adjust a position of the base plate and eliminate the gap, because it may cause roll-in of wind or noise.
7. For tightening screws, apply No.2 size Phillips head screwdriver vertically and rotate it carefully. If improper sized screwdriver or electric screwdriver is used, a screw head may be broken. Use a genuine screw made of aluminum for replacement. If a screw is tightened too much, it may be broken. (Recommended torque: 80 cN·m or about 8 kgf·cm)
8. Do not place any sticker or tape in the shield's/visor's field of vision.

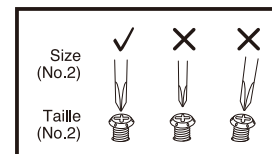

PINLOCK® EVO lens

If you are using the PINLOCK® EVO lens, read the instruction manual that comes packed with it.



1. Daytime use only. Never use PINLOCK® EVO lens at night. If the PINLOCK® EVO lens is used with a clear shield/visor, its light transmission ratio will be approximately 80%. This value does not meet the light transmission standards in the U.S. (VESC-8, 85%), Australia (AS1609, 85%), or Europe (ECE R22, 80%), so this accessory is for "daytime use only" in these jurisdictions.
2. The PINLOCK® EVO lens is made of a material that is easier to scratch than the outer shield/visor. It should be treated with great care.
3. Remove the protective film before using the PINLOCK® EVO lens.
4. The PINLOCK® EVO lens demonstrates high effectiveness in stopping fog by absorbing moisture. However, if the helmet is used continuously with the lower vent in the closed position in low-temperature, high-humidity conditions, the lens can become saturated with water vapor causing streaks and fog to appear. If streaks or fog appears, it may obstruct your view and be very dangerous! In this case, open the lower air intake and/or open the shield/visor to circulate air within the helmet to remove the streaks and fog from the helmet.
5. Purchase DKS301 for CWR-1 for replacement of PINLOCK® EVO lens.

*PINLOCK® is a registered trademark of PINLOCK SYSTEMS B.V.

Replacing Interior Parts

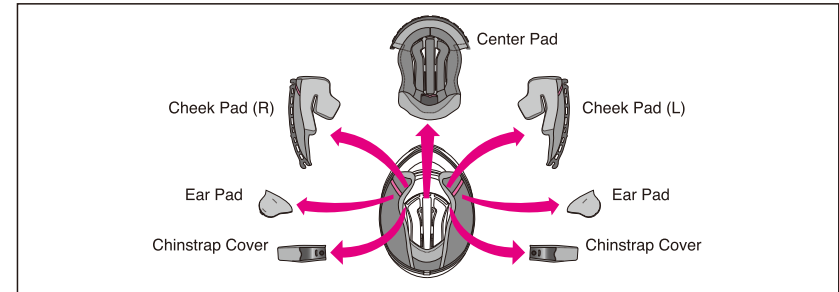

The center pad, the right and left cheek pads and chinstrap covers, and the ear pads can be removed for washing. You can also adjust the fit of your helmet by switching to the optional pads. Look at the list and drawing of interior parts and check whether the parts are installed or removed. Be sure to always fix the center pad, cheek pads, and chinstrap covers prior to riding. If necessary, use the following table to order the proper interior parts to adjust the fit of your helmet.

■ Pad Sizes

		(OP)	XS	S	M	L	XL	XXL
TYPE-K Center Pad	Optional (firm fit)	—	S17	S13	M13	L13	XL13	XL9
	Standard	S17	S13	S9	M9	L9	XL9	XL5
TYPE-K Coussinet central	Optional (loose fit)	S13	S9	S5	M5	L5	XL5	—
RYD / RF-SR Cheek Pad	Optional (firm fit)	—	43			39		35
RYD / RF-SR Coussinet maxillaire	Standard	43	39			35		31
	Optional (loose fit)	39	35			31		—

- The same cheek pads can be used with all helmet sizes. For the M size helmet example, choose cheek pad size 31 if you want a looser fit and size 39 for a firmer fit (both are optional parts).
- Center pads will vary by model size. Confirm the size of your helmet prior to making a purchase.

* Model name and specification vary depending upon country or area.

Removing Interior Parts

1. Removing the Cheek Pads

When the chin curtain is installed, remove it first.

Unfasten the 3 snaps to remove the pad from the cheek pad base (Drawing 1). Pull the notch (a) from the cheek pad bracket (A) as shown in the Drawing 2.

Next, pull the notch (b) from the cheek pad bracket (B) as shown in the Drawing 3. Do not pull it hard. **Be sure to pull the front notch (a) out first. If you pull out the rear notch (b) before pulling out notch (a), the plate may be damaged.**

2. Removing the Ear Pads

Unfasten the 4 clasps on the plate from the cheek pad base (Drawing 4). Remove the ear pad. Remove the other ear pad in the same manner.

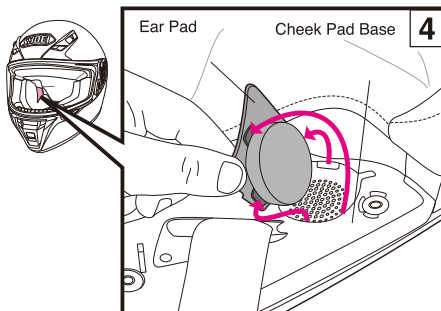
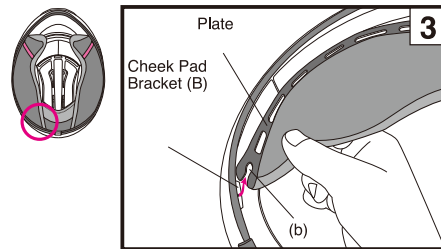
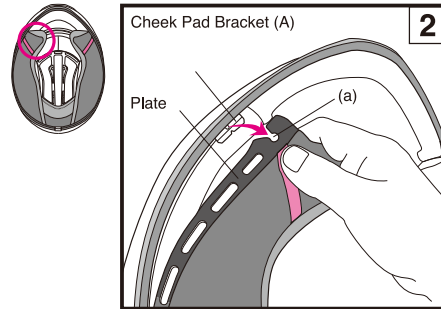
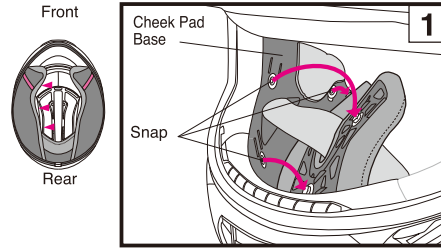

3. Removing the Center Pad

Remove the center pad by unsnapping 2 points at the rear of the helmet first (Drawing 5). Pull the front portion of the center pad from the holding plate as per Drawing 6.

4. Removing the Chinstrap Covers

Remove the cheek pad then unfasten the chinstrap cover snap. Remove the cover from the chinstrap (Drawing 7). Remove the other chinstrap cover in the same manner.

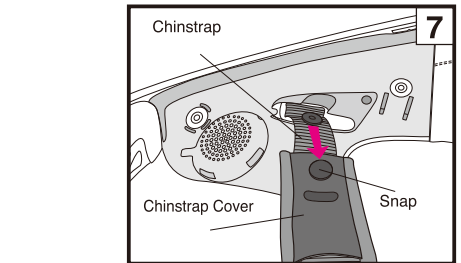
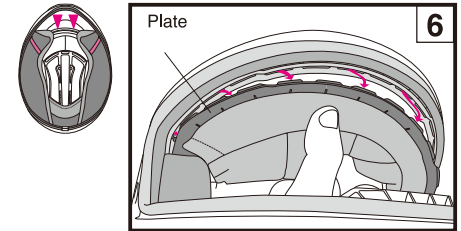
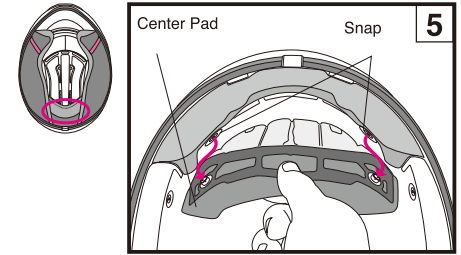

Ear Pads

The ear pads are designed to reduce wind noise. The ear pads can be removed. To remove or install the ear pads, refer to the "Removing Interior Parts" and "Installing Interior Parts" sections.

! With the ear pads are installed, the sound from nearby vehicles will be reduced. Please be aware of this while riding.

Installing Interior Parts

1. Installing the Chinstrap Covers

A chinstrap cover is interchangeable right and left. Pass the chinstrap through a chinstrap cover and snap each other until you hear it clicks (Drawing 8).

2. Installing the Center Pad

Slide and insert front plate into a gap of bracket from one side to another as indicated in Drawing 9 and 10.

Snap the two snaps into place in the rear of the center pad as per Drawing 11.

3. Installing the Ear Pads

Check right and left sides of ear pads and place it adjusting to dotted line of drawing 12. Then, adjust 4 catches to cuts of cheek pad base and press pad. Do in the same manner for other side.

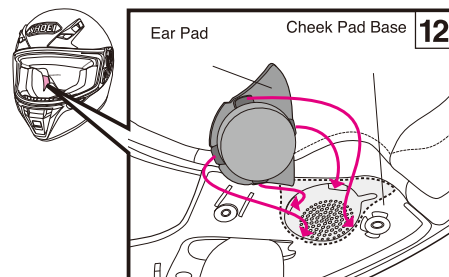
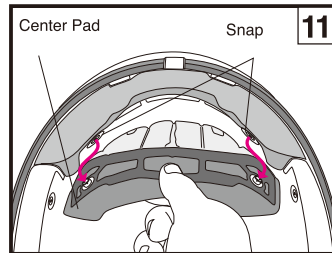
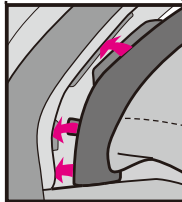
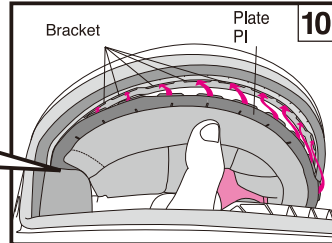
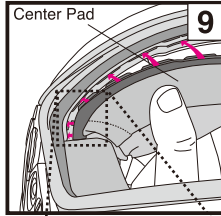
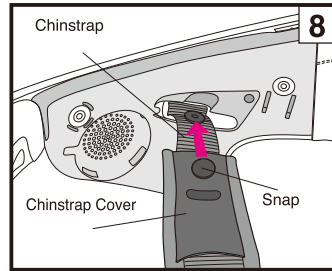

4. Installing the Cheek Pads

Before installing the cheek pads, make sure that the 3 hooks are positioned as per Drawing 13. They may not be hooked if they are not positioned properly.

Identify a right pad and a left pad. Insert a groove (b) of a rear portion of plate into a boss of a cheek pad bracket (B) as per Drawing 14. Then, do frontward and insert a groove (a) of a plate into a cheek pad bracket (A) as per Drawing 15. Make sure to insert a plate deeply. After the plate is inserted, pass the chinstrap through the hollow section of the cheek pad (Drawing 16). Fasten the snaps in ① to ③ order, by pressing the head of the snaps firmly from the pad side until they click in place. Lastly, press the corner (A) of the pad as shown in the Drawing 17 and fit the cheek pad plate securely into the boss of the cheek pad base. Install the other cheek pad in the same manner.

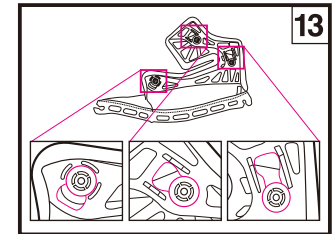

Front



Rear

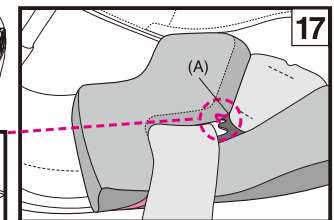
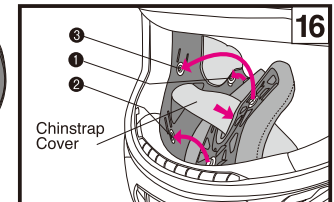
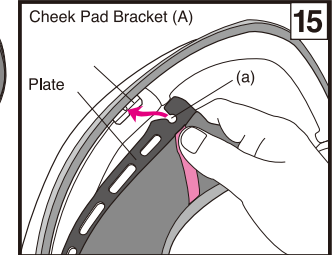
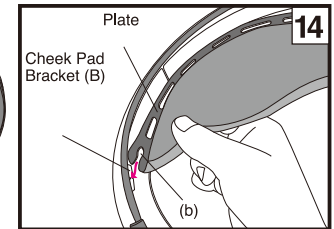

Important Notice about Handling Interior Parts

- When fastening or unfastening the snaps, you should hold near the snaps and treat carefully. Fasten the snaps firmly until they click in place.
- You can clean the inner parts by hand washing them or by washing them in a washing machine after placing them in a laundry net. Please treat them carefully when washing. Use lukewarm water. Gently squeeze the parts with a dry towel and dry them in the shade. To prevent damage to the plastic areas of the interior parts, do not wring them strongly and do not fold or bend the plastic areas. Take special care if you are using a washing machine. Do not dry the interior parts with a clothes dryer, blow dryer, or any other type of mechanical dryer, as heat can damage the material. The impact absorbing liner (polystyrene foam section) should be wet with a soft cloth dipped in a solution of mild neutral soap and water and then wiped. Allow time for the impact absorbing liner to dry in the shade. Do not dry the impact absorbing liner in the sunlight or use any type of mechanical dryer, as the impact absorbing liner is extremely sensitive to heat. If the impact absorbing liner is exposed to high heat of any kind, contact your dealer or SHOEI directly for a safety evaluation. To prevent damage, **do not use any of the following cleaning materials: hot water over 40°C; salt water; any acidic or alkali detergent; benzine, thinner, gasoline, or other organic solvents; glass cleaner; or any cleaner containing organic solvents.**

E.Q.R.S. (Emergency Quick Release System)

E.Q.R.S. (Emergency Quick Release System) is a mechanism for emergency personnel to remove the cheek pads.

To remove a cheek pad in an emergency, cut or undo a chinstrap first. While holding the helmet firmly so that the rider's head may not move, take emergency strip (Drawing 1) and pull it to a direction indicated in the Drawing 2. (If the chin curtain is installed, it must be removed before using the emergency strip.)

Pulling the emergency strip will release snaps and allow a cheek pad to be pulled out through the bottom of the helmet while it is still on the rider's head. Repeat the same procedure to remove the other side.

Be sure to hold the helmet firmly and pay full attention not to move the rider's head while removing the cheek pads.

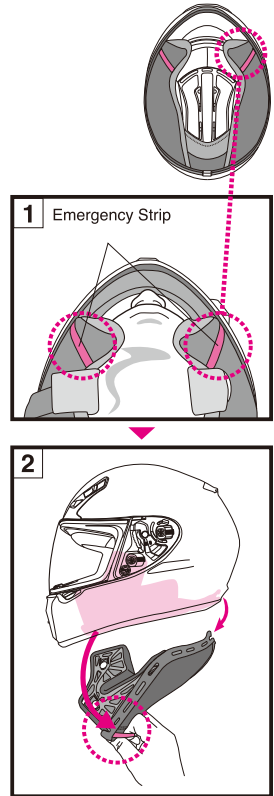

1. Make sure to hold the helmet firmly by your hand when pulling out cheek pads.
2. Use genuine SHOEI cheek pads only and never use non-SHOEI parts.
3. If a chin curtain is installed in the helmet, remove the chin curtain before handling the emergency strip.

⚠ Warnings

1. Never pull the emergency strip while riding.
2. Do not use Emergency Quick Release System when removing a cheek pad for maintenance.

EMERGENCY USE ONLY
PULL RED TAB AND REMOVE CHEEK PAD

◀ Never peel these stickers from a helmet.

WARNING

1. Before use, check that the shield /visor hooks and gears are fit firmly.
2. Be sure to always wear the center pad, cheek pads, and chinstrap covers when using the helmet.
3. When cleaning and caring for the helmet and shield /visor, **do not use any of the following cleaning materials: hot water over 40°C; salt water; any acidic or alkali detergent; benzine, thinner, gasoline, or other organic solvents; glass cleaner; or any cleaner containing organic solvents.** If any of these cleaners are used, the helmet's chemical nature may be altered and safety may be hindered.

- If insects become stuck to the helmet during riding and are left in place, the helmet surface may be corroded. They should be removed promptly.
- Be sure to use SHOEI genuine parts when replacing the outer shield / visor or inner parts.

Parts List

These optional parts are available for repair or replacement.

To replace the parts, read the instruction manual that comes packed with the parts.

- CWR-1 Shield / Visor
- QR-E Shield / Visor Base Plates (right and left)
- Q.R.S.A. Screws
- QR-E Shield / Visor Base Plates & Screw Set
- PINLOCK® lens for CWR-1 (DKS301)
- Upper Air Intake (right and left)
- Top Air Outlet
- Lower Air Intake
- TYPE-K Center Pad
- RYD / RF-SR Cheek Pads (right and left)
- RYD / RF-SR Chinstrap Covers (right and left)
- Ear Pads D (right and left)
- Breath Guard F
- Chin Curtain D

Find out more about helmets we have.