

Advice for correct fitting of the kit: Do not fully tighten the screws until sure that the kit is correctly positioned and aligned. Note: this support is not compatible for original lateral suitcases of BMW.

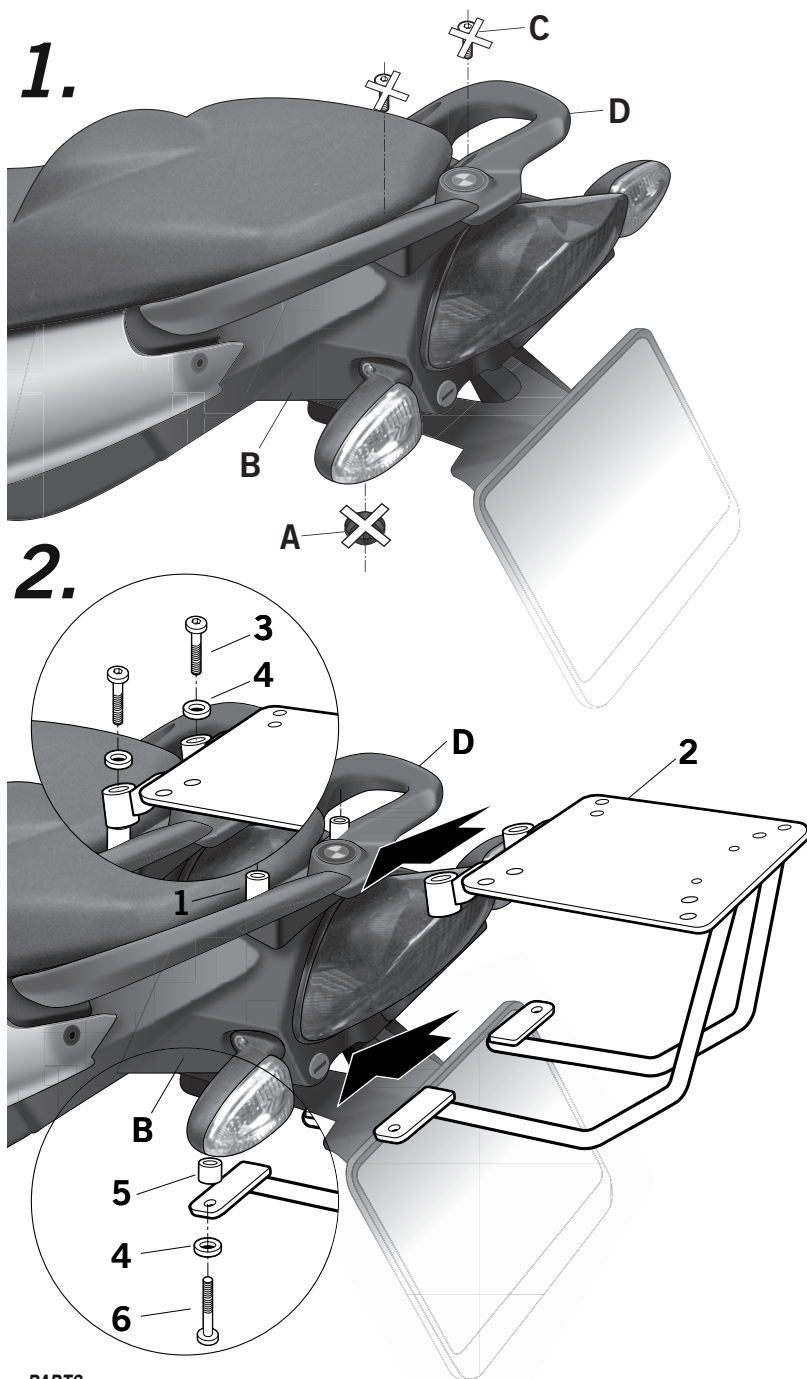

Dismantle and remove the inferior covers (A) of the back mudguard (B). Dismantle and remove the screws (C) from handgrip (D).

Place the spacers (1) in the handgrip (D). Assemble the KIT TOP support (2) in the handgrip zone (D) using spacers (1), screws (3) and washers (4); and in the inferior zone of the mudguard (B) using spacers (5), screws (6) and washers (4).

PARTS :

Pos.	Ref.		Cant.	
1	260641		2	Ø16 Ø9 x 22 - Spacer
2	261363		1	KIT TOPMASTER
3	304174		2	M8 x 80 DIN 7380 - Screw
4	303020		4	Ø8 - Washer -
5	260461		2	Ø16 Ø11 x 43 - Spacer
6	304173		2	M8 X 75 DIN 7380 - Screw