

1. Open the seat (A).
Remove the back cushion (B), with the interior screw (C). Note: use a screwdriver with a magnetised point, to facilitate the job.

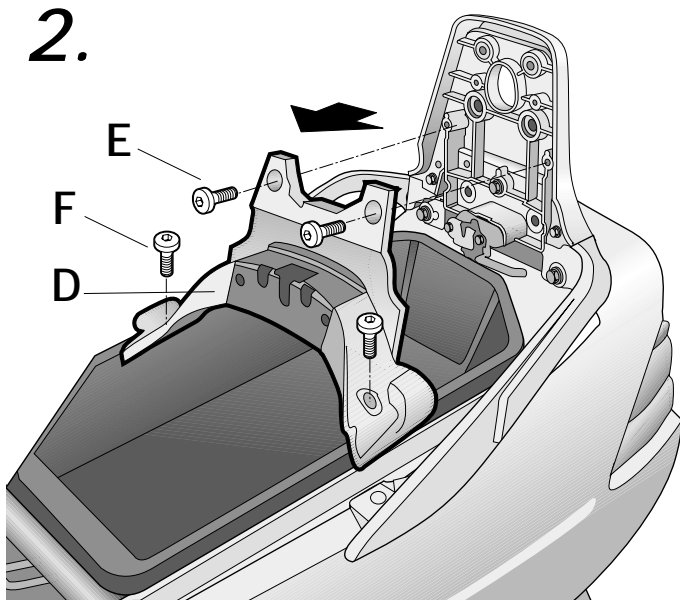

2. Remove the back hubcap (D) with the screws (E) and the screws (F).

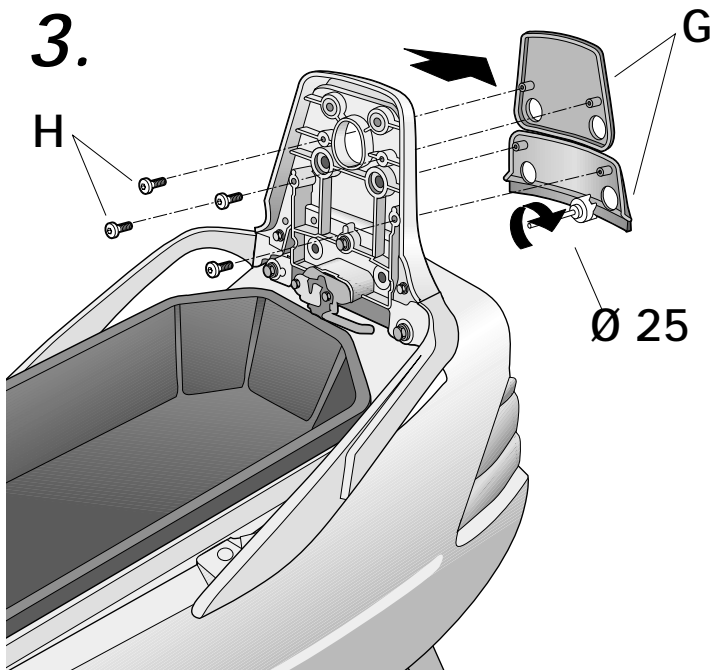

3. Remove the small back caps (G) with the screws (H).
Make the holes Ø25 in the interior marks of the small lids, and once they have holes, mount them once again with the screws (H).

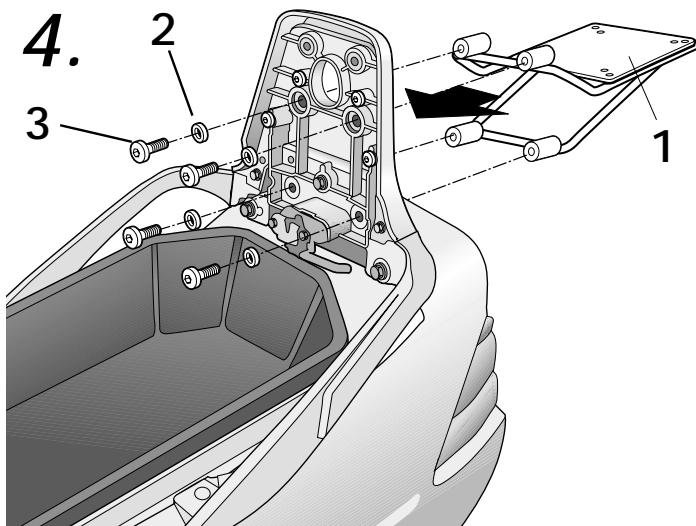

Mount kit top (1), on the back support, with the washers (2) and the screws (3).
Note: Secure the kit top (1), so that it is well centred before tightening the screws (3).

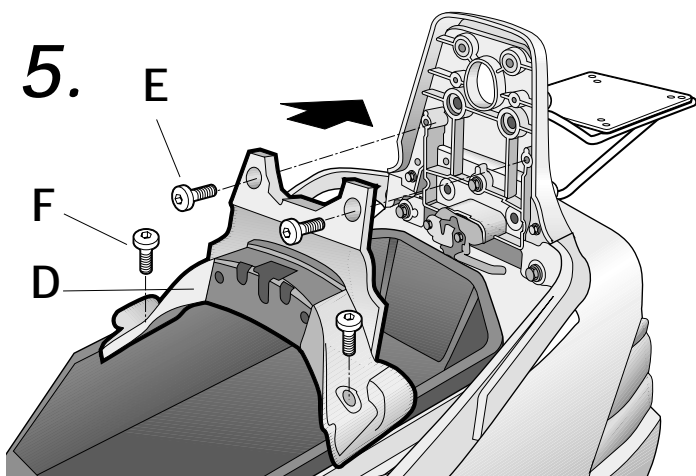

Mount the back hubcap (D) with the screws (E) and the screws (F).

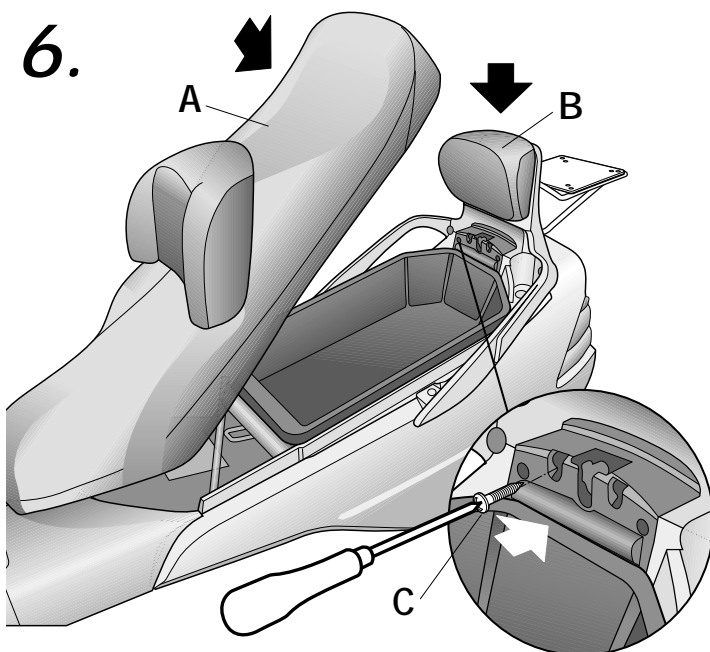

Mount the back cushion (B) with the screws (C). Note: Use the magnetised screwdriver again.
Close the seat (A).

PARTS:

Pos.	Ref.		Cant.	
1	260653		1	KIT TOP
2	303025		4	M10 - Washer -
3	304051		4	M10 x 25 DIN 7380 - Screw