

SHAD

HONDA CMX 500 REBEL '17-'18 KIT SISSY BAR HORB57SN

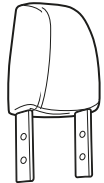

1 H1RC00 x1

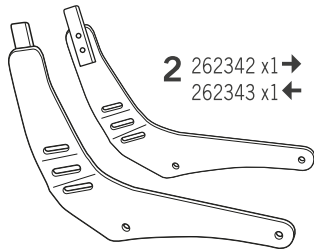

2 262342 x1 →
262343 x1 ←



3 304211 x4
M8 x 15 DIN 933



4 303020 x8
Ø8



5 304053 x4
M8 x 30 DIN 7380



6 303045 x8
Ø8

! WARNING!

Do not fully tighten the screws until it is ensured that the KIT is correctly attached and aligned.

ATTENTION: For a full equip assembly, mount the 3p system after the Sissy Bar.

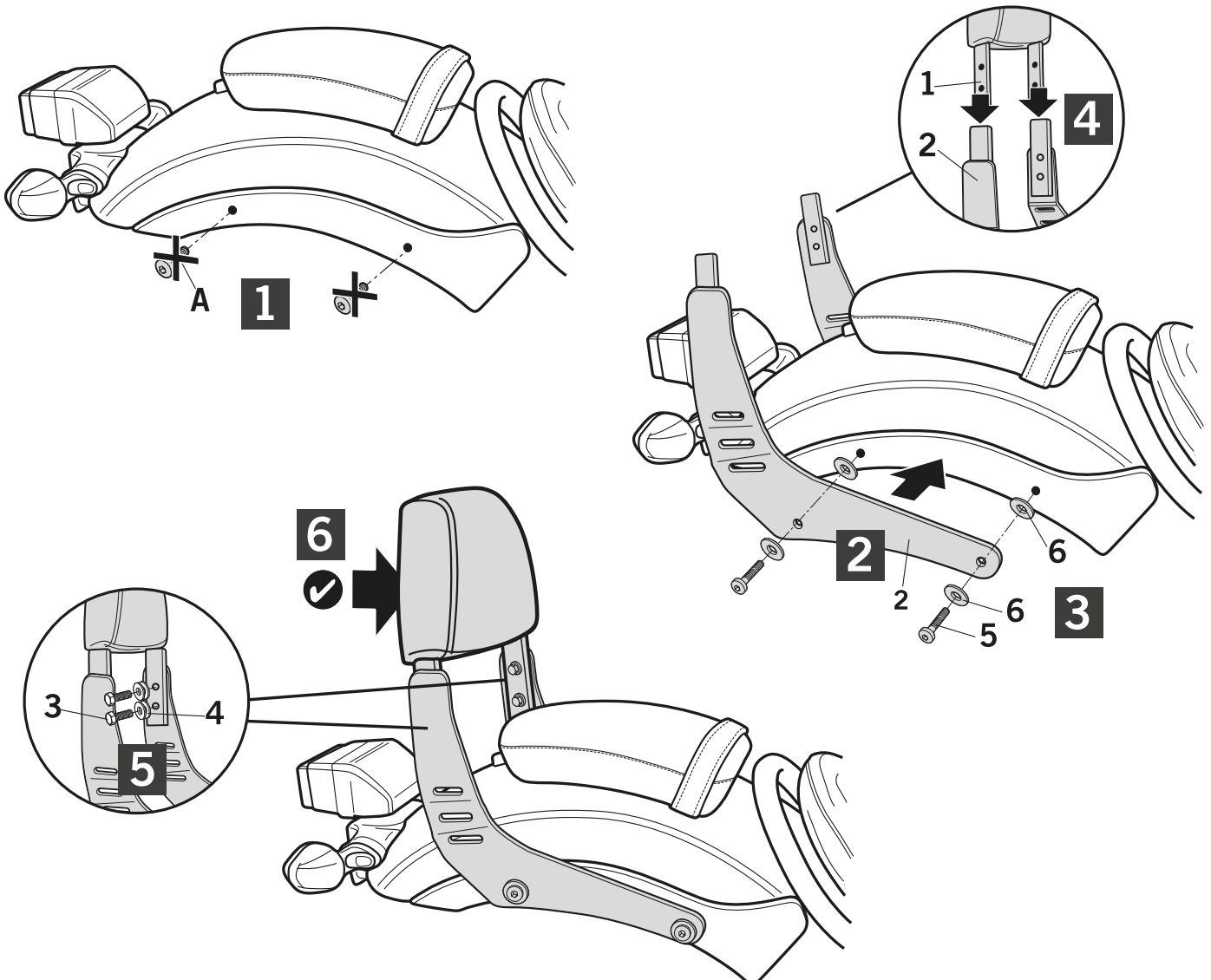

SISSY BAR + 3P SYSTEM SH23

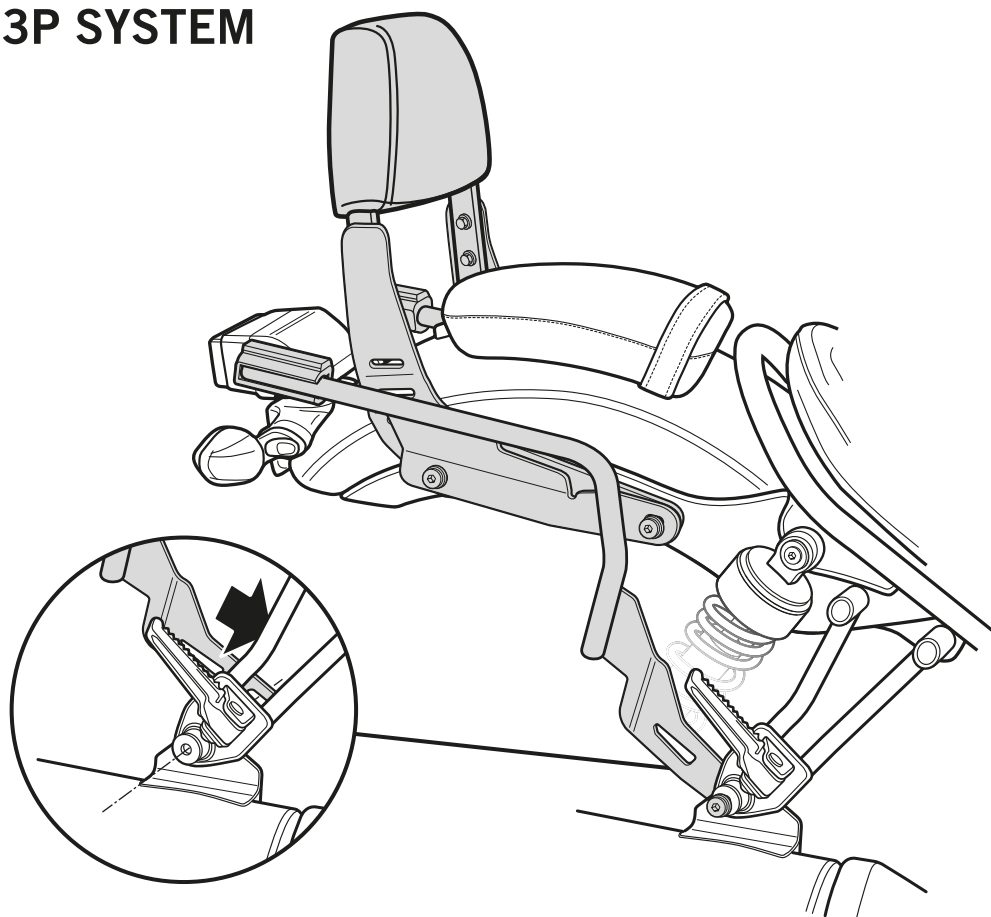

SISSY BAR + 3P SYSTEM SH35/SH36

