

# SH46

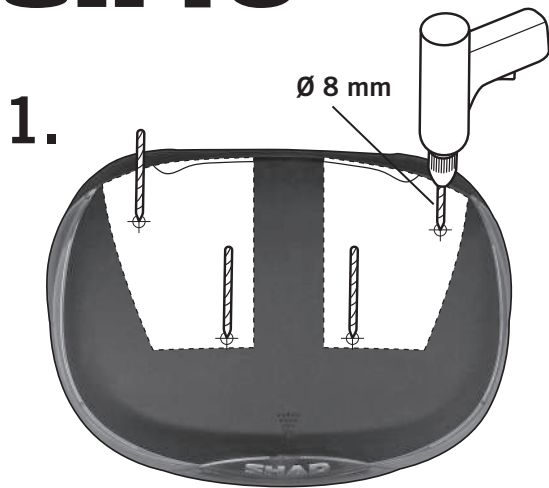

## BAG SUPERIOR SUPPORT

SUGGESTIONS FOR THE CORRECT ASSEMBLY OF THE KIT: Before the screws are completely tightened, make sure that the KIT is properly placed and aligned.

### ASSEMBLING BAG SH46

Put the template as the draw shows; mark it and make the holes of Ø8. Note: check the marks are properly made by placing the grid (8) over such marks, in order to identify if a little modification is needed. It is also recommended to make the holes as perpendicular as possible.

Assemble the top grid (8) to the front area at the bag interior by means of the washers (4), the screws (3), and the little seal (5); and at the top area using the big seals (6).

In the rear area at the bag interior by using the washers (4), the screws (2), and the little seals (5). And in the top area using the big seals (6) and the spacers (7). Finally, assemble the foamed stickers (1) over the screws.



#### PARTS

POS.	REF.	CANT.	
1	201061	4	Foamed Steacker
2	304079	2	M6 x 30 DIN 7380 - Screw
3	304052	2	M6 x 20 DIN 7380 - Screw
4	303017	4	Special washer
5	200418	4	Little O-ring Seal
6	261603	4	Big O-ring Seal
7	260213	2	Ø16 Ø9 x 12 - Distancers
8	261590	1	Bag Superior Support

SOPORTE SUPERIOR MALETA  
D0PS00

SHAD

# SH48

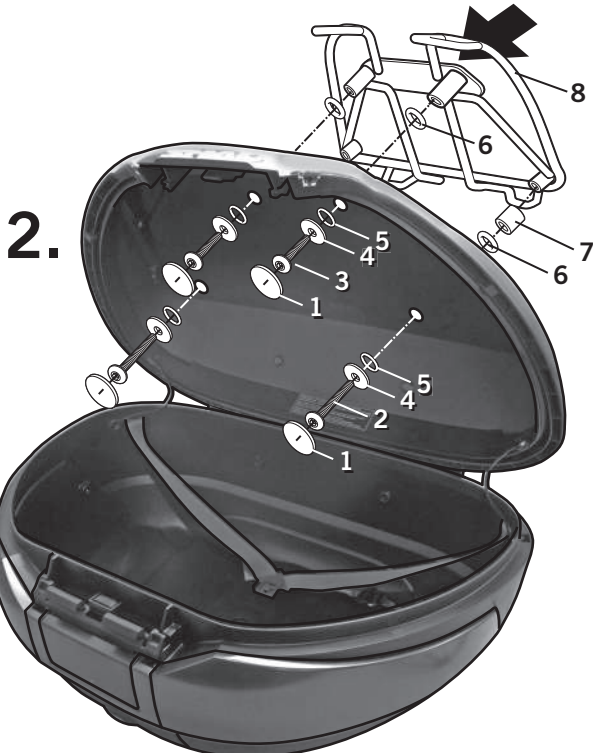

## BAG SUPERIOR SUPPORT

*SUGGESTIONS FOR THE CORRECT ASSEMBLY OF THE KIT: Before the screws are completely tighten, make sure that the KIT is properly placed and aligned.*

### ASSEMBLING BAG SH48

*Put the template as the draw shows; mark it and make the holes of  $\varnothing 8$ . Note: check the marks are properly made by placing the grid (8) over such marks, in order to identify if a little modification is needed. It is also recommended to make the holes as perpendicular as possible.*

*Assemble the top grid (8) to the front area at the bag interior by means of the washers (4), the screws (3), and the little seal (5); and at the top area using the big seals (6). In the rear area at the bag interior by using the washers (4), the screws (2), and the little seals (5). And in the top area using the big seals (6) and the spacers (7). Finally, assemble the foamed stickers (1) over the screws.*

#### PARTS

POS.	REF.	CANT.	
1	201061	4	Foamed Steacker
2	304079	2	M6 x 30 DIN 7380 - Screw
3	304052	2	M6 x 20 DIN 7380 - Screw
4	303017	4	$\varnothing 6$ - Special washer
5	200418	4	Little O-ring Seal
6	261603	4	Big O-ring Seal
7	260213	2	$\varnothing 16 \varnothing 9 \times 12$ - Distancers
8	261590	1	Bag Superior Support

# SH49

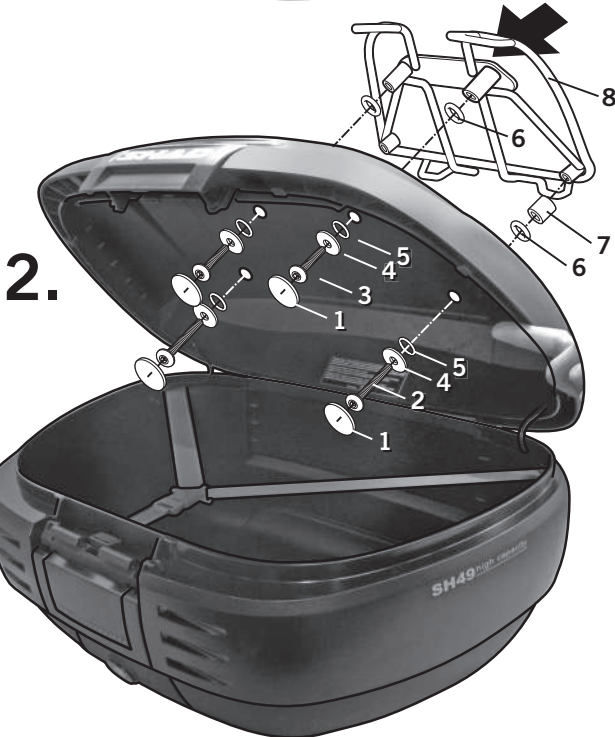

## BAG SUPERIOR SUPPORT

*SUGGESTIONS FOR THE CORRECT ASSEMBLY OF THE KIT: Before the screws are completely tighten, make sure that the KIT is properly placed and aligned.*

### ASSEMBLING BAG SH49

*Put the template as the draw shows; mark it and make the holes of Ø8. Note: check the marks are properly made by placing the grid (8) over such marks, in order to identify if a little modification is needed. It is also recommended to make the holes as perpendicular as possible.*

*Assemble the top grid (8) to the front area at the bag interior by means of the washers (4), the screws (3), and the little seal (5); and at the top area using the big seals (6). In the rear area at the bag interior by using the washers (4), the screws (2), and the little seals (5). And in the top area using the big seals (6) and the spacers (7). Finally, assemble the foamed stickers (1) over the screws.*

#### PARTS :

POS.	REF.	CANT.	
1	201061	4	Foamed Steacker
2	304079	2	M6 x 30 DIN 7380 - Screw
3	304052	2	M6 x 20 DIN 7380 - Screw
4	303017	4	Ø6 - Special washer
5	200418	4	Little O-ring Seal
6	261603	4	Big O-ring Seal
7	260213	2	Ø16 Ø9 x 12 - Distancers
8	261590	1	Bag Superior Support

# SH50



## BAG SUPERIOR SUPPORT

*SUGGESTIONS FOR THE CORRECT ASSEMBLY OF THE KIT: Before the screws are completely tighten, make sure that the KIT is properly placed and aligned.*

### ASSEMBLING BAG SH50

*Put the template as the draw shows; mark it and make the holes of Ø8. Note: check the marks are properly made by placing the grid (8) over such marks, in order to identify if a little modification is needed. It is also recommended to make the holes as perpendicular as possible.*

*Assemble the top grid (8) to the front area at the bag interior by means of the washers (4), the screws (3), and the little seal (5); and at the top area using the big seals (6). In the rear area at the bag interior by using the washers (4), the screws (2), and the little seals (5). And in the top area using the big seals (6) and the spacers (7). Finally, assemble the foamed stickers (1) over the screws.*

#### PARTS

POS.	REF.	CANT.	
1	201061	4	Foamed Steacker
2	304079	2	M6 x 30 DIN 7380 - Screw
3	304052	2	M6 x 20 DIN 7380 - Screw
4	303017	4	Ø6 - Special washer
5	200418	4	Little O-ring Seal
6	261603	4	Big O-ring Seal
7	260213	2	Ø16 Ø9 x 12 - Distancers
8	261590	1	Bag Superior Support

# SHAD

## SH46



# SHAD

## SH46



# SHAD

## SH48



# SHAD

## SH48





# SHAD

## SH49



# SHAD

## SH49



# SHAD

## SH50



# SHAD

## SH50



Shop for other luggage systems & saddlebags more on our website.