

Accessories

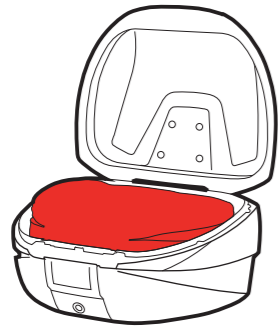

Inner Bag

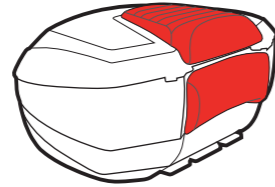

Backrest

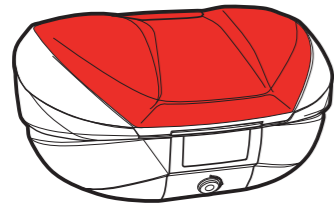

Colour cover

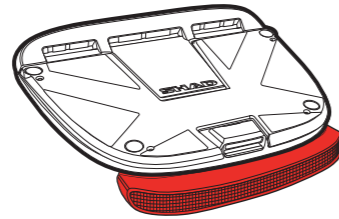

Brake light

Other Shad Products

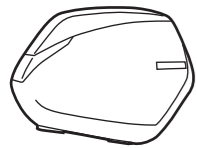

Top & Side Cases

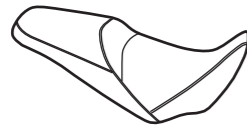

Comfort Seats

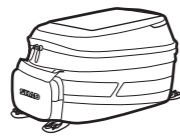

Soft Bags

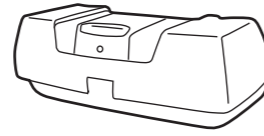

ATV luggage

Top case assembly

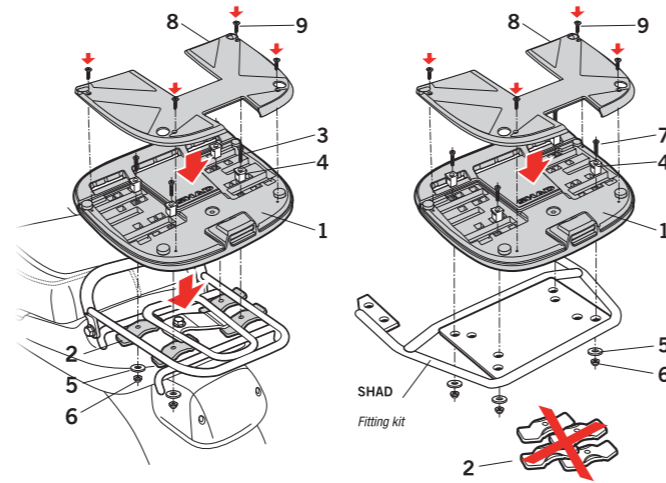

Number	Reference	Quantity
1	201834 (Support piece)	1
2	201049 (Bridle)	4
3	304144 (Screw M6x40 DIN 965)	4
4	200713/2 (Plastic bridle)	4
5	303000 (Ø6 Washer fs M6 DIN 125 A)	4
6	302021 (M6 Nut M6 DIN 985)	4
7	304058 (Screw M6x30 DIN 965)	4
8	201835 (Cover support piece)	1
9	304127 (Screw Ø3'5x13 DIN 7982)	4
10	201504 (Metal piece) *	4
11	304074 (Screw M8x20 DIN 912) **	4
12	303020 (Ø8 Washer fs M8 DIN 125 A) **	4
13	302024 (Nut M8 DIN 985) **	4

(GB) Note: Consult accessories with your distributor.
 (*) It can only be used on the Top or Full master.
 (**) Included in the specific support.

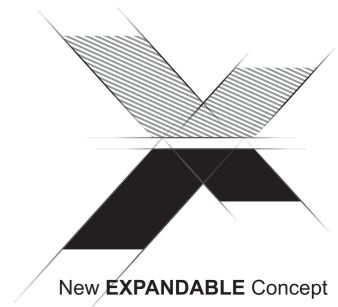
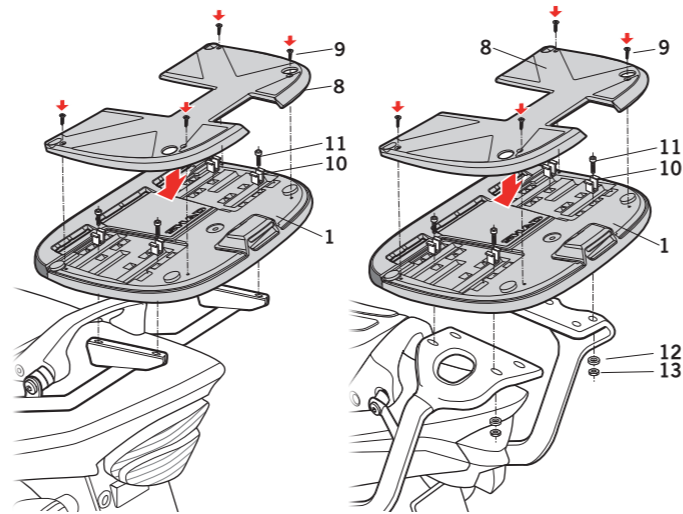

New EXPANDABLE Concept



Daily
From your early mornings until your late nights



XL Weekend
For your non-stop Getaways

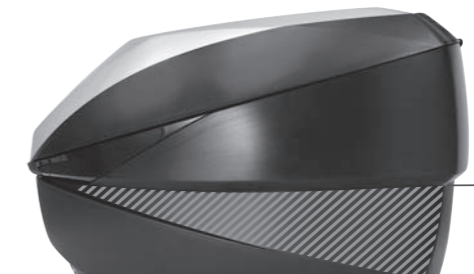

XXL Holidays
Conquer your next adventure



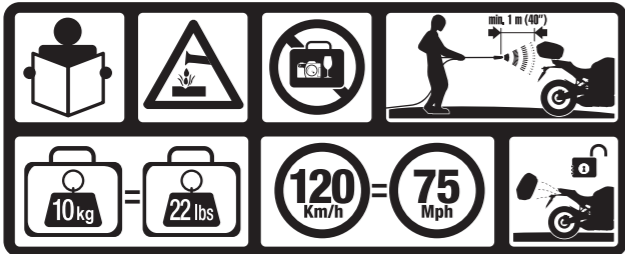

Easy to Expand

6"

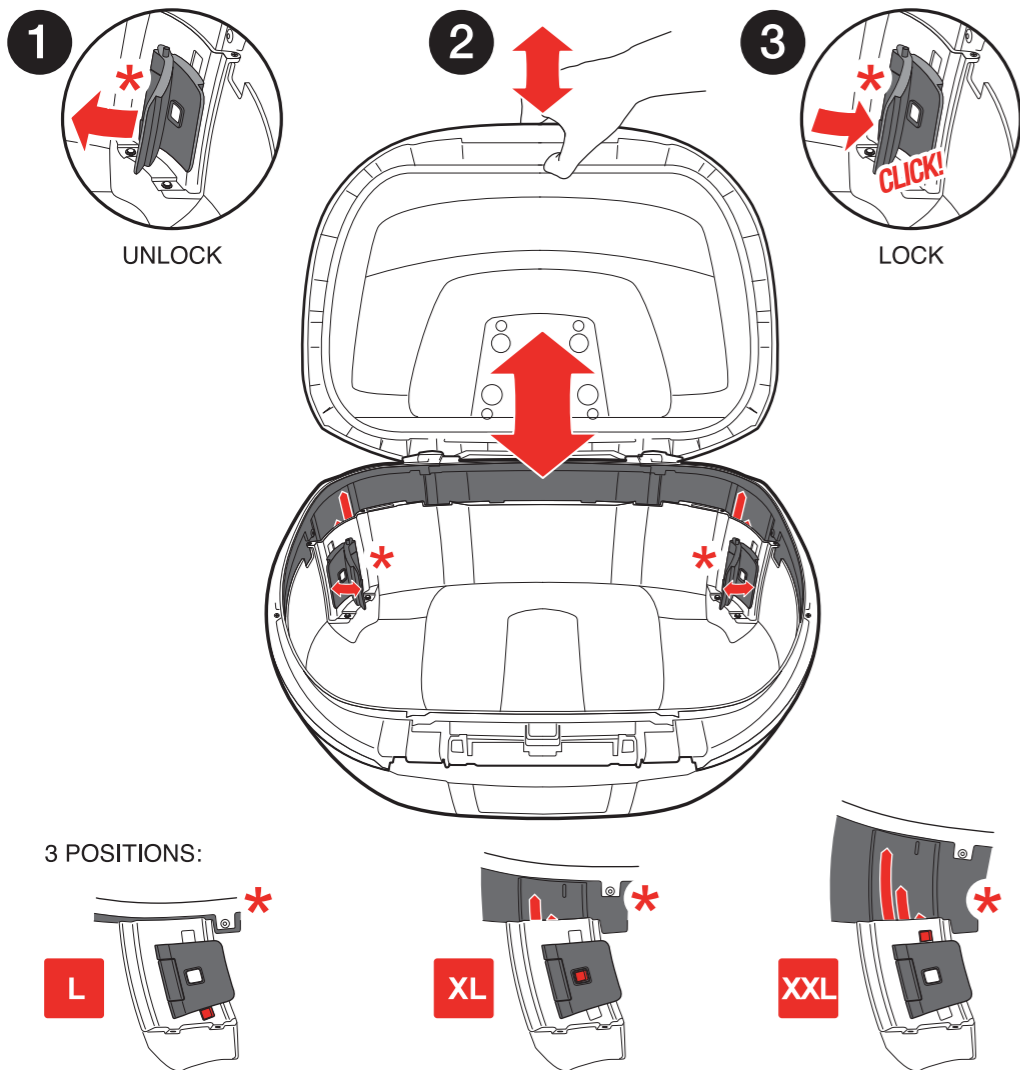

Open

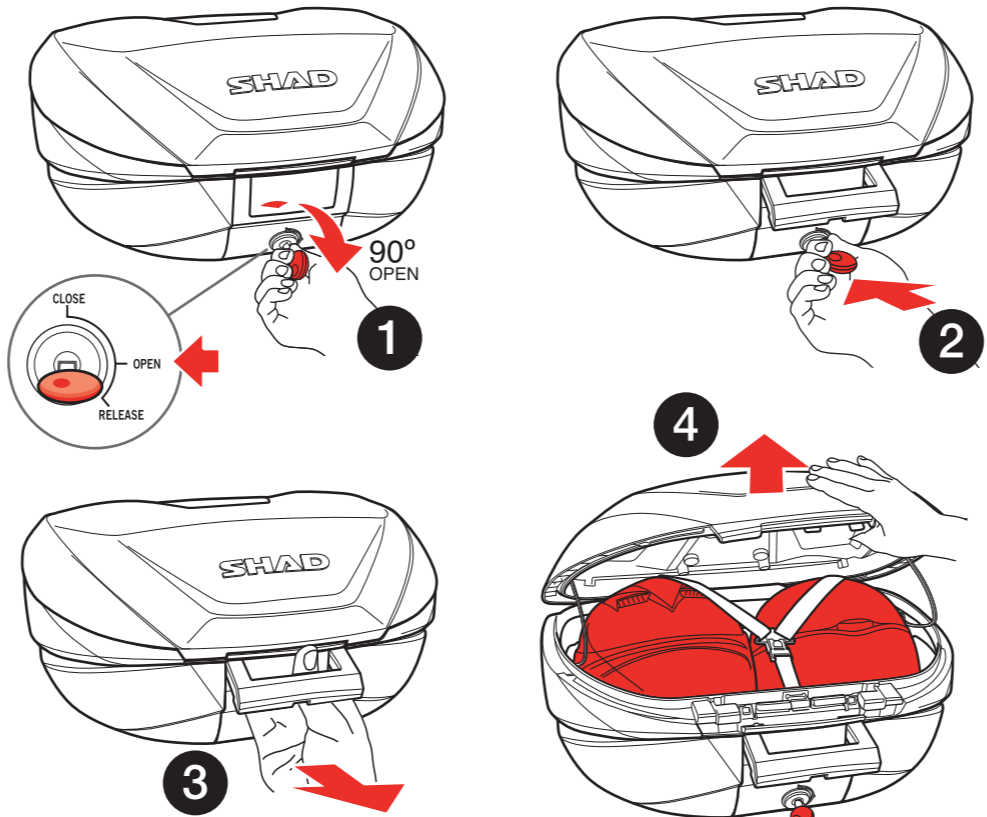

Close

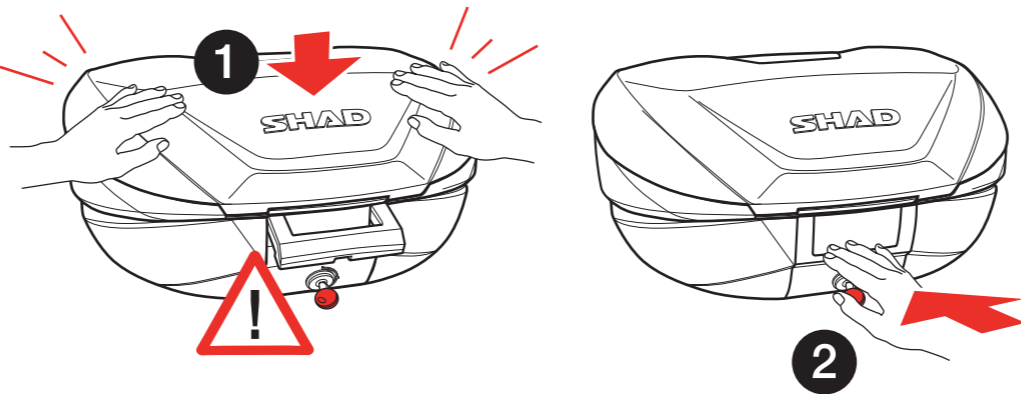

Release

