

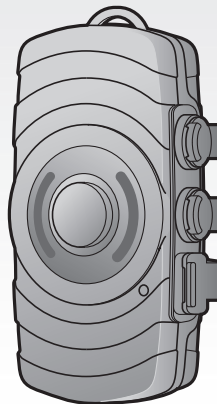

FREEWIRE

Bluetooth® CB and Audio Adapter



© 1998-2016 Sena Technologies, Inc. All rights reserved.

Sena Technologies, Inc reserves the right to make any changes and improvements to its product without providing prior notice.

Sena™ is a trademark of Sena Technologies, Inc. or its subsidiaries in the USA and other countries. FreeWire™, Prism™, Bluetooth Audio Pack for GoPro®, Tufftalk™, 20S™, 10S™, 10C™, 10U™, 10R™, 3S™, SMH10™, SMH10R™, SMH5™, SMH5-FM™, SMH3™, SPH10™, SPH10H™, SPH10H-FM™, SPH10S™, Expand™, Bluetooth Mic&Intercom™, Handlebar Remote™, Wristband Remote™, SM10™, SR10™, SR10i™ are trademarks of Sena Technologies, Inc. or its subsidiaries. These trademarks may not be used without the express permission of Sena.

GoPro® is a registered trademark of Woodman Labs of San Mateo, California. Sena Technologies, Inc. (“Sena”) is not affiliated with Woodman Labs. The Sena Bluetooth Pack for GoPro® is an after-market accessory specially designed and manufactured by Sena Technologies, Inc. for the GoPro® Hero3 and Hero4 allowing for Bluetooth capabilities. Harley-Davidson® is a registered trademarks of H-D Michigan, Inc. and Harley-Davidson, Inc. Honda® and Gold Wing® are trademarks of Honda Motor Co., Ltd. Sena is not affiliated with Harley-Davidson, H-D Michigan, Inc. or Honda Motor Co., Ltd. Other trademarks and tradenames are those of their respective owners.

The Bluetooth® word mark and logos are owned by the Bluetooth SIG, Inc. and any use of such marks by Sena is under license.

CONTENTS

1	INTRODUCTION	4	CERTIFICATION AND SAFETY APPROVALS	12
2	PACKAGE CONTENTS	5	• FCC Compliance Statement	12
	2.1 FreeWire for Harley-Davidson Package	5	• FCC RF Exposure Statement	12
	2.2 FreeWire for Honda Goldwing Package	6	• FCC Caution	12
3	INSTALLING THE FREEWIRE	7	• CE Declaration of Conformity	13
	3.1 Installing on the Handlebar	7	• Industry Canada Statement	13
	3.2 Placing on the Mounting Cradle	8	• Bluetooth License	13
4	POWERING ON/OFF AND CHARGING	8	• WEEE (Waste Electrical and Electronic Equipment)	13
	4.1 Powering On/Off	8	SAFETY INFORMATION	14
	4.2 Battery Check	8	• Product Storage and Management	14
	4.3 Charging	8	• Product Use	14
5	PAIRING THE FREEWIRE WITH SENA BLUETOOTH DEVICES	9	• Battery	15
6	USING THE FREEWIRE	9	MAINTENANCE AND CARE	16
	6.1 Connections	9		
	6.2 Using with a headset	10		
	6.3 Reset to Factory Default Settings	10		
	6.4 Fault Reset	10		
7	OPERATION QUICK REFERENCE	11		

1 INTRODUCTION

Thank you for choosing the Sena FreeWire. The FreeWire is a Bluetooth CB radio and audio adaptor. You can connect the FreeWire to the motorcycle onboard audio system and make the audio system transfer stereo audio (music, FM radio, navigation etc.) to a Sena Bluetooth headset. The FreeWire only supports Sena Bluetooth headsets of 10 Series and above such as 20S, 10S, 10C, 10R, and 10U.

You can communicate through the built-in CB radio in the onboard audio system using the FreeWire. Also, if you have a mobile phone connected to the motorcycle onboard audio system by a cable, you can have mobile phone calls using your headset.

When a rider and a passenger connect the FreeWires to each port and pair a Sena headset to each FreeWire, they can communicate with each other using the bike's internal communication network.

The FreeWire features:

- Support for onboard built-in CB radio communication
- Wirelessly stream stereo audio to Sena Bluetooth headset
- Support for internal communication between a rider and a passenger each using a FreeWire
- AUX input for GPS, radar detector or laser detector
- Mix the audio sources from the AUX input and the onboard audio system
- 12V bike-powered cigarette charger with On/Off controlled by the ignition switch
- Firmware upgradeable

Technical Specifications:

- Bluetooth 4.1
- Advanced Audio Distribution Profile (A2DP)
- Operating time: 7 hours
- Battery charging time: 2.5 hours
- Lithium polymer battery
- Dimensions: 83 mm X 45 mm X 25 mm (3.3 in X 1.8 in X 1.0 in)
- Weight: 50 g (1.76 oz)
- CE, FCC, IC

2 PACKAGE CONTENTS

2.1 FreeWire for Harley-Davidson Package

• **Main Unit**

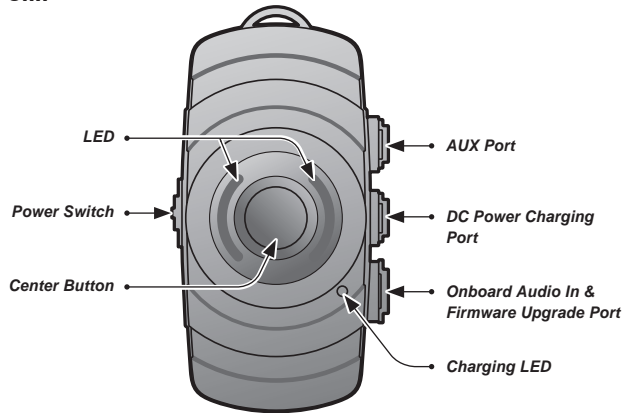

• **Handlebar Mounting Kit**



• **Mounting Cradle**



• **USB Power & Data Cable (Micro USB type)**



• **Micro USB to 7 Pin DIN Cable for Harley-Davidson**

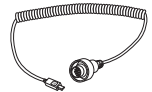

• **3.5 mm Stereo Audio Cable - Straight**

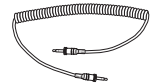

• **Cigarette Charger (Jack Type)**

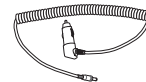

2.2 FreeWire for Honda Goldwing Package

• **Main Unit**

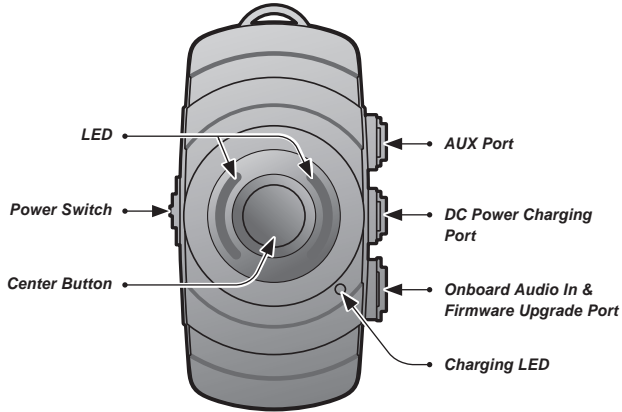

• **Handlebar Mounting Kit**



• **Mounting Cradle**



• **USB Power & Data Cable (Micro USB type)**



• **Micro USB to 5 Pin DIN Cable for Honda Goldwing**



• **3.5 mm Stereo Audio Cable - Straight**

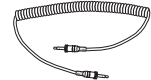

• **Cigarette Charger (Jack Type)**



3 INSTALLING THE FREEWIRE

3.1 Installing on the Handlebar

1. Attach the mounting kit on the back of the FreeWire along the guide rail.

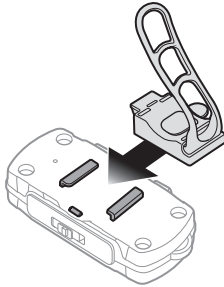

2. Place the main unit on the handlebar, wrap the rubber band around the handlebar, and hang it on the hook.

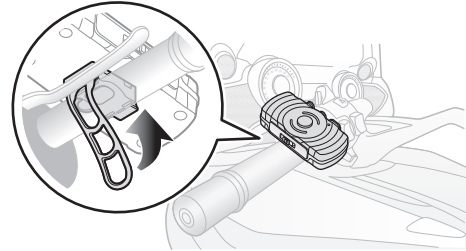

3.2 Placing on the Mounting Cradle

1. Locate a proper surface on your motorcycle body, clean the body surface location with a moistened towel, and allow to dry thoroughly.
2. Peel off the cover of the adhesive tape of the mounting cradle and attach the unit to the proper surface of your motorcycle.

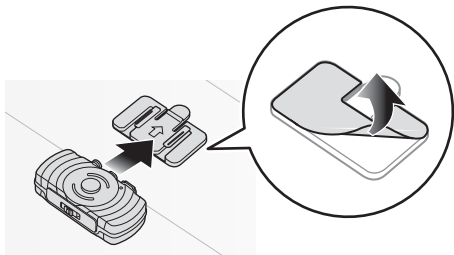

4 POWERING ON/OFF AND CHARGING

4.1 Powering On/Off

To power on the FreeWire, slide the Power Switch to on. The Blue LED will turn on. To power off, slide the Power Switch to off.

4.2 Battery Check

When the FreeWire is powering on, the Red LED flashes rapidly indicating the battery level.

4 flashes = High, 70 ~ 100%

3 flashes = Medium, 30 ~ 70%

2 flashes = Low, 0 ~ 30%

4.3 Charging

It takes about 2.5 hours to be completely charged. The Charging LED will change from solid red to solid blue when it is completely charged.

Note:

The FreeWire is automatically powered on and off by using the cigarette charger included in the package.

5 PAIRING THE FREEWIRE WITH SENA BLUETOOTH DEVICES

The FreeWire must be paired with a Sena Bluetooth headset to connect with the onboard audio system. Please take the following steps to pair with your Sena Bluetooth headsets.

1. Turn on your Sena Bluetooth headset and enter Mobile Phone Pairing Mode, following the Sena Bluetooth headset manual.
2. Turn on the FreeWire and press and hold the Center Button for 5 seconds until the LED flashes red and blue alternatively.
3. When the pairing is successful, the blue LED flashes slowly.

6 USING THE FREEWIRE

6.1 Connections

The FreeWire has one Onboard Audio In Port for wired connection with the onboard audio system and one AUX Port for wired connection with other devices.

- Onboard Audio In: Onboard audio system input
 - To connect the Harley-Davidson audio system with the FreeWire, use the included Micro USB to 7 Pin DIN cable.
 - To connect the Honda Goldwing audio system with the FreeWire, use the included Micro USB to 5 Pin DIN cable.
- AUX: Auxiliary audio input
 - To connect extra devices such as navigation, radar detector, or laser detector with the FreeWire, use the included 3.5 mm Stereo Audio Cable. The AUX signal mixes with the motorcycle onboard audio system.

Note:

Whenever there is an incoming AUX signal, the volume of Onboard Audio In is reduced to a certain level.

6.2 Using with a headset

1. Turn on Bluetooth headset that is already paired with the FreeWire.
2. Turn on audio devices that are connected to the FreeWire.
3. Power on the FreeWire.
4. The FreeWire will automatically connect to the paired Bluetooth headset. Once connected, you will be able to hear the audio.
5. If you can't hear any audio, press the Center Button of the FreeWire. The FreeWire tries to connect the paired Bluetooth headset again.

Note:

If there is a GPS system connected to the FreeWire, the turn-by-turn navigation audio will not be heard if you have a conversation on your phone or intercom. This is due to the set priority within the FreeWire.

6.3 Reset to Factory Default Settings

1. Power on the FreeWire and press the Center Button on the FreeWire for 14 seconds until the LED becomes solid red.
2. Within 10 seconds, press the Center Button to confirm reset. The FreeWire will be restored to factory settings and returns to stand-by mode.

Note:

If you reset your headset paired with your FreeWire to factory default settings, you should reset your FreeWire to factory default settings as well in order to pair them again.

6.4 Fault Reset

If the FreeWire is not working properly or is in a faulty status for any reason, you may reset by pushing the small reset button at the back of the FreeWire Unit. By using a paperclip or a pencil tip, lightly press and hold the reset button for 1 second. The FreeWire will be switched off and automatically switched on again. Turn the FreeWire back on to use it. However, this will not restore the FreeWire to factory default settings.

7 OPERATION QUICK REFERENCE

- Buttons

Button	Description	Duration	LED
Power Switch ON	Power on	-	Solid blue
Power Switch OFF	Power off	-	LEDs off
Center Button	Headset Pairing	5 secs	Blue and Red LEDs rapidly flashing
	Factory Reset	14 secs	Solid red
	Factory Reset Confirm	Tapping	Red LED flashing
Fault Reset Button	Fault Reset	Pressing	-

- LED Indicators

LED	LED Status	Description
Blue LED	Solid	Headset idle
	Slow Flashing	Headset connected / Audio streaming

- Charging LED Status

LED	Description
Solid Red	Charging
Solid Blue	Fully charged

CERTIFICATION AND SAFETY APPROVALS

FCC Compliance Statement

This device complies with part 15 of the FCC rules. Operation is subject to the following two conditions:

- (1) This device may not cause harmful interference, and
- (2) This device must accept any interference received, including interference that may cause undesired operation.

This equipment has been tested and found to comply with the limits for a Class B digital device pursuant to part 15 of the FCC rules. These limits are designed to provide reasonable protection against harmful interference in a residential installation. This equipment generates, uses and can radiate radio frequency energy and, if not installed and used in accordance with the instructions, may cause harmful interference to radio communications. However, there is no guarantee that interference will not occur in a particular installation. If this equipment does cause harmful interference to radio or television reception, which can be determined by turning the equipment on and off, the user is encouraged to try to correct the interference by one or more of the following measures:

- Reorient or relocate the receiving antennae
- Increase the separation between the equipment and the receiver

- Connect the equipment into an outlet on a circuit different from that to which the receiver is connected
- Consult the dealer or an experienced radio/TV technician for help

FCC RF Exposure Statement

This equipment complies with FCC radiation exposure limits set forth for an uncontrolled environment. End users must follow the specific operating instructions for satisfying RF exposure compliance. The antenna used for this transmitter must not transmit simultaneously with any other antenna or transmitter, except in accordance with FCC multi-transmitter product procedures.

FCC Caution

Any changes or modifications to the equipment not expressly approved by the party responsible for compliance could void user's authority to operate the equipment.

CE Declaration of Conformity

This product is CE marked according to the provisions of the R&TTE Directive (1999/5/EC). Hereby, Sena declares that this product is in compliance with the essential requirements and other relevant provisions of Directive 1999/5/EC. Please note that this product uses radio frequency bands not harmonized within EU. Within the EU this product is intended to be used in Austria, Belgium, Denmark, Finland, France, Germany, Greece, Ireland, Italy, Luxembourg, The Netherlands, Portugal, Spain, Sweden, United Kingdom and within EFTA in Iceland, Norway and Switzerland.

Industry Canada Statement

This device complies with Industry Canada license-exempt RSS standard(s). Operation is subject to the following two conditions:

- (1) This device may not cause interference.
- (2) This device must accept any interference, including interference that may cause undesired operation of the device.

Bluetooth License

The Bluetooth® word mark and logos are owned by the Bluetooth SIG, Inc. and any use of such marks by Sena is under license. Other trademarks and trade names are those of their respective owners.

The product is compliant with and adopts the Bluetooth® Specification 3.0 and has successfully passed all interoperability tests that are specified in the Bluetooth® specification. However, interoperability between the device and other Bluetooth®-enabled products is not guaranteed.

WEEE (Waste Electrical and Electronic Equipment)



The crossed-out wheel bin symbol on the product, literature, or packaging reminds you that all electrical and electronic products, batteries, and accumulators must be taken to separate collection at the end of their working life. This requirement applies to the European Union and other locations where separate collection systems are available. To prevent possible harm to the environment or human health from uncontrolled waste disposal, please do not dispose of these products as unsorted municipal waste, but hand it in at an official collection point for recycling.

SAFETY INFORMATION

Please ensure that the product is properly used by observing the warnings and cautions below to prevent any risk and/or damage to property.

Product Storage and Management

- Keep the product free of dust. It may damage mechanical and electronic parts of the product.
- Do not store the product in high temperatures as this may reduce the life span of electronic devices, damage the battery, and/or melt plastic parts of the product.
- Do not store the product in cold temperatures. Abrupt changes in temperatures may cause condensation and damage electronic circuits.
- Do not clean the product with cleaning solvents, toxic chemicals, or strong detergents as this may damage the product.
- Do not paint the product. Paint may obstruct moving parts or interfere with the normal operation of the product.
- Do not drop or otherwise shock the product. It may damage the product or its internal electronic circuits.
- Do not disassemble, repair or modify the product as this may damage the product and invalidate the product warranty.

- Do not store the product in humid environments, especially for long time storage.

Product Use

- Do not cause impact to the product or touch it with sharp tools as this may damage the product.
- Do not use the product in high-temperatures or apply heat to the product as this may cause damage, explosion, or fire.
- Keep product away from pets or small children. It may damage the product.
- In any place where wireless communication is prohibited, such as hospitals or airplanes, turn off the power and refrain from using the product. In a place where wireless communication is prohibited, electromagnetic waves may cause hazards or accidents.
- Do not use the product near hazardous explosives. When it is near any explosion hazards, turn off the power and heed any regulations, instructions, and signs in the area.
- When using the product, be certain to conform to laws regarding the use of communications devices while riding.
- Do not put the product where it may hamper the rider's vision or manipulate it while riding. This may cause traffic accidents.
- If the product is damaged, stop using it immediately. It may cause damage, explosion, or fire.

Battery

This product has an irreplaceable rechargeable battery inside. Therefore, when using the product, make sure to adhere to the following:

- Never separate the battery from the product as this may damage the product.
- The battery performance may be reduced over time with usage.
- In recharging the battery, make sure to use an approved charger provided by the manufacturer. Use of a non-approved charger may cause fire, explosion, leakage, and other hazards may also reduce the life time or performance of the battery.
- Any 3rd party USB charger can be used with Sena products if the charger is approved by either the FCC, CE, IC or other locally approved agencies that Sena accepts.
- Do not use cigarette chargers other than the included cigarette charger to charge the headset.
- Store the battery at temperatures of 15°C ~ 25°C (59°F ~ 77°F). Higher or lower temperatures may reduce the capacity and life of the battery, or may cause temporary non-operation. Do not use the product in sub-zero temperature, because it may cause serious reduction of the battery performance.

- If you apply heat to the battery or throw it into fire, it may explode.
- Do not use the product with a damaged battery. It may explode and/or cause accidents.
- Never use a damaged charger. It may explode and/or cause accidents.
- Battery life may vary depending on conditions, environmental factors, functions of the product in use, and devices used with it.

MAINTENANCE AND CARE

The FreeWire should be treated with care and the following suggestions will help you protect your warranty coverage.

- Do not use or store the device in dusty, dirty areas. Its moving parts and electronic components can be damaged.
- Do not store the device in hot areas. High temperatures can shorten the life of electronic devices, damage batteries, and warp or melt certain plastics.
- Do not store the device in cold areas. When the device returns to its normal temperature, moisture can form inside the device and damage electronic circuit boards.
- Do not attempt to open the FreeWire.
- Do not drop or knock the device. Rough handling can break internal circuit boards and fine mechanics.
- Do not use harsh chemicals, cleaning solvents, or strong detergents to clean the device.
- Do not paint the device. Paint can clog the moving parts and prevent proper operation.