

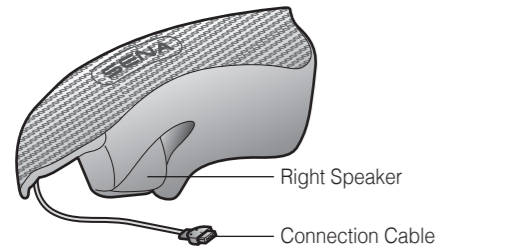

10Upad for HJC IS-17 Quick Start Guide



Right Speaker

Connection Cable

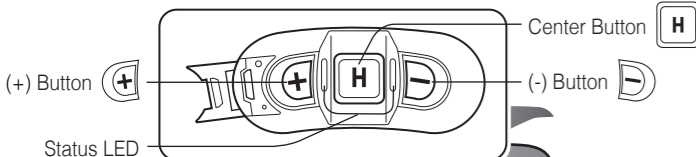

(+) Button

Center Button (H)

(-) Button

Status LED

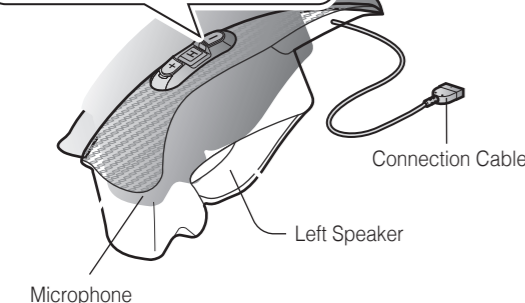

Microphone

Left Speaker

Connection Cable

Installation

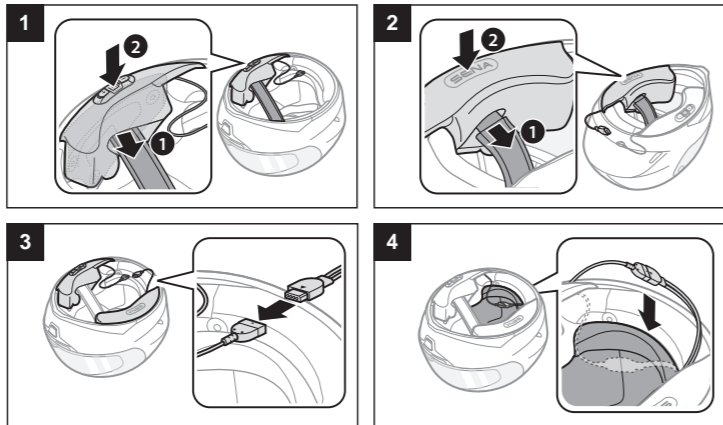

Charging

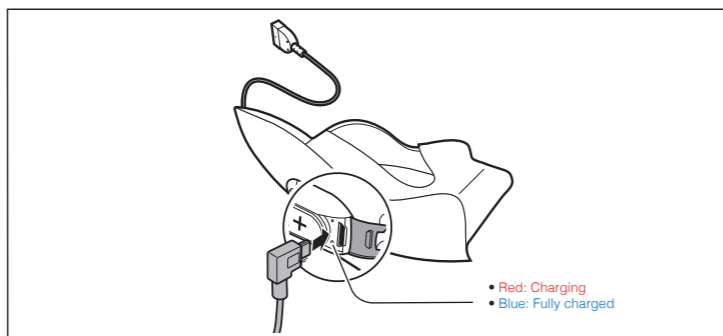

Button Operation

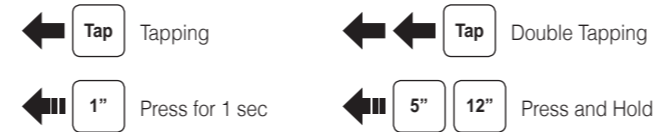

Power On/Off

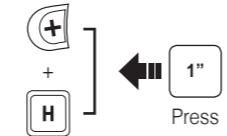

Volume Adjustment

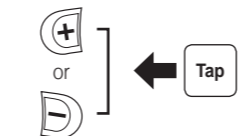

Battery Check

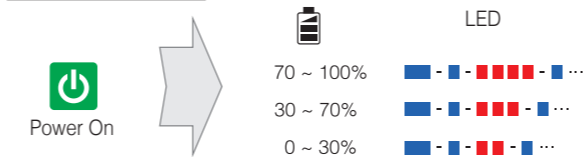

Phone, Music Pairing

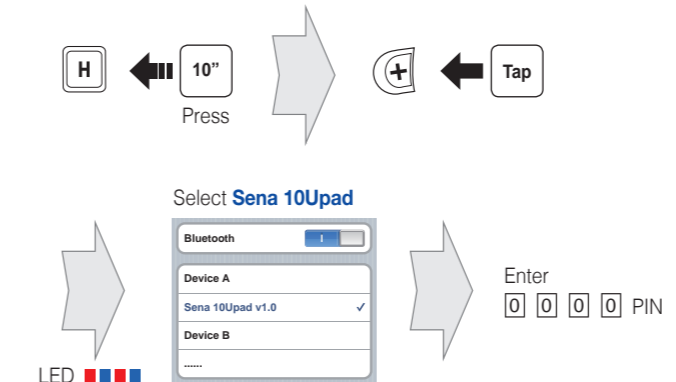

Music Operation

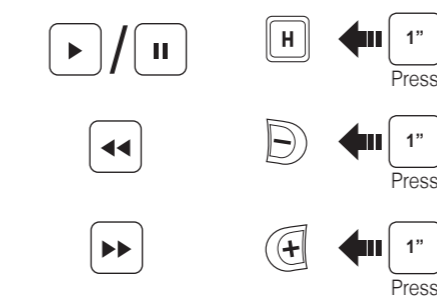

Mobile Phone Call Making and Answering

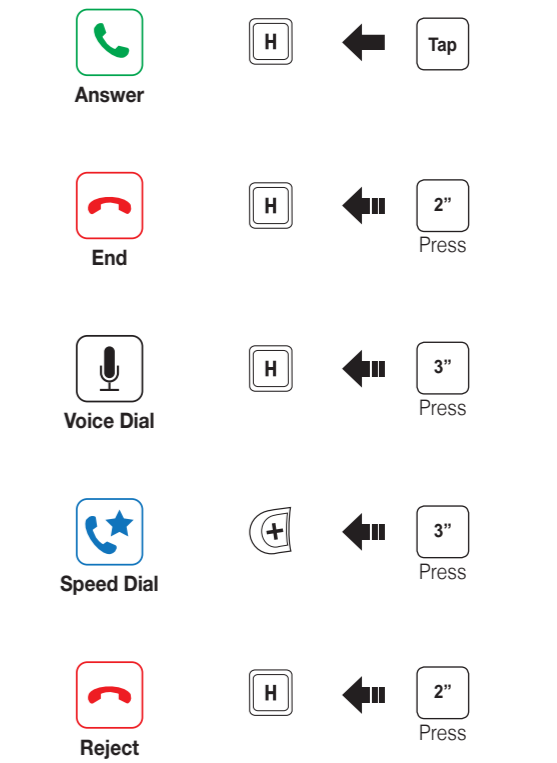

Intercom Pairing

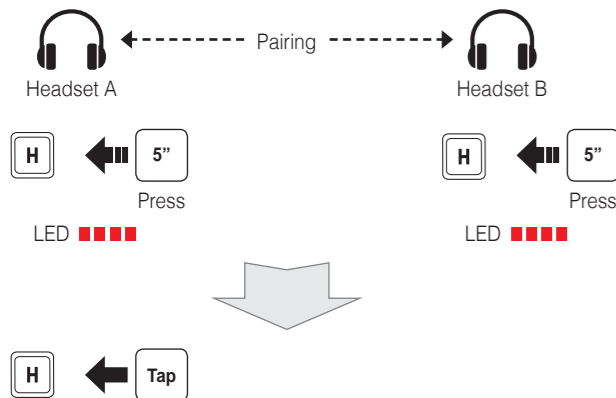

Intercom Start/End

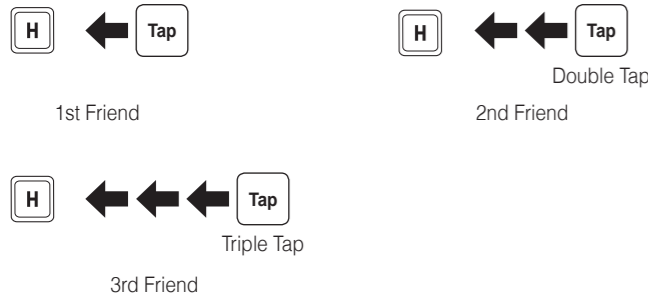

Radio On/Off

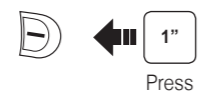

Radio Seek Stations

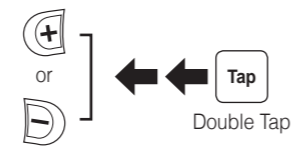

Radio Scan Up FM Band



Save to preset while scanning



Radio Move to Preset Station

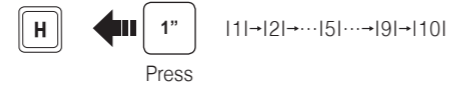

Radio Save or Delete Preset

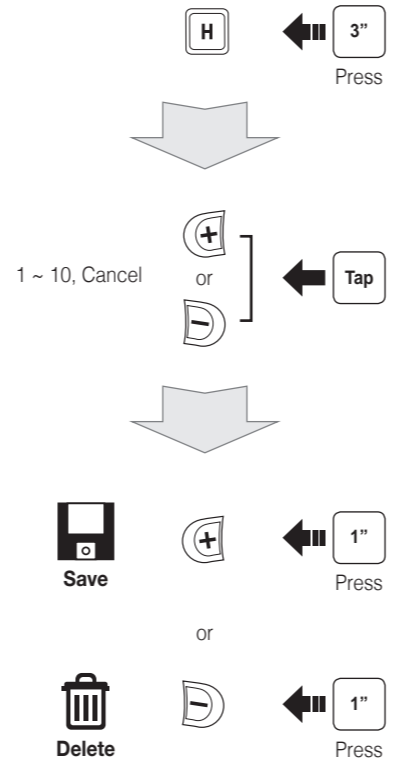

Setting

Configuration Menu



Using the Sena Device Manager

Connect the headset to your computer via a USB cable. Launch the Sena Device Manager and click **DEVICE SETTING** to configure the headset settings.

For details about downloading the Sena Device Manager, please refer to the leaflet included in the package.

Using the Sena Smartphone App

1. On your smartphone, download the Sena Smartphone App for Android or iPhone from Google Play or App Store.
2. Pair your smartphone with the headset.
3. Run the Sena Smartphone App. Swipe the screen to the right and tap Setting to configure the headset settings.

Troubleshooting

Factory Reset

If you want to restore the 10Upad to factory default settings, use the Factory Reset in the configuration menu. The headset automatically restores the default settings and turns off.

Fault Reset

If the 10Upad is not working properly for any reason, reset by gently pushing the pin-hole reset button located next to the DC Power Charging & Firmware Upgrade Port.

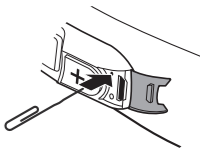

10Upad for HJC IS-MAX2 Quick Start Guide

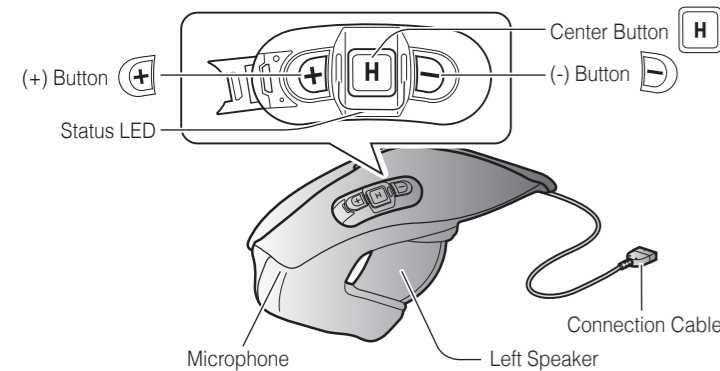

Installation

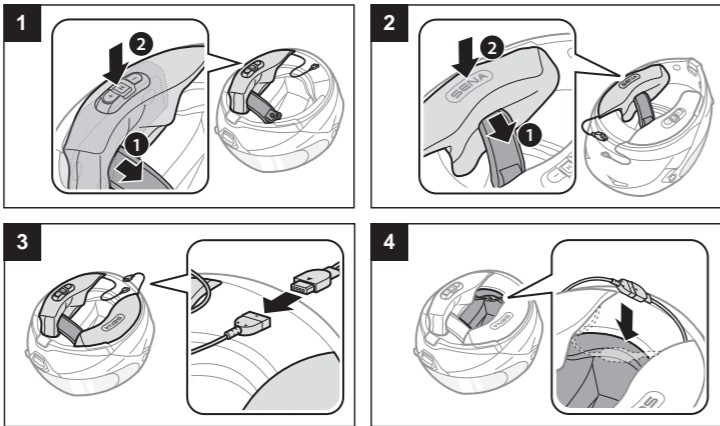

Charging

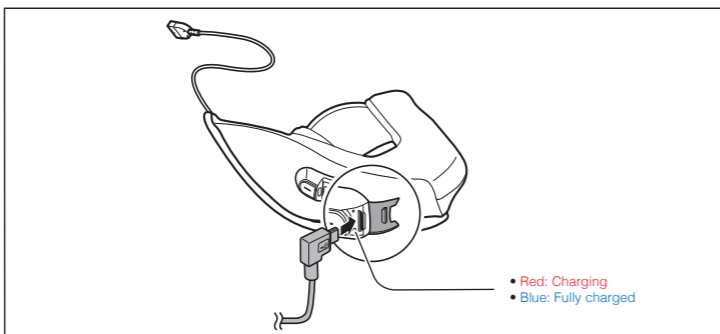

Button Operation

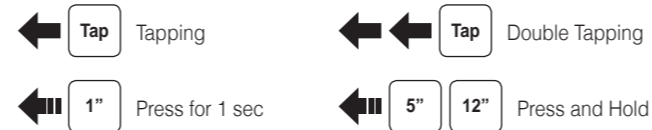

Power On/Off

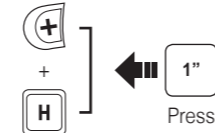

Volume Adjustment

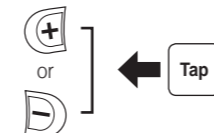

Battery Check

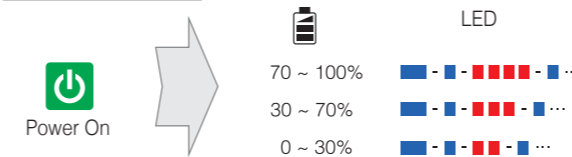

Phone, Music Pairing

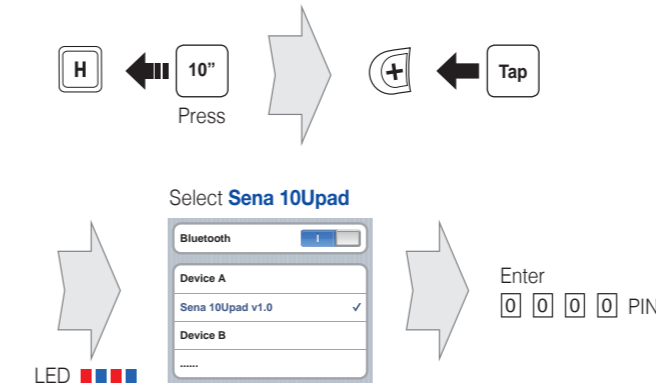

Music Operation

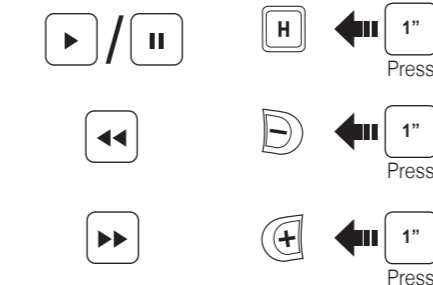

Mobile Phone Call Making and Answering

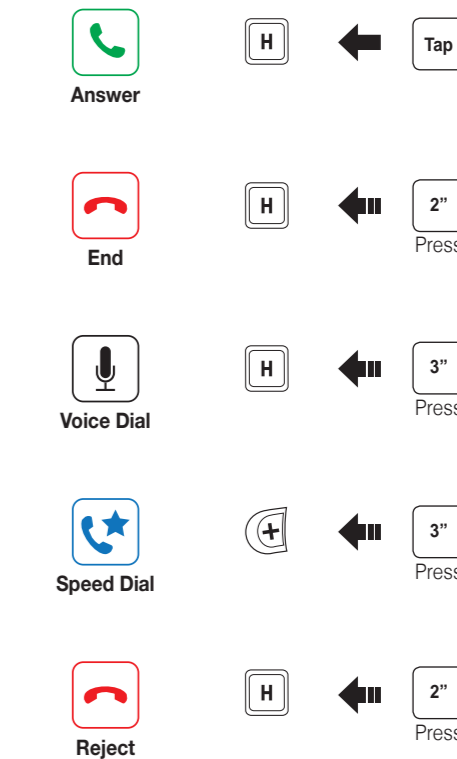

Intercom Pairing

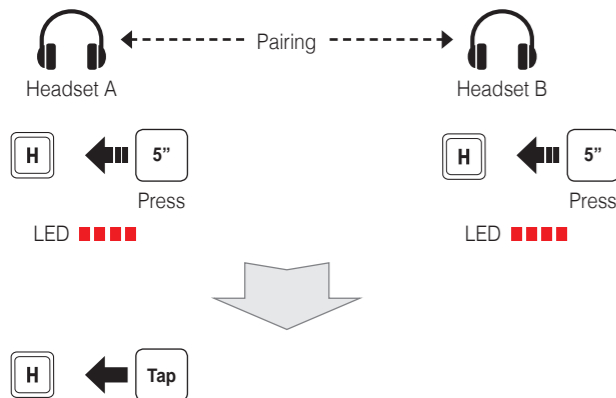

Intercom Start/End

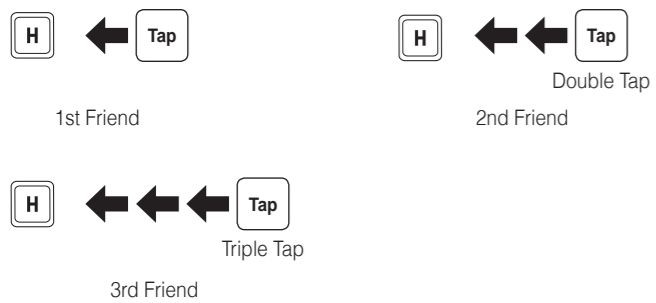

Radio On/Off

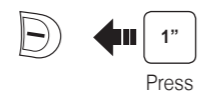

Radio Seek Stations

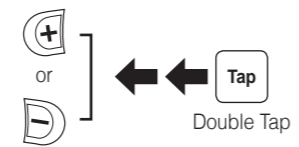

Radio Scan Up FM Band



Save to preset while scanning



Radio Move to Preset Station



Radio Save or Delete Preset

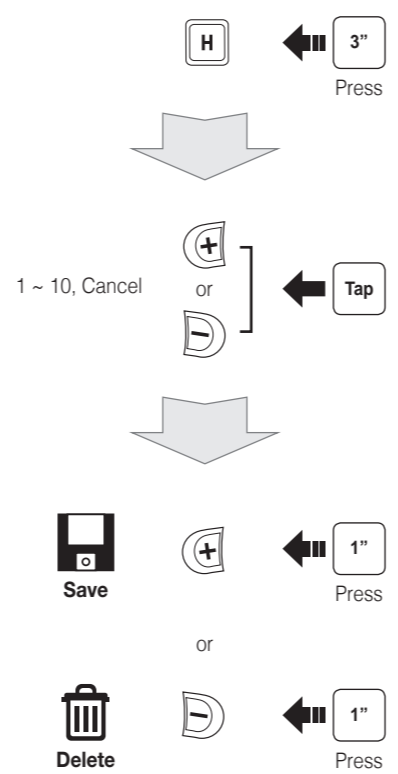

Setting

Configuration Menu



Using the Sena Device Manager

Connect the headset to your computer via a USB cable. Launch the Sena Device Manager and click **DEVICE SETTING** to configure the headset settings. For details about downloading the Sena Device Manager, please refer to the leaflet included in the package.

Using the Sena Smartphone App

1. On your smartphone, download the Sena Smartphone App for Android or iPhone from Google Play or App Store.
2. Pair your smartphone with the headset.
3. Run the Sena Smartphone App. Swipe the screen to the right and tap Setting to configure the headset settings.

Troubleshooting

Factory Reset

If you want to restore the 10Upad to factory default settings, use the Factory Reset in the configuration menu. The headset automatically restores the default settings and turns off.

Fault Reset

If the 10Upad is not working properly for any reason, reset by gently pushing the pin-hole reset button located next to the DC Power Charging & Firmware Upgrade Port.

