



MOTO SPORTS GOGGLES

WORKS FILM SYSTEM

INNOVATION
TECHNOLOGY
DESIGN



MOTOSPORTS GOGGLE

SCOTT WORKS FILM SYSTEM

The WORKS Film system is made up of the SCOTT Anti-stick Grid and two individual Roll-off canisters.

SCOTT ANTI-STICK GRID

SCOTT's improved WORKS FILM SYSTEM featuring the all new SCOTT Anti-Stick grid. Affixed on the lens by the roll-off canisters, the Anti-stick grid ensures a seamless sliding movement of the film over the lens. With an integrated mudflap to prevent water or mud from entering between the film and lens, SCOTT's Anti-stick grid guarantees the user a clear sight throughout the entire ride.

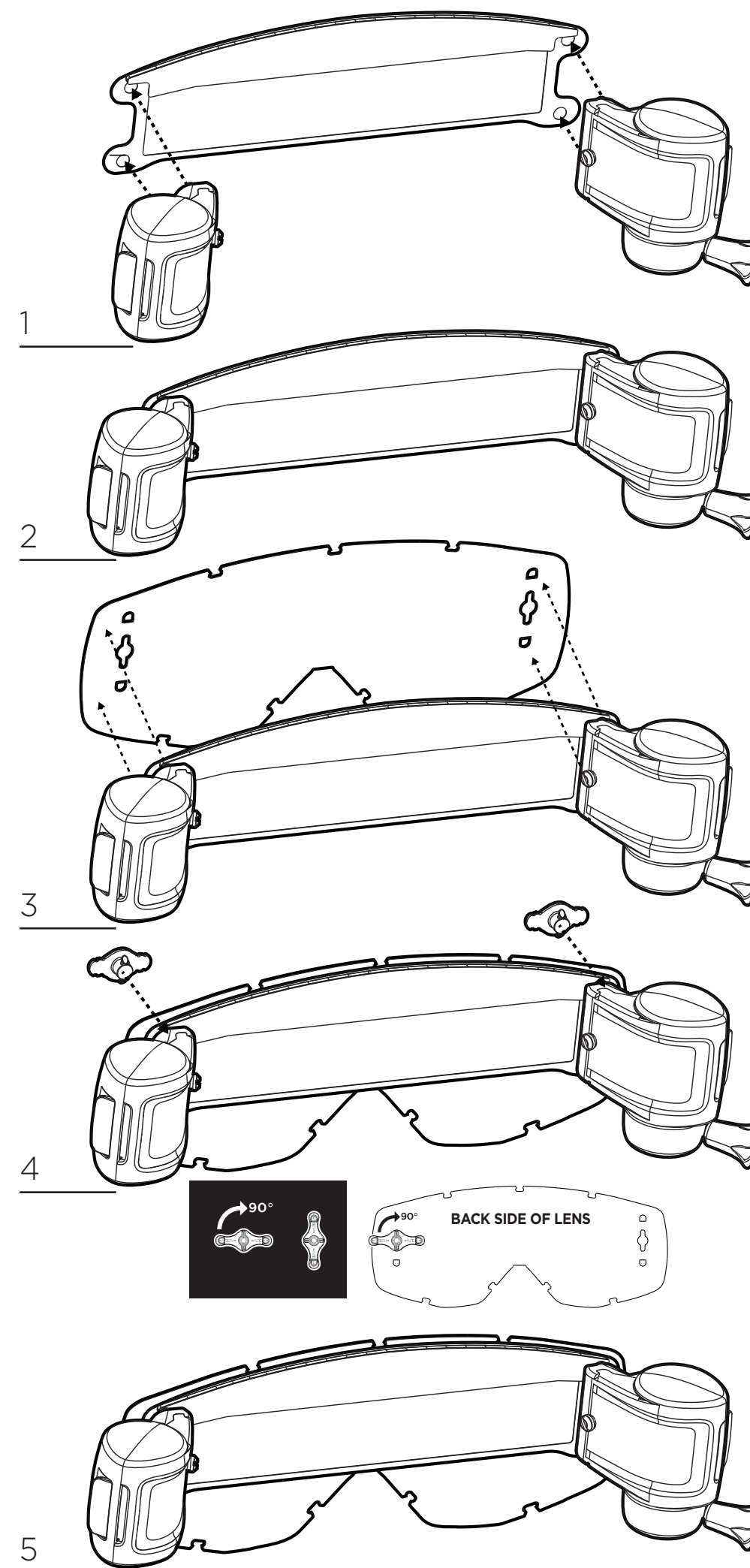



FILM MOUNTING INSTRUCTIONS:

Load the supply RR side canister with new film. Remove the door from the supply canister and untape the film. Expose the first centimeters of film and orient the film roll (A). Insert the film roll into the supply canister and reattach the door. Take the exposed tail of the film and attach it to the motor side axle (B). This is performed with the axle out of the motor RL canister. Place the axle into the receiver in the motor canister bottom. Replace the motor side door. Pull the string once or twice to ensure that the film is securely attached to the axle.

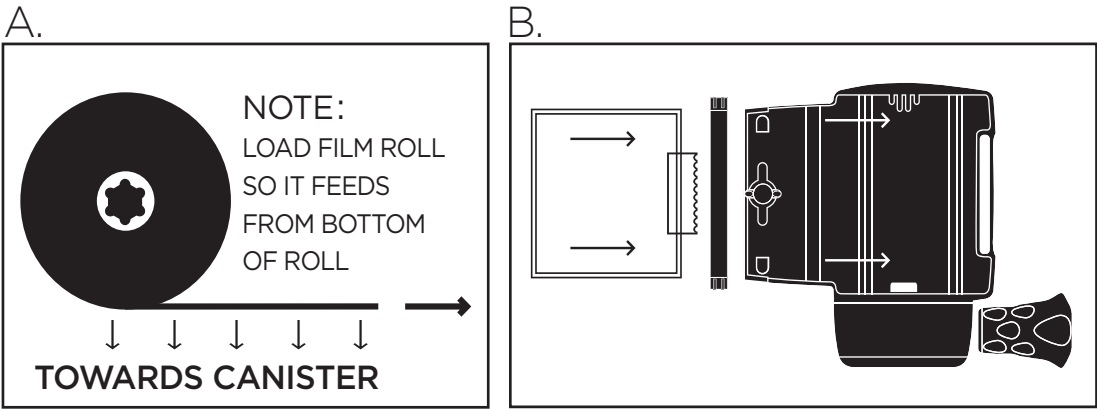

HELPFUL HINTS:

- Make sure the lens is clean and dry before loading the film.
- Store your goggles in a bag after it has been properly cleaned and loaded.
- When advancing the film across the lens use the SCOTT Anti-stick grid as a guide and tuck the film under the Mudflap for best performance.
- The Works Film System fits on every SCOTT Works replacement lens.

