

# Quick Start Guide

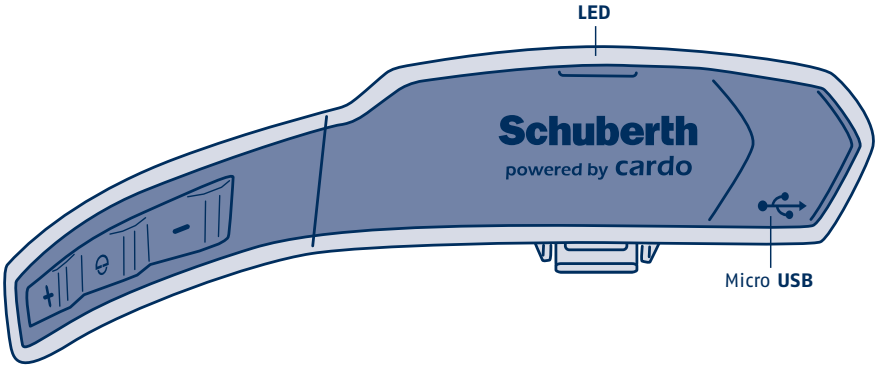

<b>On/Off</b>	2 sec.
<b>Reset</b>	5 sec. →  2 sec.
	5 sec.
	5 sec. →  1 sec. →  → Code: 0000
	5 sec. →   → Code: 0000
	≥ 3h

## EN IMPORTANT NOTES

Your complete and undivided attention is required while driving the vehicle. You must ensure that you take all the necessary precautionary measures to be able to adequately take into account the current traffic situation and weather conditions including the state of the road at all times, including when you are using the device. Before making or accepting a call you should pull over to the side of the road and stop. Any publications, advertisements, announcements or other similar communications, which imply that you can use the device on the move, merely refer to its technical capabilities and are not to be understood as an encouragement to engage in such activity. You must establish whether use of the device might represent a violation of any laws or regulations applicable in the location of use and adhere to the relevant rules. In this respect, any use of the device is exclusively at the user's own risk and responsibility. The basic requirements for safe use include that you must be physically capable of using the device and not suffer from any illness or restrictions that might impair your capability to use the device safely and ride on the road. Furthermore, you must hold a valid driving licence for the vehicle. Under no circumstances may you consume alcohol or mind altering drugs, which might impair your alertness, before or during use of the device.

**Operating temperature:** The SRC-System™ is designed to work in temperatures between -20° and 55° C.

**AC/DC Adapters:** When charging from a wall outlet, use the charger provided or another certified plug-in AC/DC adapter that meets the following criteria: **Input:** 100-240 V, 50/60 Hz, 0.2 A maximum, **Output:** 5 DV DC, 1 A maximum.

### Federal Communications Commission (FCC)

#### Statement 15.21

You are cautioned that changes or modifications not expressly approved by the part responsible for compliance could void the user's authority to operate the equipment.

#### FCC Statement

This equipment complies with Part 15 of the FCC Rules. Operation is subject to the following two conditions:

- (1) This device may not cause harmful interference, and
- (2) This device must accept any interference received, including interference that may cause undesired operation.

#### 15.105(b)

This equipment has been tested and found to comply with the limits for a Class B digital device, pursuant to part 15 of the FCC rules. These limits are designed to provide reasonable protection against harmful interference in a residential installation. This equipment generates, uses and can radiate radio frequency energy and, if not installed and used in accordance with the instructions, may cause harmful interference to radio communications. However, there is no guarantee that interference will not occur in a particular installation. If this equipment does cause harmful interference to radio or television reception, which can be determined by turning the equipment off and on, the user is encouraged to try to correct the interference by one or more of the following measures:

- Reorient or relocate the receiving antenna.
- Increase the separation between the equipment and receiver.
- Connect the equipment into an outlet on a circuit different from that to which the receiver is connected.
- Consult the dealer or an experienced radio/TV technician for help.

#### FCC RF Radiation Exposure Statement:

This equipment complies with FCC radiation exposure limits set forth for an uncontrolled environment. End users must follow the specific operating instructions for satisfying RF exposure compliance. The antenna used for this transmitter must not transmit simultaneously with any other antenna or transmitter, except in accordance with FCC multi-transmitter product procedures.

#### Industry Canada (IC)

This device complies with Industry Canada licence-exempt RSS standard(s). Operation is subject to the following two conditions: (1) this device may not cause interference, and (2) this device must accept any interference, including interference that may cause undesired operation of the device.

#### IC RF Radiation Exposure Statement:

This equipment complies with the RSS-102 exemption from routine RF exposure evaluation for use in an uncontrolled environment.

#### European CE Notice

The SRC-System™ headset (the "Product") is in conformity with the following essential requirements of Council Directive 1999/5/EC (referred to as R&TTE Directive): Articles 3.1a, 3.1.b and 3.2. The Product is manufactured in accordance with Annex II of the above directive.

#### Declaration of Conformity (DOC)

The SRC-System™ headset is compliant with and adopts the Bluetooth® Specification 3.0 and has successfully passed all interoperability tests that are specified in the Bluetooth® specification. However, interoperability between the device and other Bluetooth®-enabled products is not guaranteed.

#### WAIVER AND GENERAL RELEASE

##### (not for countries of the European Union)

BY USING THE SRC-SYSTEM™ YOU WILL WAIVE SUBSTANTIAL LEGAL RIGHTS INCLUDING THE RIGHT TO SUE. PLEASE READ THE FOLLOWING CAREFULLY BEFORE USING THE DEVICE. IF YOU DO NOT ACCEPT ALL TERMS OF THIS AGREEMENT, YOU SHOULD

IMMEDIATELY RETURN THE PRODUCT FOR A FULL REFUND. BY USING THE HEADSET YOU AGREE TO BE BOUND TO THIS AGREEMENT AND FORFEIT THE RIGHT TO SUE.

Using a communication device while riding a motorcycle, scooter, moped, ATV, quad-bike or any other vehicle or equipment, whether on land, water or air (jointly referred to as "Vehicle") requires your complete and undivided attention. Schuberth GmbH. and Cardo Systems, Inc., including their respective Officers, Directors, Affiliates, Parent Company, Representatives, Agents, Contractors, Sponsors, Employees, Suppliers and Resellers (jointly referred to as the "Company") strongly advises you to take all necessary precautions and remain alert to the traffic, weather and road conditions if you choose to use the SRC System (the "Device"), including all derivative models irrespective of its commercial name or branding, and stop your Vehicle on the roadside prior to initiating or receiving calls. Any publications, advertisements, announcements or similar notes that refer to using the Device while riding a Vehicle are solely intended to address its technical capabilities and should not be misconstrued as if encouraging users to operate the Device while actively involved in traffic.

By way of purchasing this Device and not returning it for a full refund (see below), you are irrevocably releasing, indemnifying from any liability, loss, claim and expense (including attorneys fees) and holding the Company harmless for any bodily injuries, harm or death as well as losses or damages in goods, to any Vehicles including your own, or to any property or asset that belong to you or to third parties, any of which may result from using the Device under any circumstances or conditions and irrespective of jurisdiction. The Company will not be responsible for any physical damages, irrespective of reasons, conditions or circumstances, including malfunctioning of the Device, and all risks associated with operating it rest solely and entirely with the user of this Device, irrespective of whether the Device is used by the original purchaser or any third party.

The Company hereby notifies you that using this Device may also be in contravention to local, federal, state or national laws or regulations, and that any use of the Device is entirely at your sole risk and responsibility.

1. You, your heirs, legal representatives, successors or assigns, hereby voluntarily and forever release, discharge, indemnify and hold harmless the Company from any and all litigation, claims, debts, demands, actions and liability which may arise, directly or indirectly, from using the Device for any distress, pain, suffering, discomfort, loss, injury, death, damages to or in respect to any person or property however caused, WHETHER ARISING FROM THE NEGLIGENCE OR OTHERWISE, and which may hereafter accrue to you on some future date as a result of said use, to the fullest extent permitted by law.
2. You fully understand and assume the risks in using the Device, including risk of negligent acts or omissions by others.
3. You confirm that you are physically capable to use the Device and that you have no medical conditions or needs that may infringe upon your abilities to do so in a safe manner. You confirm that you are at least eighteen (18) years of age and that you have been advised of the risks associated with the use of the Device. You further confirm that you will not consume any alcohol that may affect your alertness or any mind-altering substance, and will not carry, use or consume these substances before or during the use of the Device.
4. You fully acknowledge our warnings and understand that:
  - (a) risks and dangers exist in using the Device while in traffic, including but not limited to injury or illness, strains, fractures, partial and/or total paralysis, death or other ailments that could cause serious disability;
  - (b) these risks and dangers may be caused by the negligence of the manufacturers or its agents or any third party involved in designing or manufacturing the Device;
  - (c) these risks and dangers may arise from foreseeable or unforeseeable causes. You hereby assume all risks and dangers and all responsibility for any losses and/or damages, whether caused in whole or in part by the negligence or other conduct of others, including the Company.
5. You confirm that you have read this release of liability and fully understand its terms and that you have given up substantial rights by not returning the Device for a full refund (see refund option below).

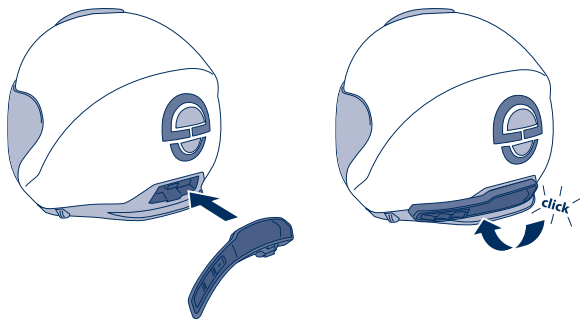

We recommend that, in addition to carefully reading the Quick Start Guide, you should also read the instructions for the SRC-System™, in order to understand all the functions and the correct operation.

Find out more about motorcycle communication we have.