

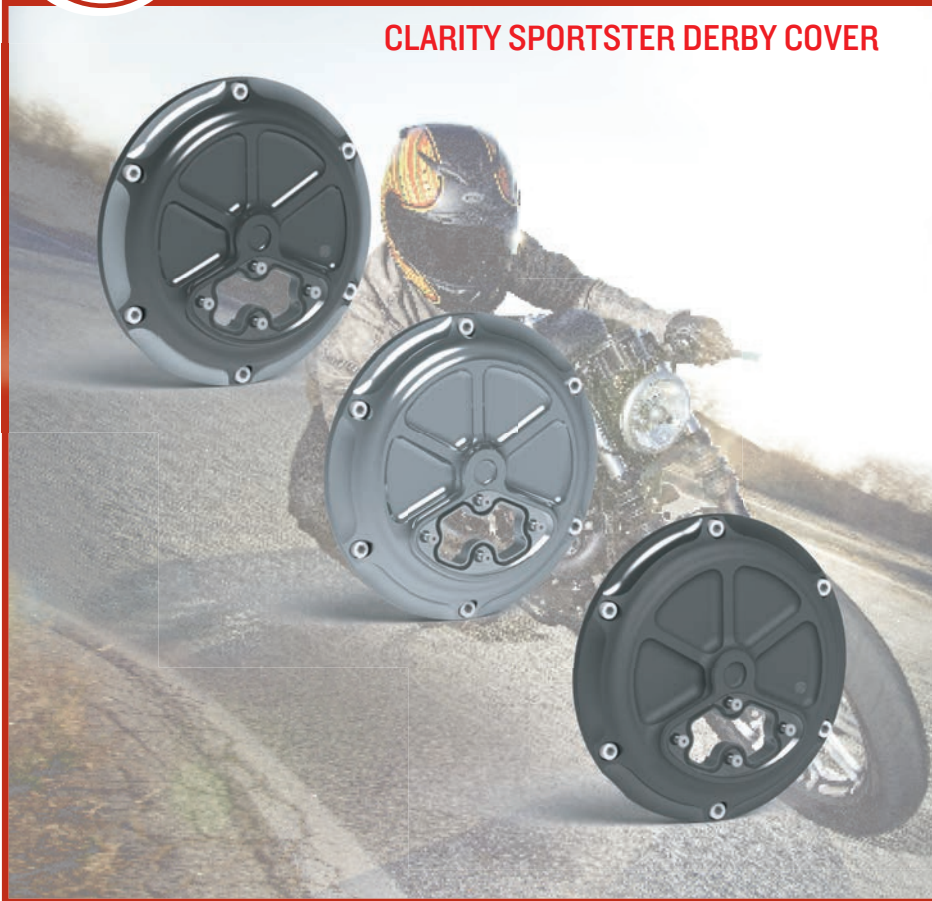

CLARITY SPORTSTER DERBY COVER

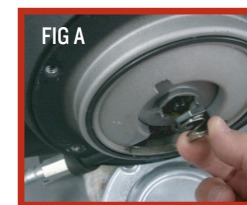

1. Turn your motorcycle off and place securely on a lift or side stand.
2. Place an oil pan underneath the derby cover area and remove the existing derby cover. (refer to the HD service manual if necessary).
3. Once the existing derby cover is removed clean all mounting surfaces and wipe out excess oil. Make sure to save the clutch adjustment spring and lock plate, they will be reinstalled (Fig A).
Note: Do not use any harsh chemicals during cleaning.



4. With the factory derby cover removed check the primary oil level. Add oil if necessary per the HD service manual.
5. Install the RSD Clarity Derby cover and hand tighten bolts to hold it in place.
NOTE: Upon assembly use blue Loctite 243 on all fasteners.
NOTE: Make sure the inside of the Lexan window is clean prior to installation. Clean with Plexus if necessary.
6. Torque the 1/4-20 x 5/8" bolts(1) to 95 in-lbs using the torque pattern in Fig B.



FIG B
TORQUE SEQUENCE

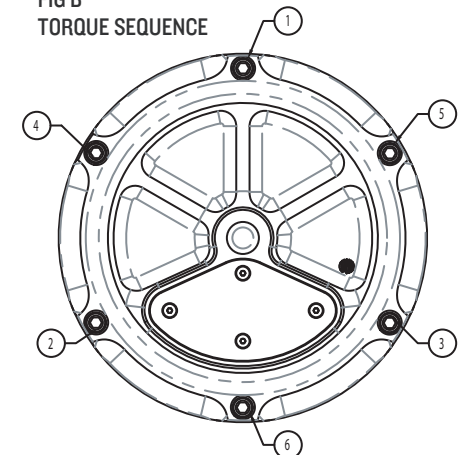

7. Go for a ride!

CAUTION:
CLARITY WINDOW IS PERMANENTLY INSTALLED AT THE FACTORY AND SHOULD NOT BE REMOVED OR SERVICED. IF REMOVAL IS NECESSARY CONTACT THE TECH DEPARTMENT FOR SPECIAL SERVICE INSTRUCTIONS. PERFORMANCE MACHINE THE MANUFACTURER IS NOT RESPONSIBLE FOR DAMAGE TO THE CLARITY WINDOW CAUSED BY IMPROPER SERVICE.

PRODUCT DESCRIPTION

2004-UP XL SPORTSTER MODELS : CLARITY DERBY COVER

0177-2035



ROLAND SANDS DESIGN

ASSEMBLY INSTRUCTIONS

Clarity Sportster Derby Cover

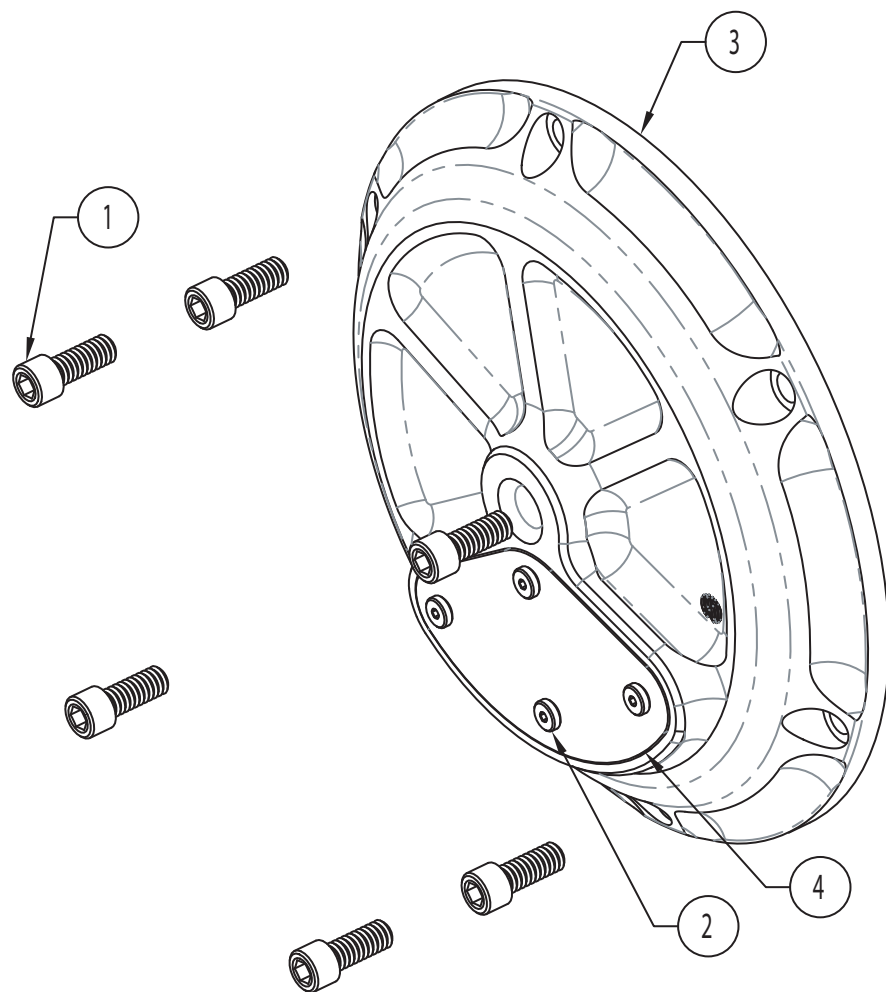

CAUTION:

CLARITY WINDOW IS PERMANENTLY INSTALLED AT THE FACTORY AND SHOULD NOT BE REMOVED OR SERVICED. IF REMOVAL IS NECESSARY CONTACT THE TECH DEPARTMENT FOR SPECIAL SERVICE INSTRUCTIONS. PERFORMANCE MACHINE THE MANUFACTURER IS NOT RESPONSIBLE FOR DAMAGE TO THE CLARITY WINDOW CAUSED BY IMPROPER SERVICE.

USE ONLY POLYCARBONATE APPROVED CLEANERS SUCH AS PLEXUS TO CLEAN YOUR CLARITY WINDOW. HARSH CHEMICALS MAY CAUSE DAMAGE.

NOTE: FOGGING MAY OCCUR ON THE INSIDE OF THE LEXAN WINDOWS DUE TO HUMIDITY CHANGES. IF FOGGING IS VISIBLE START THE MOTORCYCLE AND RUN UNTIL FOGGING DISAPPEARS.

ITEM NO.	DESCRIPTION	QTY.
1	SHCS 1/4-20 X 5/8 SS	6
2	SHCS LOW HEAD 8-32 X 1/2 W/ VIBRA-TITE	4
3	RSD CLARITY DERBY COVER, 2004-UP XL SPORTSTER	1
4	COVER WINDOW, RSD CLARITY SPORTSTER DERBY COVER	1