



FITTING INSTRUCTIONS FOR SP0071 BK SWINGARM PROTECTORS
TRIUMPH STREET TWIN '16- & THRUXTON 1200 '16-



THIS KIT CONTAINS THE ITEMS PICTURED AND LABELLED BELOW.
DO NOT PROCEED UNTIL YOU ARE SURE ALL PARTS ARE PRESENT.

Please note that the way the kit is packed does not necessarily represent the way of mounting to the bike.

Please note that in cases where kits are packed with a plastic tube separating components on the spindle bar (this tube should be discarded).

THE PARTS SHOWN MAY BE REPRESENTATIVE ONLY (FOR CLARITY OF INSTRUCTIONS ONLY).

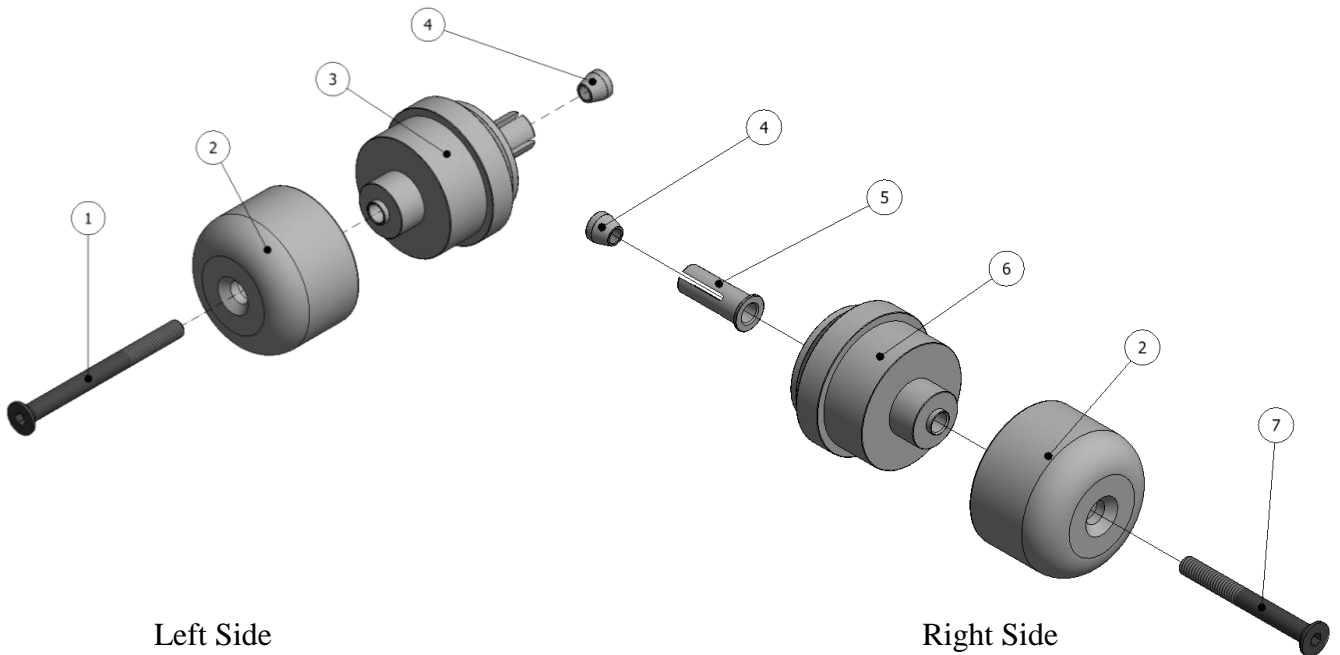



LEGEND

ITEM 1 = M6 x 70mm LONG COUNTERSUNK BOLT (x1).

ITEM 2 = BOBBIN (B0481) (x2).

ITEM 3 = MOUNTING BLOCK LEFT (M0482) (x1).

ITEM 4 = TAPERED NUT (H0062) (x2).

ITEM 5 = MOUNTING BLOCK EXPANDER (M0484) (x1).

ITEM 6 = MOUNTING BLOCK RIGHT (M0483) (x1).

ITEM 7 = M6 x 55mm LONG COUNTERSUNK BOLT (x1).

TOOLS REQUIRED

- 4mm Allen key.

FITTING INSTRUCTIONS

Left-hand side (as you sit on bike)

- Fit the longer counter sunk bolt (item 1) through the crash protector so head sits in counter-sink.
- Place the bobbin on to the longer mounting block (item 3 – M0482).
- Place the tapered nut (item 4 – H0062) on exposed end of bolt so tapered face goes into recess of the mounting block.
- Tighten the bolt until the tapered portion of nut just contacts in the recessed face of the mounting block.
- Place this assembly into the left hand side of the rear wheel spindle.
- Tighten the bolt so the bobbin is held in position firmly (do not over tighten).

Right-hand side (as you sit on bike)

- Fit the shorter counter sunk bolt (item 7) through the crash protector so head sits in counter-sink.
- Place the remaining bobbin on to the smaller mounting block (item 9 – M0483).
- Position the mounting block expander (item 5 – M0484) over the exposed end of the bolt.
- Place the tapered nut (item 4 – H0062) on exposed end of bolt so tapered face goes into recess of the mounting block.
- Tighten the bolt until the tapered portion of nut just contacts in the recessed face of the mounting block.
- Place this assembly into the right hand side of the rear wheel spindle.
- Tighten the bolt so the bobbin is held in position firmly (do not over tighten).

- **Regularly check to ensure bobbins remain tight.**