

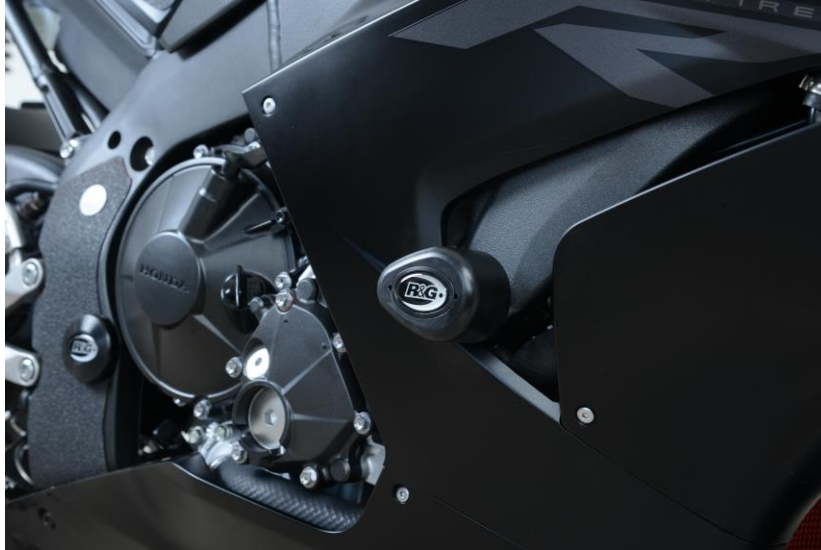

CP0495

**FITTING INSTRUCTIONS FOR CP0495 CRASH PROTECTORS**  
**HONDA CBR1000RR-R & SP 2020- RACE KIT**



**THIS KIT CONTAINS THE ITEMS PICTURED AND LABELLED OVER PAGE.**

SOME PARTS MAY BE SHOWN FOR CLARITY OF INSTRUCTIONS ONLY.

DO NOT PROCEED UNTIL YOU ARE SURE ALL PARTS ARE PRESENT.

**PLEASE READ ALL INSTRUCTIONS BEFORE PROCEEDING.**

**IF IN ANY DOUBT WHEN FITTING OUR PRODUCTS, CONSULT ONE OF OUR  
DEALERS OR HAVE FITTED BY A QUALIFIED TECHNICIAN.**

PLEASE NOTE THAT THE WAY THE KIT IS PACKED DOES NOT NECESSARILY REPRESENT THE WAY  
OF MOUNTING TO THE BIKE.

IN THE EVENT OF RUBBER WASHERS BEING USED TO HOLD COMPONENTS ONTO BOLTS,

THESE RUBBER WASHERS CAN BE THROWN AWAY.



<b><u>TOOLS REQUIRED</u></b>	<b><u>GENERAL TORQUE SETTINGS</u></b>
<ul style="list-style-type: none"> <li>• Socket set to include 17 &amp; 19mm A/F sockets and wrench.</li> <li>• Torque wrench (40Nm).</li> <li>• Suitable jack to support the engine during fitting.</li> </ul>	<p>M4 BOLT = 8Nm  M5 BOLT = 12Nm  M6 BOLT = 15Nm  M8 BOLT = 20Nm  M10 BOLT = 40Nm  M12 BOLT = 40Nm</p>

**LEGEND**

<b>ITEM NO.</b>	<b>DESCRIPTION</b>	<b>QTY</b>
ITEM 1	B0472 M12 CRASH PROTECTOR	2
ITEM 2	M12 x 1.25 x 120MM HEX HEAD BOLT	1
ITEM 3	M12 x 1.25 x 100MM HEX HEAD BOLT	1
ITEM 4	S0389 26MM SPACER	1
ITEM 5	S0974 52MM SPACER	1
ITEM 6	S0184 3MM SPACER	2
ITEM 7	M12 WASHER	2
ITEM 8	SHAKE PROOF WASHER	2
ITEM 9	BOBBIN CAP	2



CP0495

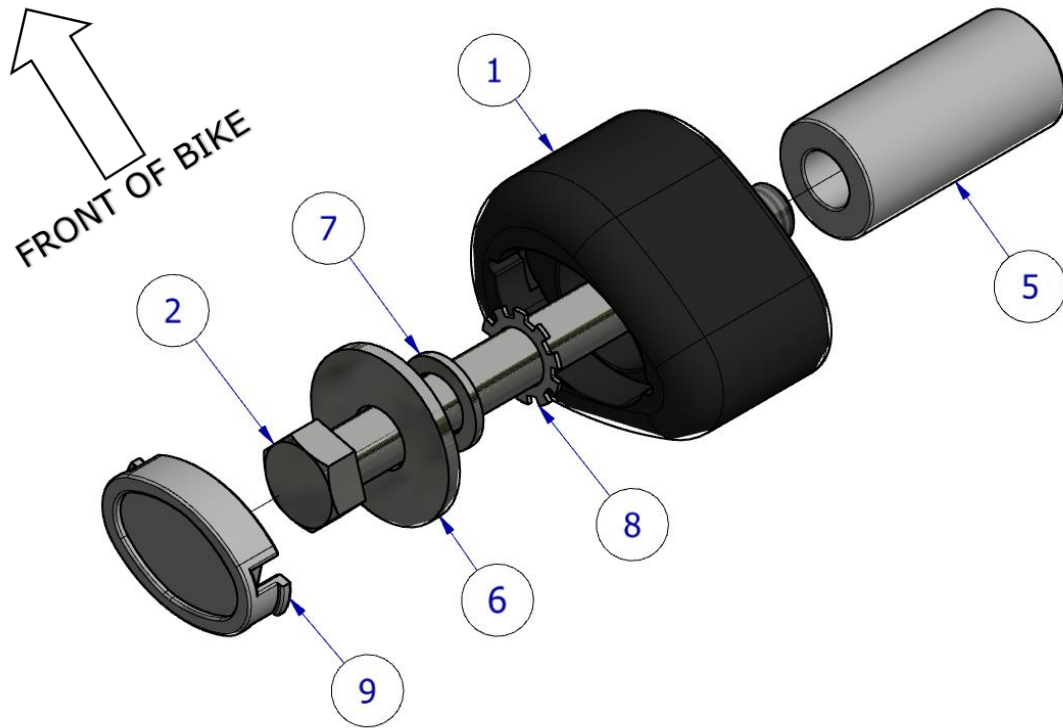

**LHS ASSEMBLY**

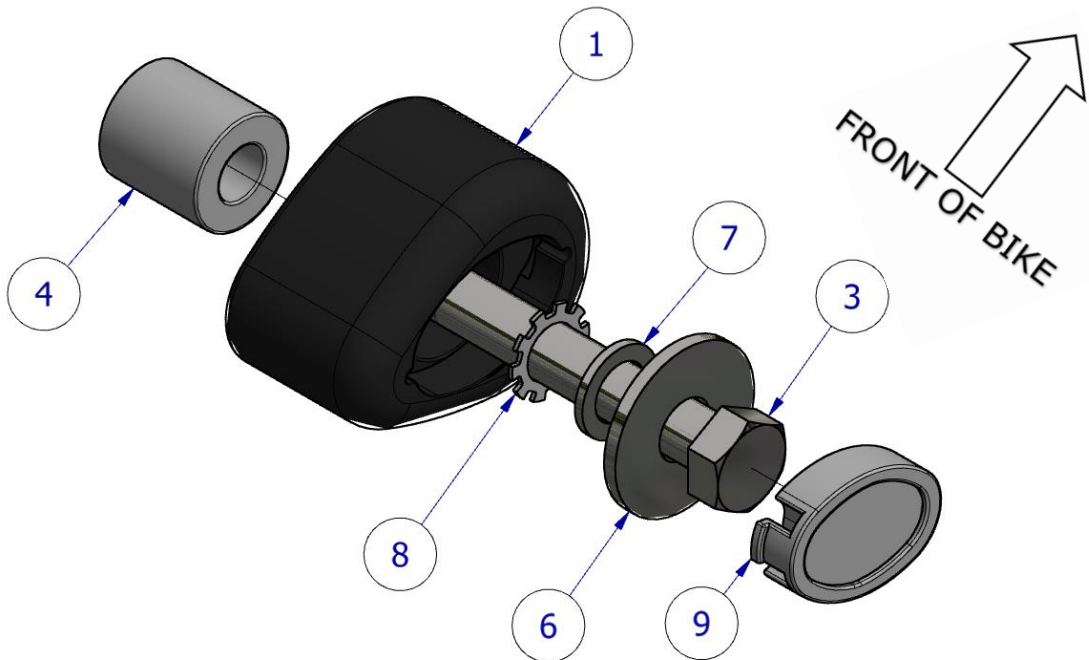

**RHS ASSEMBLY**



CP0495

## AERO-STYLE CRASH PROTECTOR ORIENTATION



Picture 1



Picture 2

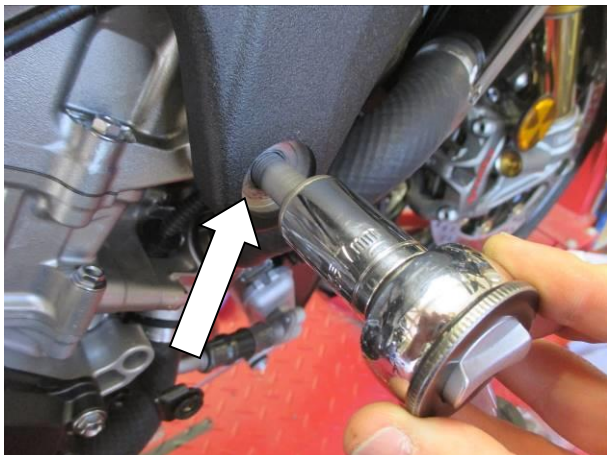

Picture 3



Picture 4



## **FITTING INSTRUCTIONS**

Before beginning, ensure the bike is upright and supported by a suitable engine stand or jack placed under the sump of the motorbike. This will prevent the engine from moving when removing engine bolts. **DO NOT REMOVE MORE THAN 1 ENGINE BOLT AT ANY TIME.** You may wish to remove the belly pan to give more access to the sump, but this is not necessary.

### **Left Side (as you sit on the bike)**

- Starting on the left-hand side of the bike, using your ratchet, remove the engine bolt arrowed in picture 1 (**DO NOT REMOVE BOTH ENGINE BOLTS AT THE SAME TIME**).
- Assemble the left-hand side assembly as shown in LHS assembly diagram (page 3). To do this, slide one 3mm spacer (Item 6 - S0184) over the M12 x 120mm bolt (item 2) (This spacer will sit inside the crash protector to correct the bolt length).
- Next, place one M12 washer (item 7) onto the bolt, followed by locking washer (item 8) and one crash protector (item 1) so that the serrated edge of the locking washer sits against the recessed inner face of the crash protector.
- Then place the longer 52mm spacer (item 5 - S0974) over the exposed end of the bolt.
- Place the assembly into the position of the previously removed LHS engine bolt.
- Finally tighten the crash protector bolt until you feel some compression from inside the protector using 19mm socket and wrench. **PLEASE NOTE THE CRASH PROTECTOR MUST BE POSITIONED AS IN PICTURE 'A' ON PAGE 4 WITH THE BIGGER END TOWARD FRONT OF BIKE.** Turn a little more so that you feel the compression increase slightly, then apply a quarter turn. Tighten to 40Nm of torque (do not exceed this figure, as damage can occur to the motorcycle and the bolt).
- If not already fitted, fit a bubble sticker into recess of one crash protector cap.
- Fit a crash protector cap (item 9) into the crash protector as shown in picture 2.
- The fitted crash protector should be clear of fairings and resemble that shown in picture 2.

### **Right Side (as you sit on the bike)**

- The right-side fits in a similar way to the left side, using your ratchet, remove the right-hand side engine bolt arrowed in picture 3.
- Assemble the right-hand side assembly as shown in RHS assembly diagram (page 3).
- slide one 3mm spacer (Item 6 - S0184) over the M12 x 100mm bolt (item 2) (This spacer will sit inside the crash protector to correct the bolt length).
- Slide the remaining M12 washer (item 7), followed by a locking washer (item 8) over the M12 x 100mm bolt (item 3).
- Place the remaining the remaining crash protector (item 1) over the bolt so that the serrated edge of the locking washer sits against the recessed inner face of the crash protector.
- Then place the remaining 26mm spacer (item 4 - S0389) over the exposed end of the bolt.
- Place the assembly into the position of the previously removed RHS engine bolt as shown in picture 4.
- Finally tighten the crash protector bolt until you feel some compression from inside the protector using 19mm socket and wrench. **PLEASE NOTE THE CRASH PROTECTOR MUST BE POSITIONED AS IN PICTURE 'A' ON PAGE 4 WITH THE BIGGER END TOWARD FRONT OF BIKE.** Turn a little more so that you feel the compression



CP0495

increase slightly, then apply a quarter turn. Tighten to 40Nm of torque (do not exceed this figure, as damage can occur to the motorcycle and the bolt).

- If not already fitted, fit a bubble sticker into recess of the crash protector cap.
- Fit the remaining crash protector cap (item 9) into the crash protector, so the assembly resembles that in picture 4.
- Before riding, check both sides are secure, and the crash protectors cannot rotate.
- Check tightness of each side regularly.