



FITTING INSTRUCTIONS FOR CP0454BL/WH CRASH PROTECTORS
MV AGUSTA BRUTALE 800RR 2018-

Page | 1



PICTURE A



PICTURE B



THIS KIT CONTAINS THE ITEMS PICTURED AND LABELLED BELOW.
DO NOT PROCEED UNTIL YOU ARE SURE ALL PARTS ARE PRESENT.

Please note that the way the kit is packed does not necessarily represent the way of mounting to the bike
 Please note that in cases where kits are packed with rubber washers holding the components onto the bolt – *the rubber washers should be thrown away!*

THE PARTS SHOWN MAY BE REPRESENTATIVE ONLY (FOR CLARITY OF INSTRUCTIONS ONLY)

GENERAL TORQUE SETTINGS

M4 BOLT = 8Nm
 M5 BOLT = 12Nm
 M6 BOLT = 15Nm
 M8 BOLT = 20Nm
 M10 BOLT = 40Nm

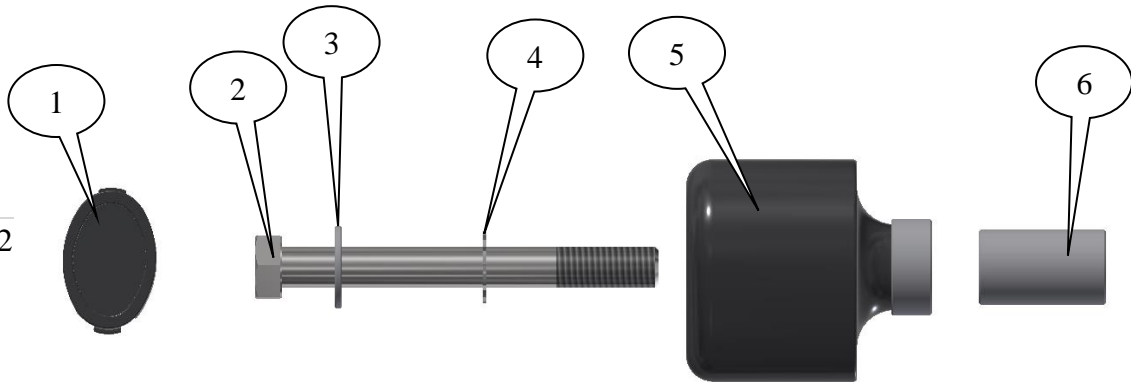
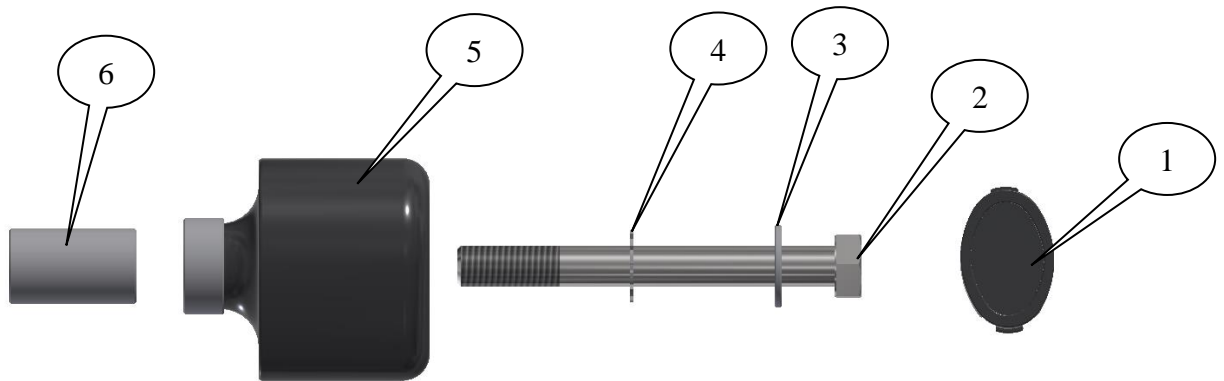
**LEFT HAND SIDE****RIGHT HAND SIDE****TOOLS REQUIRED**

- Socket set to include 14 and 19mm A-F sockets and wrench.
- Torque wrench (up to 40 Nm).

LEGEND

ITEM 1 = BC0002 CRASH PROTECTOR CAPS (x2).

ITEM 2 = M12x1.25x110mm LONG HEX HEAD BOLTS (L&RHS) (x2).

ITEM 3 = M12 PLAIN WASHERS (x2).

ITEM 4 = LW0001 (SHAKE PROOF WASHERS) (x2).

ITEM 5 = CRASH PROTECTORS (B0431 with CS340 (12mm)) (x2).

ITEM 6 = CRASH PROTECTOR SPACER L&R-HAND SIDES (S0515=37mm long) (x1).



FITTING INSTRUCTIONS

Left Side (as you sit on bike)

- Remove the engine bolt on the left side of the bike, as arrowed in picture A.
- Slide one of the 12mm plain washers (item 3) onto one of the M12x110mm long hexagon headed bolt (item 2) so the washer sits against head of bolt.
- Slide one of the serrated locking washers (item 4) over the bolt so it sits against the washer just fitted.
- Next slide the bolt with washers through either crash protector (item 5) so head of bolt and washers goes into counter-bore in the crash protector.
- Slide one of the spacers (item 6=37mm long) over the exposed end of the bolt as shown in the left-hand side assembly picture above.
- Offer the crash protector assembly up to the frame mount and begin to tighten the bolt as shown in picture A.
- Tighten the bolt until you feel some compression from inside the protector using 19mm socket and wrench. **PLEASE NOTE THE CRASH PROTECTOR MUST BE POSITIONED AS IN PICTURE 'C' WITH BIGGER END TOWARD FRONT OF BIKE.** Turn a little more so that you feel the compression increase slightly. Then apply a quarter turn. Tighten to 40Nm of torque (do not exceed this figure, as damage can occur to the motorcycle and the bolt).
- If not already fitted fit one of the bubble stickers into the recess of one of the crash protector caps (item 1).
- Fit the crash protector cap (item 1) into the crash protector as shown in picture A.

Page | 3

Right Side (as you sit on bike)

- Remove the engine bolt on the left side of the bike, as arrowed in picture B.
- Slide the remaining 12mm plain washers (item 3) onto the remaining M12x110mm long hexagon headed bolt (item 2) so the washer sits against head of bolt.
- Slide the remaining serrated locking washer (item 4) over the bolt so it sits against the washer just fitted.
- Next slide the bolt with washers through the remaining crash protector (item 5) so head of bolt and washers goes into counter-bore in the crash protector.
- Slide the remaining spacer (item 6=37mm long) over the exposed end of the bolt as shown in the right-hand side assembly picture above.
- Offer the crash protector assembly up to the frame mount and begin to tighten the bolt as shown in picture B.
- Tighten the bolt until you feel some compression from inside the protector using 19mm socket and wrench. **PLEASE NOTE THE CRASH PROTECTOR MUST BE POSITIONED AS IN PICTURE 'C' WITH BIGGER END TOWARD FRONT OF BIKE.** Turn a little more so that you feel the compression increase slightly. Then apply a quarter turn. **Tighten to 40Nm of torque (do not exceed this figure, as damage can occur to the motorcycle and the bolt).**
- If not already fitted fit one of the bubble stickers into the recess of one of the crash protector caps (item 1).
- Fit the crash protector cap (item 1) into the crash protector as shown in picture B.