



FITTING INSTRUCTIONS FOR CP0379BL AERO CRASH PROTECTORS
YAMAHA YZF-R25/R3 2014-



PICTURE 'A'



PICTURE 'B'



PICTURE 'C'

THIS KIT CONTAINS THE ITEMS PICTURED AND LABELLED BELOW.
DO NOT PROCEED UNTIL YOU ARE SURE ALL PARTS ARE PRESENT.

Please note that the way the kit is packed does not necessarily represent the way of mounting to the bike

Please note that in cases where kits are packed with rubber washers holding the components onto the bolt – *the rubber washers should be thrown away!*

THE PARTS SHOWN MAY BE REPRESENTATIVE ONLY (FOR CLARITY OF INSTRUCTIONS ONLY)

GENERAL TORQUE SETTINGS

- M4 BOLT = 8Nm
- M5 BOLT = 12Nm
- M6 BOLT = 15Nm
- M8 BOLT = 20Nm
- M10 BOLT = 40Nm

R&G Racing

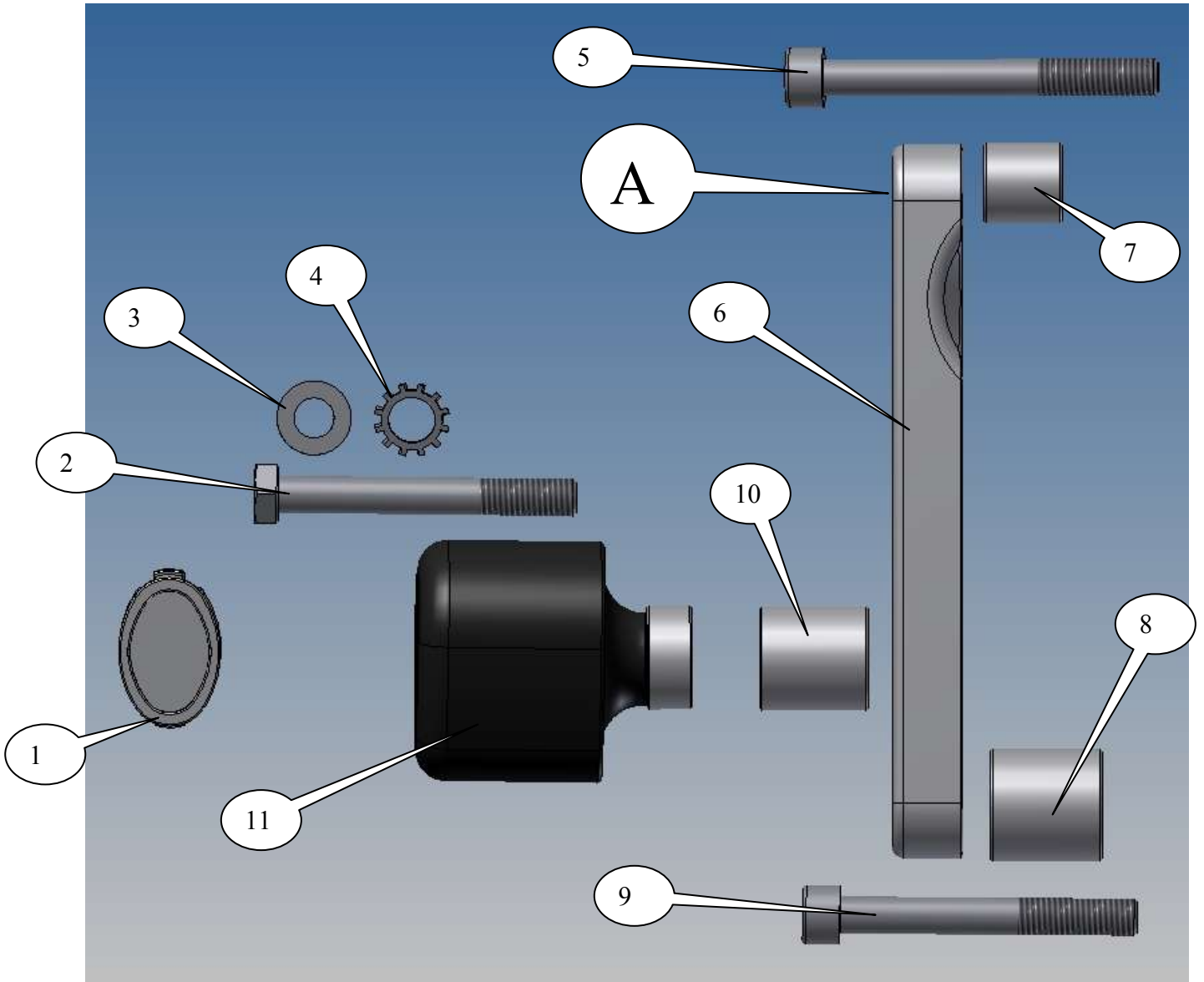

LEFT HAND SIDE

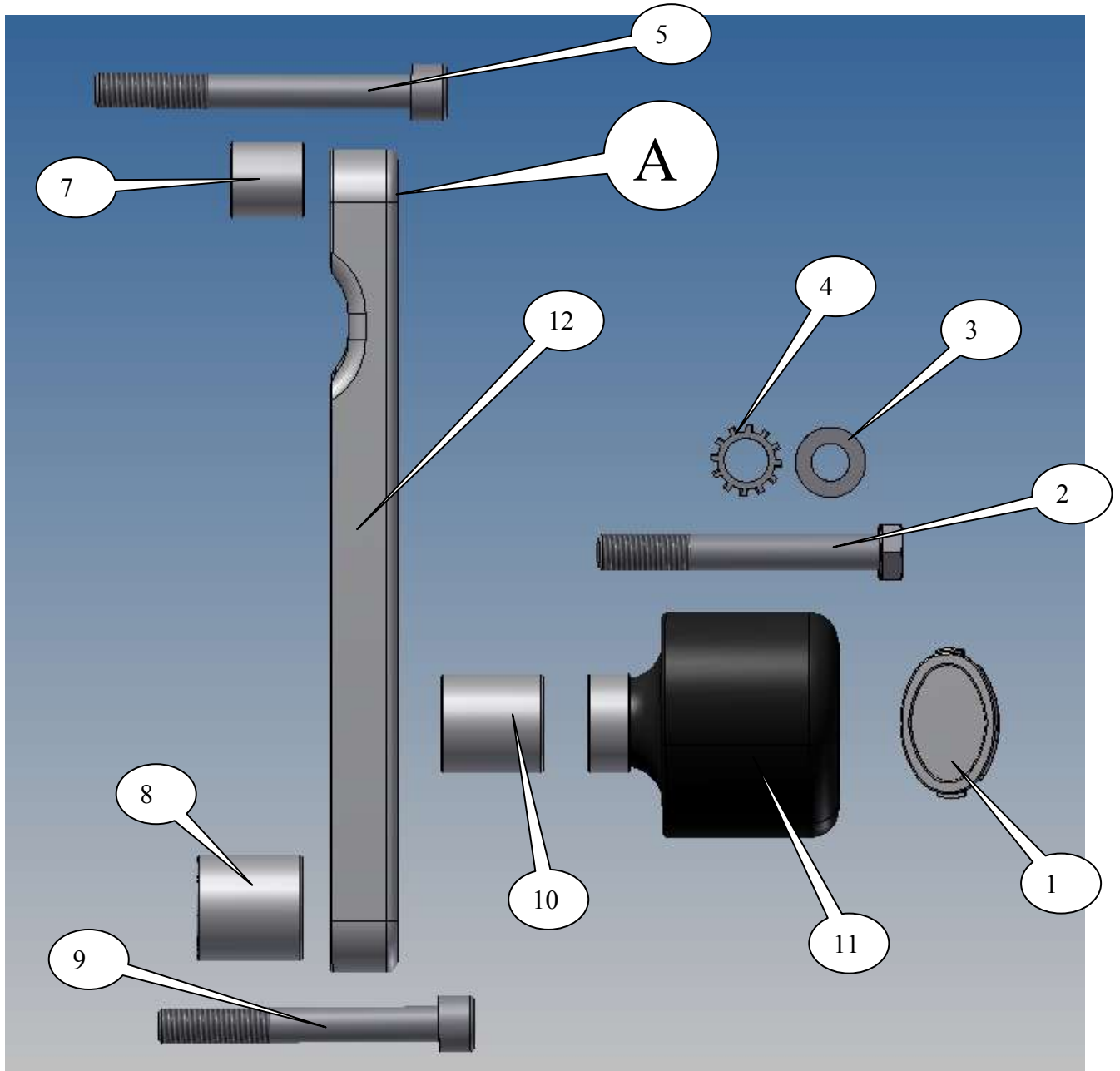

RIGHT HAND SIDE
TOOLS REQUIRED

- Socket set to include 10 and 17mm A/F sockets and wrench.
 - 4, 5, 6 and 8mm Allen keys.
 - Phillips driver.
 - Torque wrench (up to 40Nm).



LEGEND

- ITEM 1 = CRASH PROTECTOR CAPS, R&LHS (BC0002) (x2).
- ITEM 2 = CRASH PROTECTOR BOLTS, M10x1.25x85mm LONG HEX HEAD (x2).
- ITEM 3 = M10 PLAIN WASHERS, R&LHS (x2).
- ITEM 4 = LOCKING WASHERS, R&LHS (LW0001) (x2).
- ITEM 5 = FRONT MOUNTING BLOCK BOLTS M10x1.25x90mm LONG CAP HEAD (x2).
- ITEM 6 = MOUNTING BLOCK LHS (M0413) (x1).
- ITEM 7 = SPACERS, FRONT R&LHS (S0830=21mm LONG) (x2).
- ITEM 8 = SPACERS, REAR R&LHS (S0831=30mm LONG) (x2).
- ITEM 9 = REAR BLOCK MOUNTING BOLTS, M10x1.25x85mm LONG CAP HEAD (x2).
- ITEM 10 = CRASH PROTECTOR SPACERS, R&LHS (S0832=29mm LONG) (x2).
- ITEM 11 = CRASH PROTECTORS, R&LHS (B0431 with CS0341 (10mm) (x2).
- ITEM 12 = MOUNTING BLOCK RHS (M0414) (x1).



Picture 1



Picture 2



Picture 3



Picture 4



Picture 5



Picture 6



Picture 7



Picture 8



Picture 9



Picture 10



Picture 11



Picture 12



Picture 13



Picture 14



Picture 15



Picture 16

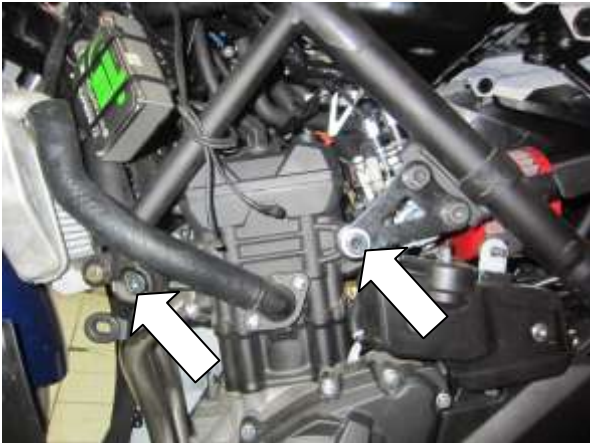

Picture 17



Picture 18

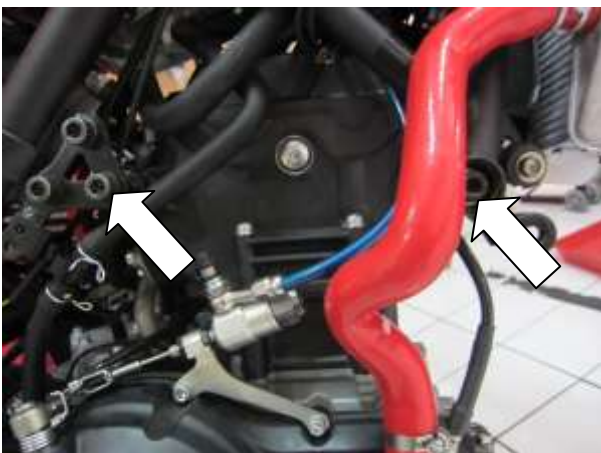

Picture 19



Picture 20

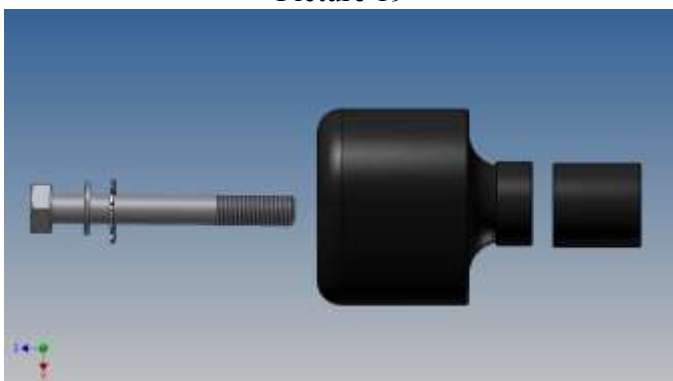

Picture 21

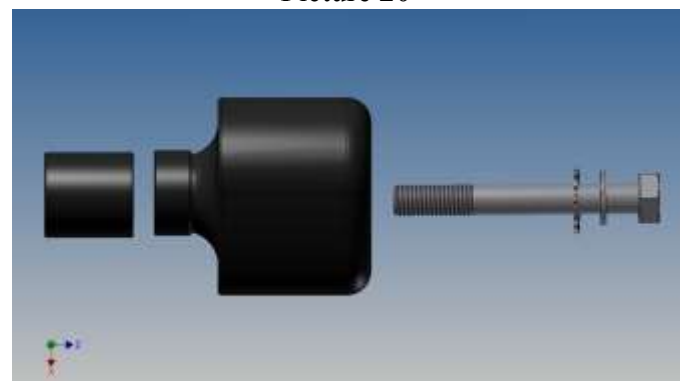

Picture 22



FITTING INSTRUCTIONS

Near side (left side as you sit on bike)

- Remove the two bolts arrowed in pictures 1 and 2 and remove the left hand side plastic infill panel.
- Remove the two bolts arrowed in picture 3 and remove the plastic seat/frame panel.
- Remove the bolts and plastic rivets arrowed in pictures 4 thru 9 and carefully remove the left hand side fairing.

Off side (right side as you sit on bike)

- Remove the two bolts arrowed in pictures 11 and 12 and remove the right hand side plastic infill panel.
- Remove the two bolts arrowed in picture 13 and remove the plastic seat/frame panel.
- Remove the bolts and plastic rivets arrowed in pictures 14 thru 16 and carefully remove the right hand side fairing.

Near side (left side as you sit on bike)

- Remove the two bolts arrowed in picture 17.
- Place one of the longest cap head bolts (item 5=90mm long) through the hole nearest the cut-out (labelled A in the parts diagram on page 2) in the shortest mounting block (item 6) so the head of the bolt goes into the counter-bore.
- Place one of the shortest spacers (item 7=21mm) over the exposed end of the bolt.
- Place one of the shortest cap head bolts (item 9=85mm long) into the rear most hole so the head of the bolt goes into the counter-bore.
- Place one of the longest spacers (item 8) over the exposed end of the bolt.
- Offer this assembly into position as shown in picture 18 and engage both bolts and tighten evenly. Do not exceed 40 N/m of torque.

Off side (right side as you sit on bike)

- Remove the two bolts arrowed in picture 19.
- Place the remaining longest cap head bolt (item 5=90mm long) through the hole nearest the cut-out (labelled B in the parts diagram on page 3) in the longest mounting block (item 12) so the head of the bolt goes into the counter-bore.
- Place the remaining shortest spacer (item 7=21mm) over the exposed end of the bolt.
- Place the remaining shortest cap head bolt (item 9=85mm long) into the rear most hole so the head of the bolt goes into the counter-bore.
- Place the remaining longest spacer (item 8) over the exposed end of the bolt.
- Offer this assembly into position as shown in picture 20 and engage both bolts and tighten evenly. Do not exceed 40 N/m of torque.

Near side (left side as you sit on bike)

- Refit all the left hand side fairings and panels as original.

Off side (right side as you sit on bike)

- Refit all the right hand side fairings and panels as original.

Near side (left side as you sit on bike)

- Place one of the plain washers (item 3) onto one of the hex headed bolts (item 2=85mm long) as shown in picture 21.



- Place one of the locking washers (item 4) over the bolt and against the washer just fitted as shown in picture 21.
- Place the bolt and washers through one of the crash protectors (item 11) as shown in picture 21.
- Place one of the remaining spacers (item 10=29mm long) over the exposed end of the bolt as shown in picture 21.
- Offer this assembly into position as shown in picture 'A' on page 1 (please ensure no parts come in contact with any fairing panels). Finally tighten the crash protector bolts until you feel some compression from inside the protector using 17mm socket and wrench. **PLEASE NOTE THE CRASH PROTECTOR MUST BE POSITIONED AS IN PICTURE 'C' WITH BIGGER END TOWARD FRONT OF BIKE.** Turn a little more so that you feel the compression increase slightly. Then apply a quarter turn. Do not over tighten as damage can occur to the bike. Do not exceed 40 N/m of torque.
- If not already fitted, fit bubble sticker into recess of crash protector cap (item 1).
- Fit crash protector cap (item 1) into the crash protector.

Off side (right side as you sit on bike)

- Place the remaining plain washer (item 3) onto the remaining hex headed bolt (item 2=85mm long) as shown in picture 22.
- Place the remaining locking washer (item 4) over the bolt and against the washer just fitted as shown in picture 22.
- Place the bolt and washers through the remaining crash protector (item 11) as shown in picture 22.
- Place the remaining spacer (item 10=29mm long) over the exposed end of the bolt as shown in picture 22.
- Offer this assembly into position as shown in picture 'B' on page 1 (please ensure no parts come in contact with any fairing panels). Finally tighten the crash protector bolts until you feel some compression from inside the protector using 17mm socket and wrench. **PLEASE NOTE THE CRASH PROTECTOR MUST BE POSITIONED AS IN PICTURE 'C' WITH BIGGER END TOWARD FRONT OF BIKE.** Turn a little more so that you feel the compression increase slightly. Then apply a quarter turn. Do not over tighten as damage can occur to the bike. Do not exceed 40 N/m of torque.
- If not already fitted, fit bubble sticker into recess of crash protector cap (item 1).
- Fit crash protector cap (item 1) into the crash protector.