



**FITTING INSTRUCTIONS FOR FP0182BK FORK PROTECTORS**  
**KAWASAKI ZX-10R '16-**



**THIS KIT CONTAINS THE ITEMS PICTURED AND LABELLED BELOW.**  
**DO NOT PROCEED UNTIL YOU ARE SURE ALL PARTS ARE PRESENT.**

Please note that the way the kit is packed does not necessarily represent the way of mounting to the bike.

Please note that in cases where kits are packed with a plastic tube separating components on the spindle bar (this tube should be discarded).

THE PARTS SHOWN MAY BE REPRESENTATIVE ONLY (FOR CLARITY OF INSTRUCTIONS ONLY)

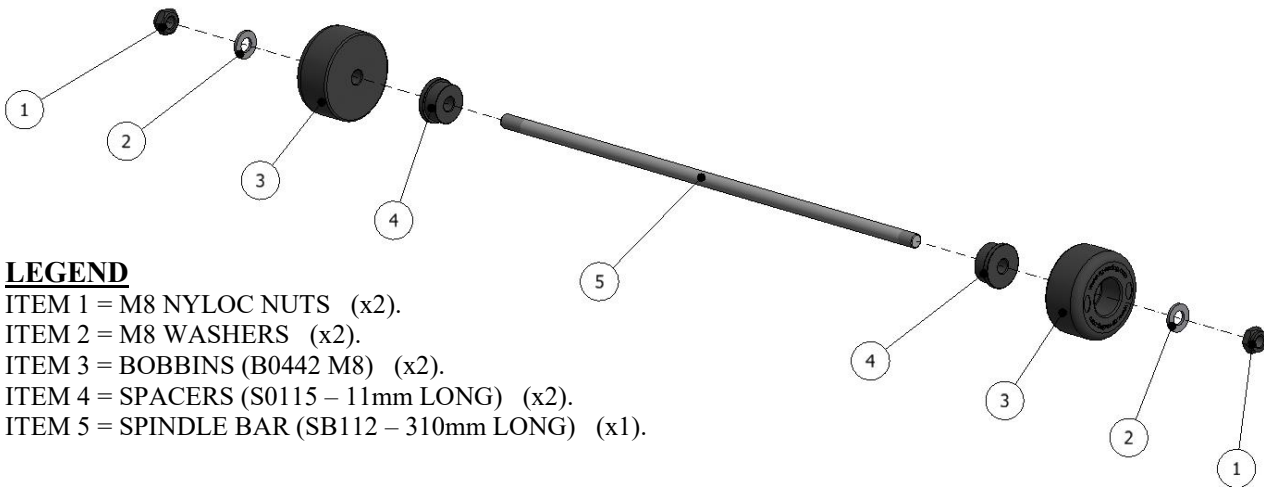

**LEGEND**

- ITEM 1 = M8 NYLOC NUTS (x2).
- ITEM 2 = M8 WASHERS (x2).
- ITEM 3 = BOBBINS (B0442 M8) (x2).
- ITEM 4 = SPACERS (S0115 – 11mm LONG) (x2).
- ITEM 5 = SPINDLE BAR (SB112 – 310mm LONG) (x1).



### **TOOLS REQUIRED**

- Socket set to include 2x 13mm sockets.

### **FITTING INSTRUCTIONS**

- Fit one spacer (S0115 – 11mm long) into the hexagon shaped recess on the right hand side of the front spindle.
- Fit one nut and washer onto the spindle bar (the end with shorter thread) and engage the nut so the plastic insert of the nut is fully engaged.
- Feed the spindle bar (SB112) with nut and washer through either bobbin (B0442 M8) and through the spacer just fitted.
- Place the remaining spacer (S0115 – 11mm long) over the exposed left hand end of spindle bar so the spacer fits inside the hexagon shaped recess on the front spindle and then slide the remaining bobbin (B0442 M8) onto the spindle bar.
- Fit the washer and nut from the kit onto the thread and tighten until both nuts are engaged in nylon and equal amounts protrude from either side. Do not overtighten - the nyloc nuts will hold it tight.

### **CONSUMER NOTICE**

The catalogue description and any exhibition of samples are only broad indications of the Products and R&G may make design changes which do not diminish their performance or visual appeal and supplying them in such state shall conform to the order. The Buyer acknowledges no representation or warranty (other than as to title) has been given or will apply to the Products other than those in R&G's order or confirmation and the Buyer confirms it has chosen the Products as being of merchantable quality and suitable for its particular purposes. Where R&G fits the Products or undertakes other services it shall exercise reasonable skill and care and rectify any fault free of charge unless the workmanship has been disturbed. The Buyer is responsible for ensuring that the warranty on the motorcycle is not affected by the fitting of the Products. On return of any defective Products R&G shall at its option either supply a replacement or refund the purchase money but shall not be liable if the Products have been modified or used or maintained otherwise than in accordance with R&G's or manufacturer's instructions and good engineering practice or if the defect arises from accident or neglect. Other than identified above and subject to R&G not limiting its liability for causing death and personal injury, it shall not be liable for indirect or consequential loss and otherwise its liability shall be limited to the amounts paid by the Buyer for the Products or the fitting or service concerned. These terms do not affect the Buyer's statutory rights.