



LP0245

**FITTING INSTRUCTIONS FOR LP0245BK LICENCE PLATE BRACKET  
KAWASAKI NINJA 400 2018 (FOR USE WITH STANDARD AND R&G MINI  
INDICATORS (8mm))**

Page | 1



**THIS KIT CONTAINS THE ITEMS PICTURED AND LABELLED BELOW.  
DO NOT PROCEED UNTIL YOU ARE SURE ALL PARTS ARE PRESENT.**

**Please note that the way the kit is packed does not necessarily represent the way of mounting to the bike**

THE PARTS SHOWN MAY BE REPRESENTATIVE ONLY (FOR CLARITY OF INSTRUCTIONS ONLY)

**GENERAL TORQUE SETTINGS**

M4 BOLT = 8Nm  
M5 BOLT = 12Nm  
M6 BOLT = 15Nm  
M8 BOLT = 20Nm  
M10 BOLT = 40Nm

Please note that in cases where kits are packed with rubber washers holding the components onto the bolt – *the rubber washers should be thrown away!*

**TOOLS REQUIRED**

- Set of metric Allen keys to include 3, 4 and 5mm A/F sizes.
- Socket set to include 8, 12 and 13mm A/F socket and wrench.
  - Phillips driver.
  - Electrical pliers/crimps.
  - Small amount of super glue.



LP0245

Page | 2

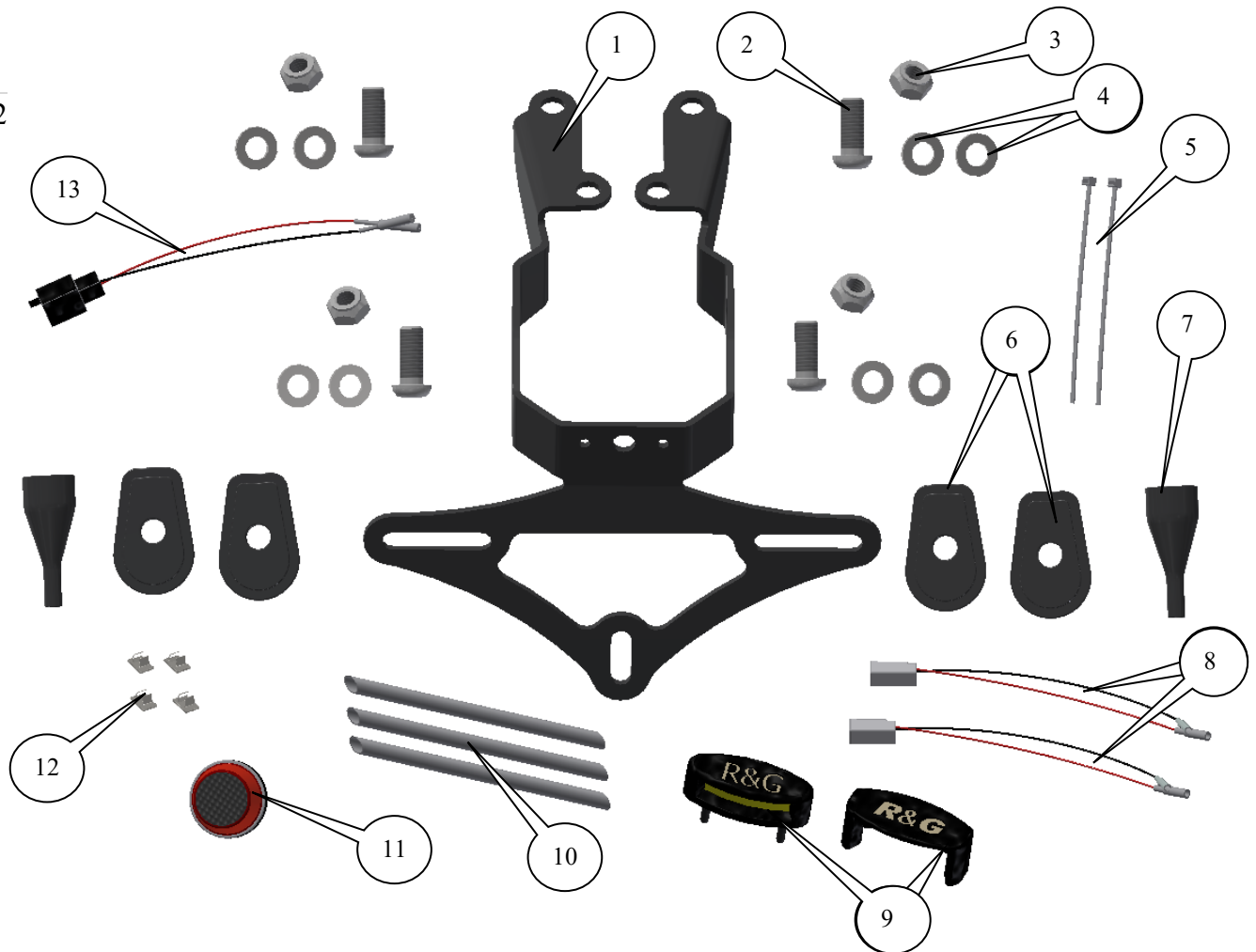

**LEGEND**

- ITEM 1 = LICENCE PLATE BRACKET (TB0245) (x1).
- ITEM 2 = M8 x 25mm LONG BUTTON HEAD BOLTS (x4).
- ITEM 3 = M8 NYLOC NUTS (x4).
- ITEM 4 = M8 WASHER (x8).
- ITEM 5 = CABLE TIES (x2).
- ITEM 6 = MINI INDICATOR ADAPTORS (I0039) (x4).
- ITEM 7 = SILICON INDICATOR NUT COVERS (IWC0002) (x2).
- ITEM 8 = MINI INDICATOR CONNECTORS (CON0032) (x2).
- ITEM 9 = LICENCE PLATE ILLUMINATOR ASSEMBLY (LA0002) (x1).
- ITEM 10 = 200mm LENGTH OF HEAT SHRINK (x3).
- ITEM 11 = REFLECTOR (REFL 1) (x1).
- ITEM 12 = CABLE CLIPS (x4).
- ITEM 13 = LICENCE PLATE ILLUMINATOR CONNECTOR (CON0007) (x1).



LP0245



Picture 1

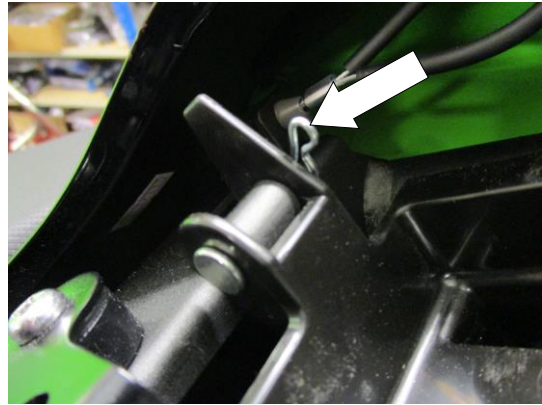

Picture 2

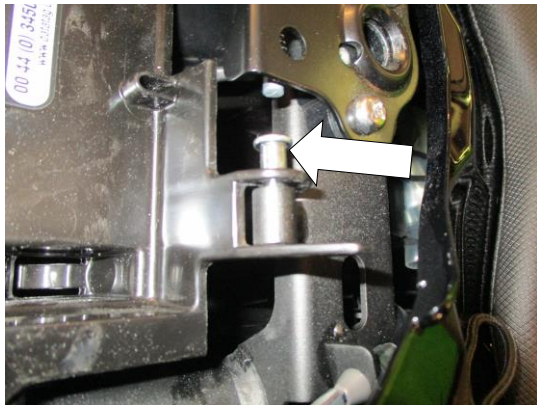

Picture 3



Picture 4

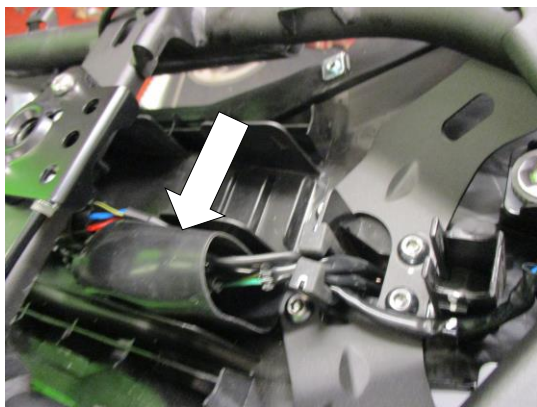

Picture 5

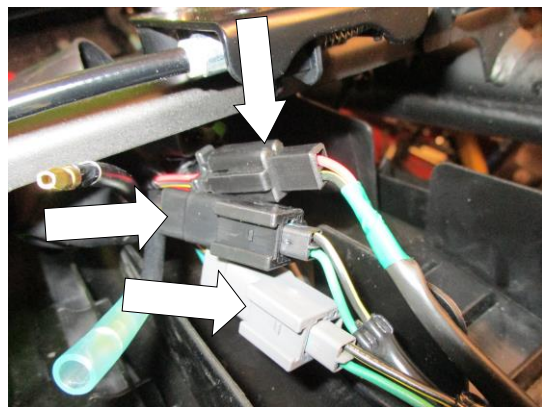

Picture 6



LP0245

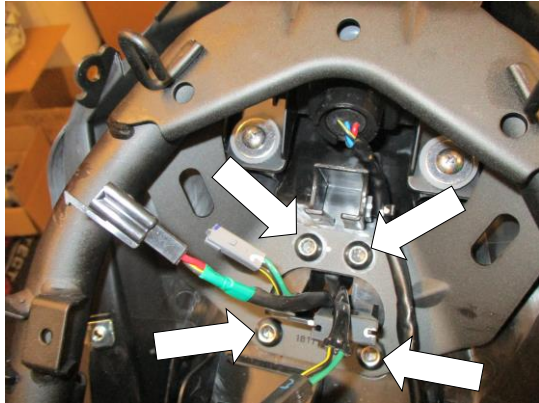

Picture 7



Picture 8



Picture 9



Picture 10



Picture 11



Picture 12



LP0245



Picture 13

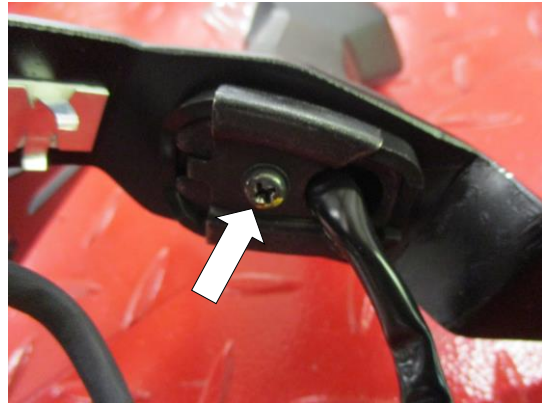

Picture 14



Picture 15

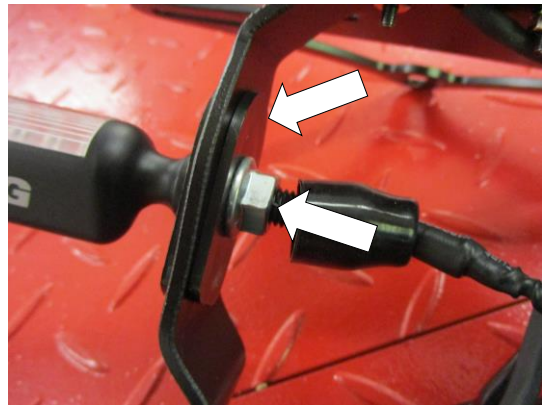

Picture 16

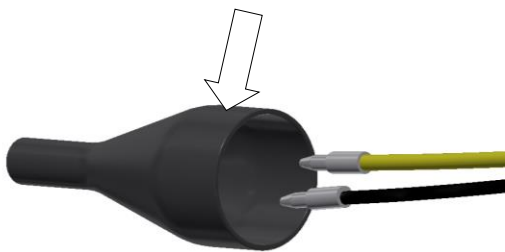

Picture 17

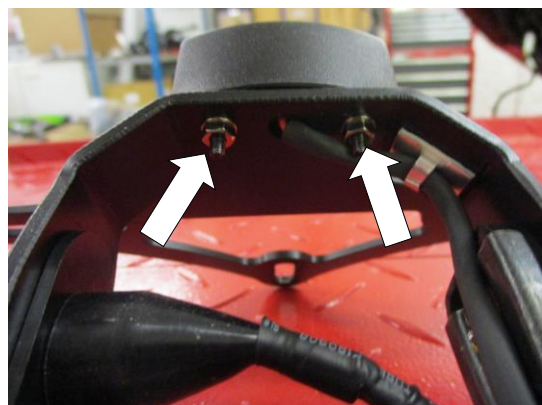

Picture 18



LP0245

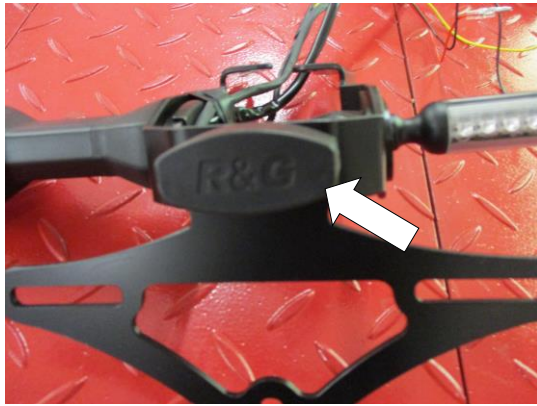

Picture 19



Picture 20



Picture 21

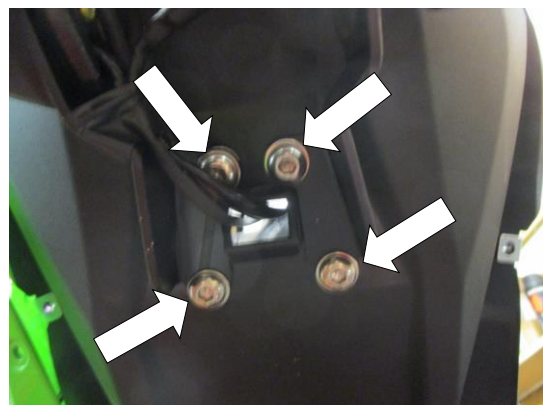

Picture 22

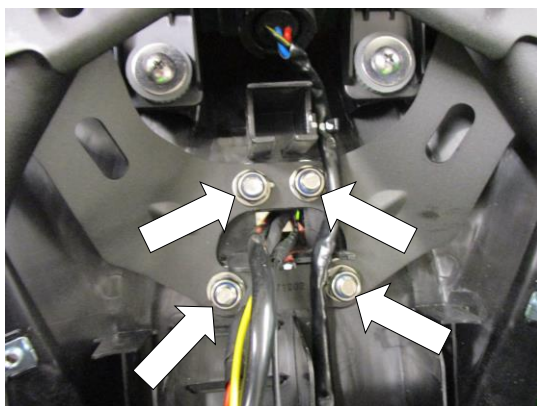

Picture 23



Picture 24



LP0245

### **FITTING INSTRUCTIONS**

- To fit the R&G tail tidy, first remove the seat using the key as shown in picture 1.
- Remove the two 'R' clips indicated in picture 2 and remove the two pins indicated in picture 3.
- Remove the under-seat tray cover as shown in picture 4.
- Slide the rubber plug socket cover along the wiring loom to give access to the indicator and licence plate illuminator as indicated in picture 5.
- Disconnect the three plug sockets as arrowed in picture 6 (indicators and licence plate illuminator).
- Remove the four bolts arrowed in picture 7, while supporting the original licence plate bracket from underneath.
- Carefully lower the original licence plate bracket while feeding the wiring through the hole in the under-tray.

#### **If reusing the original indicators**

- Remove the screw arrowed in picture 8.
- Remove the indicator clamp bracket as shown in picture 9.
- Remove the indicator spreader plate as shown in picture 10.
- Gently squeeze the indicator stem and remove the indicator
- Repeat the above steps to remove the opposite indicator.
- Fit the indicators into the new licence plate bracket (item 1) and secure as shown in pictures 11,12,13, and 14.

#### **If using the mini indicators**

- To fit the R&G Mini Indicators (R&G mini indicator product code RG370 for bulb type and RG371 for LED type or RG372 for Aero Style led type).
- Position the two indicator adaptors (item 6 –I0039) onto the wiring of each indicator, ensuring the sides facing each other have the raised centre profile, before fitting the flanged nut supplied, as shown in pictures 15 and 16.
- Feed the indicator wiring through the nut/wire cover (item 7) as shown in pictures 16 and 17 (it helps if a small amount of liquid detergent is used) and position the nut cover over the nut.
- Fit one length of heat-shrink (item 10) to the wires of each indicator.
  
- Fit the R&G licence plate illuminator (item 9) as shown in pictures 18 and 19, please note you will have to fit the light shroud and use a small amount of adhesive to hold it in position. Fit one length of heat-shrink (item 10) to the wire. It is a good idea to reconnect to the wiring loom using the supplied connector (item 13) to check at this stage (if illumination fails, swap the bullet connections around).
- Tidy the wiring to the licence plate bracket using the supplied clips and cable ties (items 5 and 12).
- Offer the new licence plate bracket into position while feeding the wiring through the hole in the under-tray as shown in pictures 20 and 21.
- Fit the four button head bolts with washers (items 2 and 4) through the four holes in the new licence plate bracket as shown in picture 22.
- Secure using the four nuts with washers (items 3 and 4) as shown in picture 23, please ensure the wires are not crushed.



LP0245

- Route the wiring as original and reconnect the licence plate illuminator and indicators to the original plug sockets.
- If using led mini indicators, you will have to use a resistor on each indicator (R and G product code RGR0001) to achieve the correct flash rate. It is a good idea to connect the indicators to the main loom using the supplied connectors (item 8) at this stage, if illumination fails please swap the bullet connection around.
- If using bulb mini indicators, it is a good idea to connect the indicators to the main loom using the supplied connectors (item 8) at this stage, if illumination fails please swap the bullet connection around.
- Refit the under-seat tray cover as original (as shown in picture 24).
- Refit the seat as original and licence plate (it may require drilling).
- **IMPORTANT: IF FITTING A FULL-SIZE LICENCE PLATE AND PLACING IT FAR DOWN ON THE LICENCE PLATE HANGER, THERE IS A SMALL CHANCE OF THE LICENCE PLATE HITTING THE BACK WHEEL UNDER HEAVY LOAD AND OVER LARGE BUMPS IN THE ROAD. IT IS YOUR RESPONSIBILITY TO CHECK FOR THIS POSSIBILITY AND TAKE AVOIDING ACTION. FAILURE TO CHECK THIS COULD RESULT IN SERIOUS INJURY.**
- Depending on local laws, attach enclosed reflector (item 11) in an appropriate location.
- Test the license plate illuminator and all lights before riding.

ISSUE 1 19/04/2018 (NSY)

#### CONSUMER NOTICE

The catalogue description and any exhibition of samples are only broad indications of the Products and R&G may make design changes which do not diminish their performance or visual appeal and supplying them in such state shall conform to the order. The Buyer acknowledges no representation or warranty (other than as to title) has been given or will apply to the Products other than those in R&G's order or confirmation and the Buyer confirms it has chosen the Products as being of merchantable quality and suitable for its particular purposes. Where R&G fits the Products or undertakes other services it shall exercise reasonable skill and care and rectify any fault free of charge unless the workmanship has been disturbed. The Buyer is responsible for ensuring that the warranty on the motorcycle is not affected by the fitting of the Products. On return of any defective Products R&G shall at its option either supply a replacement or refund the purchase money but shall not be liable if the Products have been modified or used or maintained otherwise than in accordance with R&G's or manufacturer's instructions and good engineering practice or if the defect arises from accident or neglect. Other than identified above and subject to R&G not limiting its liability for causing death and personal injury, it shall not be liable for indirect or consequential loss and otherwise its liability shall be limited to the amounts paid by the Buyer for the Products or the fitting or service concerned. These terms do not affect the Buyer's statutory rights.