



FITTING INSTRUCTIONS FOR AB0002BK ADVENTURE BARS
KAWASAKI GTR 1400 2010-



PICTURE ONE



PICTURE TWO

THIS KIT CONTAINS THE ITEMS PICTURED AND LABELLED BELOW.
DO NOT PROCEED UNTIL YOU ARE SURE ALL PARTS ARE PRESENT.

Please note that the way the kit is packed does not necessarily represent the way of mounting to the bike

THE PARTS SHOWN MAY BE REPRESENTATIVE ONLY (FOR CLARITY OF INSTRUCTIONS ONLY)

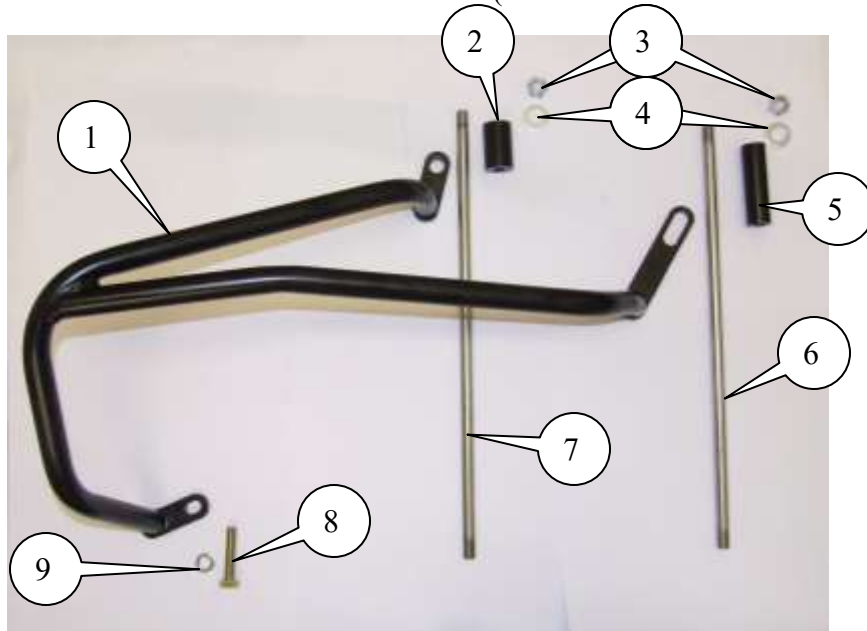

LEFT HAND SIDE



THIS KIT CONTAINS THE ITEMS PICTURED AND LABELLED BELOW.
DO NOT PROCEED UNTIL YOU ARE SURE ALL PARTS ARE PRESENT.

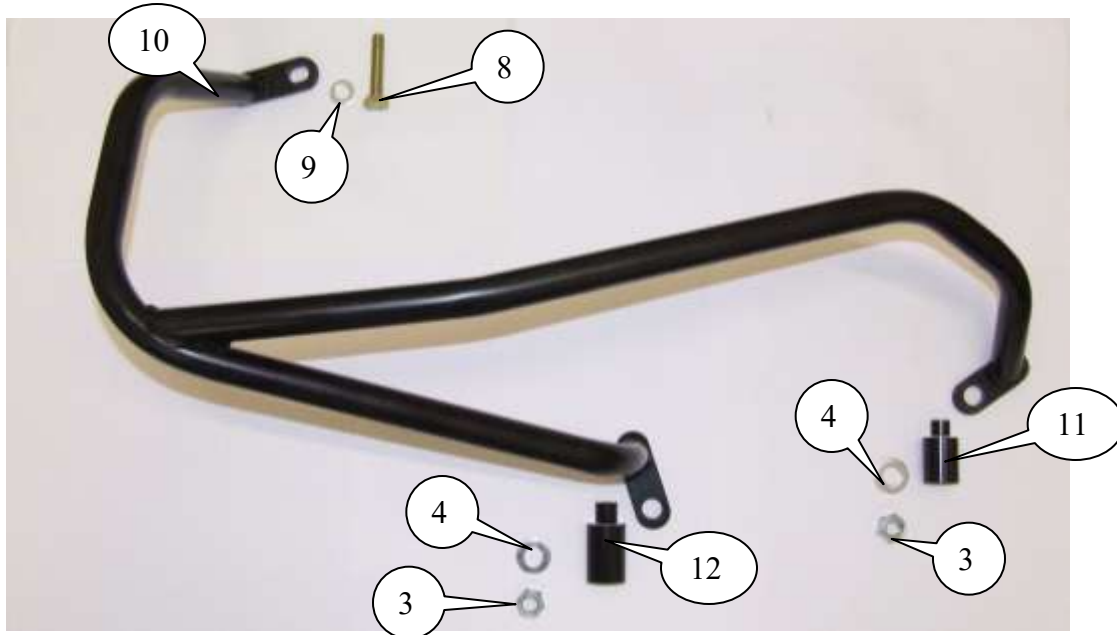

RIGHT HAND SIDE

LEGEND

- ITEM 1 = ADVENTURE BAR LEFT-HAND SIDE (CB008) (x1).
- ITEM 2 = UPPER SPACER LEFT-HAND SIDE (S0319) (45mm LONG) (x1).
- ITEM 3 = M12 NYLOC NUTS, TWO PER SIDE (x4).
- ITEM 4 = M12 WASHERS, TWO PER SIDE (x4).
- ITEM 5 = LOWER SPACER LEFT-HAND SIDE (S0420) (78mm LONG) (x1).
- ITEM 6 = LOWER ENGINE BAR (EB058) (405mm LONG) (x1).
- ITEM 7 = UPPER ENGINE BAR (EB057) (430mm LONG) (x1).
- ITEM 8 = M10x1.25x50mm LONG HEX HEAD BOLTS, ONE PER SIDE (x2).
- ITEM 9 = M10 WASHERS, ONE PER SIDE (x2).
- ITEM 10 = ADVENTURE BAR RIGHT-HAND SIDE (CB009) (x1).
- ITEM 11 = LOWER SPACER RIGHT-HAND SIDE (S0291) (47mm LONG) (x1).
- ITEM 12 = UPPER SPACER RIGHT-HAND SIDE (S0419) (55mm LONG) (x1).

TOOLS REQUIRED

- Socket set to include 17 and 19mm sockets and wrench.
 - 8mm A/F hex bit socket.
 - Torque wrench (up to 40Nm).



PICTURE THREE

Left-hand side (as you sit on bike)

- Remove the two nuts in position arrowed in picture THREE.
- Using the longer engine bar (ITEM 7) and a soft-faced mallet, gently drive out the upper original engine bar leaving the same length of new engine bar protruding from both sides (ensure the original bar does not fall or cause any damage).
- Place spacer ITEM 12 (55mm long) over exposed end of upper engine bar on the right hand side, please ensure the smaller spigot diameter is located in the engine location hole.
- Using the shorter engine bar (ITEM 6) and a soft-faced mallet, gently drive out the lower original engine bar leaving the same length of new engine bar protruding from both sides (ensure the original bar does not hit the foot brake lever and does not fall or cause any damage).
- Place spacer ITEM 11 (47mm long) over exposed end of lower engine bar on the right hand side please ensure the smaller spigot diameter is located in the engine location hole.
- Place spacer ITEM 2 (45mm long) over exposed end of upper engine bar on the left hand side.
- Place spacer ITEM 5 (78mm long) over exposed end of lower engine bar on the left hand side.
- Remove the cap head bolt in position arrowed in picture ONE.
- Carefully offer left hand adventure bar (ITEM 1) up to bike feeding the front mounting through the vents in the side fairing as shown in picture ONE.
- While ensuring the adventure bar does not contact the fairing place the upper and lower mounts over the exposed ends of the new engine bars.
- Place nuts and washers onto upper and lower engine bars; do not tighten at this stage.
- Using one of the M10 hex headed bolts and washers (ITEM'S 8 and 9) secure the front mount of the adventure bars.



Right-hand side (as you sit on bike)

- Remove the cap head bolt in position arrowed in picture TWO.
- Carefully offer the right hand adventure bar (ITEM 10) up to bike feeding the front mounting through the vents in the side fairing as shown in picture TWO.
- While ensuring the adventure bar does not contact the fairing place the upper and lower mounts over the exposed ends of the new engine bars.
- Place nuts and washers onto upper and lower engine bars; do not tighten at this stage.
- Using the remaining M10 hex headed bolts and washers (ITEM'S 8 and 9) secure the front mount of the adventure bars.
- Tighten all engine bar nuts ensuring the bars protrude equal amounts through the nuts on both sides and are not in contact with any fairing or mechanical parts. Do not over tighten as damage can occur to the bike. **Do not exceed 40Nm of torque.**
- **BEFORE RIDING PLEASE ENSURE NO PARTS HINDER OR IMPEDE ANY FUNCTION OF THE MOTORCYCLE.**

CONSUMER NOTICE

The catalogue description and any exhibition of samples are only broad indications of the Products and R&G may make design changes which do not diminish their performance or visual appeal and supplying them in such state shall conform to the order. The Buyer acknowledges no representation or warranty (other than as to title) has been given or will apply to the Products other than those in R&G's order or confirmation and the Buyer confirms it has chosen the Products as being of merchantable quality and suitable for its particular purposes. Where R&G fits the Products or undertakes other services it shall exercise reasonable skill and care and rectify any fault free of charge unless the workmanship has been disturbed. The Buyer is responsible for ensuring that the warranty on the motorcycle is not affected by the fitting of the Products. On return of any defective Products R&G shall at its option either supply a replacement or refund the purchase money but shall not be liable if the Products have been modified or used or maintained otherwise than in accordance with R&G's or manufacturer's instructions and good engineering practice or if the defect arises from accident or neglect. Other than identified above and subject to R&G not limiting its liability for causing death and personal injury, it shall not be liable for indirect or consequential loss and otherwise its liability shall be limited to the amounts paid by the Buyer for the Products or the fitting or service concerned. These terms do not affect the Buyer's statutory rights.