



FITTING INSTRUCTIONS FOR SS0032 SPINDLE SLIDERS
TRIUMPH SPEED TRIPLE 2011



THIS KIT CONTAINS THE ITEMS PICTURED AND LABELLED BELOW.
DO NOT PROCEED UNTIL YOU ARE SURE ALL PARTS ARE PRESENT.

Please note that the way the kit is packed does not necessarily represent the way of mounting to the bike.

THE PARTS SHOWN MAY BE REPRESENTATIVE ONLY (FOR CLARITY OF INSTRUCTIONS ONLY)

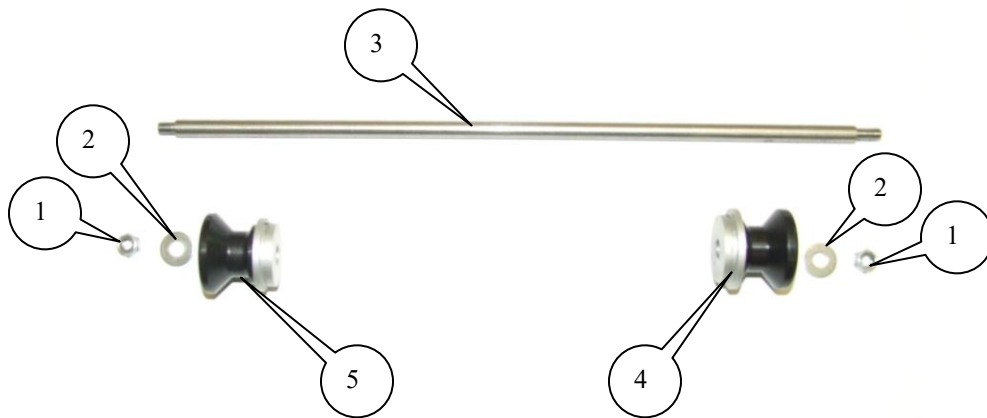



LEGEND

ITEM 1 = M6 NYLOC NUTS (x2).

ITEM 2 = M6 WASHERS (16mm OUTSIDE DIAMETER) (x2).

ITEM 3 = SPINDLE BAR (SB077 340mm LONG) (x1)

ITEM 4 = PADDOCK STAND BOBBINS L-H-S (B0301 WITH CS315) (x1).

ITEM 5 = PADDOCK STAND BOBBINS L-H-S (B0301 WITH CS410) (x1).

ITEM 6 = SPINDLE BAR (SB0024) (x1)

Please note that in cases where kits are packed with rubber washers holding the components onto the bolt – *the rubber washers should be thrown away!*

TOOLS REQUIRED

- TWO 10mm A/F SOCKETS AND WRENCHES.

FITTING INSTRUCTIONS

- PLACE PADDOCK STAND BOBBIN WITH SMALLER LOCATION SPIGOT (S0301 WITH CS315, ITEM 5) INTO LEFT-HAND FRONT SPINDLE.
- PLACE PADDOCK STAND BOBBIN WITH LARGER LOCATION SPIGOT (S0301 WITH CS410, ITEM 4) INTO RIGHT-HAND FRONT SPINDLE.
- FEED SPINDLE-BAR (SB077, ITEM 3) THROUGH PADDOCK STAND BOBBINS IN FRONT SPINDLE.
- FIT WASHERS AND NYLOC NUTS ONTO EITHER END OF SPINDLE BAR.
- TIGHTEN UNTIL BOTH NUTS ARE ENGAGED IN NYLON AND EQUAL AMOUNTS PROTRUDE FROM EITHER SIDE. DO NOT OVER-TIGHTEN—THE NYLOC NUTS WILL HOLD IT TIGHT.

CONSUMER NOTICE

The catalogue description and any exhibition of samples are only broad indications of the Products and R&G may make design changes which do not diminish their performance or visual appeal and supplying them in such state shall conform to the order. The Buyer acknowledges no representation or warranty (other than as to title) has been given or will apply to the Products other than those in R&G's order or confirmation and the Buyer confirms it has chosen the Products as being of merchantable quality and suitable for its particular purposes. Where R&G fits the Products or undertakes other services it shall exercise reasonable skill and care and rectify any fault free of charge unless the workmanship has been disturbed. The Buyer is responsible for ensuring that the warranty on the motorcycle is not affected by the fitting of the Products. On return of any defective Products R&G shall at its option either supply a replacement or refund the purchase money but shall not be liable if the Products have been modified or used or maintained otherwise than in accordance with R&G's or manufacturer's instructions and good engineering practice or if the defect arises from accident or neglect. Other than identified above and subject to R&G not limiting its liability for causing death and personal injury, it shall not be liable for indirect or consequential loss and otherwise its liability shall be limited to the amounts paid by the Buyer for the Products or the fitting or service concerned. These terms do not affect the Buyer's statutory rights.