



FITTING INSTRUCTIONS FOR ECS0142BK RIGHT-HAND SIDE ENGINE CASE SLIDER



Picture A



Picture B

THIS KIT CONTAINS THE ITEMS PICTURED AND LABELLED OVER PAGE.

SOME PARTS MAY BE SHOWN FOR CLARITY OF INSTRUCTIONS ONLY.

DO NOT PROCEED UNTIL YOU ARE SURE ALL PARTS ARE PRESENT.

PLEASE READ ALL INSTRUCTIONS BEFORE PROCEEDING.

PLEASE NOTE THAT THE WAY THE KIT IS PACKED DOES NOT NECESSARILY REPRESENT THE WAY OF MOUNTING TO THE BIKE.

IN THE EVENT OF RUBBER WASHERS BEING USED TO HOLD COMPONENTS ONTO BOLTS,
THESE RUBBER WASHERS CAN BE THROWN AWAY.



<u>TOOLS REQUIRED</u>	<u>GENERAL TORQUE SETTINGS</u>
<ul style="list-style-type: none"> • T30 Torx Tool • 5mm A/F Allen Tool • Torque Wrench 	<p>M4 BOLT = 8Nm</p> <p>M5 BOLT = 12Nm</p> <p>M6 BOLT = 15Nm</p> <p>M8 BOLT = 20Nm</p> <p>M10 BOLT = 40Nm</p> <p>M12 BOLT = 40Nm</p>

LEGEND

ITEM No.	DESCRIPTION	QTY
ITEM 1	ECS0142 H.D.P.E. ENGINE CASE SLIDER (FITTED WITH 1x CS530, 1x CS531, 1x CS532 COMPRESSION SLEEVES)	1
ITEM 2	M6 x 1.0 x 65.0mm STAINLESS STEEL CAP HEAD BOLT	1
ITEM 3	M6 x 1.0 x 55.0mm STAINLESS STEEL CAP HEAD BOLT	2
ITEM 4	M6 WASHER (12mm O/D)	3

EXPLODED ASSEMBLY DIAGRAM

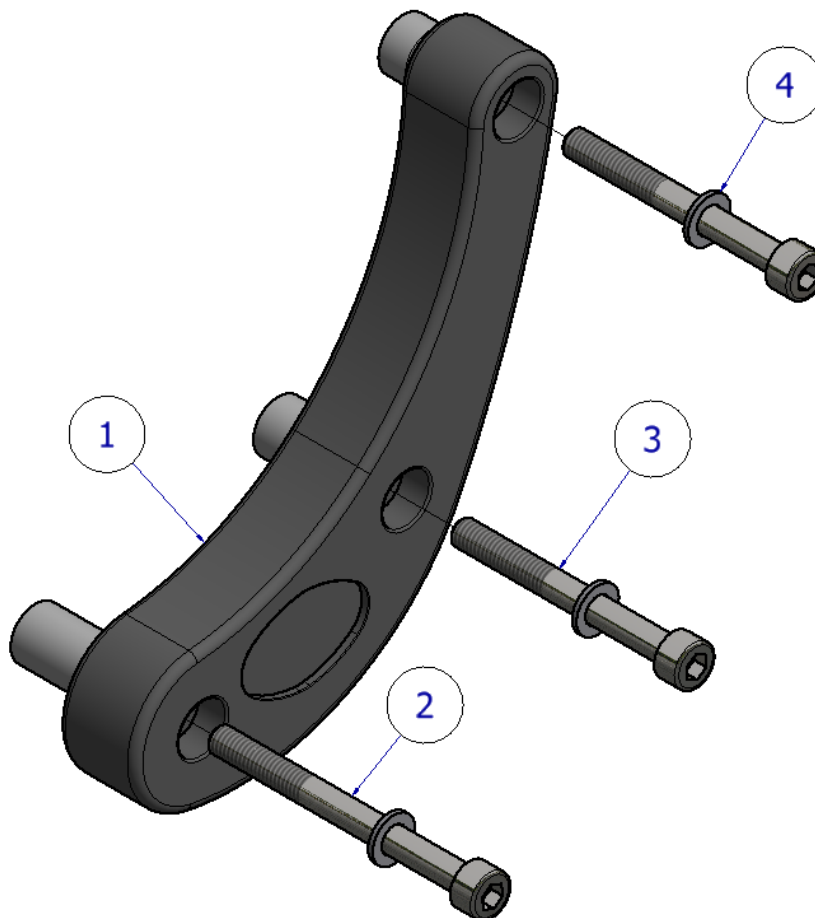

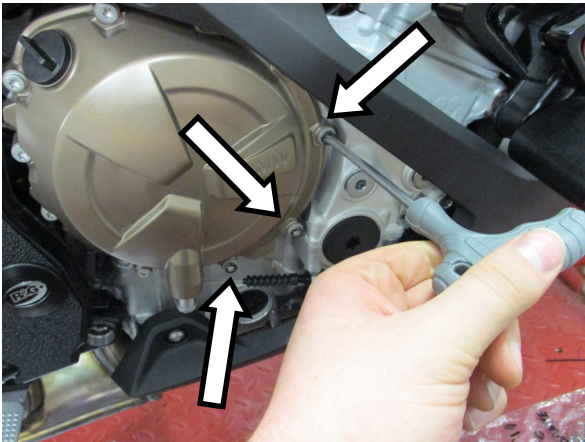

Picture 1

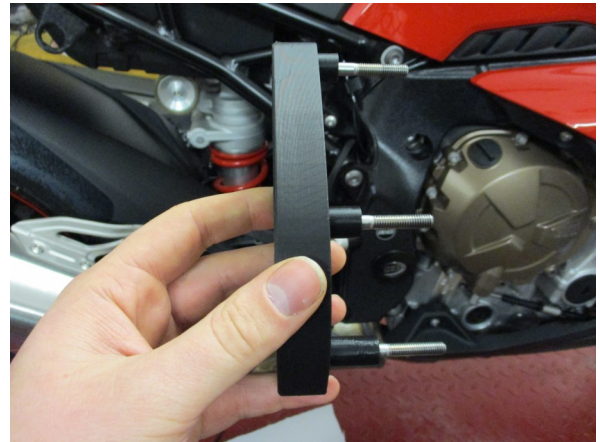

Picture 2

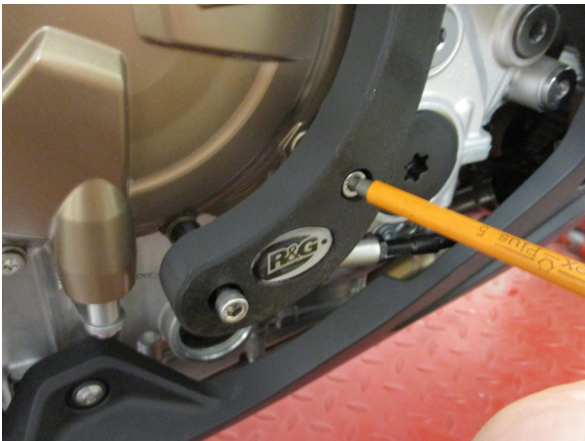

Picture 3



Picture 4

FITTING INSTRUCTIONS

- Remove the 3x T30 engine case bolts shown in picture 1.
- Referring to the diagram on page 2 as well as picture 2, pre-assemble the R&G engine case slider. Slide a washer (item 4) over each of the 3x cap-head bolts. Now, slide the 2x 55mm bolt (item 3) assemblies through the top 2 recessed mounting holes in the engine case slider (item 1), then slide the 65mm bolt (item 2) assembly through the bottom mounting hole.
- Offer the assembled slider up to the engine case, then secure using a 5mm Allen key as shown in picture 3, finally fully tightening to the manufacturers specified torque.
- If not already fitted, attach one of the included R&G bubble stickers to the slider.