

**BMW**  
**R125 0GS/GP/ADV - R1200GS/EXC./RALL. - F850GS - F750GS**

**REF 9847 UPPER DEFLECTORS**



1 Person



20 min



EASY



N° 10



N° T25  
N° T30



ALLEN  
N° 3

ID	PART	DESCRIPTION	QTY	REF
1		Left deflector	1	9847F/H/WM3
2		Right deflector	1	9847F/H/WM3
3		Left support (L)	1	SOPOR-2P-6-9847
4		Right support (R)	1	SOPOR-2P-6-9847
5		Ø8 x Ø14 x 3,5 bush	2	CASQUI-----182
6		M5 ISO 7380 screw cap	6	TAPON-----85
7		M5x11 Ø11 ISO 7380 Allen screw	6	TORNI-AI----520
8		M5x1 nylon washer	6	ARNV0000000245
9		Ø8 x 2 silicon adhesive spacer	2	ADHESI-GT-D8---
10		Ø4,5 x Ø11 x 2 Rubber washer	6	ARAND-EPDM--722

## MOUNTING INSTRUCTIONS BMW R1250GS / F750GS / F850GS

The right side assembly is shown as an example, so the same steps can be performed for the left side assembly.

**1**

DISASSEMBLY

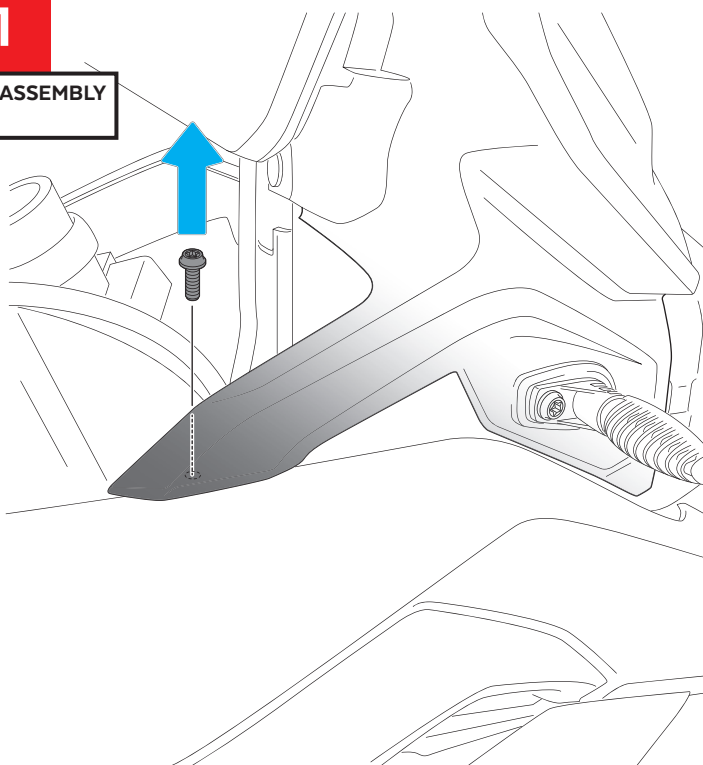

**2**

DISASSEMBLY

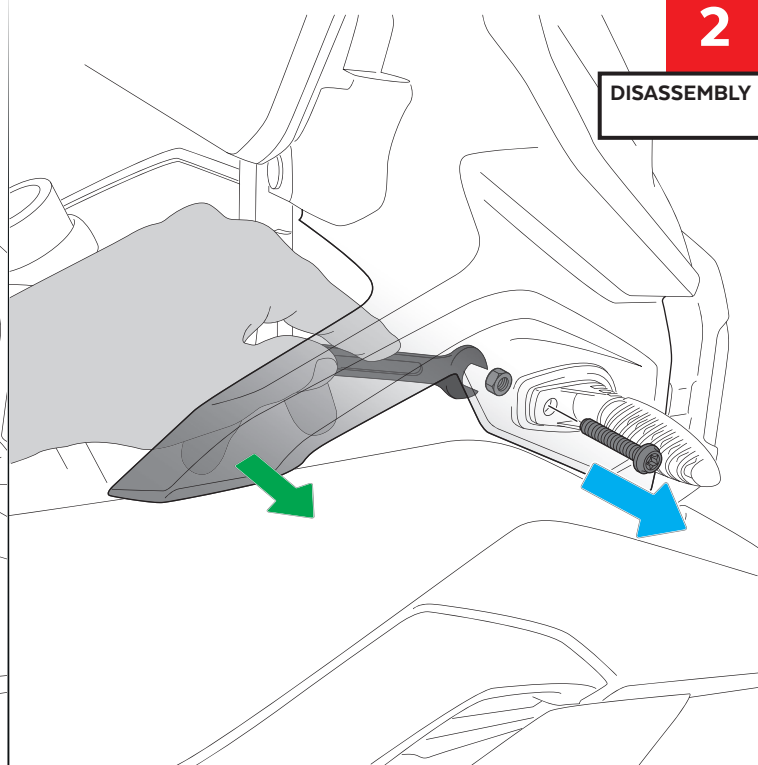

**3**

ASSEMBLY

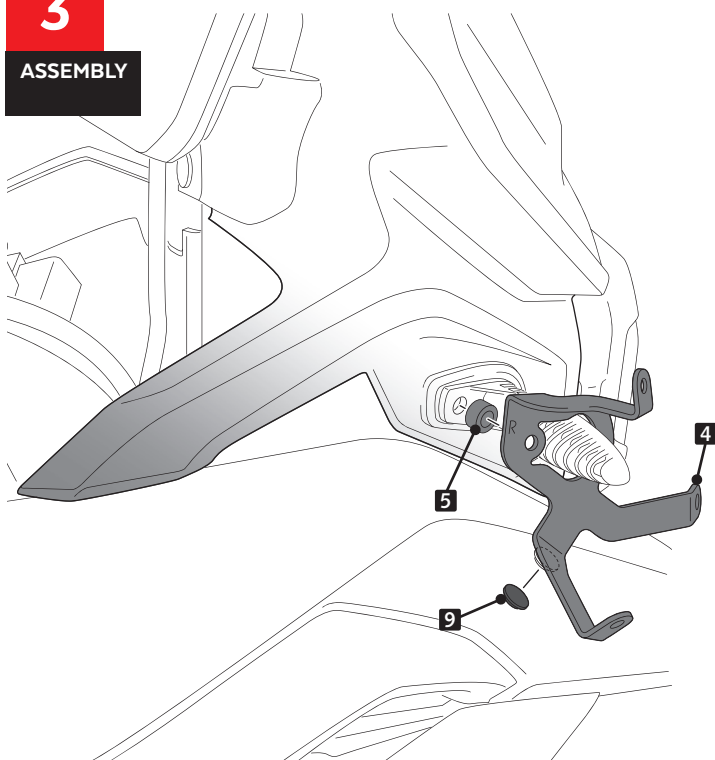

**4**

ASSEMBLY

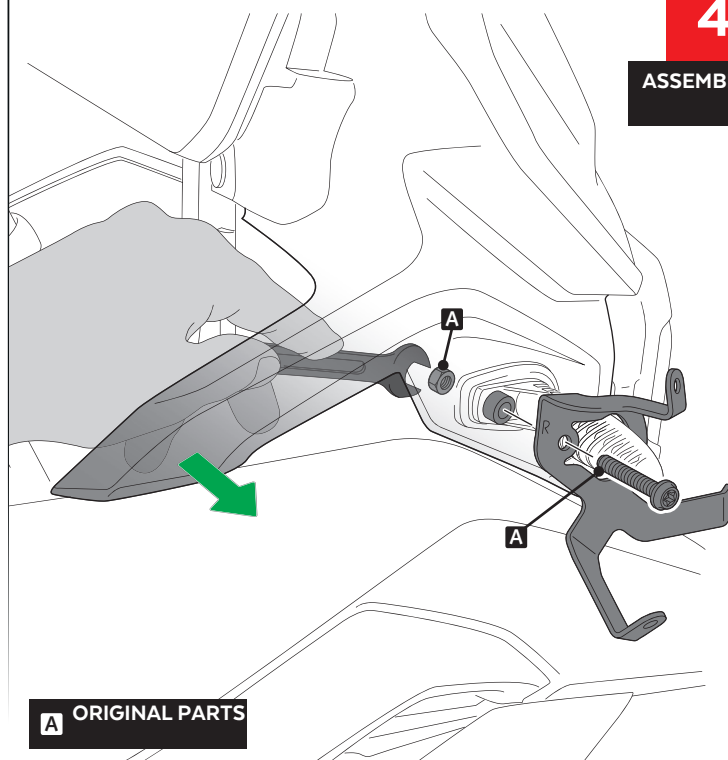

**A** ORIGINAL PARTS

# MOUNTING INSTRUCTIONS BMW R1250GS / F750GS / F850GS

**5**

ASSEMBLY

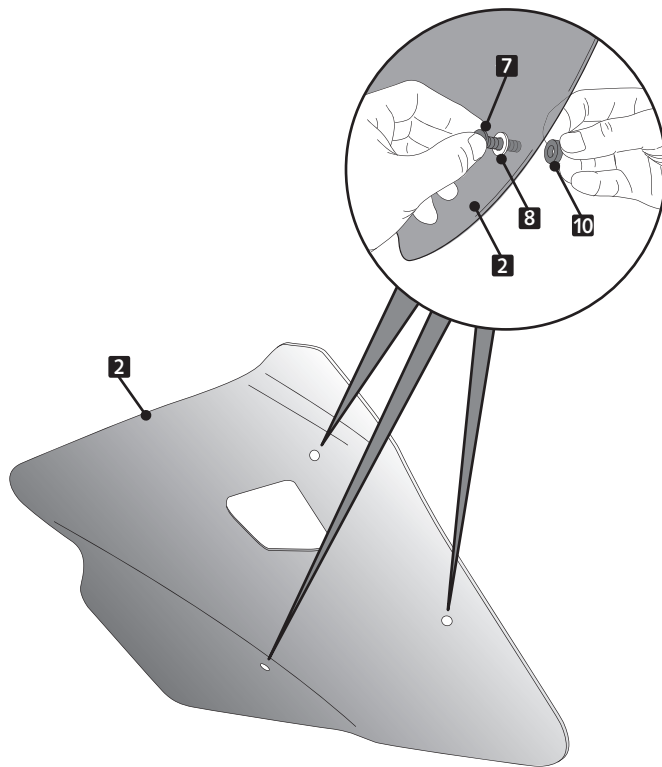
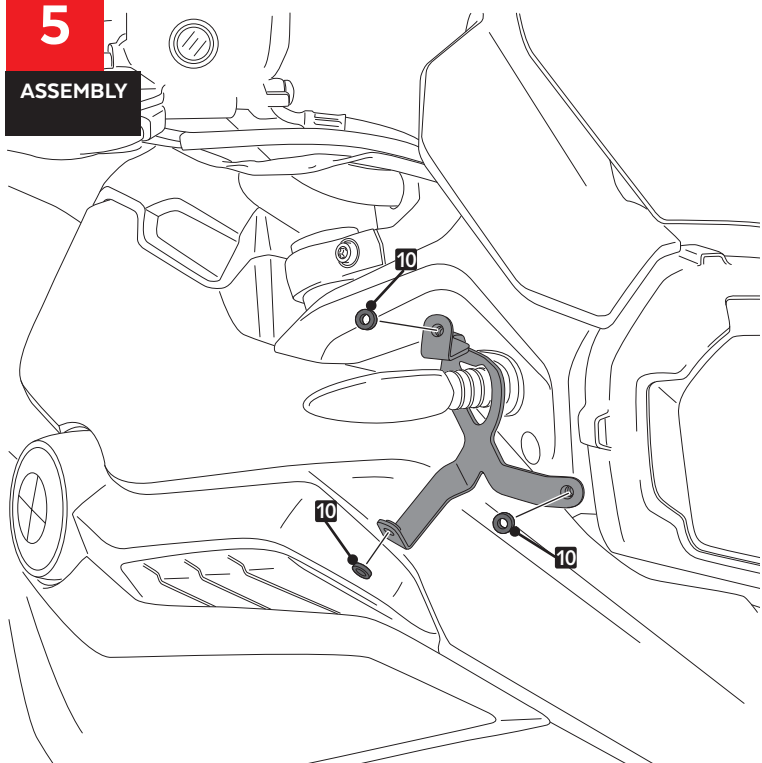

**6**

ASSEMBLY

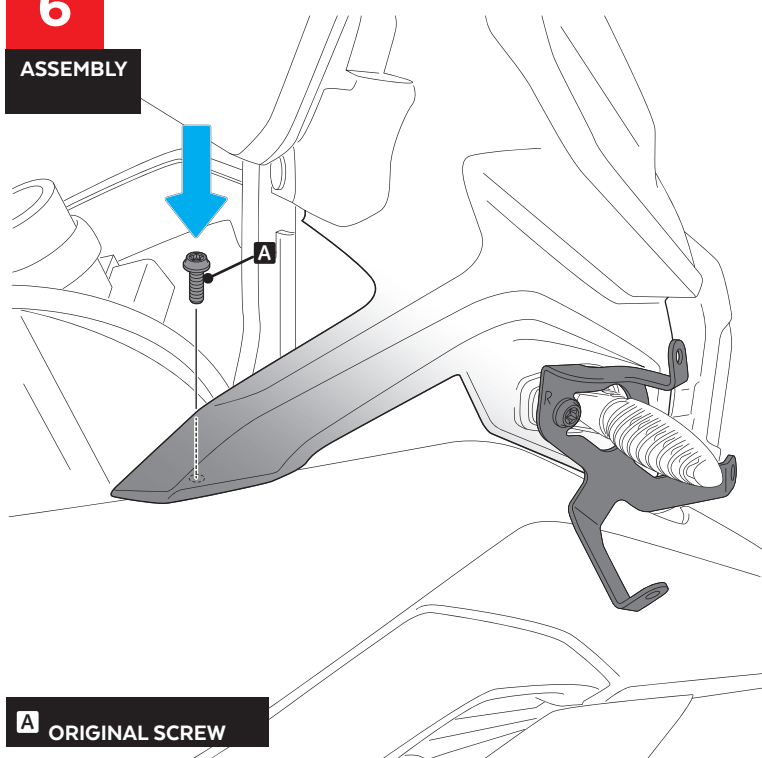

**A** ORIGINAL SCREW

**7**

ASSEMBLY

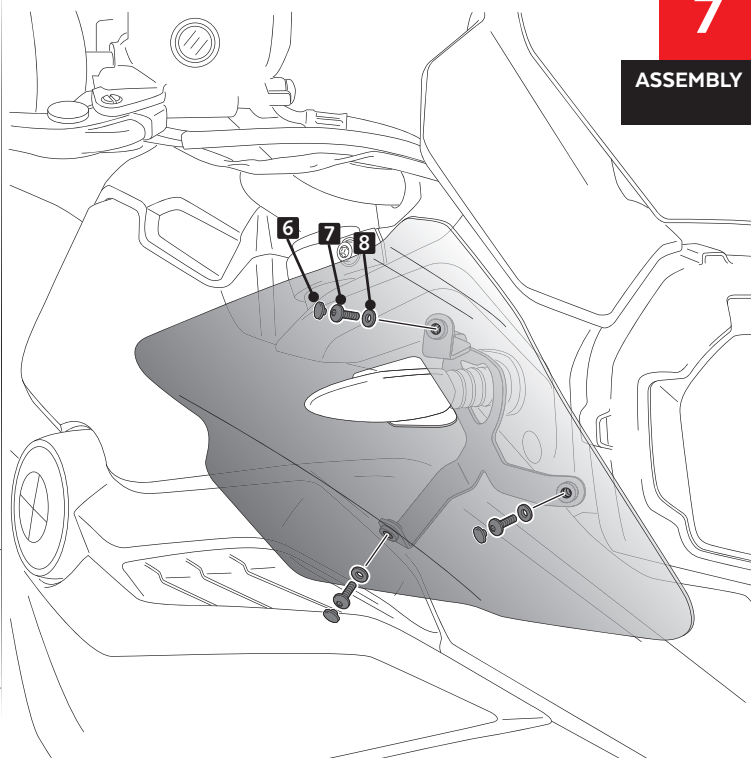

## MOUNTING INSTRUCTIONS BMW R1200GS LC '13-

The right side assembly is shown as an example, so the same steps can be performed for the left side assembly.

**1**

DISASSEMBLY

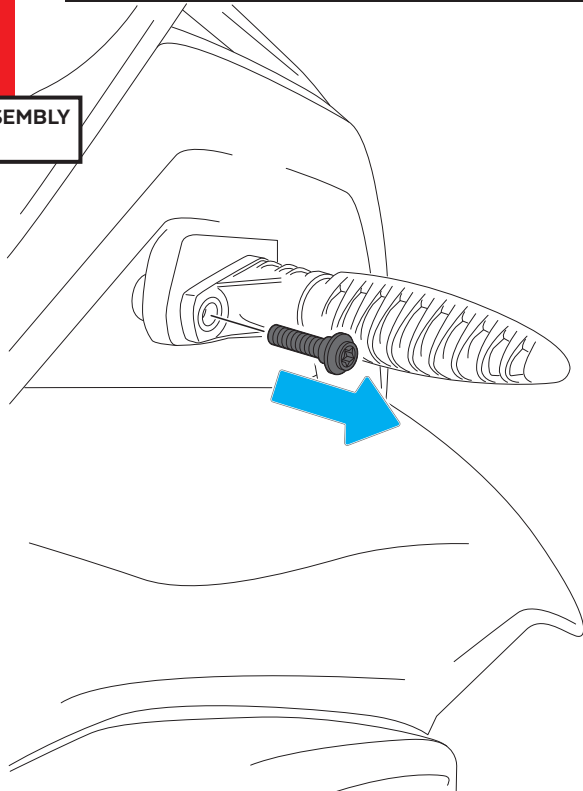

**2**

DISASSEMBLY

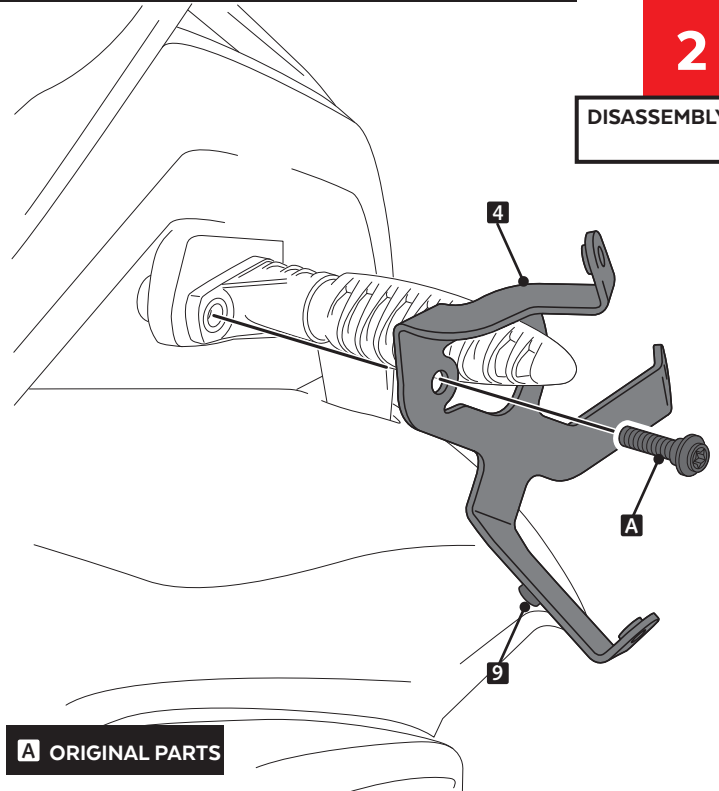

**A** ORIGINAL PARTS

**3**

ASSEMBLY

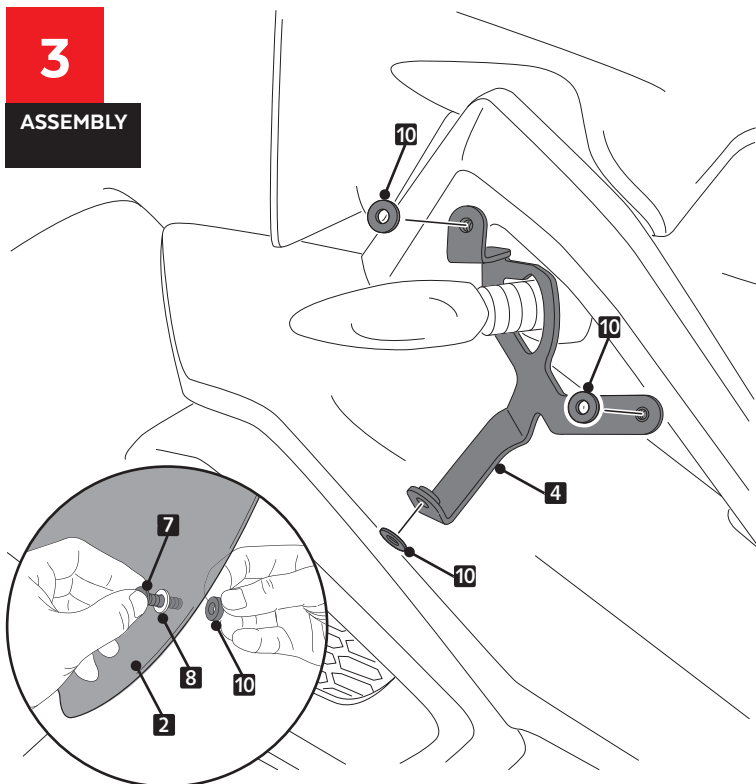

**4**

ASSEMBLY

