

MOUNTING INSTRUCTIONS

EXTENDA FENDA
UNIVERSAL

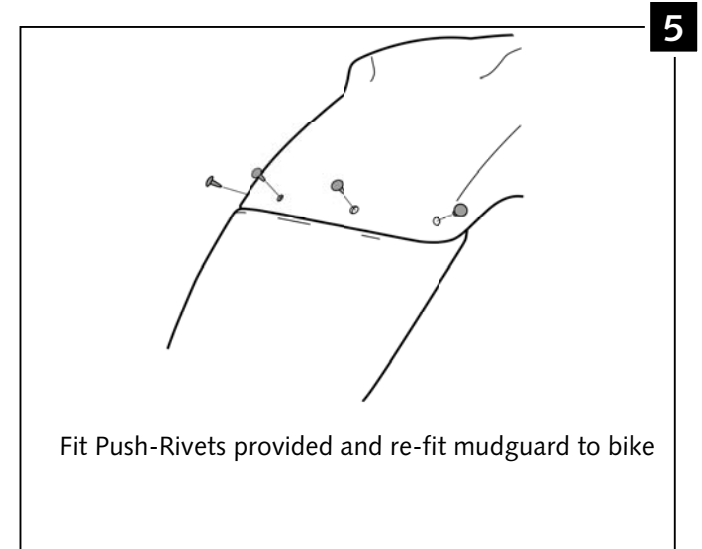
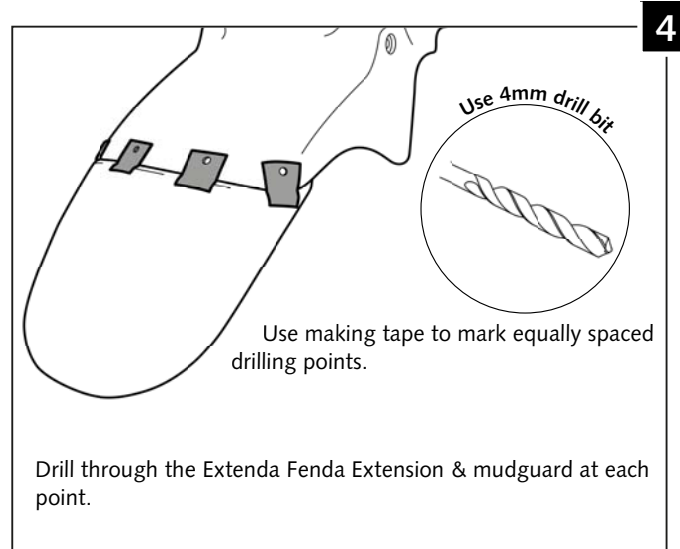
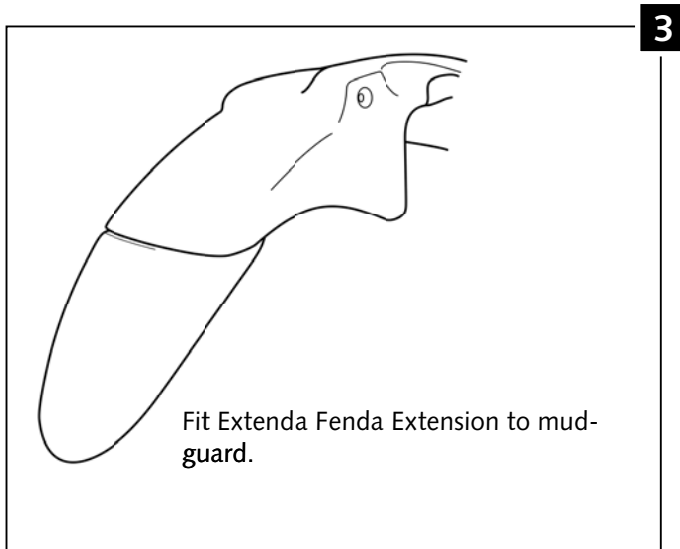
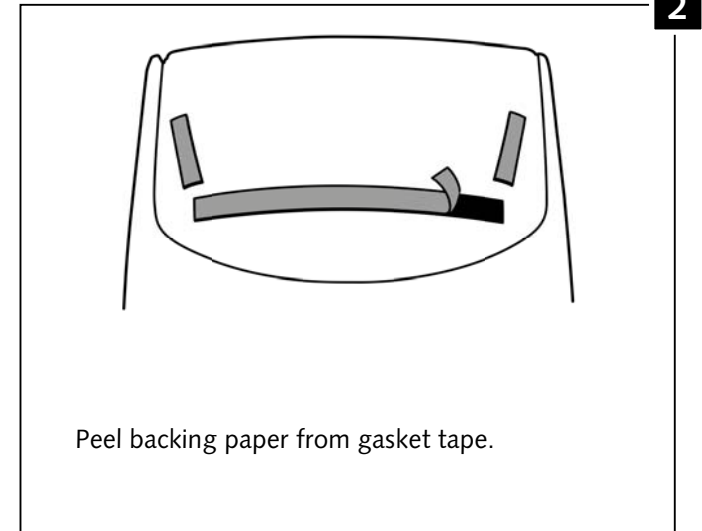
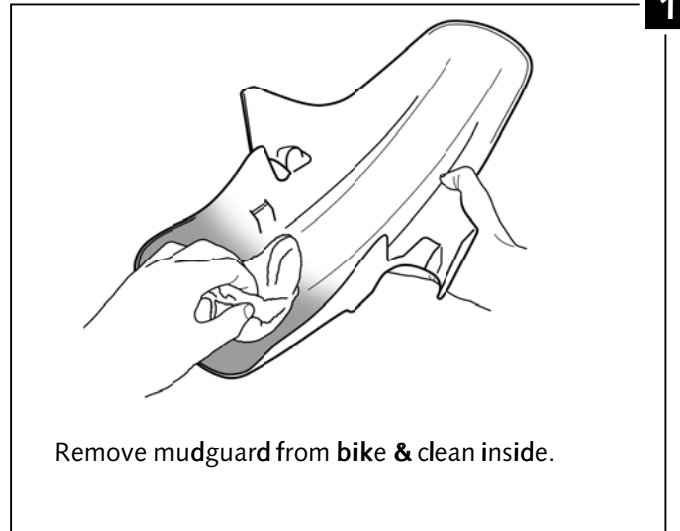

MOUNTING INSTRUCTIONS

XTENDA FENDA
REF.9203,9825

STICK FIT EXTENDA FENDA
(For Extenda Fendas Without Mounting Tape)

The product can be fitted with the guard on or off the bike. (We recommend that the guard should be removed from the bike when possible.) Thoroughly wash and degrease the inside of the guard using the alcohol wipe supplied. Check fit of the Extenda Fenda on the guard and align at your own leisure. Rough up both touching surfaces with sandpaper. Apply high bond adhesive * in concentric circular patterns on the Extenda Fenda mounting face. Offer the Extenda up to the guard and position as correctly as possible. When you are happy that the Extenda Fenda is correctly positioned, press all around the joint face with finger pressure. It is advisable to apply spring clamps or similar to the extreme/outer ends to ensure good contact.

**FULL ADHESIVE STRENGTH TAKES SEVERAL HOURS.
DO NOT RIDE OFF IMMEDIATELY!!!
BEFORE RIDING.**

*we recommend a silane modified silicone adhesive – single pack