

HONDA CB1000R '18-

REF 9754N

CRASH PADS FOR

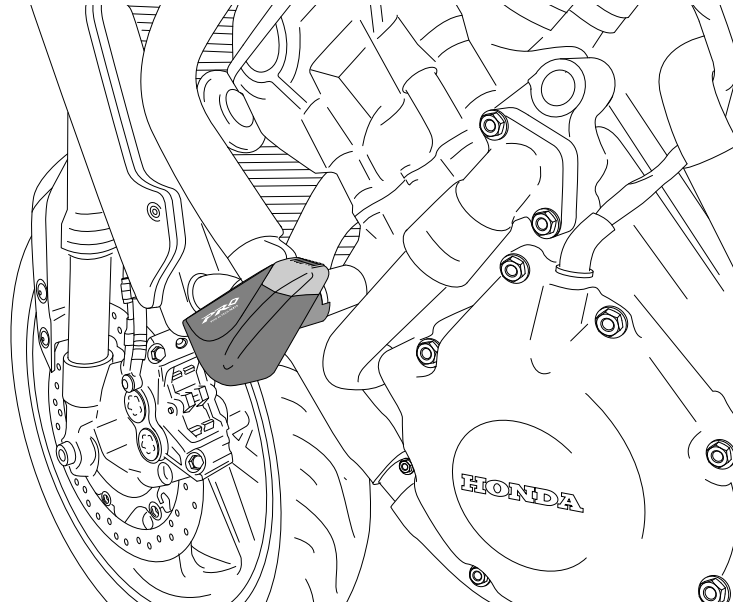

RATCHET



N° 14

ALLEN



N° 10

ID.	PART	DESCRIPTION	QTY.	REF.:
1		Covers set	2	TAPAPROPATIN---
2		M12/125x110 DIN912 screw	1	TORNIAD912--385
3		M12/125x130 DIN912 screw	1	M2TM12125130A9B
4		Ø20ext. Ø12int nut	2	ARANM12DIN433ZB
5		Nylon protector	2	CONPUNTPROTPATI
6		Aluminium metal spacer (right)	1	PLATI367-0-0367
7		Aluminium metal spacer (left)	1	PLATI368-0-0368
8		Metal spacer	2	CASQUI85-1-1385
9		M6x20 DIN912 screw	2	M2TM06100020A8B

HONDA CB1000R '18-

MOUNTING INSTRUCTIONS

RIGHT SIDE

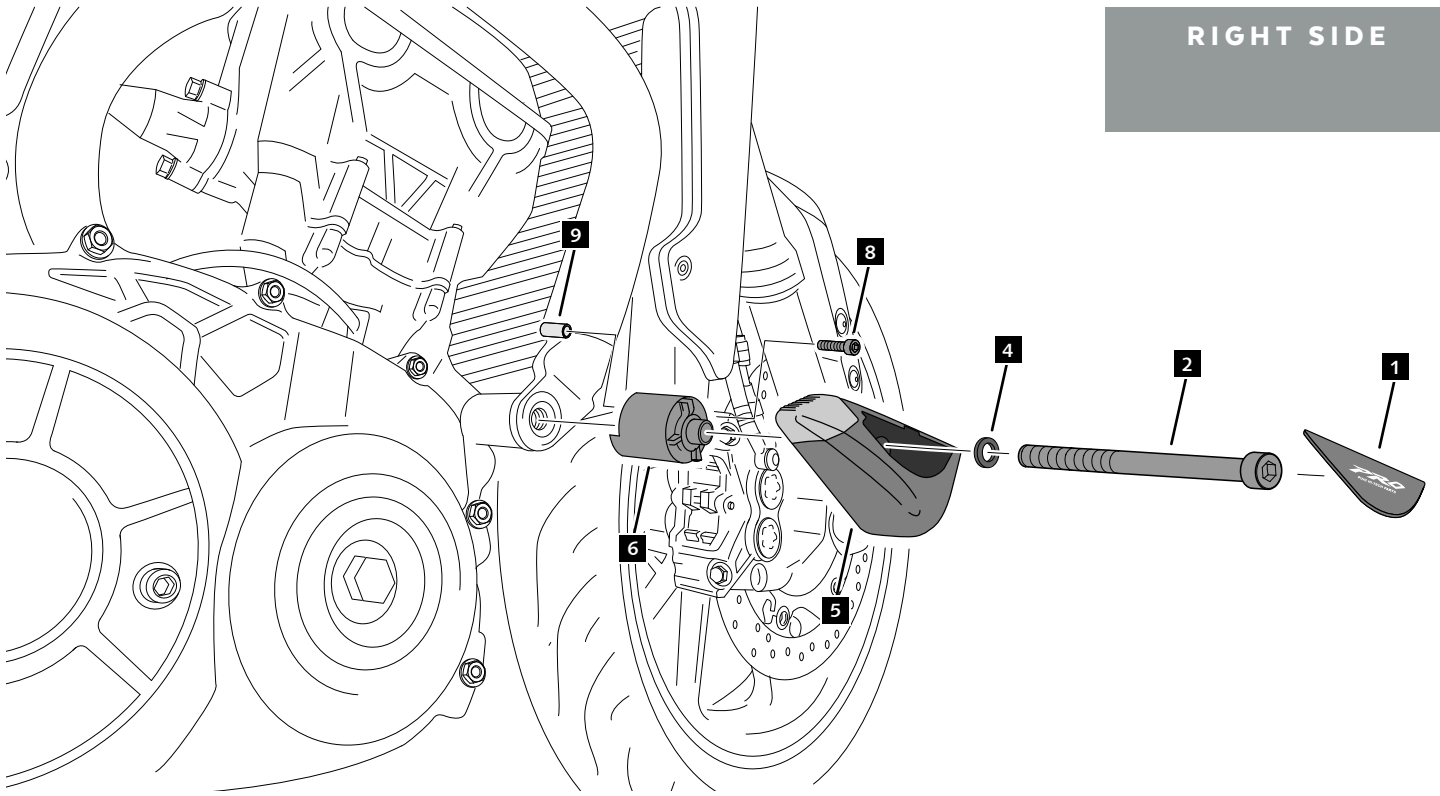

LEFT SIDE

