

DUCATI PANIGALE V2 '20- / V4 '18-'19 / V4 25 ANNIVERSARIO 916 '20-
/ V4 S '18-'19 / V4 CORSE '19-'20 / V4 SPECIALE '18-'19

REF 9690

R- RACER SCREEN



1 Person



45 min



MEDIUM



TORX T° 7



ALLEN N° 3
N° 4

ID	PIEZA/PART	DESCRIPTION	QTY	REF
1		Racing screen	1	9690F/H/R/W/NM3

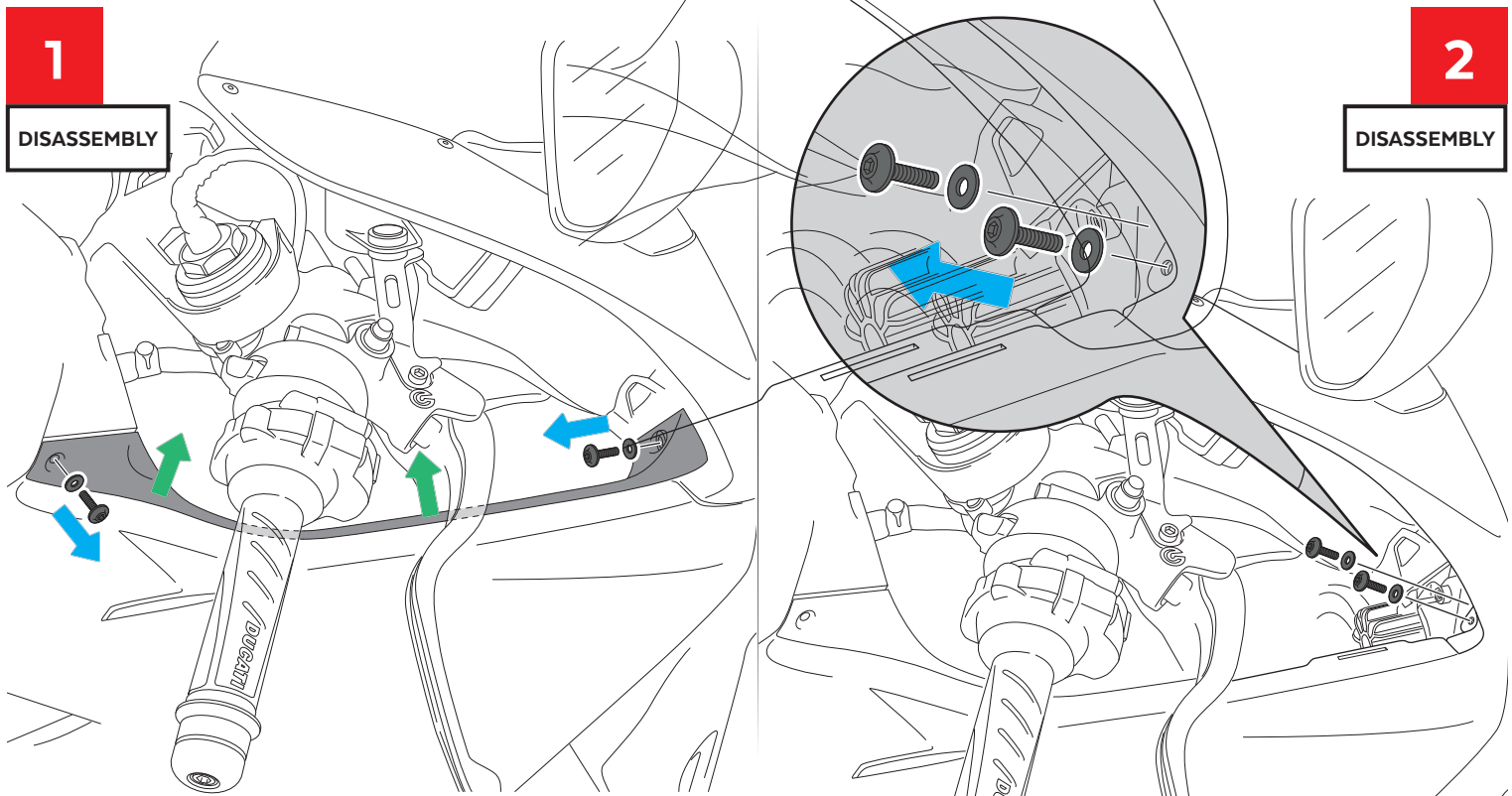

1

DISASSEMBLY

2

DISASSEMBLY

DUCATI PANIGALE V2 '20- / V4 '18-'19 / V4 25 ANNIVERSARIO 916 '20-
/ V4 S '18-'19 / V4 CORSE '19-'20 / V4 SPECIALE '18-'19

MOUNTING INSTRUCTIONS

3

DISASSEMBLY

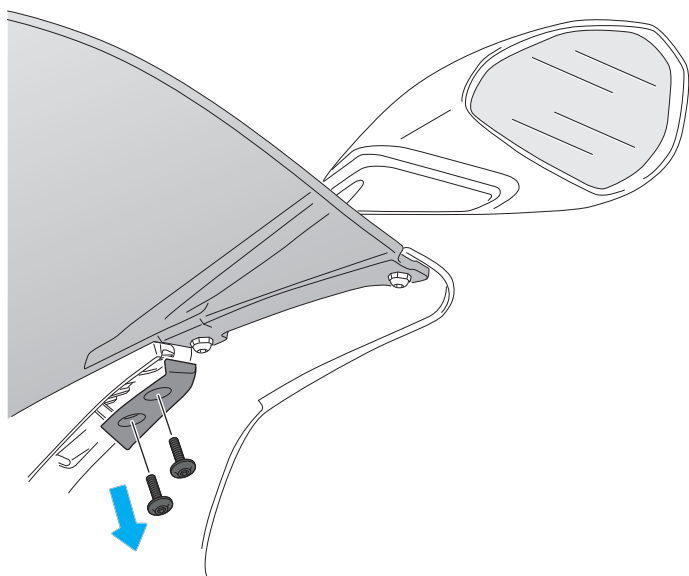

4

DISASSEMBLY

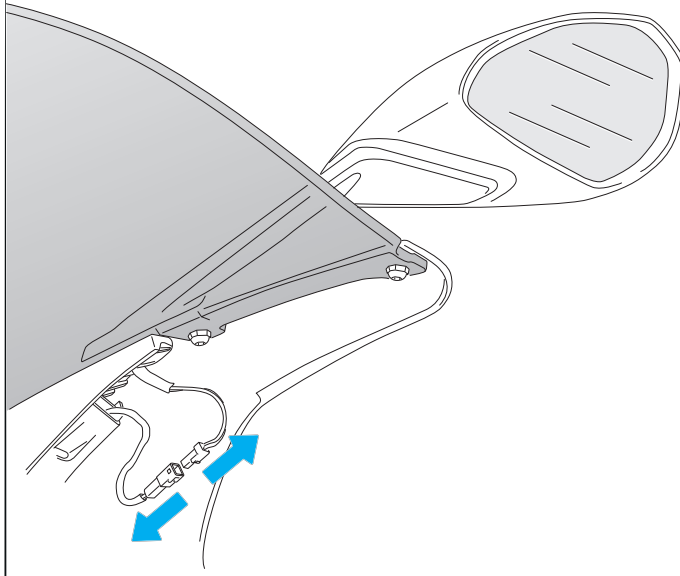

5

DISASSEMBLY

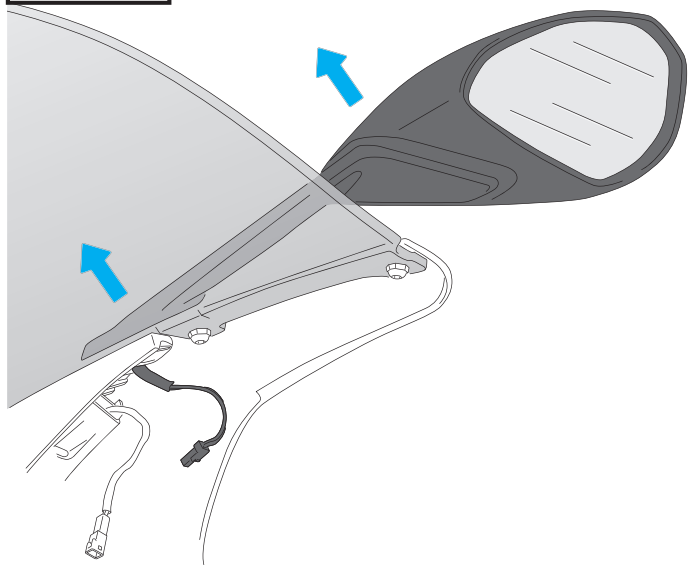

6

DISASSEMBLY

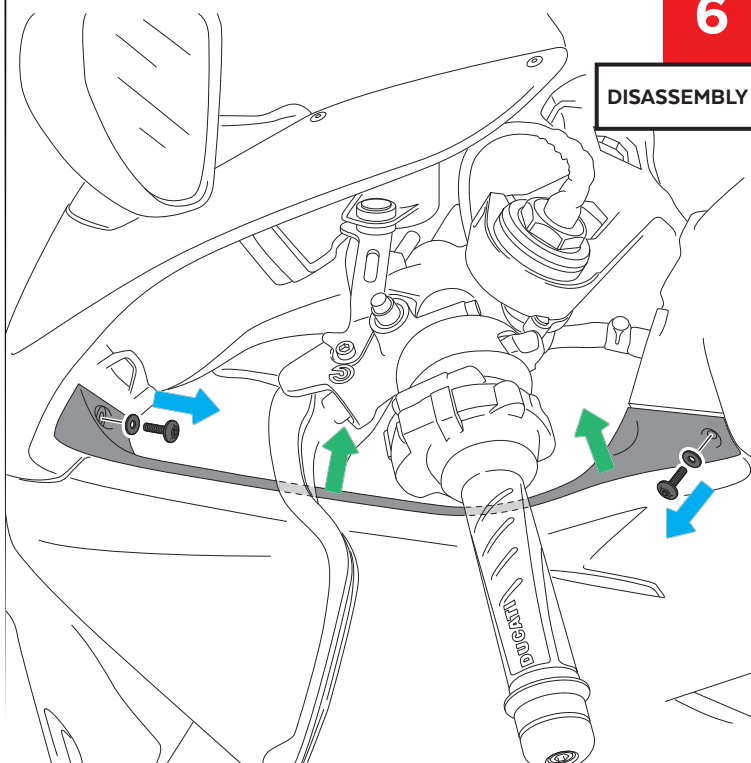

DUCATI PANIGALE V2 '20- / V4 '18-'19 / V4 25 ANNIVERSARIO 916 '20-
/ V4 S '18-'19 / V4 CORSE '19-'20 / V4 SPECIALE '18-'19

MOUNTING INSTRUCTIONS

7

DISASSEMBLY

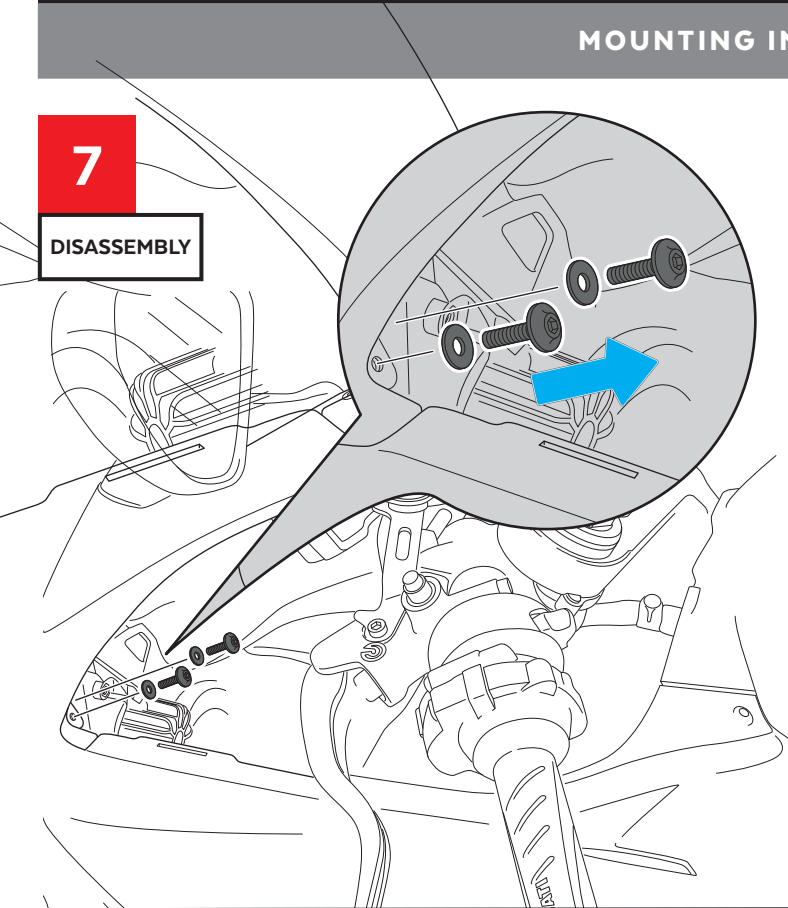

8

DISASSEMBLY

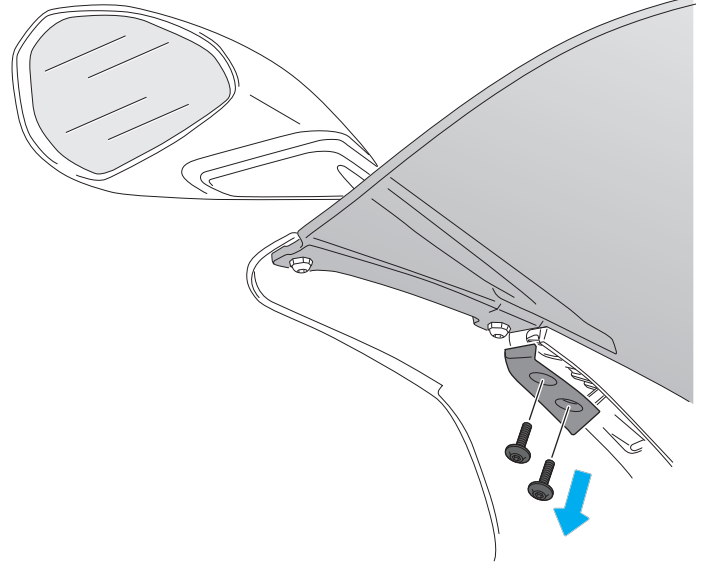

9

DISASSEMBLY

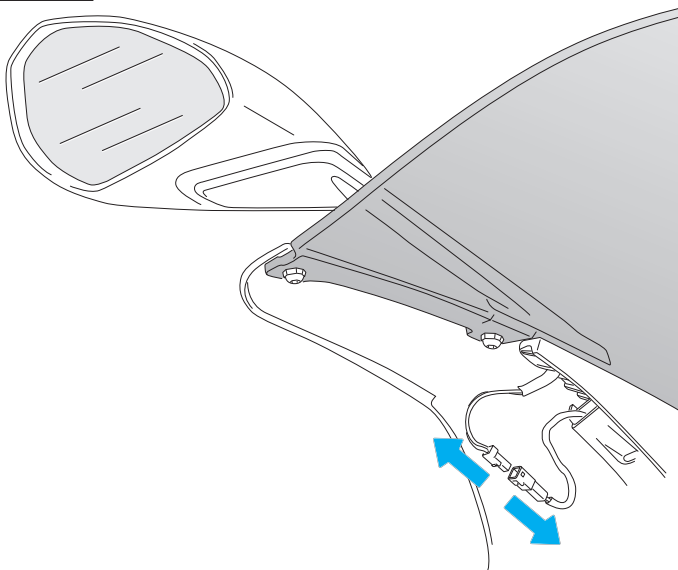

10

DISASSEMBLY

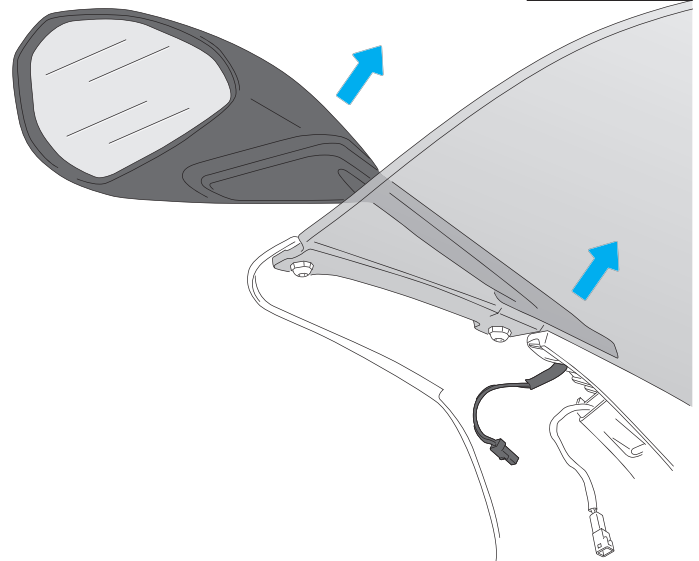

DUCATI PANIGALE V2 '20- / V4 '18-'19 / V4 25 ANNIVERSARIO 916 '20-
/ V4 S '18-'19 / V4 CORSE '19-'20 / V4 SPECIALE '18-'19

MOUNTING INSTRUCTIONS

11

DISASSEMBLY

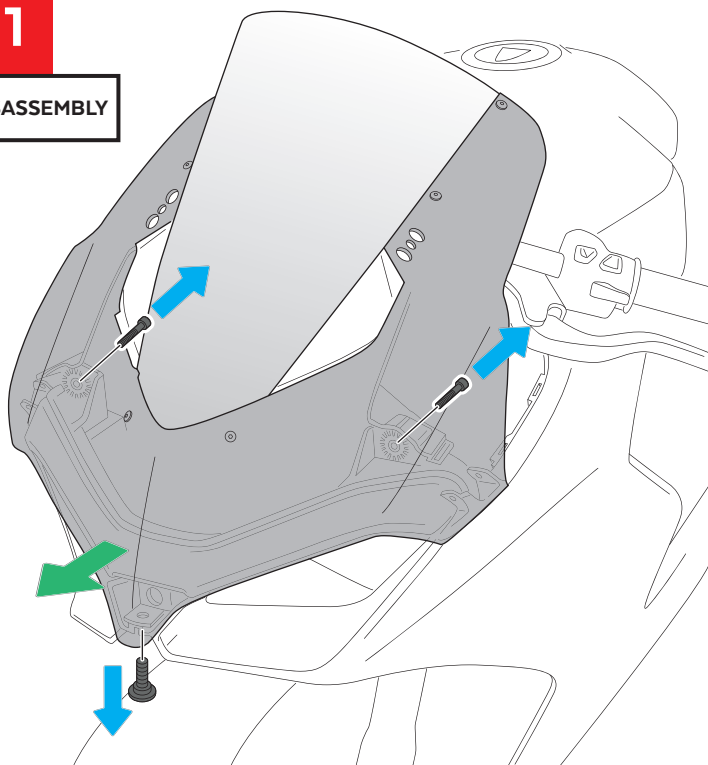

12

DISASSEMBLY

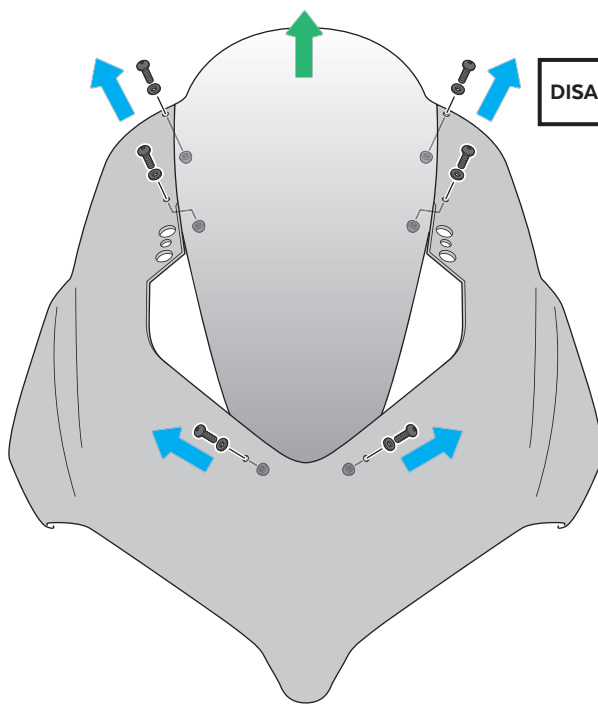

13

ASSEMBLY

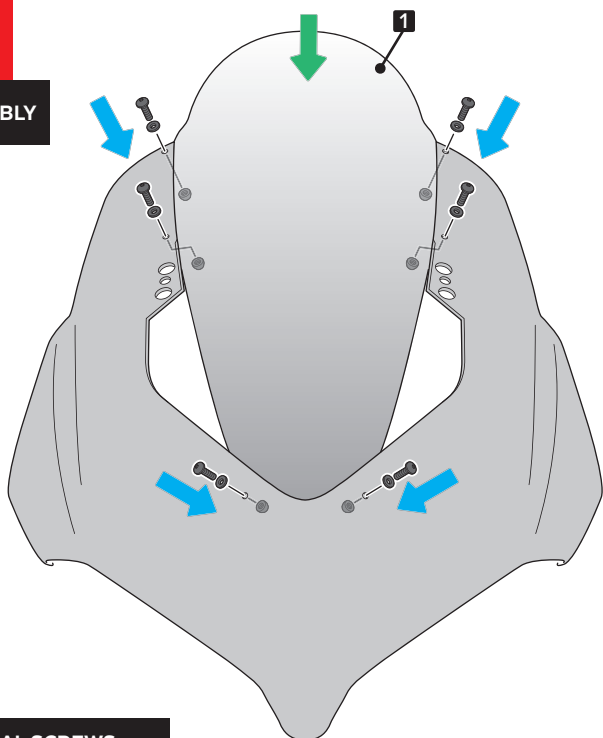

ORIGINAL SCREWS

IN ORDER TO FINISH THE ASSEMBLY OF THE FAIRING,
PLACE THE SCREWS BACK ON ACCORDING TO DRAWINGS 11
TO 1.