

MOUNTING INSTRUCTIONS

FRONT TURN SIGNAL SUPPORT

YAMAHA MT09 '17-

Ref.: 9465N

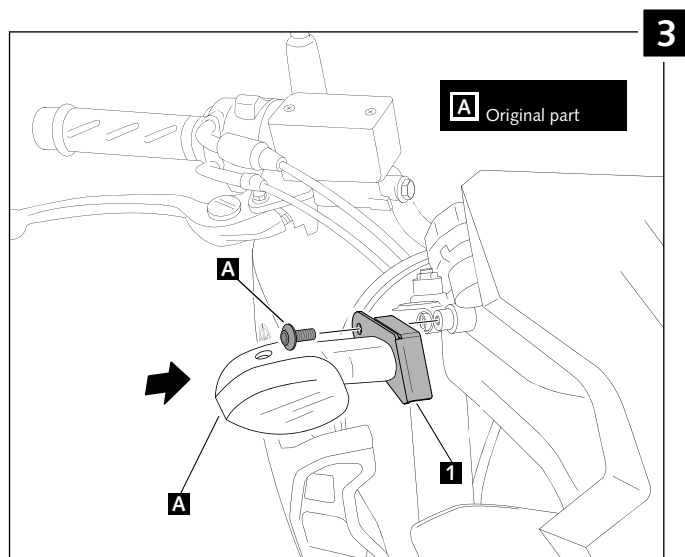
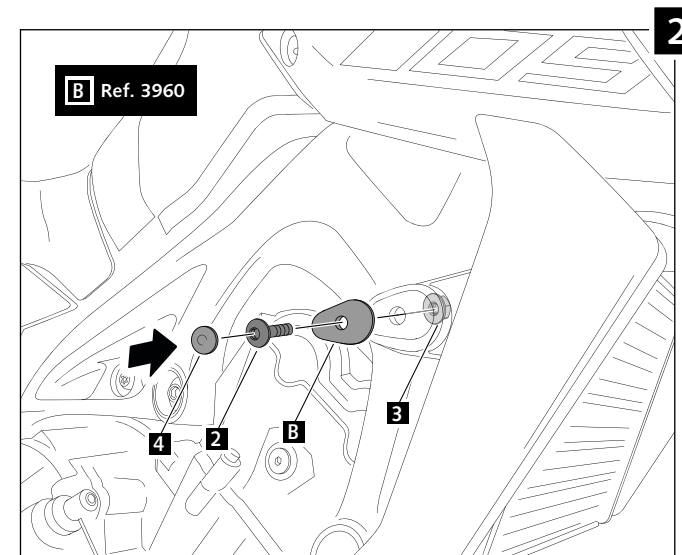
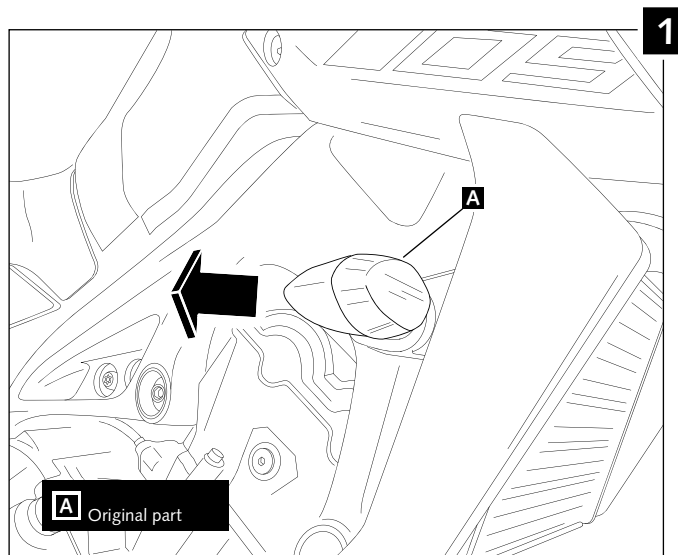

MOUNTING INSTRUCTIONS

If you are not mechanical, please contact a specialist workshop. MOTOPLASTIC-PUIG no responsibility for damage caused by incorrect assembly of the product.

ID.	DESCRIPTION	REF.	QTY.
1	Turn signal support	SOPINT14-0-0014	2
2	M6x15 DIN1001 screw (black)	TORNI-I7380-403	2
3	M6 DIN6923 nut	TUERCAEM6G-0213	2
4	M6 DIN1001 screw cap	TAPON-----86	2