

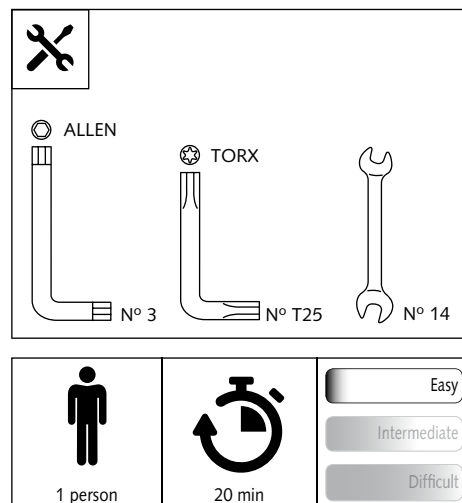

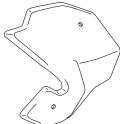

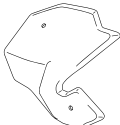



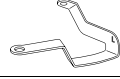

HANDLEBAR DEFLECTOR FOR BMW R1200GS LC / R1200GS LC ADVENTURE / R1250GS / R1250GS ADVENTURE / S1000XR

Ref.: 9397

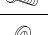
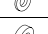

ID	PART	DESCRIPTION	QTY	REF.
1		Right deflector	1	9397F/H/WM3
2		Left deflector	1	9397F/H/WM3
3		Right metal support (R)	1	SOPOR-2P-5-9397
4		Left metal support (L)	1	SOPOR-2P-5-9397
5		Ø12xØ6x9 Silemblock	2	AROPASACABLES-1
6		Ø12xØ6,8x6,5 bush with flange	2	CASQUI-1A---750
7		M5x30 Ø11 ISO 7380 Allen screw	2	TORNI-I7380-767
8		Ø13xØ6,5x8,5 bush	2	CASQUI-----0298
9		M5x11Ø11 ISO 7380 Allen screw	2	TORNI-AI----520
10		M5x1 Nylon washer	2	ARNV0000000245
11		4,5xØ11Øx2 Rubber washer	2	ARAND-EPDM--722
12		M5 ISO 7380 Allen screw cap	4	TAPON_____85

HANDLEBAR DEFLECTOR FOR EFLEKTOR FÜR
BMW R1200GS LC / R1200GS LC ADVENTURE
/ R1250GS / R1250GS ADVENTURE / S1000XR

MOUNTING INSTRUCTIONS

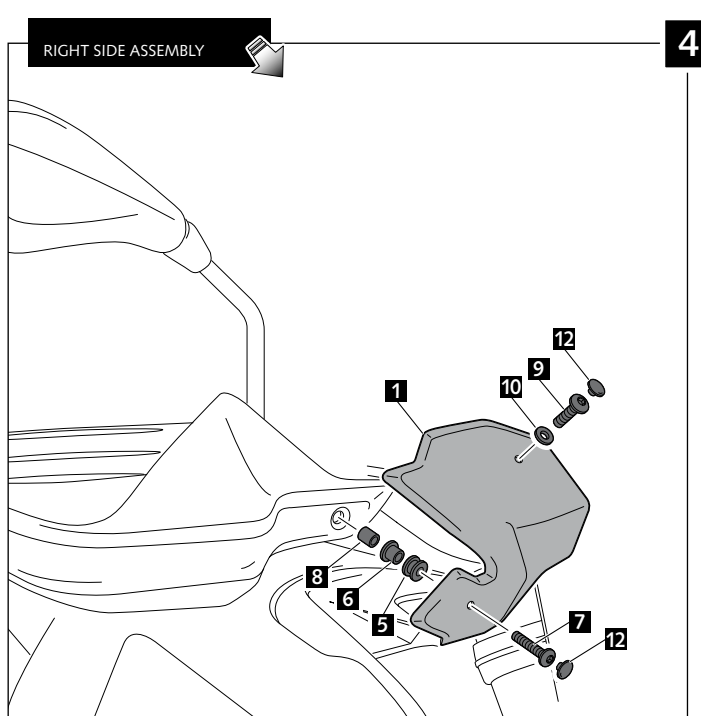
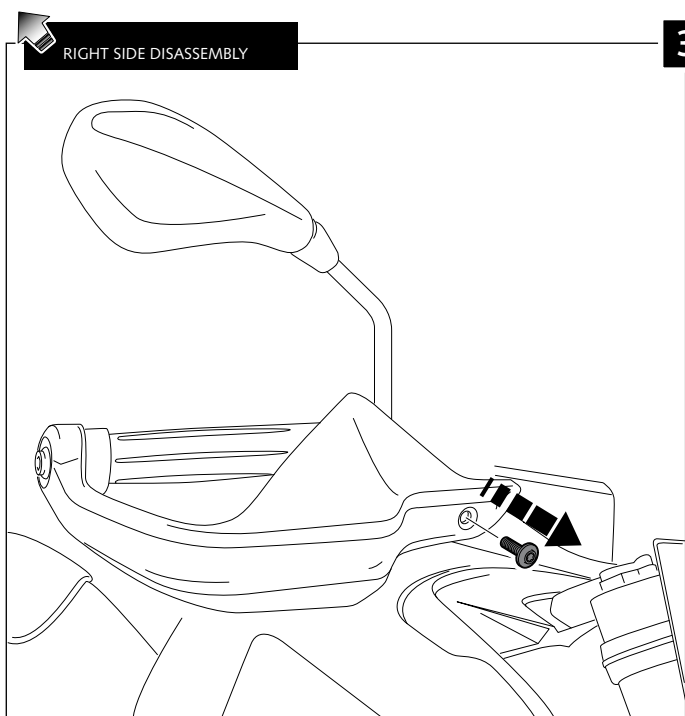
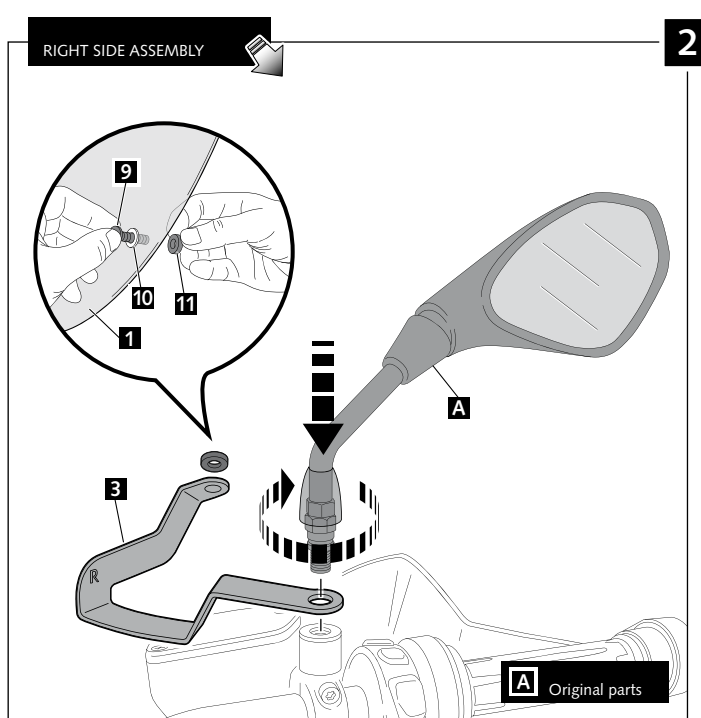
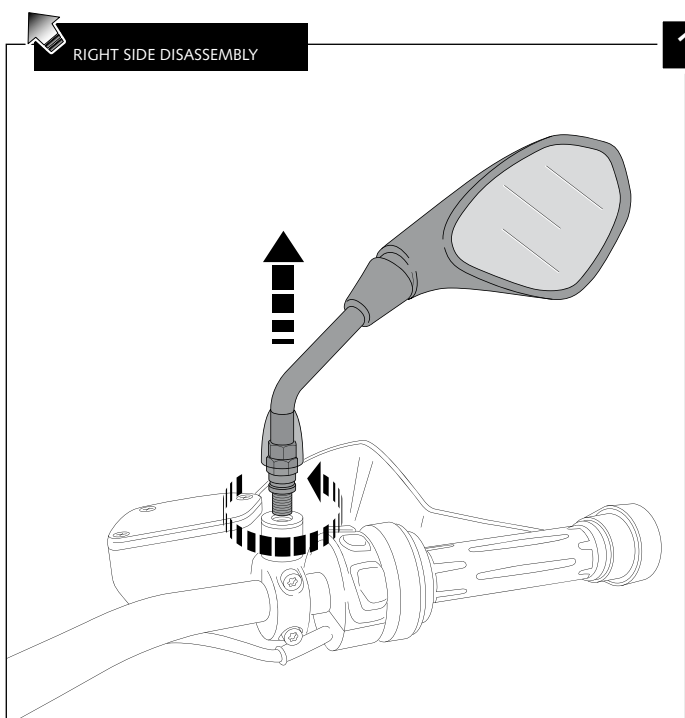

HANDLEBAR DEFLECTOR FOR
**BMW R1200GS LC / R1200GS LC ADVENTURE
 / R1250GS / R1250GS ADVENTURE / S1000XR**

MOUNTING INSTRUCTIONS

