

RADIATOR SIDE COVERS FOR

## YAMAHA MT-09 '17-

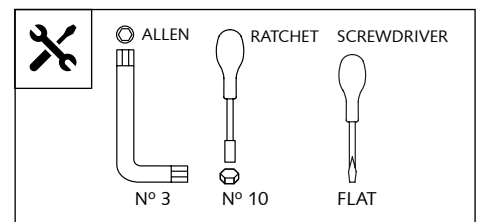

**Ref.: 9378**



ID.	PART	DESCRIPTION	QTY.	REF.:
1		Left radiator side cover	1	9378J/CM3
2		Right radiator side cover	1	9378J/CM3
3		Left aluminum support 2mm	1	SOPOR-6P-11-9378
4		Right aluminum support 2mm	1	SOPOR-6P-11-9378
5		Left iron support 2mm original turn signal (optional homologated)	1	SOPOR-6P-11-9378
6		Right iron support 2mm original turn signal (optional homologated)	1	SOPOR-6P-11-9378
7		Subjection plates for original turn signal 3mm	2	SOPOR-6P-11-9378
8		Left acrylic turn signal (Supplied already mounted)	1	MET-----9378HM3
9		Right acrylic turn signal (Supplied already mounted)	1	MET-----9378HM3
10		Left turn signal (Supplied already mounted)	1	6475N
11		Right turn signal (Supplied already mounted)	1	6475N
12		Yamaha turn signals adapter (Supplied already mounted on Puig item)	1	4863N
13		M5x16 Ø11 ISO 7380 Allen Screw	6	TORNI-I7380-493
14		M5 silentblock	6	SILENTBTM5-046/1
15		M5x1 nylon washer	6	ARNV00000000245
16		M5 ISO 7380 Allen screw cap	6	TAPON-----85
17		Ø12,5x4 silicon adhesive spacer (Supplied already mounted)	2	TOPE-PA12,7X3,5
18		M5x16 Ø11 ISO 7380 Allen Screw	2	TORNI-AI----520
19		Stickers set	1	ADHESI-----254

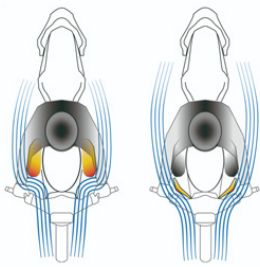

## PROTECTION

Protects the rider from inclement weather

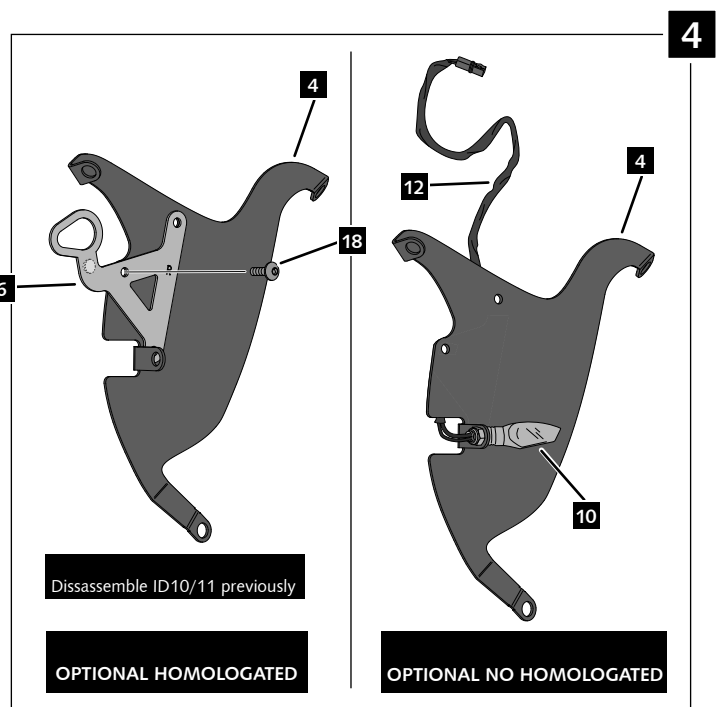
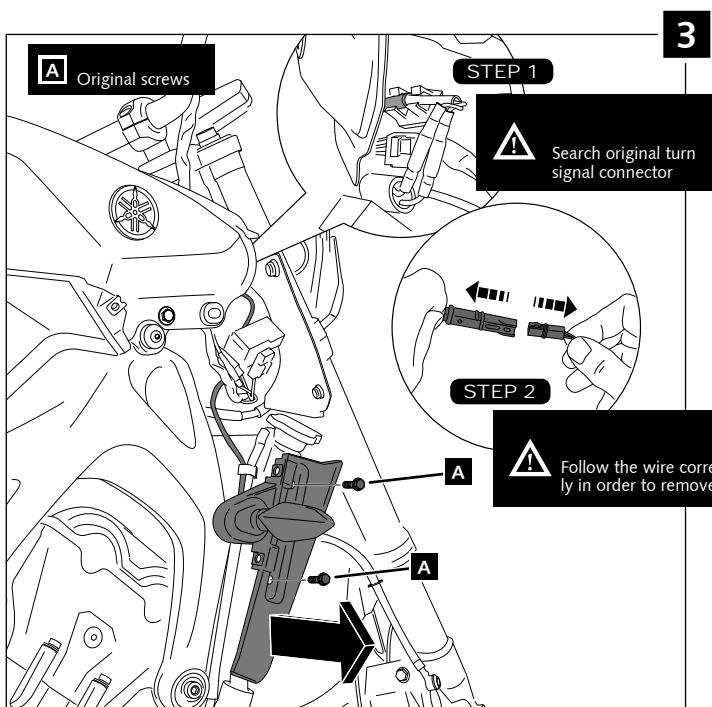
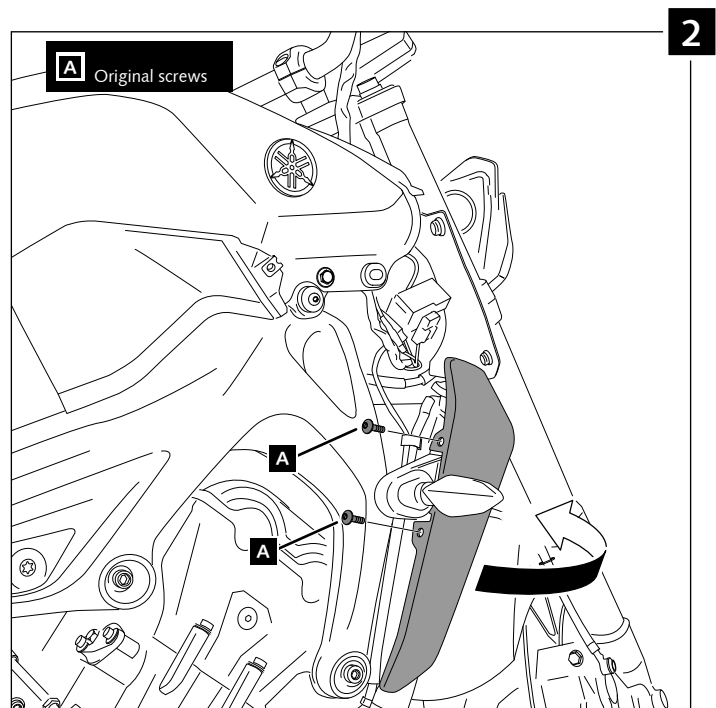
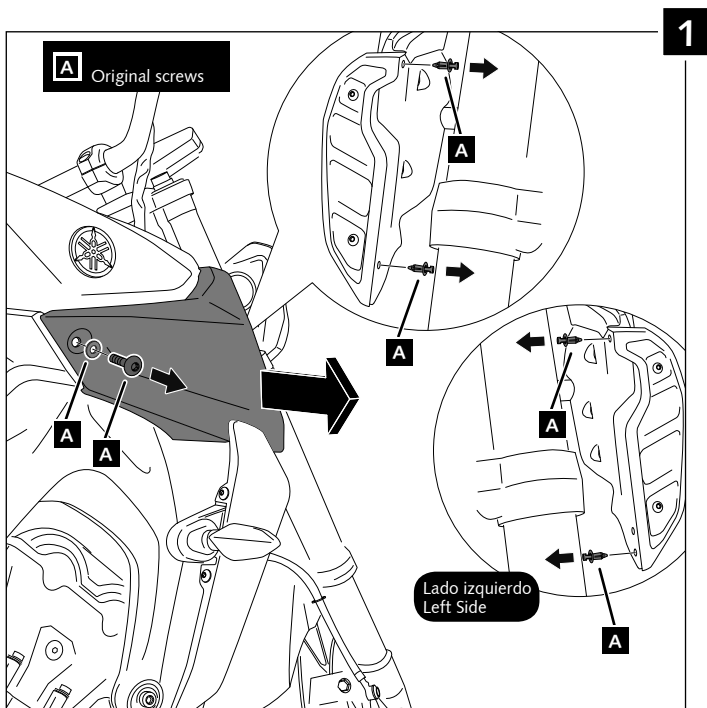

## ASSEMBLY **NO HOMOLOGATED**

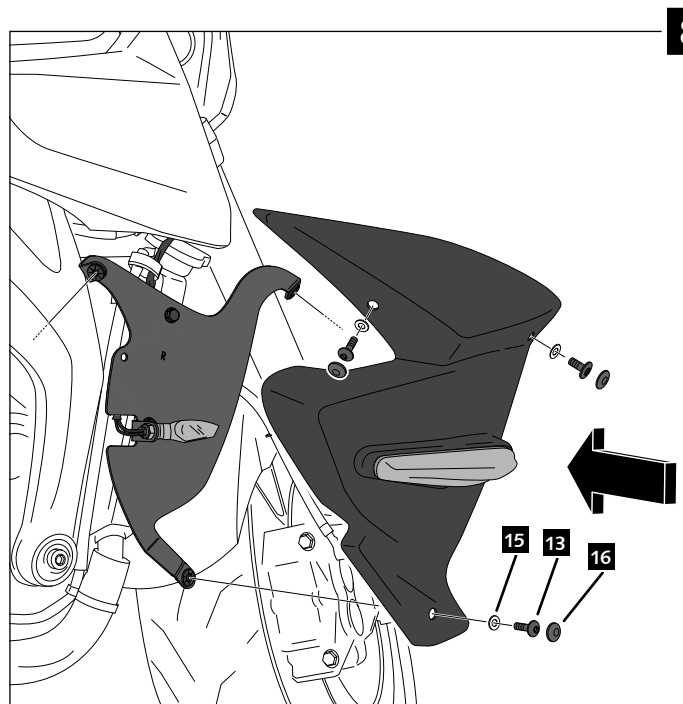
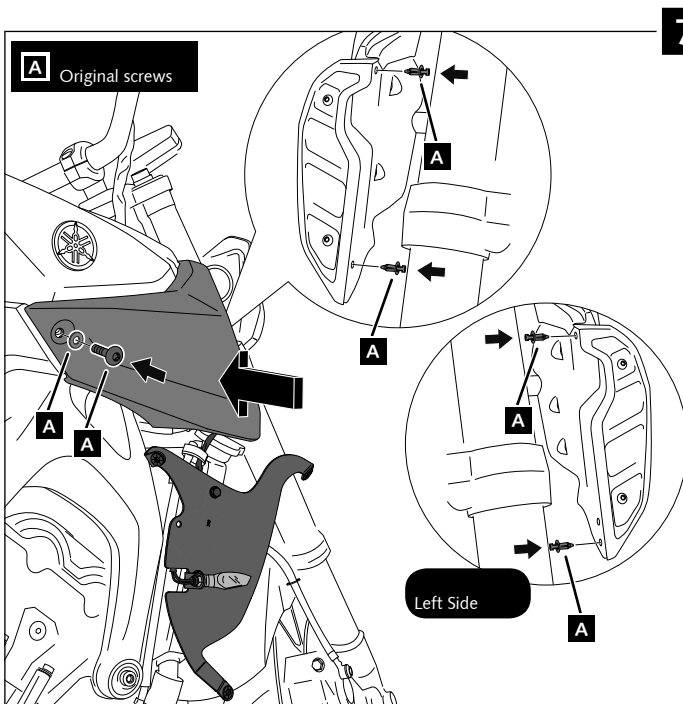
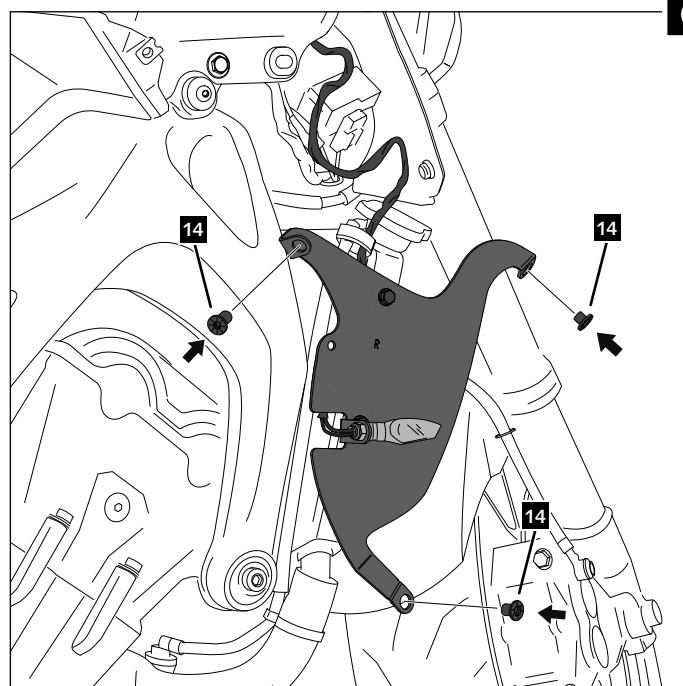
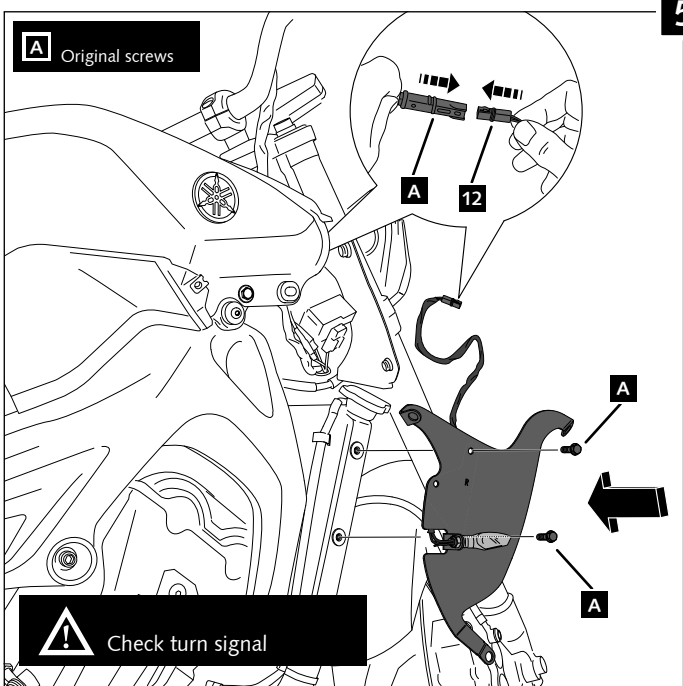
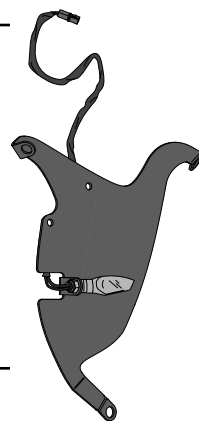

## ASSEMBLY **HOMOLOGATED**

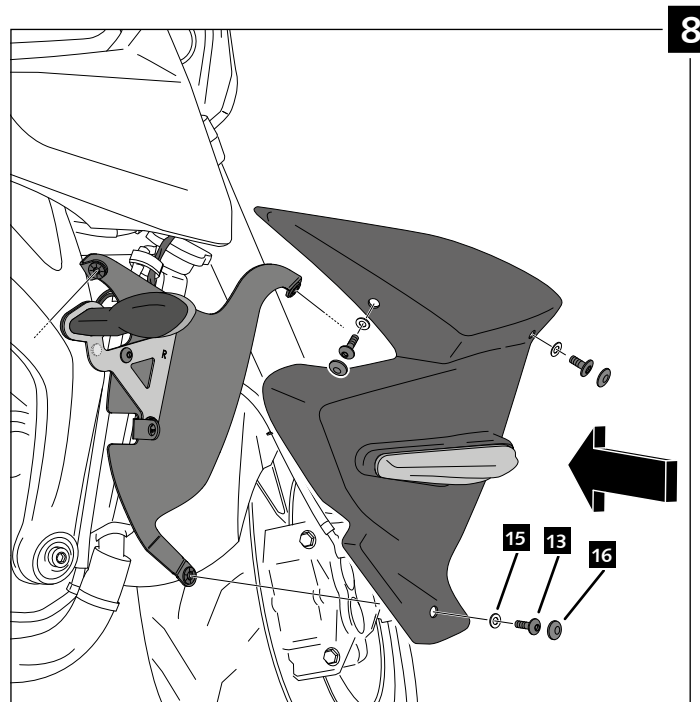
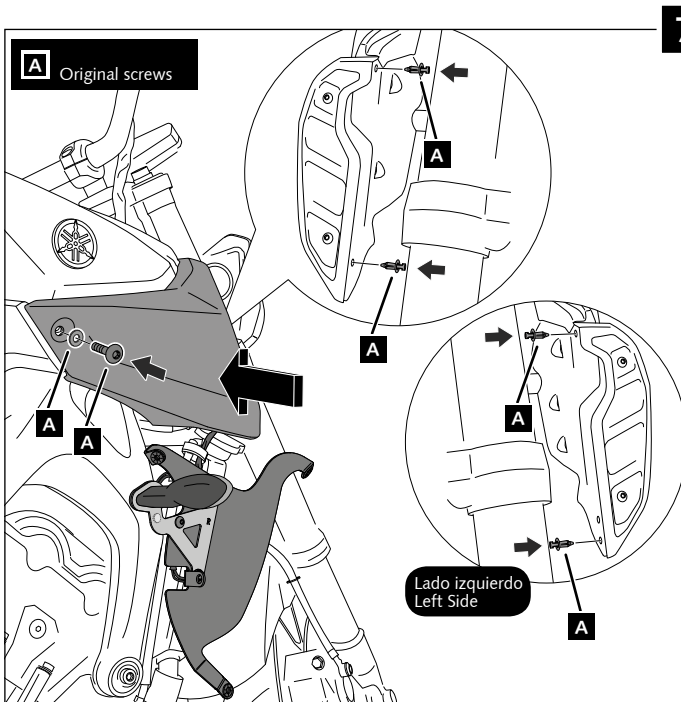
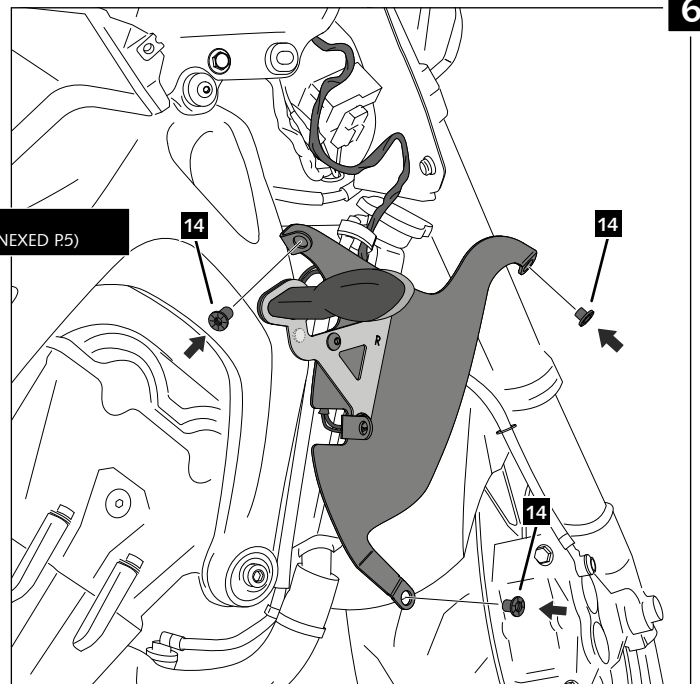
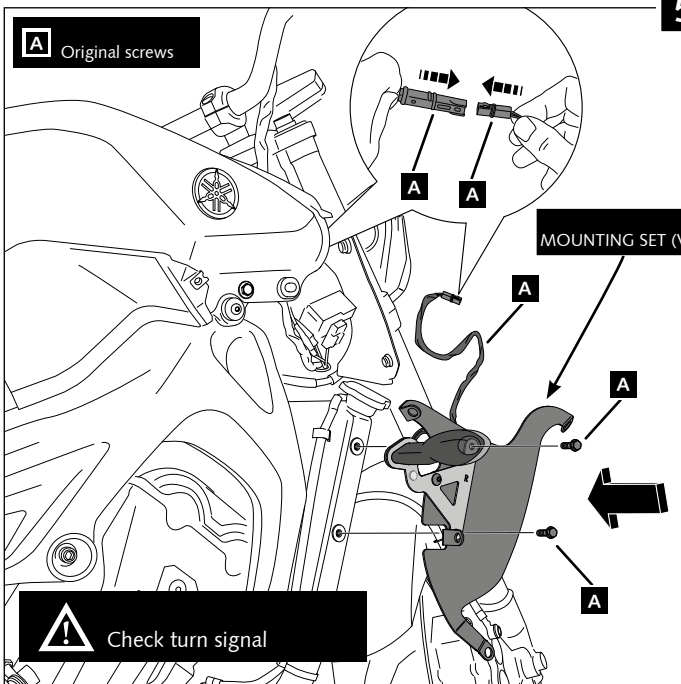
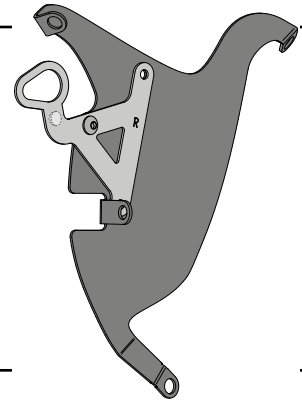

## ANNEXED OEM TURN SIGNALS

### - MOUNTING INSTRUCTIONS -

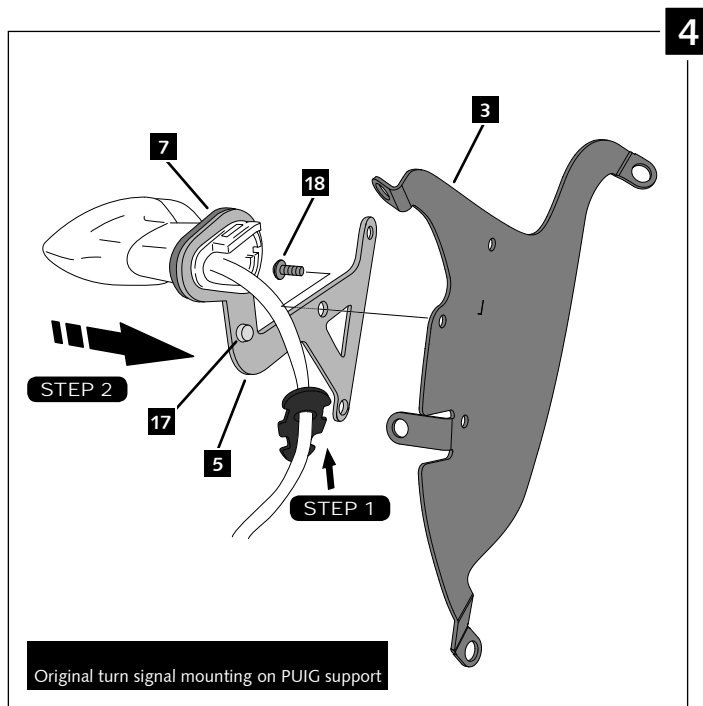
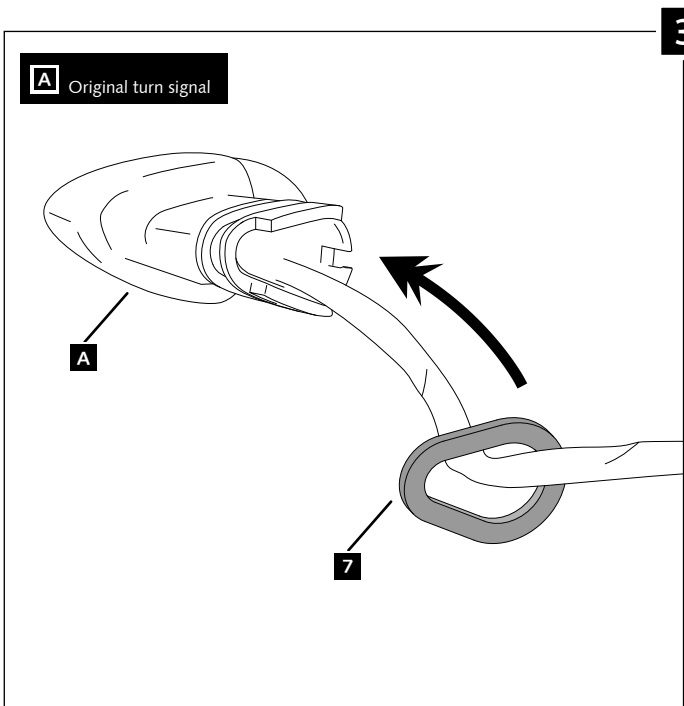
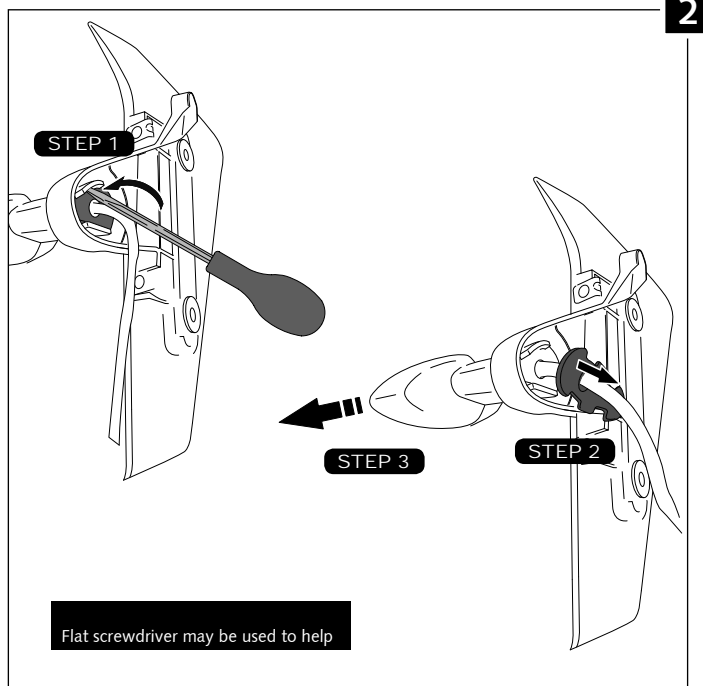
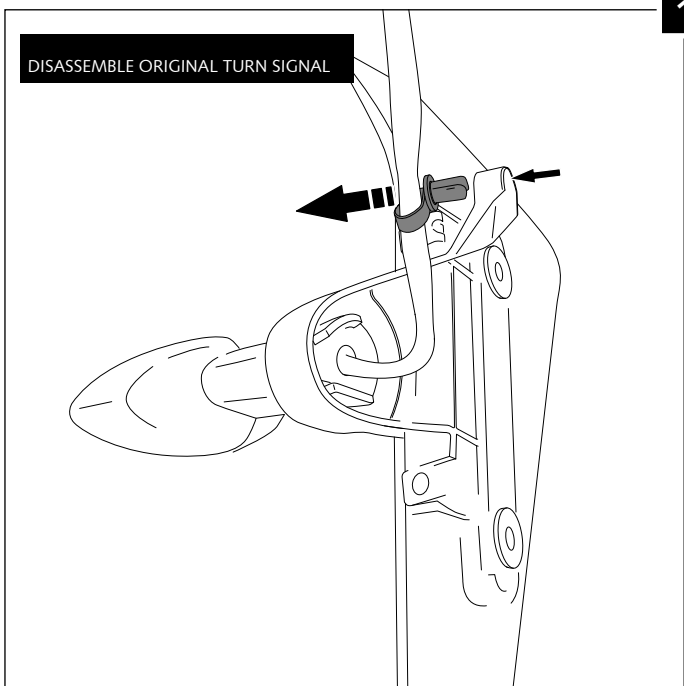



## ANNEXED 2

### PARTS

