

MOUNTING INSTRUCTIONS

SCREEN REINFORCEMENT KIT FOR
BMW R1200GS LC / ADVENTURE
R1250GS LC / ADVENTURE



ID	PART	DESCRIPTION	QTY	REF.
1		Right fixed support	1	SOPOR4P-13-7566
2		Right guided support	1	SOPOR4P-13-7566
3		Left fixed support	1	SOPOR4P-13-7566
4		Left guided support	1	SOPOR4P-13-7566
5		Cylinder Ø inner 8,2 x Ø outer 10 x 5,3 mm (inox.)	2	CASQUI-2----572
6		Cylinder Ø inner 10,4 x Ø outer 13 x 3,3 mm (inox.)	2	CASQUI-2----572
7		Nylon Washer DIN 433 Øinner 10,5 x Øouter 18 x 1,6mm	2	ARAND-----650
8		M8x1,5 DIN125 metal washer (black)	2	ARANDPD125A-018
9		M8 locknut (black)	2	TUEA-D985.8-M8-
10		Nut cover (black)	2	CAPERUTM8--21/2
11		M5x16 Ø11 ISO 7380 screw (black)	2	TORNI-I7380-493
12		M6x25 ISO 7380 screw (black)	4	TORNI-I7380-405
13		M6x1mm metal washer (black)	4	ARANDEPD125-054
14		Cylinder Ø inner 8 x Ø outer 14x7,5 (black)	4	CASQUI8147-0193

SIN SOPORTE GPS / WITHOUT GPS SUPPORT

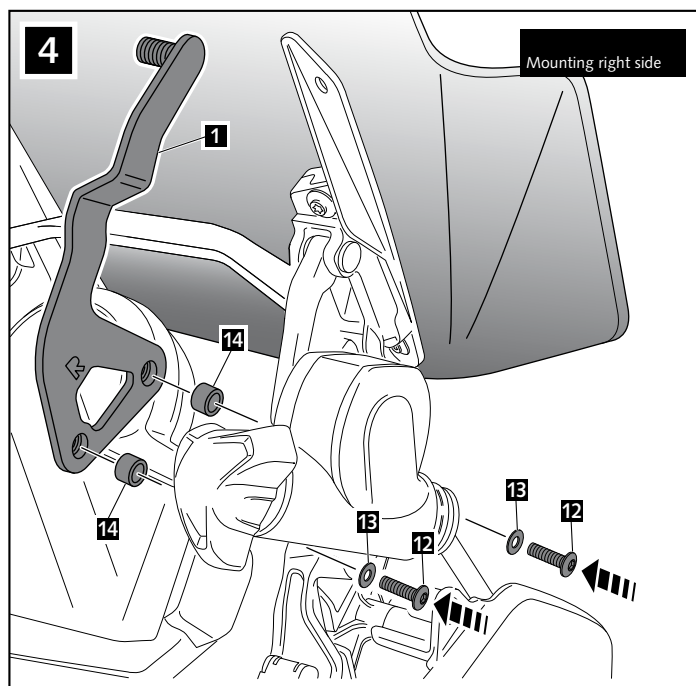
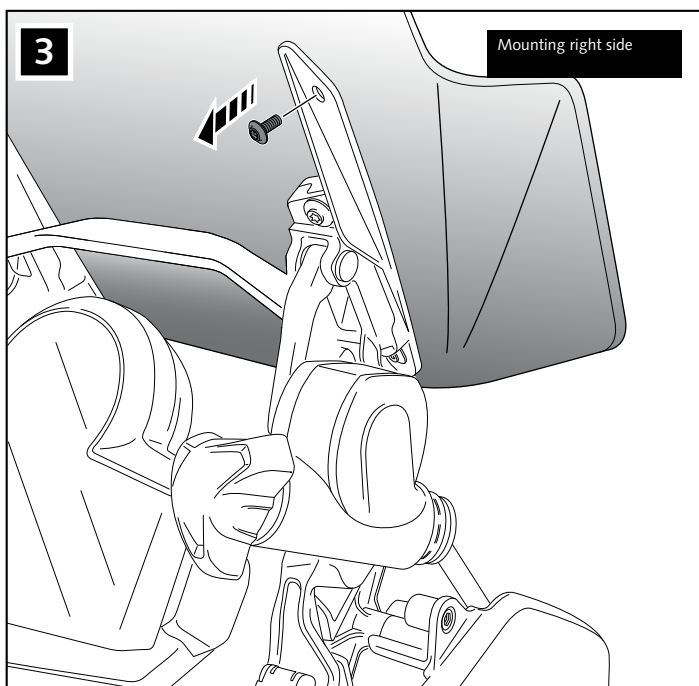
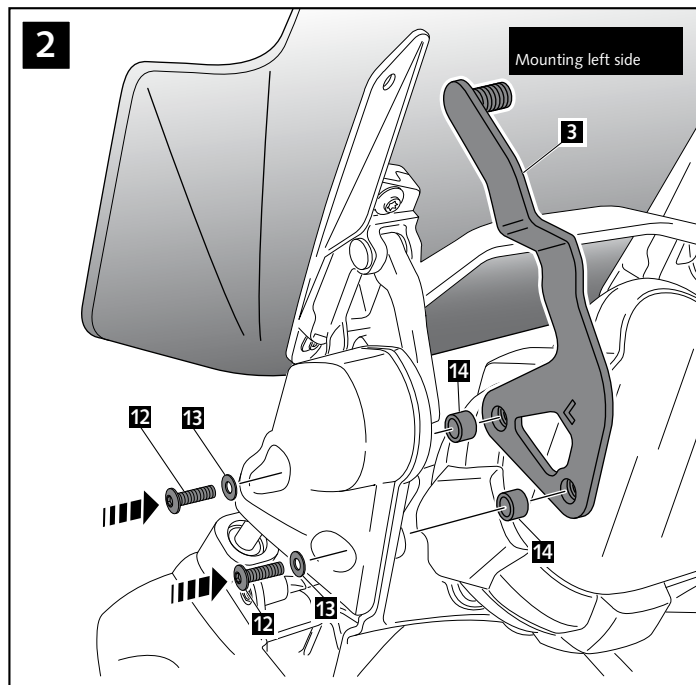
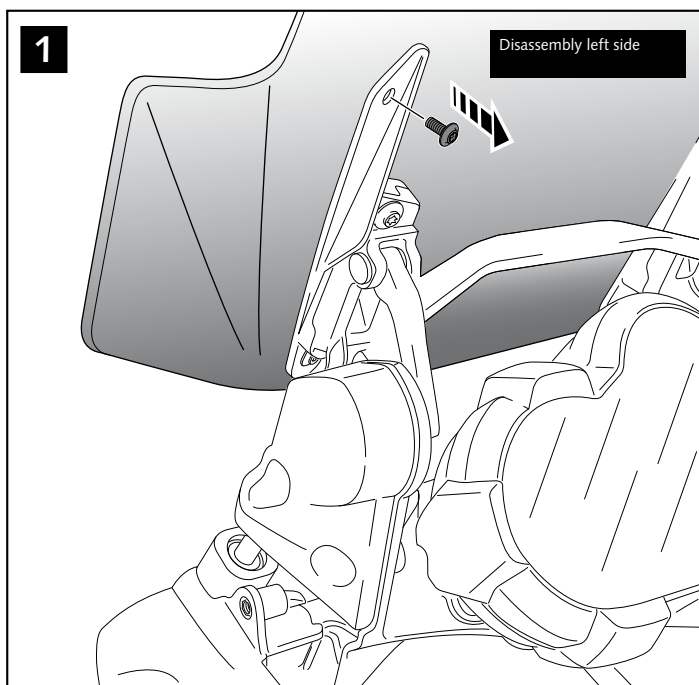

CON SOPORTE GPS / WITH GPS SUPPORT

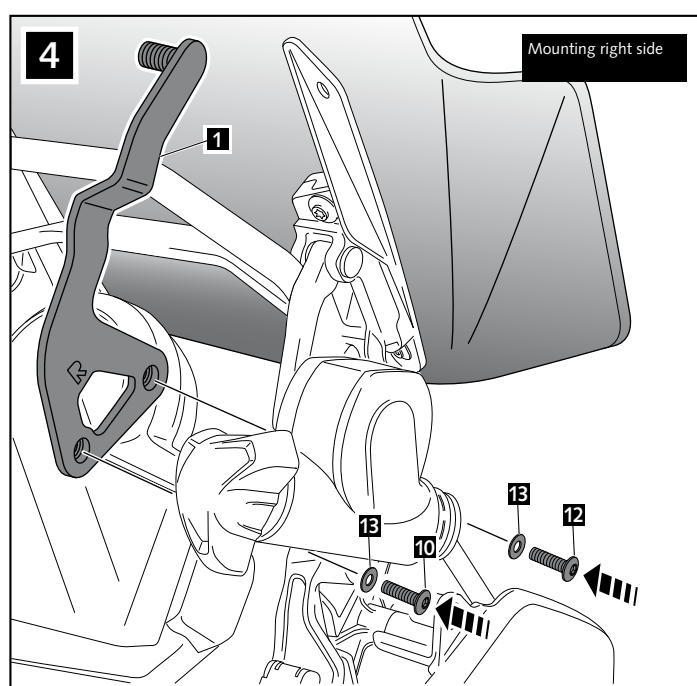
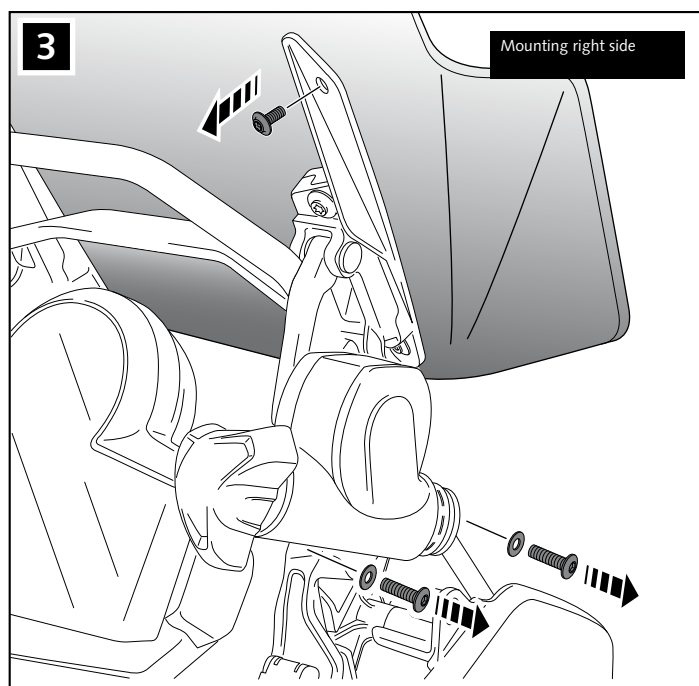
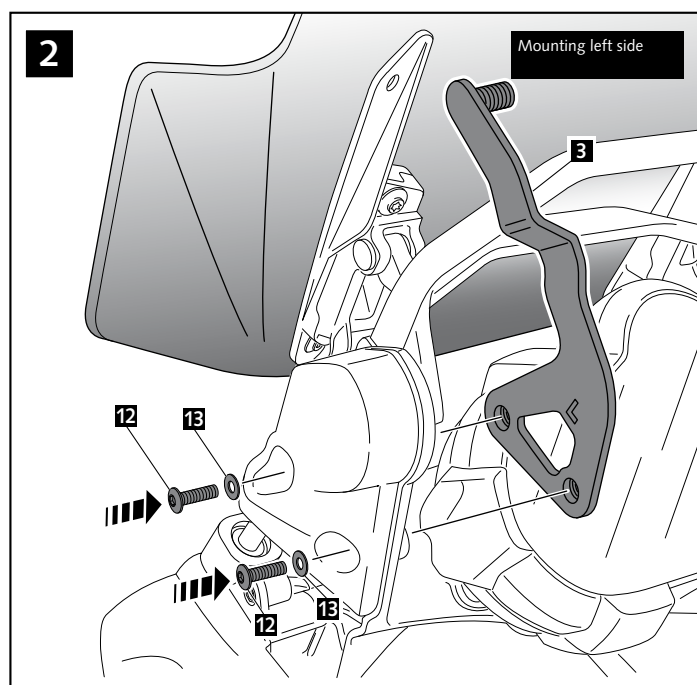
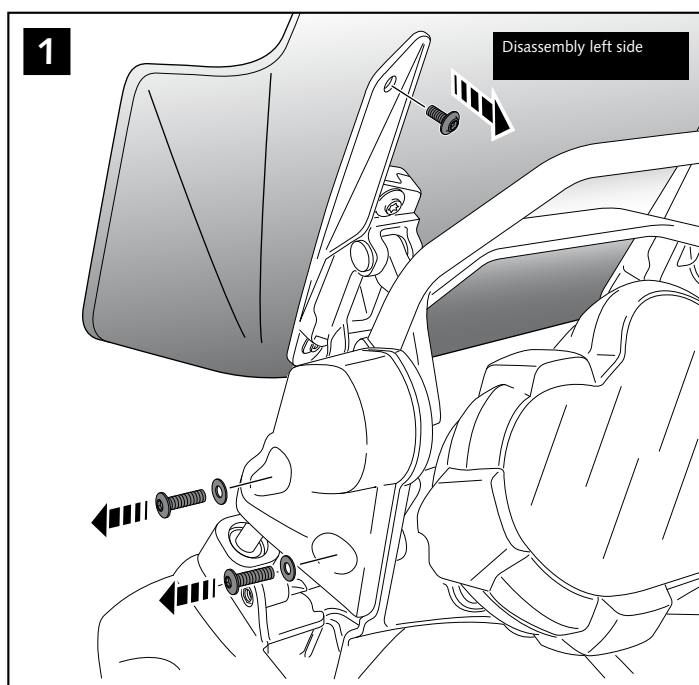

CON Y SIN SOPORTE GPS / WITH & WITHOUT GPS SUPPORT

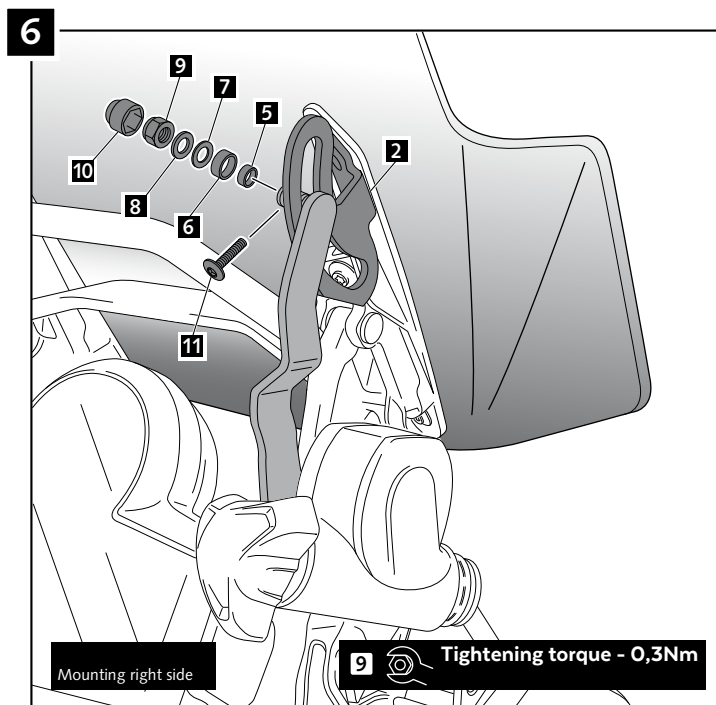
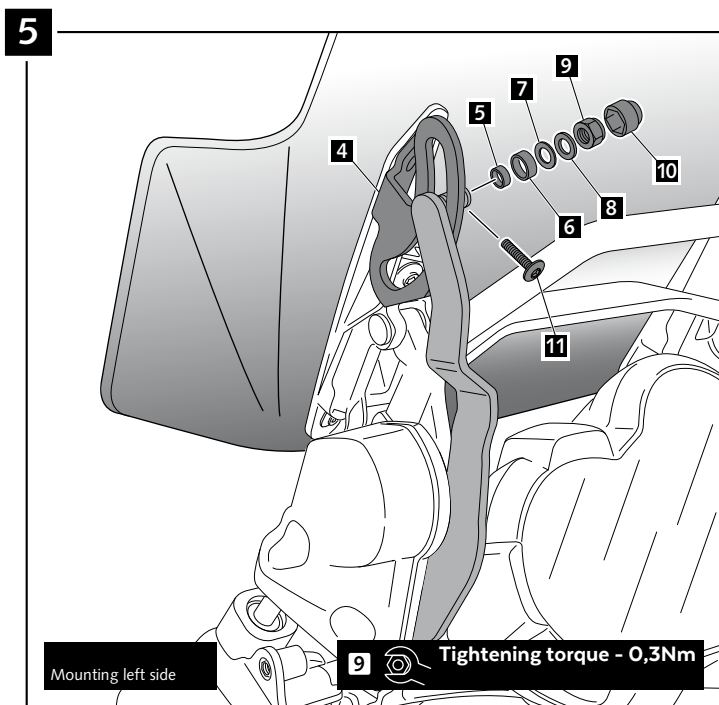

USAGE INFORMATION

THE REINFORCEMENT MECHANISM DESIGNED BY **PUIG** GIVES AN EXTRAORDINARY RIGIDITY TO THE SCREEN. ONCE IT IS MOUNTED, AND UNLIKE OTHER SYSTEMS, IT IS NOT NECESSARY TO LOOSEN THE NUT IN ORDER TO MOVE THE SCREEN. THIS MECHANISM IS DESIGNED IN ORDER TO SERVE ITS FUNCTION IN ANY POSITION OF THE SCREEN AND WITHOUT NEEDING FURTHER REGULATION.