



It would be convenient to re-tight the licence support screws, specially the ones that are fixed to the motorcycle, whenever you maintain the vehicle.

Thanks for your attention.

ID.	DESCRIPTION	QTY.
1	Adjustable support	1
2	Black M6x25 DIN1001 screw	2
3	Black M6x20 DIN1001 screw	2
4	Metalic cilinder	4
5	Well nut	1
6	Plastic ziptides	4
7	License support light	1
8	Reflector	1
9	Support for reflector	1
10	M5x10 screw ISO7380	2
11	M5 nuts DIN6923	2

## MOUNTING INSTRUCTIONS

LICENSE SUPPORT FOR

**KTM RC125-390 14'-**

**Ref.: 7107N**

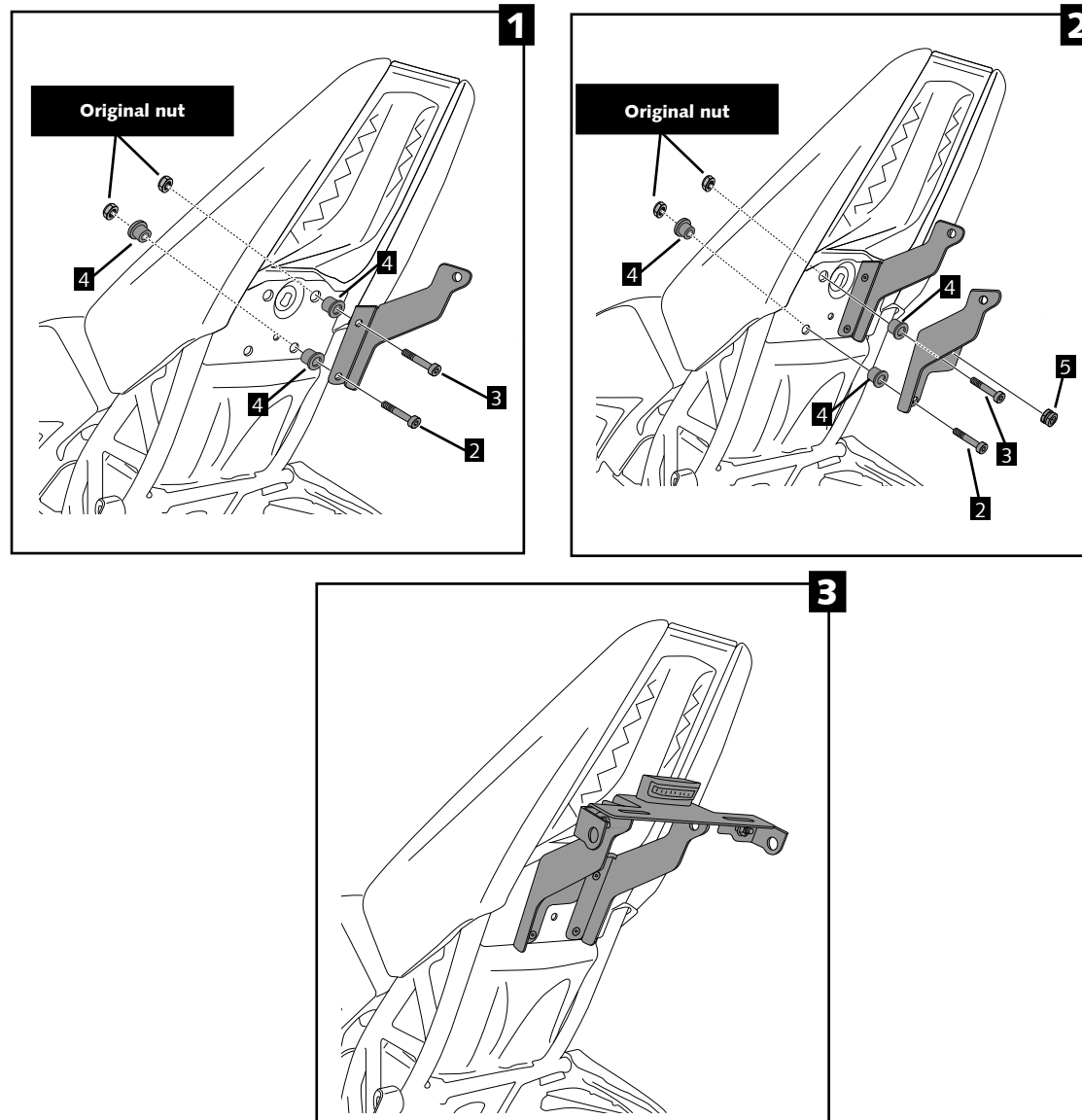

Learn more about motorcycle license plate accessories we have.