

CRASH PADS FOR KAWASAKI ER-6N 09' -11'

REF:5288N



INSTRUCTIONS TO ASSEMBLE

Remove the fasteners that subject the chassis to the engine, on the point marked below (and the opposite side). Mount the protectors on each own side as the figure below shows. Tight the set, and place the caps.

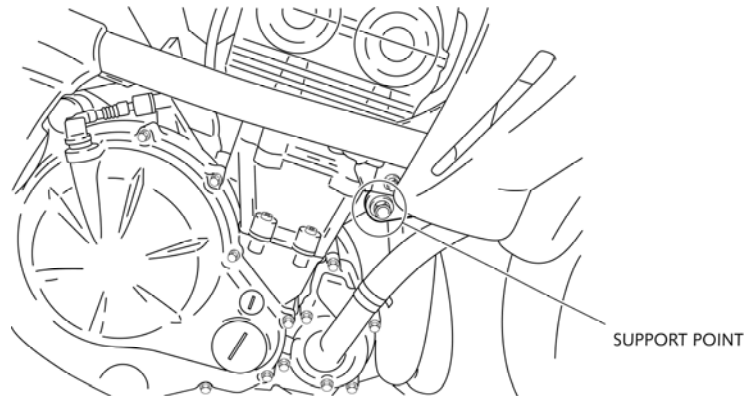

MATERIAL SUPPLIED

POSITION	DESCRIPTION	QUANTITY
1	Caps set	2
2	M10/150x90 screw	1
3	M10/150x120 screw	1
4	Ø20ext.Ø10int x2 washer	2
5	Nylon protector	2
6	Aluminium metal arrowhead right hand side	1
7	Aluminium metal arrowhead left hand side	1
8	Right Iron Plate	1
9	Left Iron Plate	1
10	M10/150 nut DIN 985	2
11	M10/125 x110 screw	1
12	M10/125 x80 screw	1
13	Aluminium metal arrowhead	1

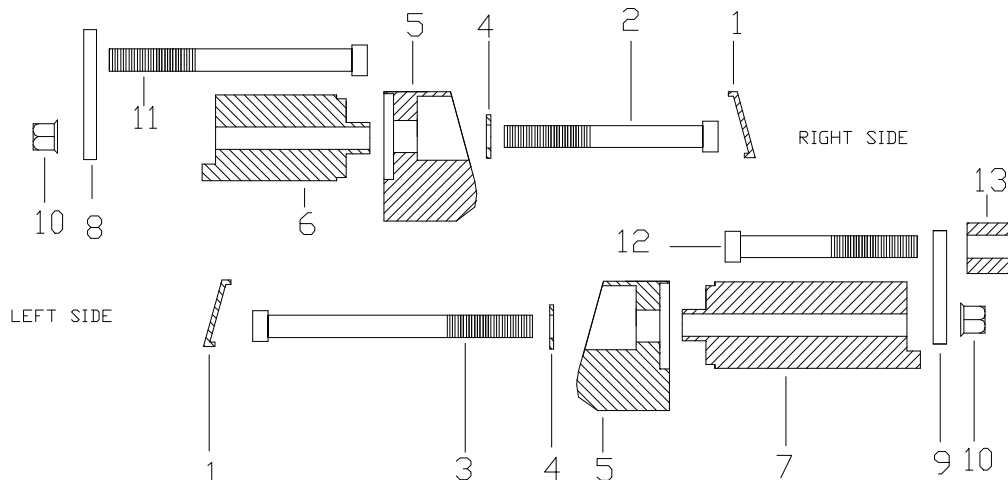

THE USE OF CRASH PADS DO NOT GUARANTEE A FULL PROTECTION IN CASE OF ACCIDENT. MOTOPLASTIC-PUIG DECLINE ANY RESPONSIBILITY IN CASE OF MOTORCYCLE DAMAGE.

Learn more about motorcycle frame and body we have.