

Startup the Heated Function



Switch On
 Press the ON-Button for 2 seconds and then release, the blue light will flash.
Increase Heated Level
 After the blue light flash, repeat the same action on pressing On-Button.
 The green light will flash and the temperature will increase.

Adjust the Temperature



Increase Temperature Level
 Simply press the ON-Button and then release, the indicator light will flash to the next level.
Decrease Temperature Level
 Simply Press the OFF-Button and then release, the indicator light will flash back to the previous level.

Switch Off the Function



Switch Off the heated function
 Simply press the OFF-Button and hold for 2 secs, the first level (blue flash) will be off.
 The heated function will be successfully switched off.

Temperature Graph

Level Indicator

- 1 (Blue)
- 2 (Green)
- 3 (Yellow)
- 4 (Red)

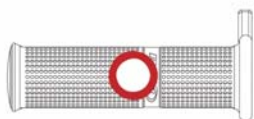

*Measured under 25°C
 *Tolerance +/- 5°C

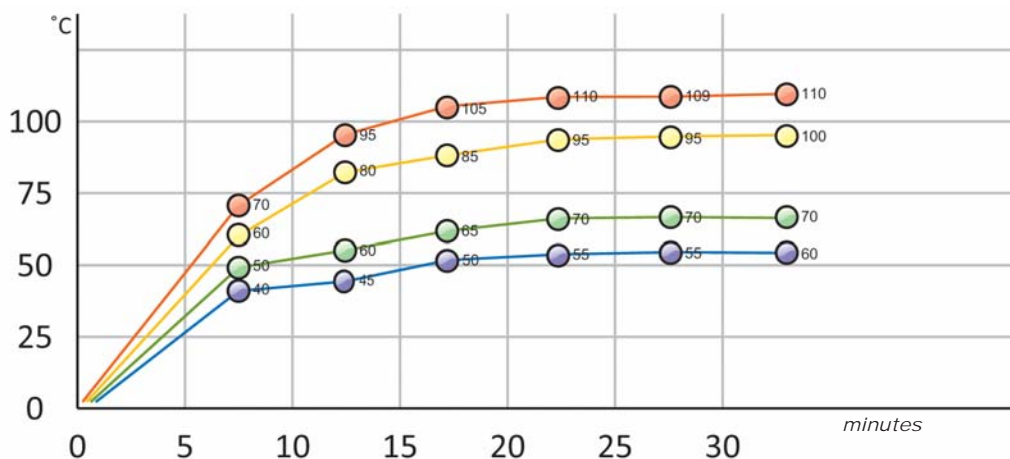

Auto-Protecting Function



When power input is under low voltage
 Once the heated grip detected input voltage is lower than 12.3V, the heated function will be automatically switched off.
Switch On in low voltage power input situation
 If the power input voltage is lower than 12.3V, the blue indicator will flash 5 times and then turn off.

Check all components

*Please check each component is included in the package before you go through.

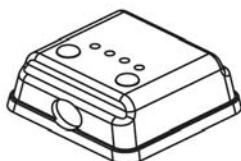

Control Box - 1 PC

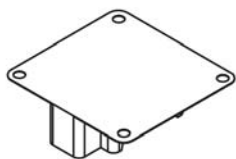

Clamp.Top - 1 PC

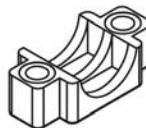

Clamp.Bot - 1 PC



3M Tape - 1 PC

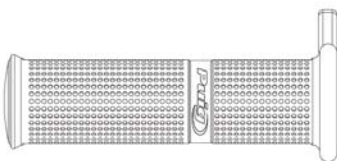

Heat Grip - 1 PAIR

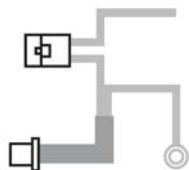

ConnectorWire - 1 SET



SelfTap.Screw - 4 PCS



Hex.Screw - 2 PCS

Wiring Connect Guide

* Please ask local dealer for assistance if you were not familiar with handling the electronic parts.
 * Any damage will occur due to the wrong installation or incorrect wiring connection.

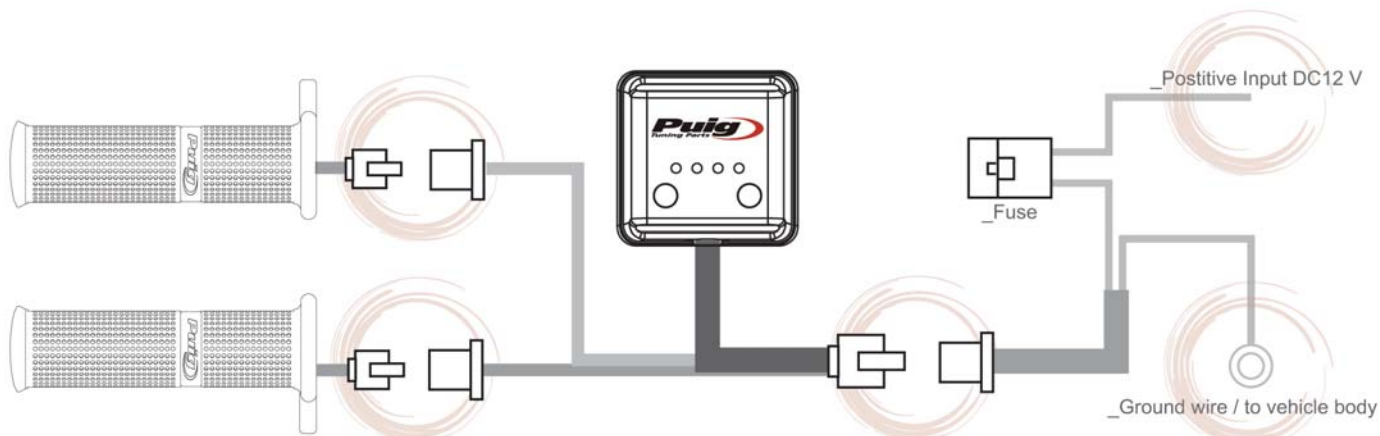

Control Box Assembling

* Please ask local dealer for assistance if you were not familiar with mechanical engineering.
 * Any damage will occur due to the wrong or inappropriate assembling on the Control Unit.

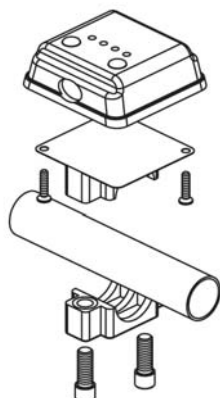

SCREW ON HANDLE-BAR

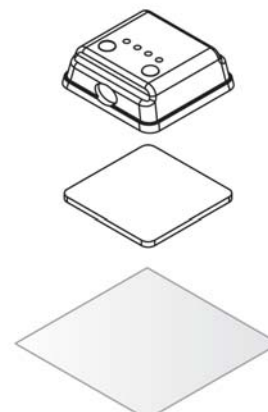

ATTACH TO BODY - SURFACE