

CRASH PADS FOR KAWASAKI ER6n 09

REF:4964



INSTRUCTIONS TO ASSEMBLE

1. Remove the fasteners that fix the chassis to the engine (mark on the picture below).
2. Mount the plate-protector set on its own side (using the 12 and 13 fasteners with the original nuts).
3. After tightening, install the plugs (1), fixing them with the supplied screws (8). Finally, place the adhesives (9), pressing a few seconds to ensure correct fixation.

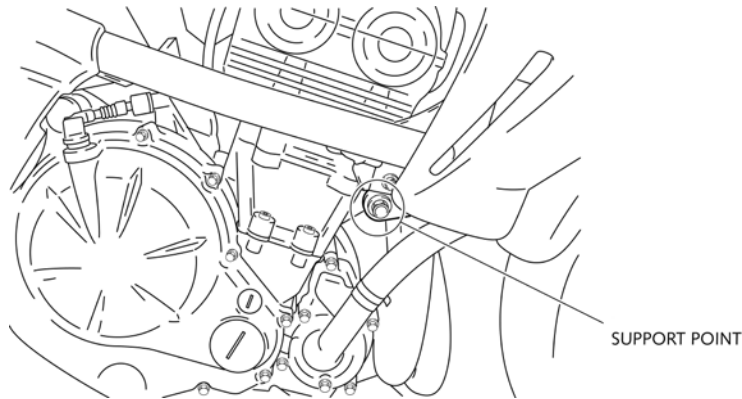

MATERIAL SUPPLIED

POSITION	DESCRIPTION	QUANTITY
1	Plastic caps	2
2	M10/150x55 screw	1
3	M10/150x80 screw	1
4	Ø20ext.Ø10int x2 washer	2
5	Nylon protector	2
6	Aluminium metal arrowhead right hand side	1
7	Aluminium metal arrowhead left hand side	1
8	Right Iron Plate	1
9	Left Iron Plate	1
10	M10/125 x110 screw	1
11	M10/125 x70 screw	1
12	Aluminium metal arrowhead	1
13	M10/150 nut DIN 6921	2

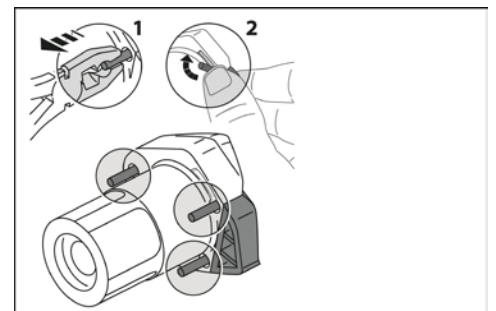
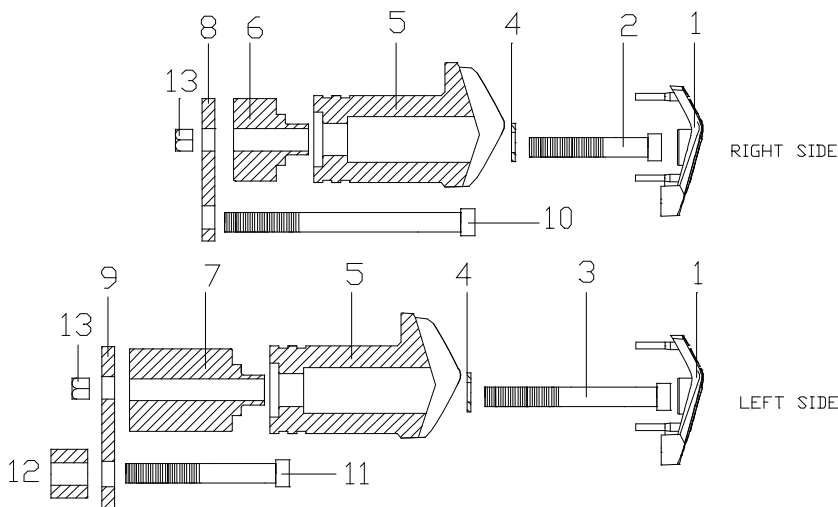

THE USE OF CRASH PADS DO NOT GUARANTEE A FULL PROTECTION IN CASE OF ACCIDENT. MOTOPLASTIC-PUIG DECLINE ANY RESPONSIBILITY IN CASE OF MOTORCYCLE DAMAGE.

Learn more about motorcycle frame and body we have.