

CRASH PAD FOR DUCATI MONSTER 696 08'-09'
REF:4705

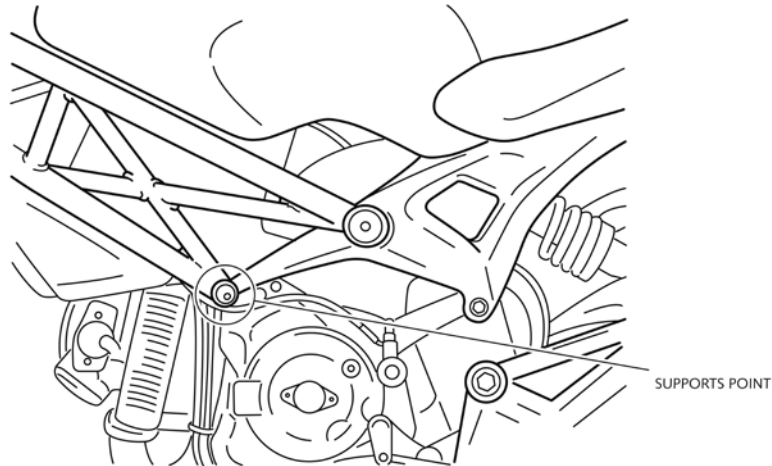

INSTRUCTIONS TO ASSEMBLE

Remove the nut that subjects the engine to the chassis on the point marked on the figure. Remove the left puck from the set (the one that has more thread on the bar) and introduce it in the chassis so it pushes the original bar out. Once replaced, mount the left crash pad and tight it on both sides. Once tight it, place the caps (1) and fix it with the fasteners (8). Finally, place the stickers (9) pressing a few seconds to make sure it has been placed correctly.



MATERIAL SUMINISTRADO / MATERIAL SUPPLIED

| POSITION | DESCRIPTION | QUANTITY |
|----------|---------------------------|----------|
| 1 | Plastic lids | 2 |
| 2 | 275mm screw bar | 1 |
| 3 | M12/175x25 DIN912 | 2 |
| 4 | Ø20ext.Ø12,5int x2 washer | 2 |
| 5 | Nylon protector | 2 |
| 6 | Aluminium metal arrowhead | 2 |

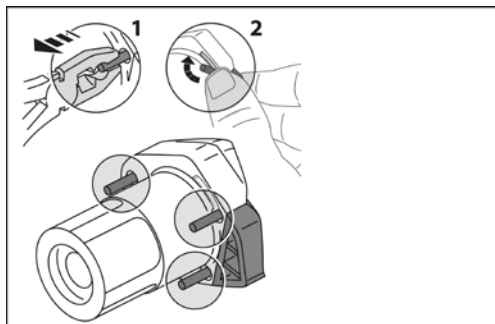
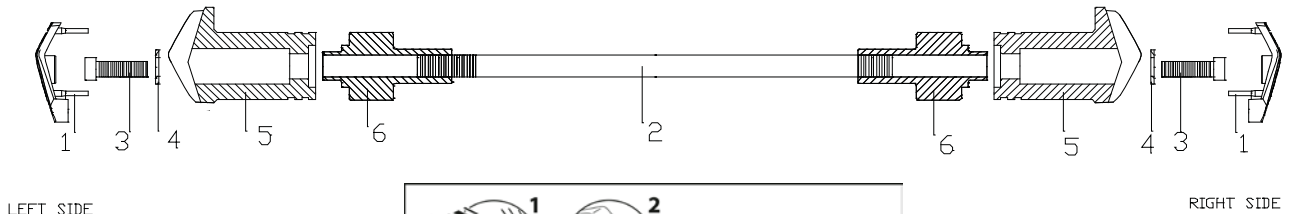

THE USE OF CRASH PADS DO NOT GUARANTEE A FULL PROTECTION IN CASE OF ACCIDENT. MOTOPLASTIC-PUIG DECLINE ANY RESPONSIBILITY IN CASE OF MOTORCYCLE DAMAGE.

Learn more about motorcycle frame and body we have.