

ROUNDED CONTOUR-PROFILE

PREVENTION

- Use water and neutral soap to clean the windshield.
- Check the tightening of the fasteners periodically.
- Park the scooter facing the sun, avoiding the sun-reflection effect that may damage some parts.
- Park if possible on even surfaces.

Thanks for your attention.

ID.	DESCRIPTION	QTY.
1	Clear windshield	1
2	Metal support 70x80°xØ8	2
3	5,5x14 screw to tight into plastic	2
4	Plastic washer	4
5	5,5x16 screw to tight into plastic	2
6	Support with drill through	2
7	Screw with drill through	2
8	Special washer	2
9	Ø10x230 bar	2
10	M8 nut cover	4
11	M8/125x30 left fastener (left side)	1
12	M8/125x30 (right side)	1
13	M8 washer DIN 125/A	2
14	M8/125 lock nut cover DIN 915	3
15	Bellow drill cover	2
16	Plastic support	2
17	M8 lock nut cover left fastener	1
18	Arrowhead Ø8xØ14x6	2
19	M8 nut cover	2
20	Ø8 nylon washer	4

WINDSHIELD ADAPTABLE TO
HONDA SCOOPY SH 125-150i '06-'08

Mod.: TS
Ref.: 4028W

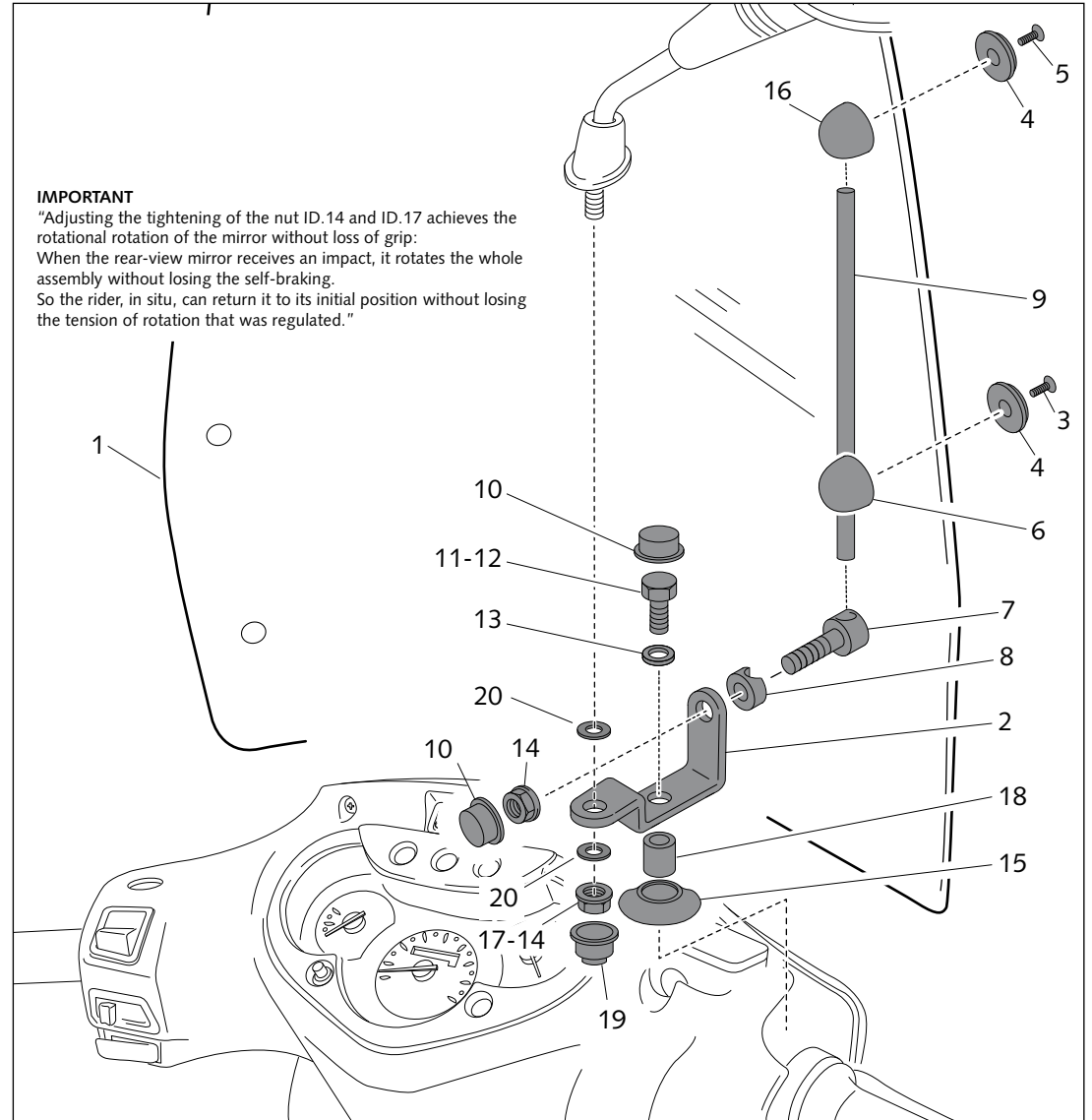

IMPORTANT

"Adjusting the tightening of the nut ID.14 and ID.17 achieves the rotational rotation of the mirror without loss of grip:
When the rear-view mirror receives an impact, it rotates the whole assembly without losing the self-braking.
So the rider, in situ, can return it to its initial position without losing the tension of rotation that was regulated."