

# HONDA AFRICA TWIN

## CRF1100L ADVENTURE '20- / CRF1100L '20-

### M O U N T I N G I N S T R U C T I O N S

REF 3887

BEAK



1 Person



15 min



EASY



HONDA AFRICA TWIN ADVENTURE '20-



HONDA AFRICA TWIN '20-



N° 12  
N° 13



ALLEN  
N° 3  
N° 4  
N° 6

ID	PART	DESCRIPTION	QTY	REF
1		Beak	1	3887JM3
2		Chassis Support for HONDA AFRICA TWIN '20-	1	SOPOR3P6CN-3887
		Chassis Support for HONDA AFRICA TWIN ADVENTURE '20-	1	SOPOR3P6CA-3887
3		Base Support	1	SOPOR3P6B--3887
4		M5x11 Ø11 ISO 7380 Allen screw	4	TORNI-AI----520
5		M6x16 Ø11 ISO 7380 Allen screw	2	TORNI-I7380-403
6		M5x1 nylon washer	4	ARNV00000000245
7		Ø4,5 x Ø11 x 2mm rubber washer	4	ARAND-EPDM--722
8		M5 ISO 7380 Screw Cap	4	TAPON-----85
9		M8x35 DIN 912 Allen Screw	2	TORNI-AD912-196
10		M8 Lock nut	2	TUEA-D985.8-M8-
11		Sticker kit	1	ADHESI-VI--3887

# HONDA AFRICA TWIN CRF1100L ADVENTURE '20- / CRF1100L '20-

## MOUNTING INSTRUCTIONS

**1**

DISASSEMBLY

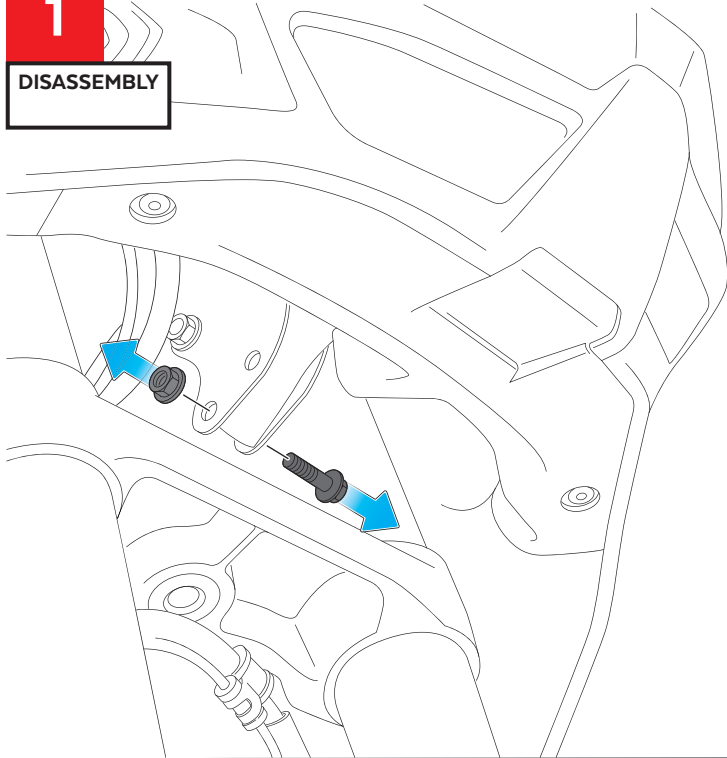

**2**

ASSEMBLY

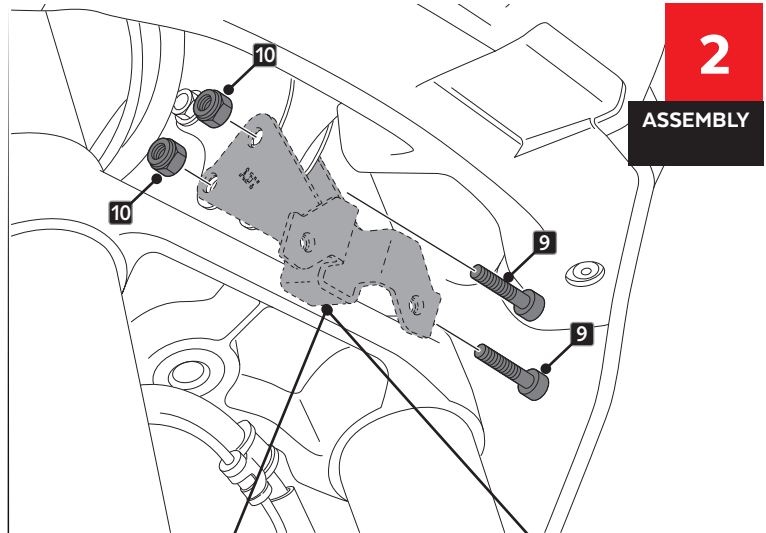

HONDA AFRICA TWIN '20-

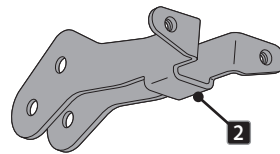

HONDA AFRICA TWIN ADVENTURE '20-

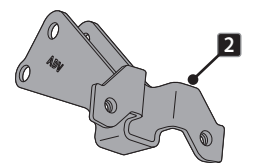

**3**

ASSEMBLY

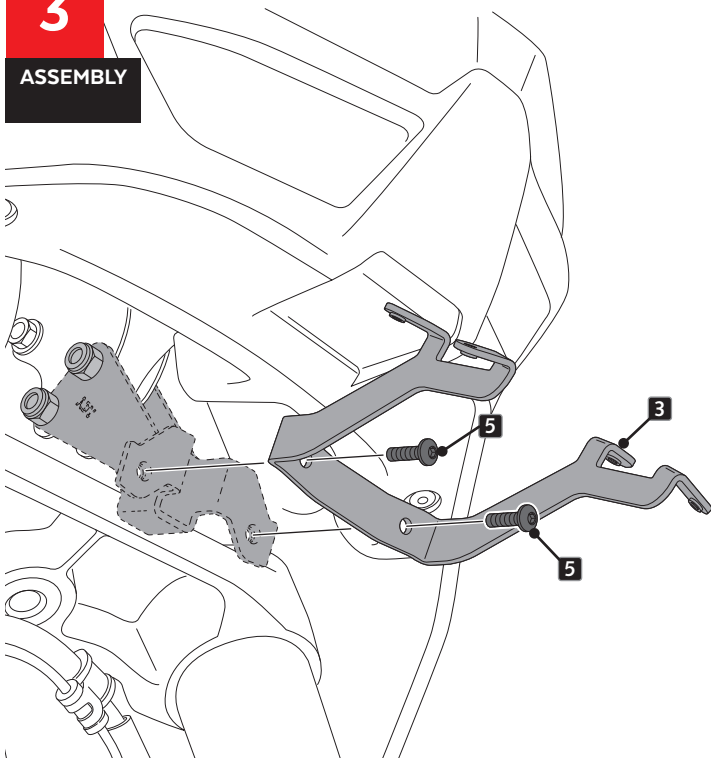

**4**

ASSEMBLY

