

BMW S1000RR '19-

MOUNTING INSTRUCTIONS

REF 3833



SIDE DEFLECTORS

1 Person

5 min

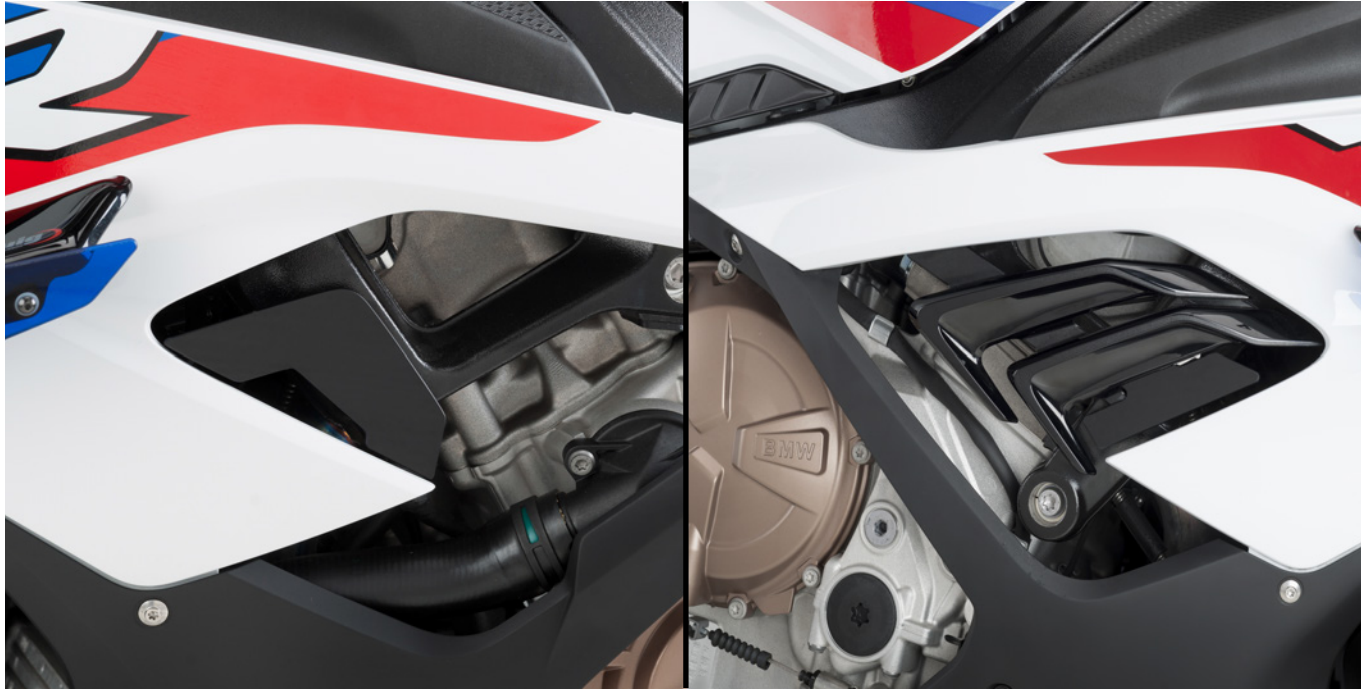
EASY

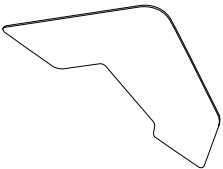
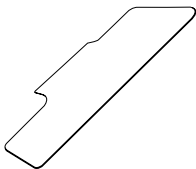
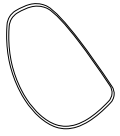

| ID. | PART | DESCRIPTION | QTY. | REF.: |
|-----|---|----------------------------------|------|-----------------|
| 1 |  | Left deflector | 1 | 3833NM3 |
| 2 |  | Right deflector | 1 | 3833NM3 |
| 3 |  | Left double-sided adhesive tape | 1 | ADHESI2PVI-3833 |
| 4 |  | Right double-sided adhesive tape | 1 | ADHESI2PVI-3833 |

BMW S1000RR '19-

MOUNTING INSTRUCTIONS

1

ASSEMBLY

LEFT SIDE

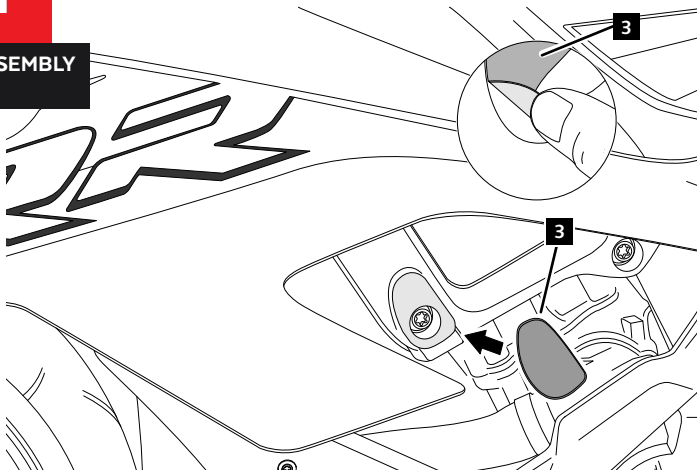

STEP 1 MAKE SURE ALL SURFACES ARE CLEAN AND DRY.

STEP 2 EXTRACT THE PAPER FROM THE DOULE-SIDED ADHESIVE TAPE.

STEP 3 PUT ID3 IN THE POSITION INDICATED BY THE ARROW.

2

ASSEMBLY

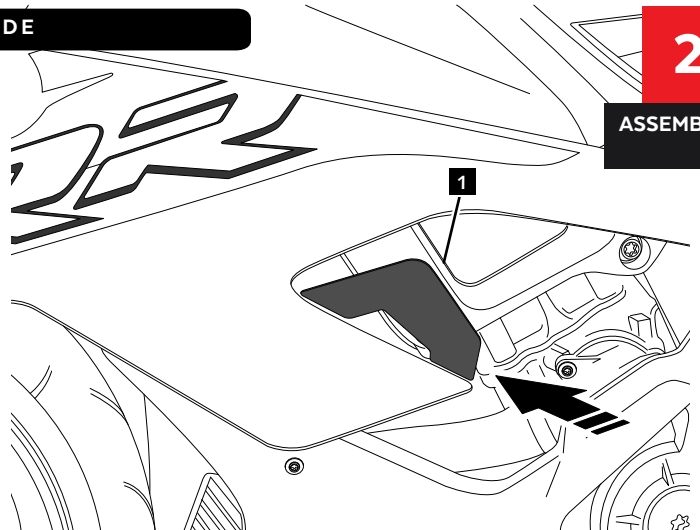

STEP 4 TO POSITION THE DEFLECTOR ACCORDING TO IMAGE.

STEP 5 APPLY PRESSURE ON ADHESIVE AREA FOR 1 MINUT. IDEAL TAPE APPLICATION IS ACCOMPLISHED WHEN TEMPERATURE IS BETWEEN 21°C AND 38° AND THE BOND IS ALLOWED TO DWELL 24 HOURS.

3

ASSEMBLY

RIGHT SIDE

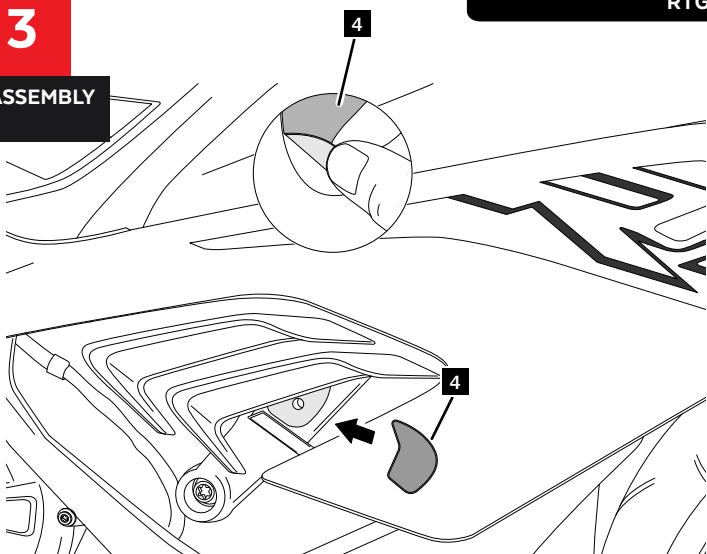

STEP 1 MAKE SURE ALL SURFACES ARE CLEAN AND DRY.

STEP 2 EXTRACT THE PAPER FROM THE DOULE-SIDED ADHESIVE TAPE.

STEP 3 PUT ID3 IN THE POSITION INDICATED BY THE ARROW.

4

ASSEMBLY

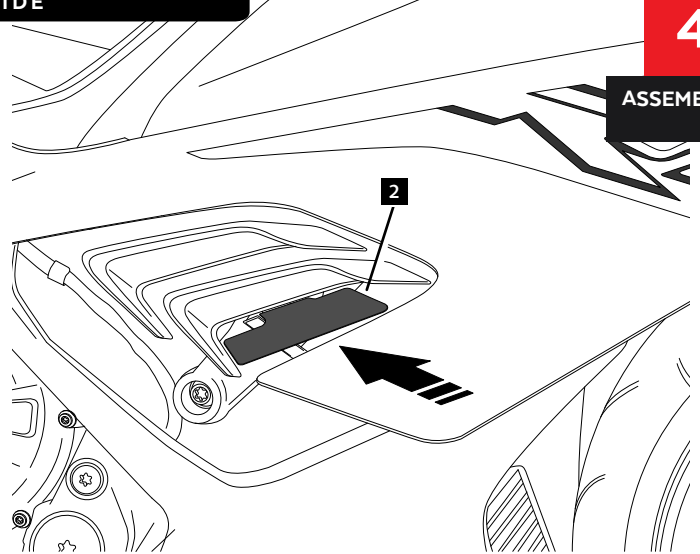

STEP 4 TO POSITION THE DEFLECTOR ACCORDING TO IMAGE.

STEP 5 APPLY PRESSURE ON ADHESIVE AREA FOR 1 MINUT. IDEAL TAPE APPLICATION IS ACCOMPLISHED WHEN TEMPERATURE IS BETWEEN 21°C AND 38° AND THE BOND IS ALLOWED TO DWELL 24 HOURS.