

DUCATI PANIGALE
V4 '20- / V4 R '19-'20 / V4 S '20-

REF 3759

R - RACER SCREEN



1 Person



45 min



MEDIUM



TORX T° 7

ALLEN N° 3
N° 4

| ID | PART | DESCRIPTION | QTY | REF |
|----|---|----------------|-----|-----------------|
| 1 |  | R-Racer screen | 1 | 3759F/H/R/W/NM3 |

1

DISASSEMBLY

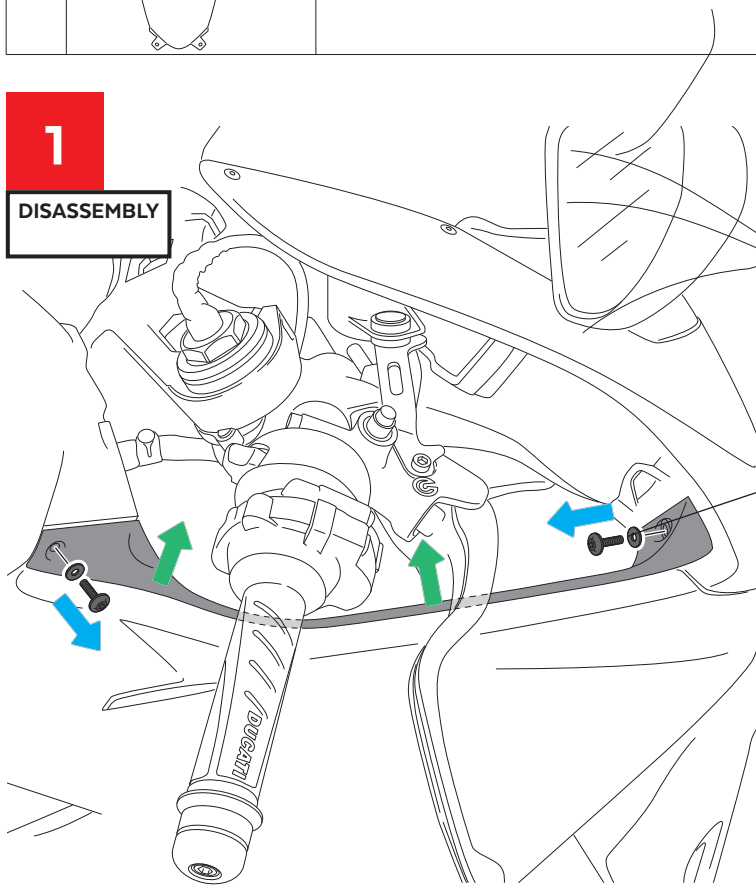

2

DISASSEMBLY

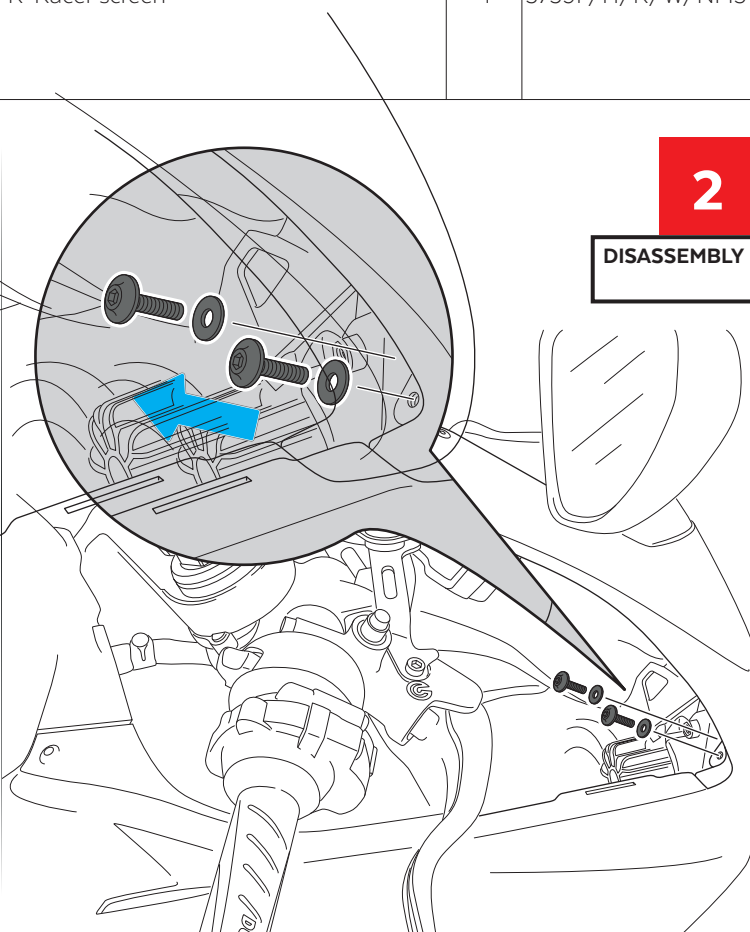

DUCATI PANIGALE
V4 '20- / V4 R '19-'20 / V4 S '20-

MOUNTING INSTRUCTIONS

3

DISASSEMBLY

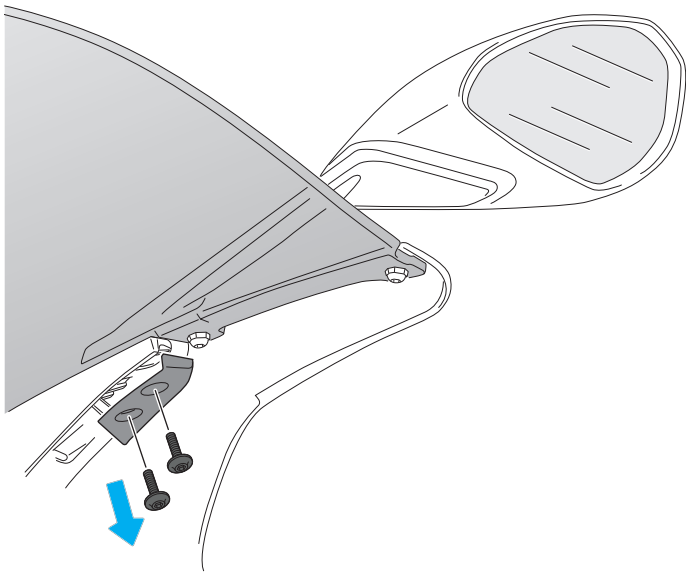

4

DISASSEMBLY

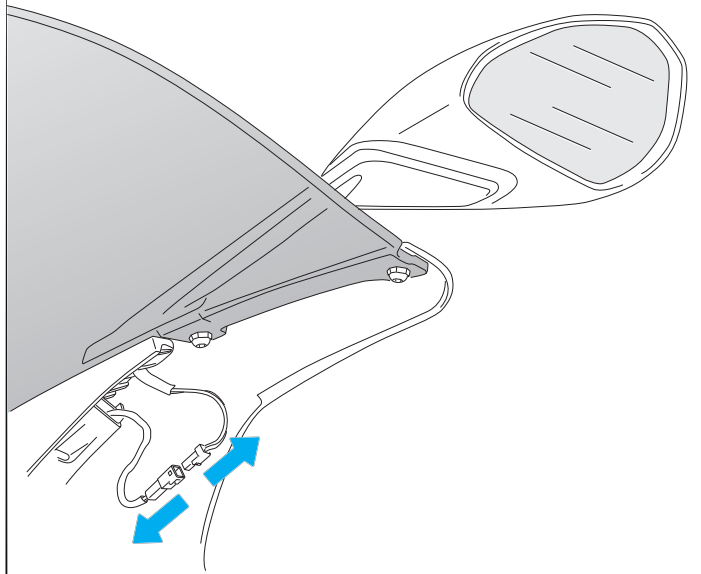

5

DISASSEMBLY

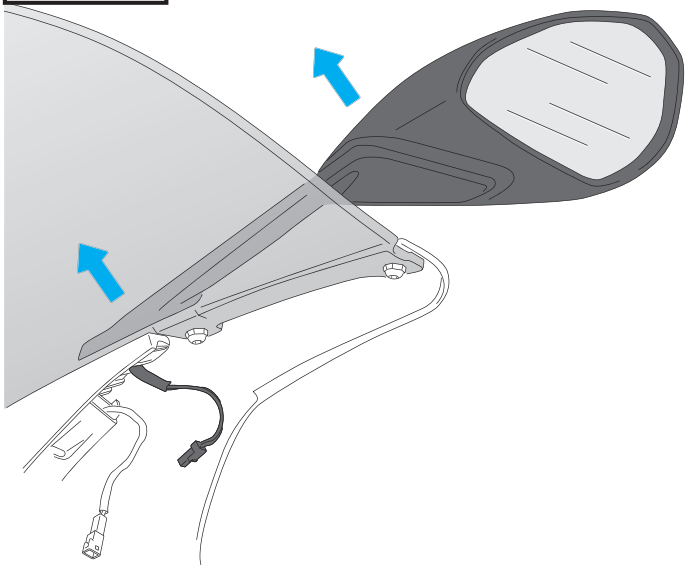

6

DISASSEMBLY

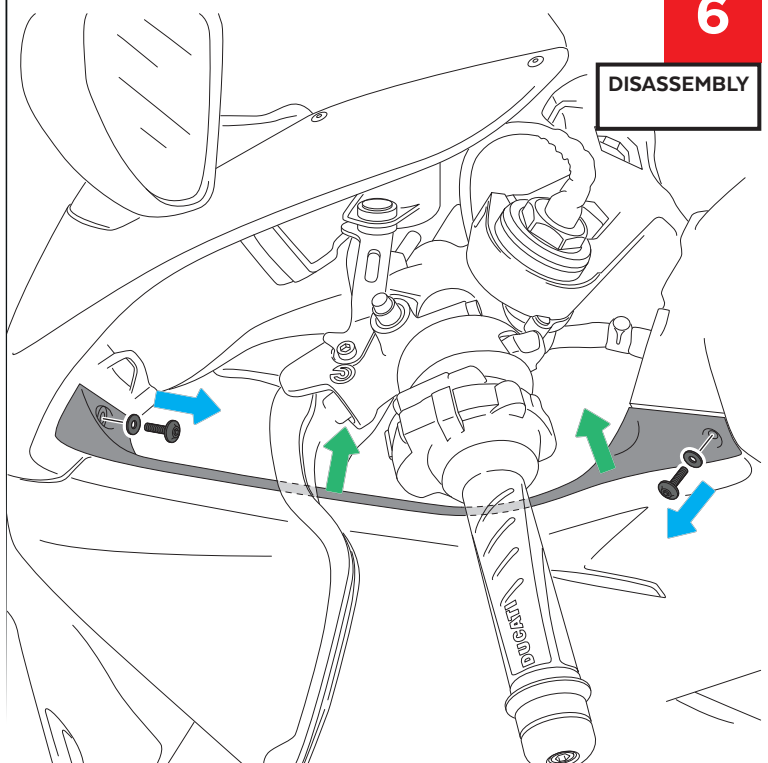

**DUCATI PANIGALE
V4 '20- / V4 R '19-'20 / V4 S '20-**

MOUNTING INSTRUCTIONS

7

DISASSEMBLY

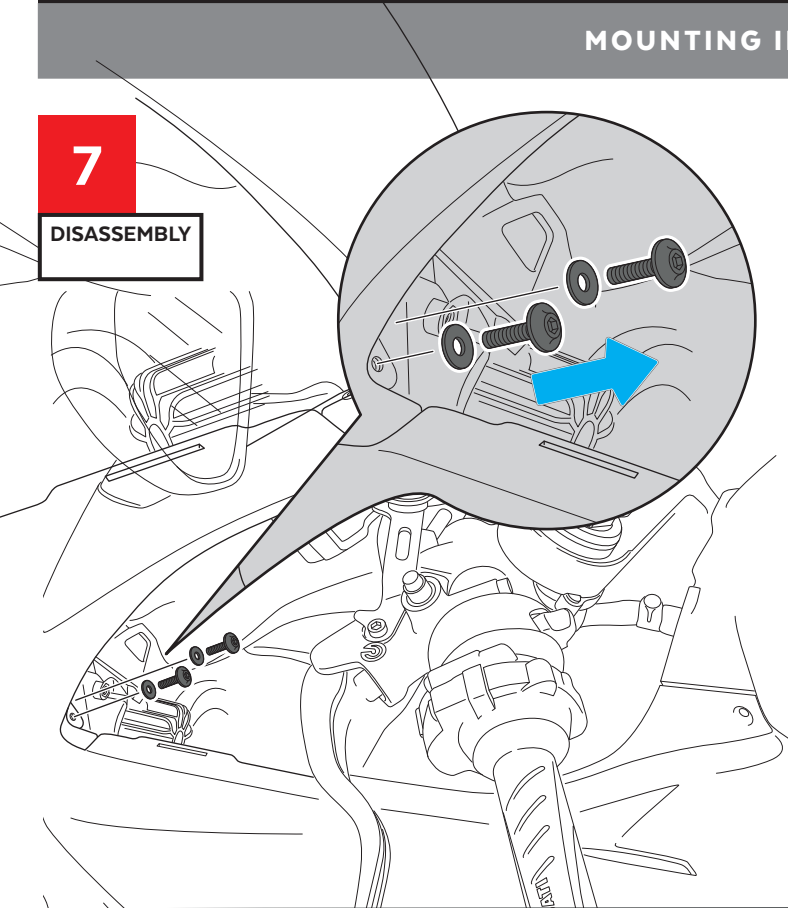

8

DISASSEMBLY

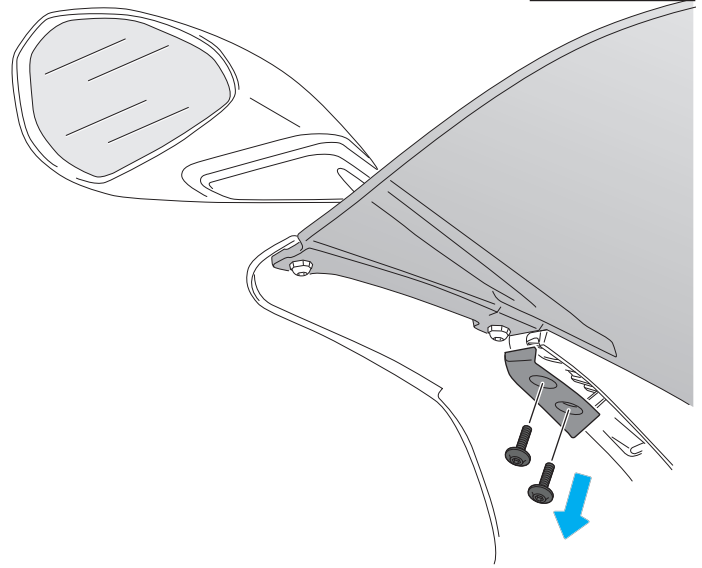

9

DISASSEMBLY

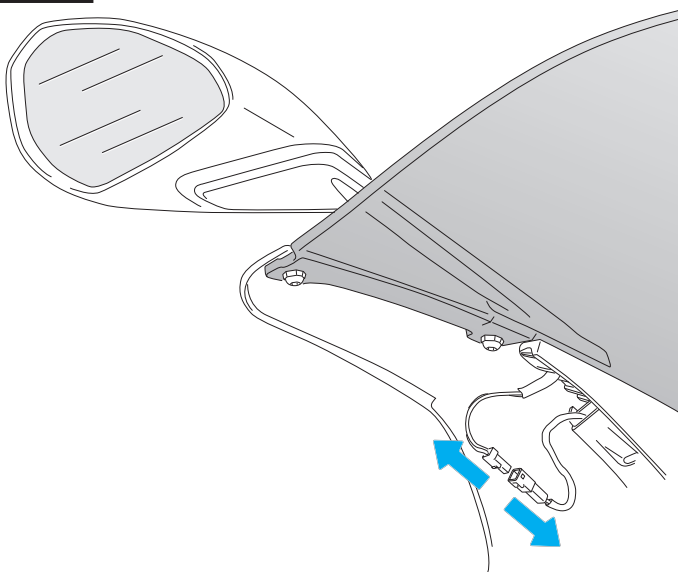

10

DISASSEMBLY

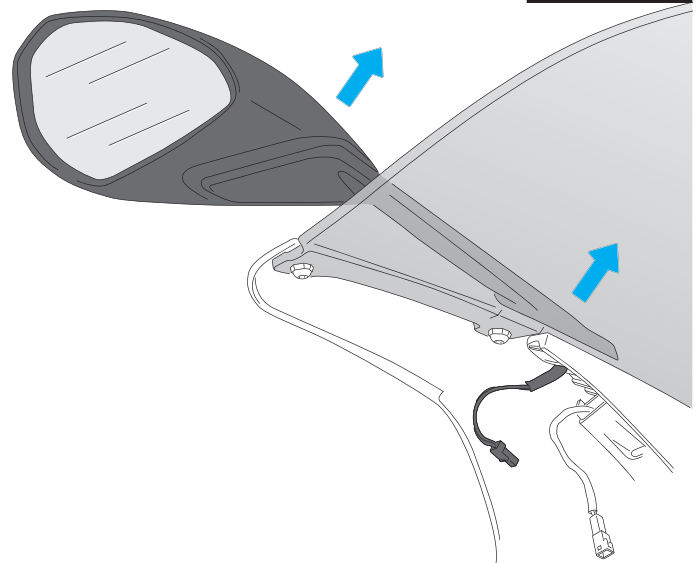

DUCATI PANIGALE V4 '20- / V4 R '19-'20 / V4 S '20-

MOUNTING INSTRUCTIONS

11

DISASSEMBLY

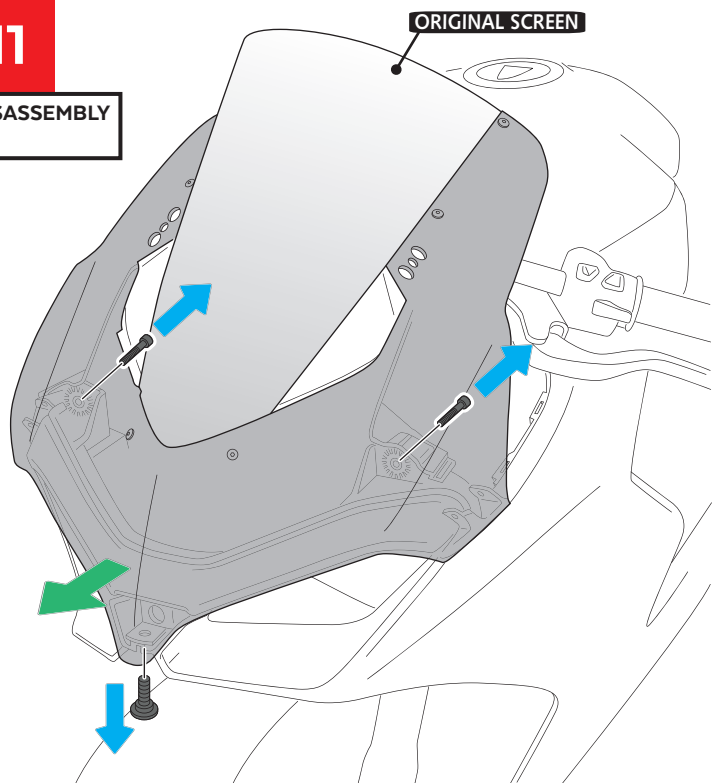

12

DISASSEMBLY

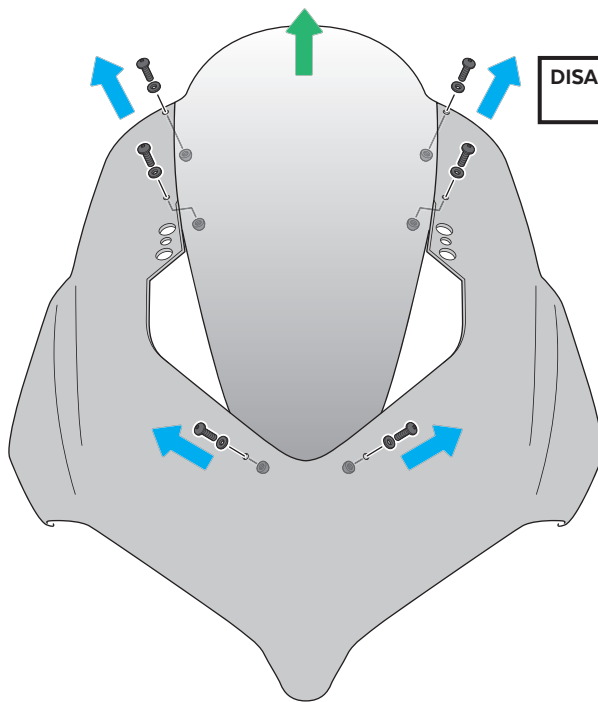

13

ASSEMBLY

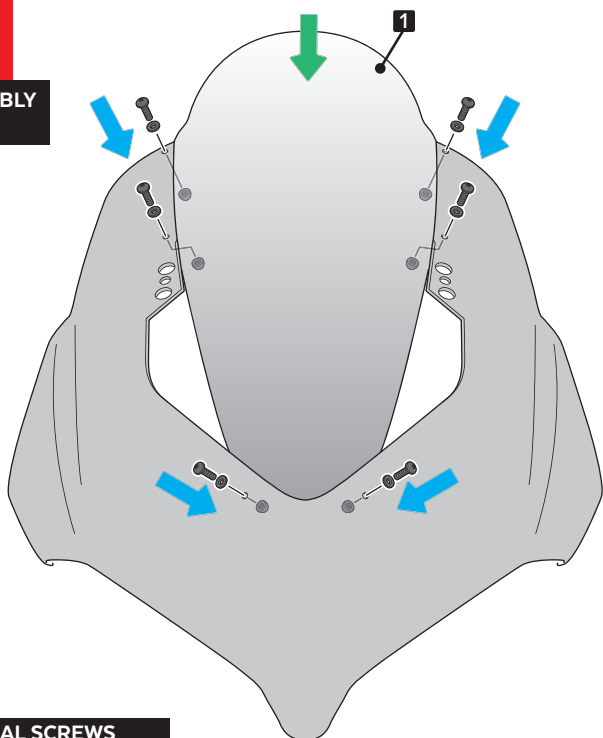

ORIGINAL SCREWS

IN ORDER TO FINISH THE ASSEMBLY OF THE FAIRING,
PLACE THE SCREWS BACK ON ACCORDING TO DRAWINGS 11
TO 1.