

KYMCO X-CITING 400 S '19-

M O U N T I N G I N S T R U C T I O N S

REF 3757

**V-TECH LINE TOURING WINDSHIELD
(WINDSHIELD INCLUDES DETACHABLE HAND-DEFLECTORS)**



OPTION A

WINDSHIELD
WITHOUT
HAND-DEFLECTORS









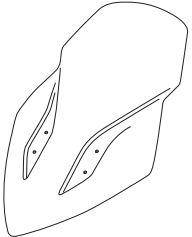
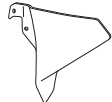
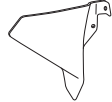

OPTION B

WINDSHIELD
WITH
HAND-DEFLECTORS

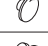

PHILLIPS
SCREWDRIVER

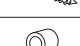
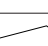

ID	PART	DESCRIPTION	QTY	REF
1		Windshield	1	3757F/H/WM3
2		Left hand-deflector	1	3757F/H/WM3
3		Right hand-deflector	1	3757F/H/WM3
4		Ø17,5x Ø9,5 x Ø13 x10 silentblock	4	AROPASACABLES--
5		Ø15 xØ9 x7,5 bush with flange	4	CASQUI-1A---324
6		M6x16 Ø14 ISO 7380 Allen screw	4	TORNI-I7380-403
7		M6 ISO 7380 screw cap	4	TAPON-----86
8		Ø9 xØ6 x8mm silentblock	4	AROPASACABLES-3
9		Ø12xØ6,8x7,3 bush with flange	4	CASQUI-1A---750
10		DIN7505/B Ø4 x 35 sc rew	4	TORNI-D7505-869
11		Ø9x Ø5 x13 spacer	4	CASQUI-----713
12		25x15mm dual lockhook and loop fastener (supplied already mounted on items 2/3)	2	hook and loop fastener-25X10
13		Stickers set (supplied already mounted on items 2/3)	1	ADHESI-----268

KYMCO X-CITING 400 S '19-

MOUNTING INSTRUCTIONS

1

DISASSEMBLY

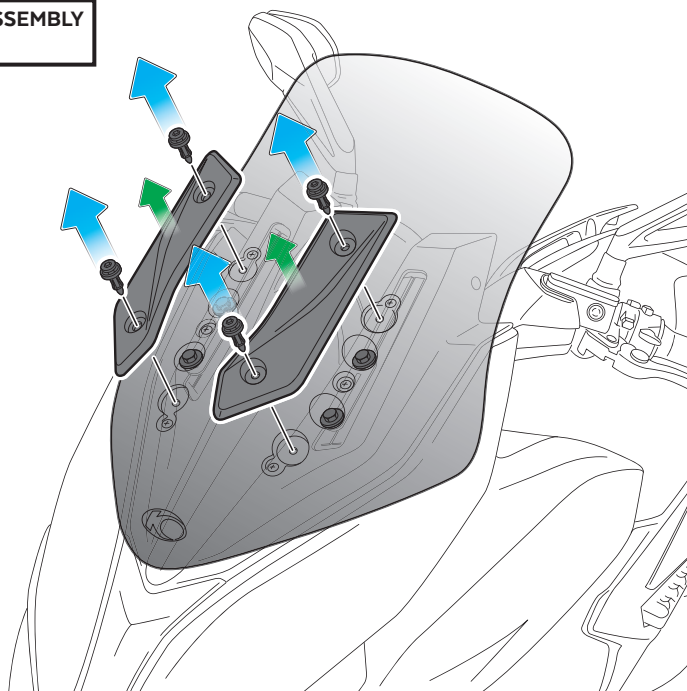

2

DISASSEMBLY

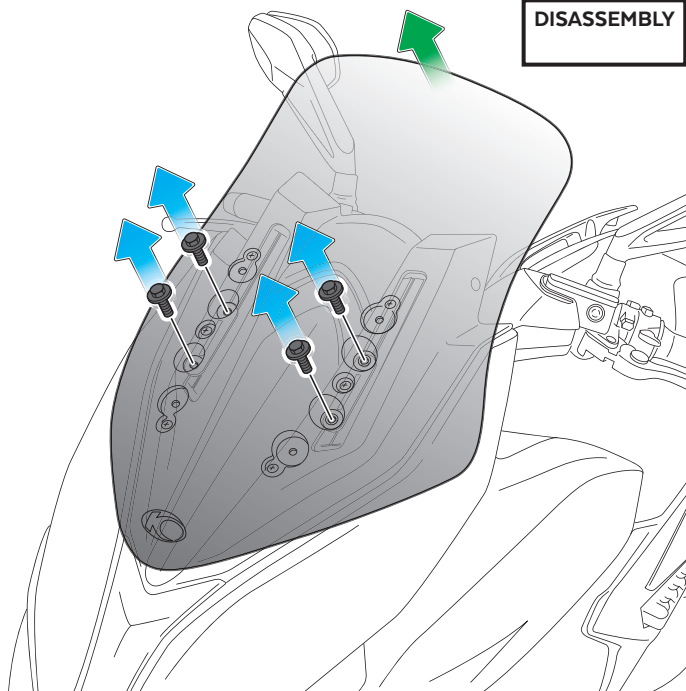

3

DISASSEMBLY

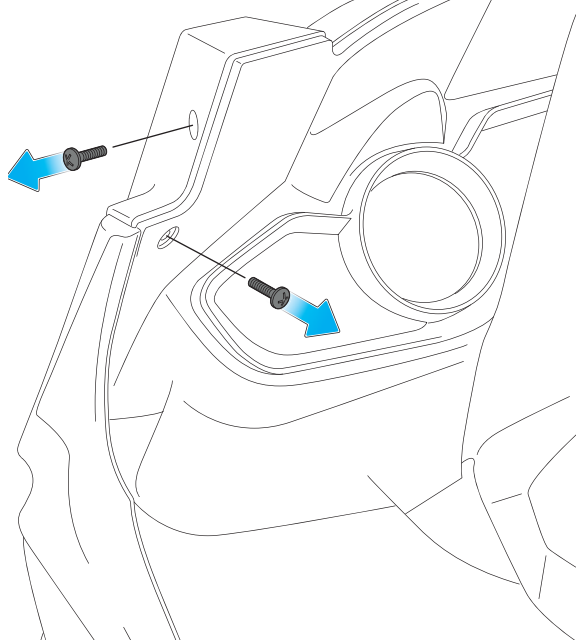

4

ASSEMBLY

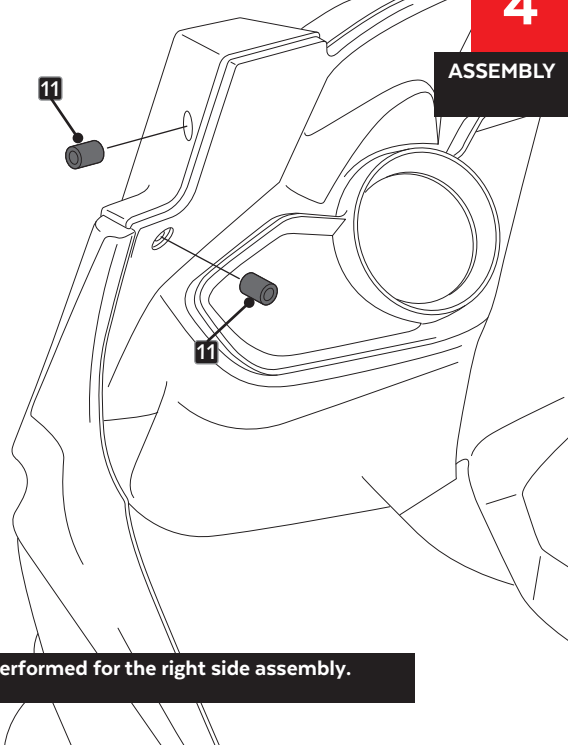

The left side assembly is shown as an example, so the same steps can be performed for the right side assembly.

KYMCO X-CITING 400 S '19-

MOUNTING INSTRUCTIONS

5

ASSEMBLY

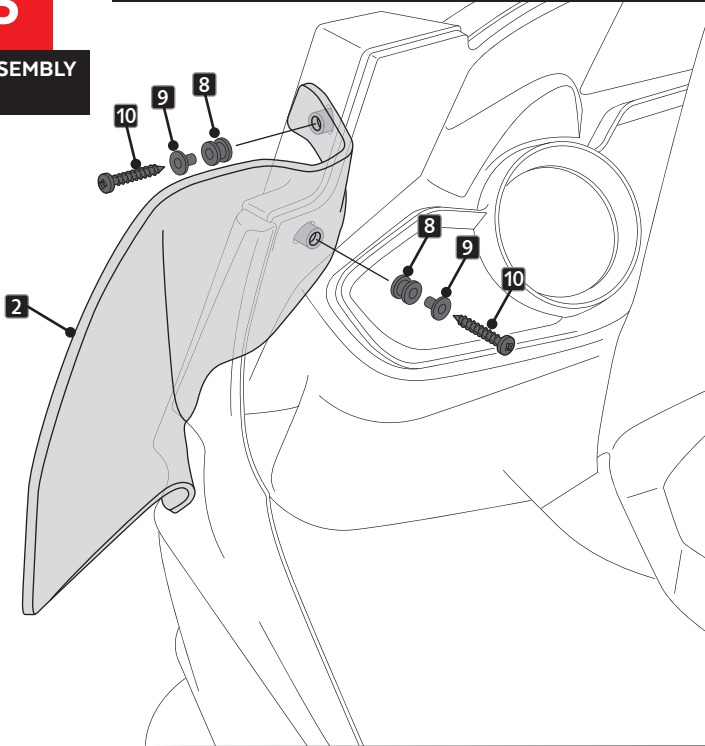

The left side assembly is shown as an example, so the same steps can be performed for the right side assembly.

6

ASSEMBLY

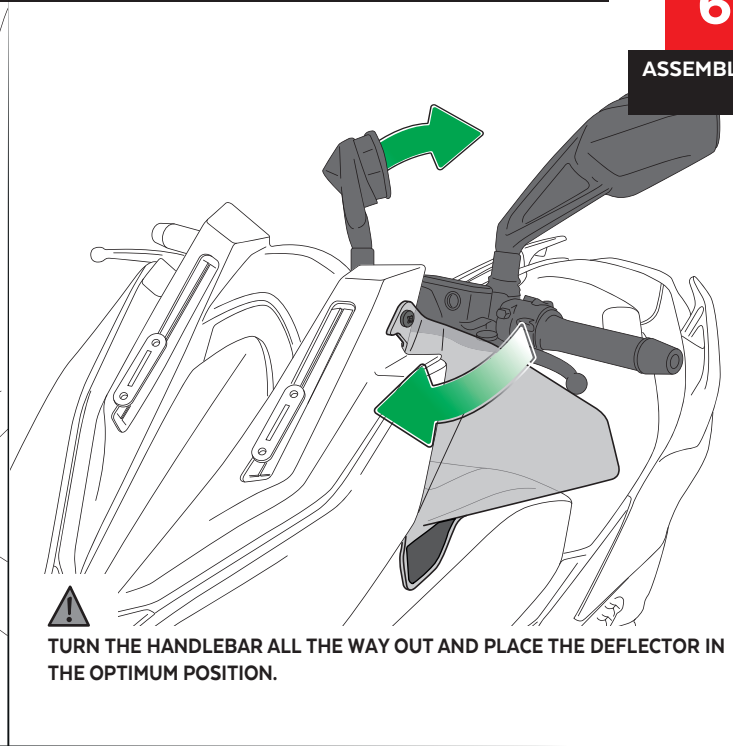

! TURN THE HANDLEBAR ALL THE WAY OUT AND PLACE THE DEFLECTOR IN THE OPTIMUM POSITION.

7

ASSEMBLY

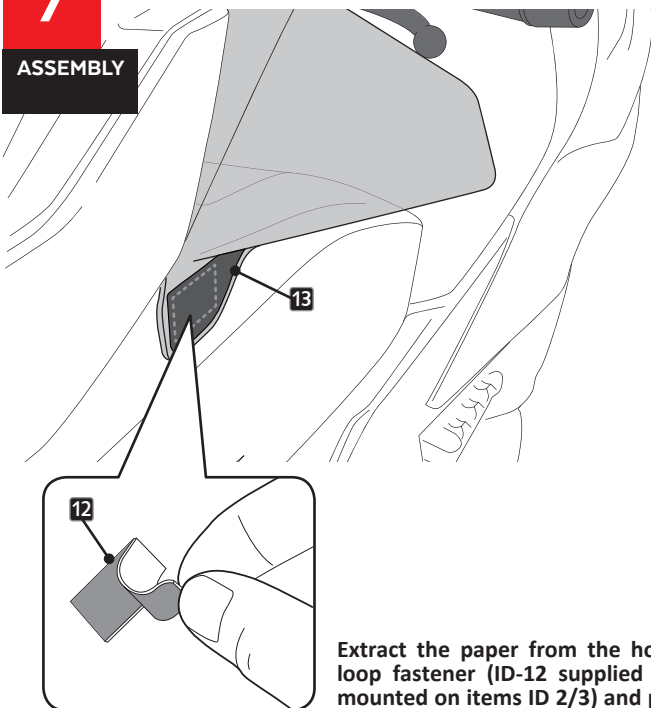

Extract the paper from the hook and loop fastener (ID-12 supplied already mounted on items ID 2/3) and position the hand-deflector.

8

ASSEMBLY

